

FOR SALE

SITE PLAN APPROVED INDUSTRIAL LAND

REMINGTON RD. REMINGTON, VA 22734



SALE PRICE **\$2,500,000**

OFFERING SUMMARY

Lot Size: 9.0 Acres
Zoning: I-1
Market: Washington DC
Submarket: Fauquier
Price / SF: \$6.38
Parcel ID: 6888-64-1833-000

PROPERTY OVERVIEW

Approximately 9 acres available for sale. The property is site plan approved for a 30,000 SF vehicle/truck & heavy equipment sales, rental and service facility with related parking. I-1 Zoning allows for many additional by-right uses including contractor's shop/warehouse, auto repair (mechanical & body), farm equipment sales, rental & service, self-storage and more.

LOCATION OVERVIEW

Located on Remington Rd. directly across from the Dominion Power Remington Solar Farm. Just over 1 mile to both Rt. 28 & Rt. 15/29. This property is in a Qualified Opportunity Zone!

PRESENTED BY:

CHUCK RECTOR

PRINCIPAL

703.330.1224

chuck@weber-rector.com

Offering is subject to errors, omissions, prior sale, change in price, or withdrawal without notice.



COMMERCIAL REAL ESTATE SERVICES

9401 Battle Street Manassas, VA 20110

www.Weber-Rector.com

FOR SALE

SITE PLAN APPROVED INDUSTRIAL LAND

REMINGTON RD. REMINGTON, VA 22734

SITE PLAN

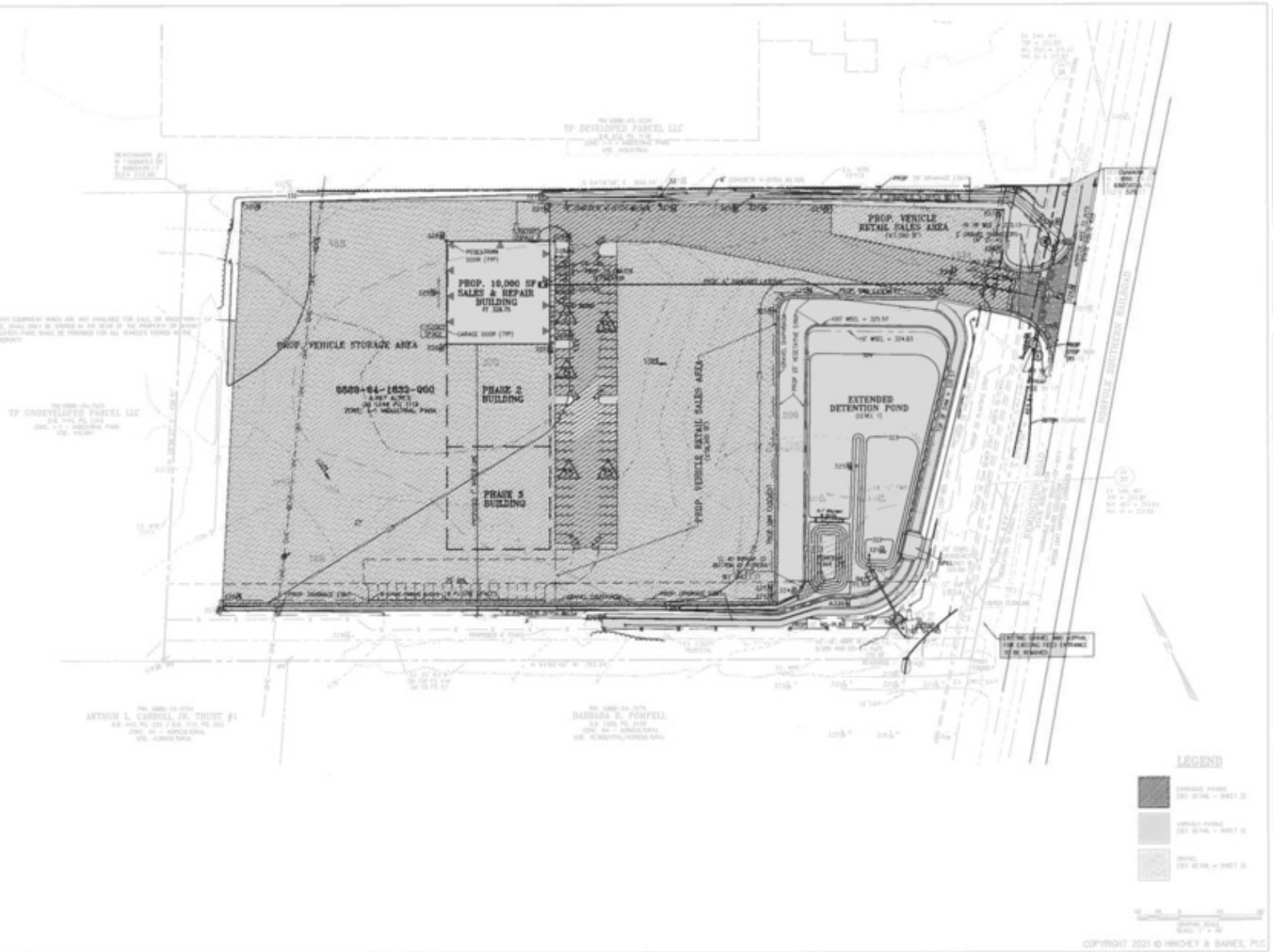

PRESENTED BY:

CHUCK RECTOR

PRINCIPAL

703.330.1224

chuck@weber-rector.com

Offering is subject to errors, omissions, prior sale, change in price, or withdrawal without notice.



COMMERCIAL REAL ESTATE SERVICES

9401 Battle Street Manassas, VA 20110

www.Weber-Rector.com

FOR SALE

SITE PLAN APPROVED INDUSTRIAL LAND

REMINGTON RD. REMINGTON, VA 22734

LOCATION MAP

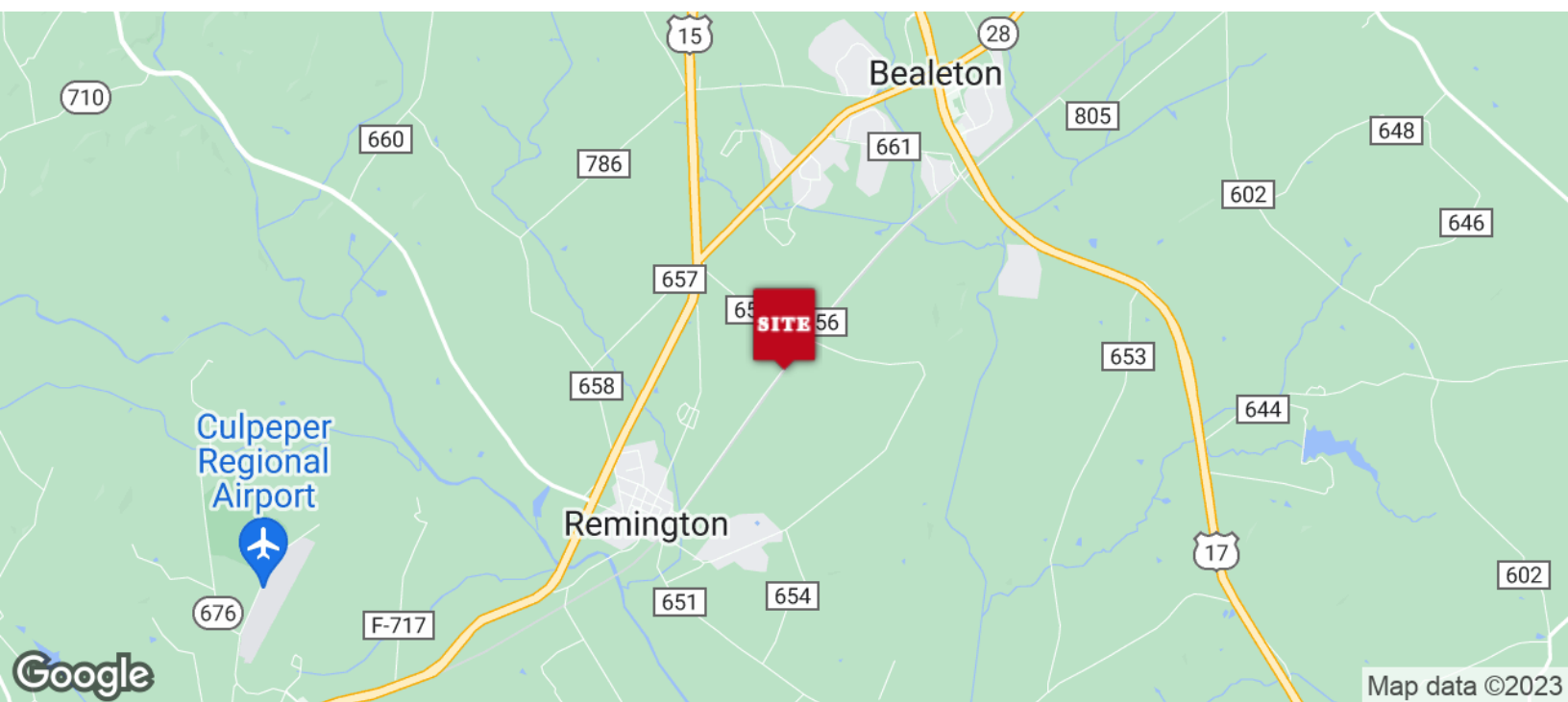

PRESENTED BY:

CHUCK RECTOR

PRINCIPAL

703.330.1224

chuck@weber-rector.com

Offering is subject to errors, omissions, prior sale, change in price, or withdrawal without notice.



COMMERCIAL REAL ESTATE SERVICES

9401 Battle Street Manassas, VA 20110

www.Weber-Rector.com

Opportunity Zones

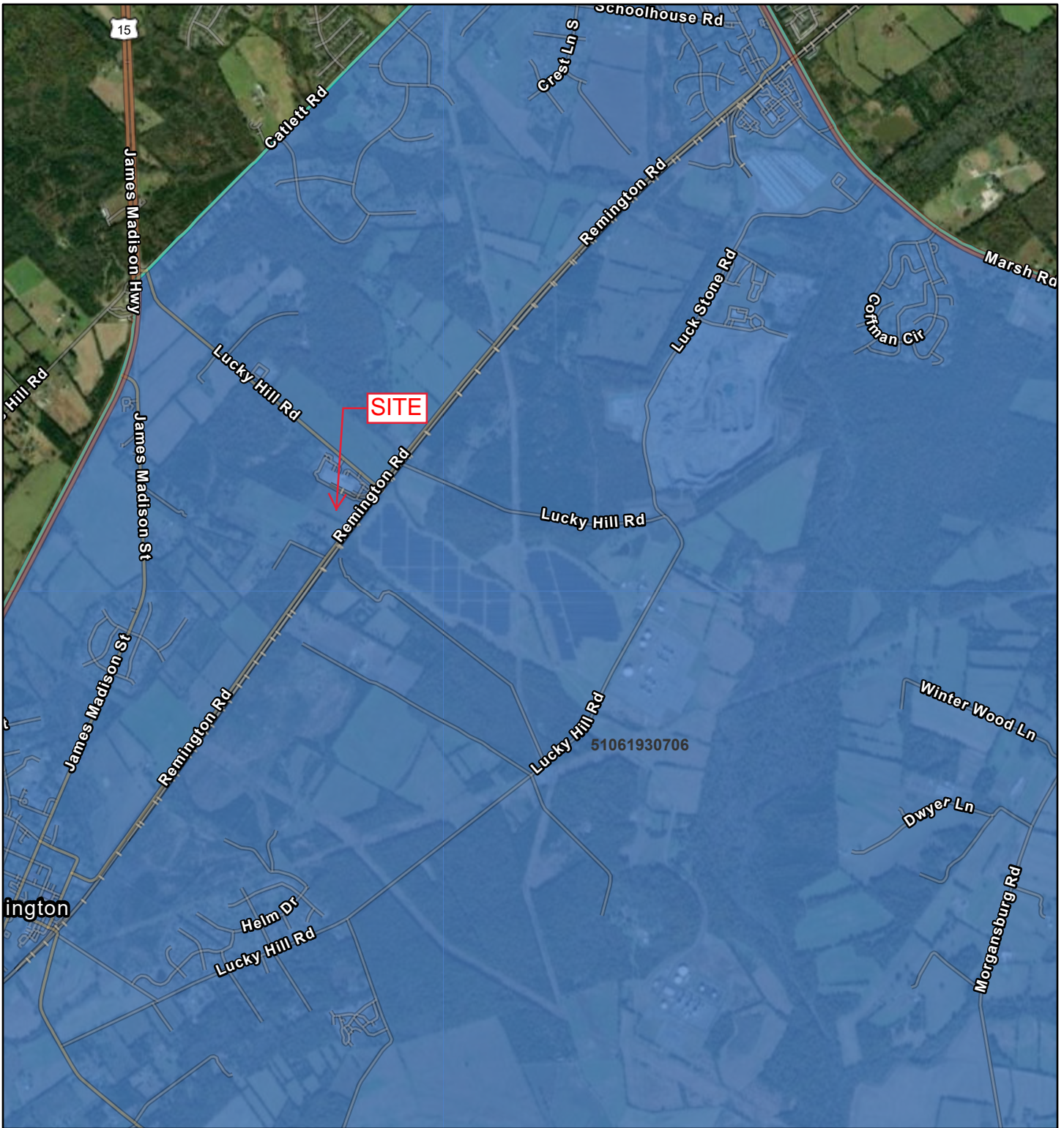

3/10/2022, 12:48:30 PM

 opportunity_zones

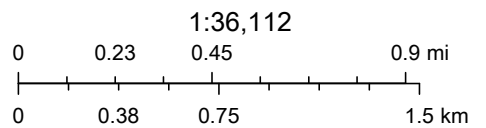

VITA, Esri, HERE, Garmin, SafeGraph, GeoTechnologies, Inc., METI/NASA, USGS, EPA, NPS, US Census Bureau, USDA, Maxar