

±27,830 SF



Sublease



2229-2235 E. Magnolia Street, Phoenix, AZ

Property Features

- Size:** ±27,830 SF
- Office:** ±4,000 SF which consists of:
- ±2,000 SF on the 1st floor
 - ±1,5000 SF mezzanine
 - ±500 SF temperature controlled room
- Available:** August 2023
- Clear Height:** 24'
- Loading:** 2 dock-high doors
1 grade level door
- Rate:** \$0.75 NNN
- Term:** Lease expires 10/31/2024
- Zoning:** A-2, City of Phoenix
- Location:** Less than 1 mile to the I-10 Freeway via 24th Avenue, with quick access to the 51, I-17 and US 60



2229-2235 E. Magnolia Street, Phoenix, AZ

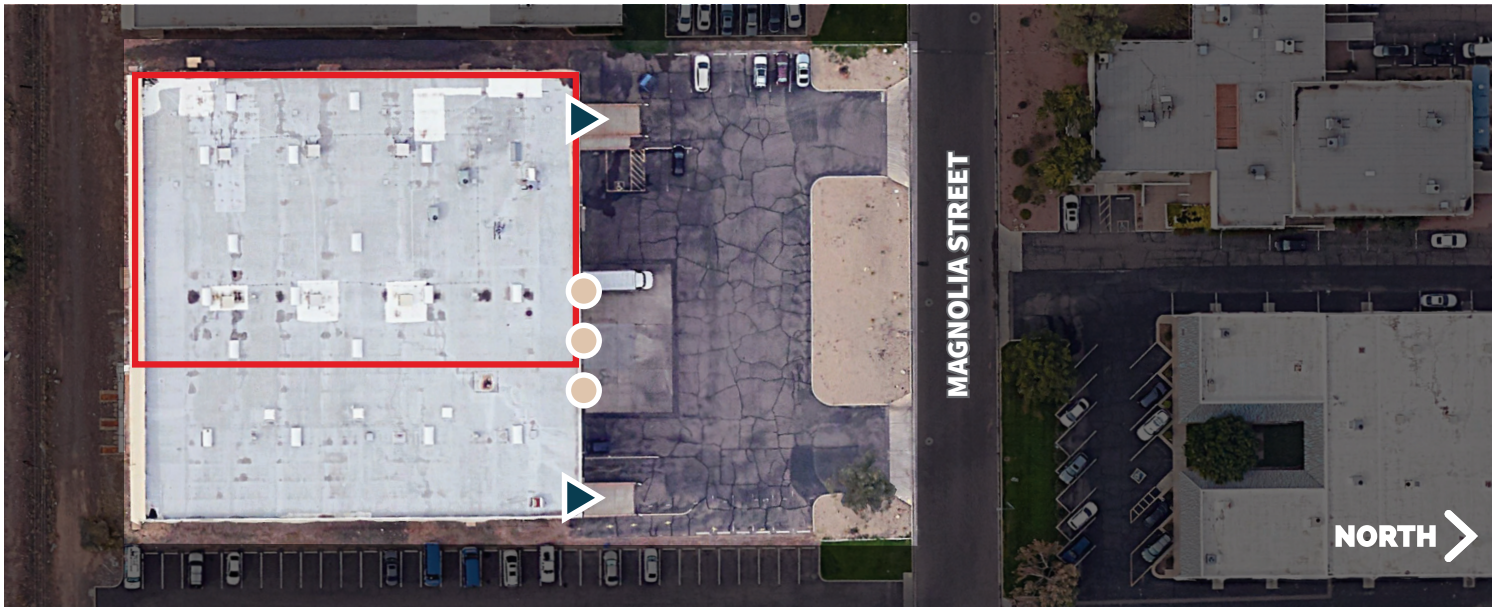

▶ Grade level door ● Dock high door



Jason Moore
Senior Vice President
+1 602 282 6280
Jason.Moore@jll.com



Although information has been obtained from sources deemed reliable, JLL does not make any guarantees, warranties or representations, express or implied, as to the completeness or accuracy as to the information contained herein. Any projections, opinions, assumptions or estimates used are for example only. There may be differences between projected and actual results, and those differences may be material. JLL does not accept any liability for any loss or damage suffered by any party resulting from reliance on this information. If the recipient of this information has signed a confidentiality agreement with JLL regarding this matter, this information is subject to the terms of that agreement. © 2023 Jones Lang LaSalle IP, Inc. All rights reserved.