

911 ERSKINE STREET THE FOUNTAINS

EAST NEW YORK

BROOKLYN
NY



CONCEPTUAL RENDERING

SPACE DETAILS

LOCATION

Northeast corner of Seaview Avenue

APPROXIMATE SIZE

Space A	
Ground Floor	13,607 SF*
Lower Level	7,037 SF*
Space B	
Ground Floor	20,212 SF*
Lower Level	7,080 SF*

*Divisible

CEILING HEIGHT

Space A	
Ground Floor	15 FT 2 IN
Lower Level	10 FT
Space B	
Ground Floor	16 FT 2 IN
Lower Level	10 FT 2 IN

FRONTAGE

Space A	135 FT on Erskine Street
Space B	172 FT on Erskine Street and 131 FT on Seaview Avenue

POSSESSION

January 2020

SITE STATUS

New construction

PARKING

96 spaces

NEIGHBORS

The Home Depot, ShopRite, Target, Bed Bath & Beyond, Old Navy, Best Buy, Michael's, JCPenney, Pier 1 Imports, ALDI and Petco

COMMENTS

Across from the Gateway Center
140,899 VPD on the Belt Parkway

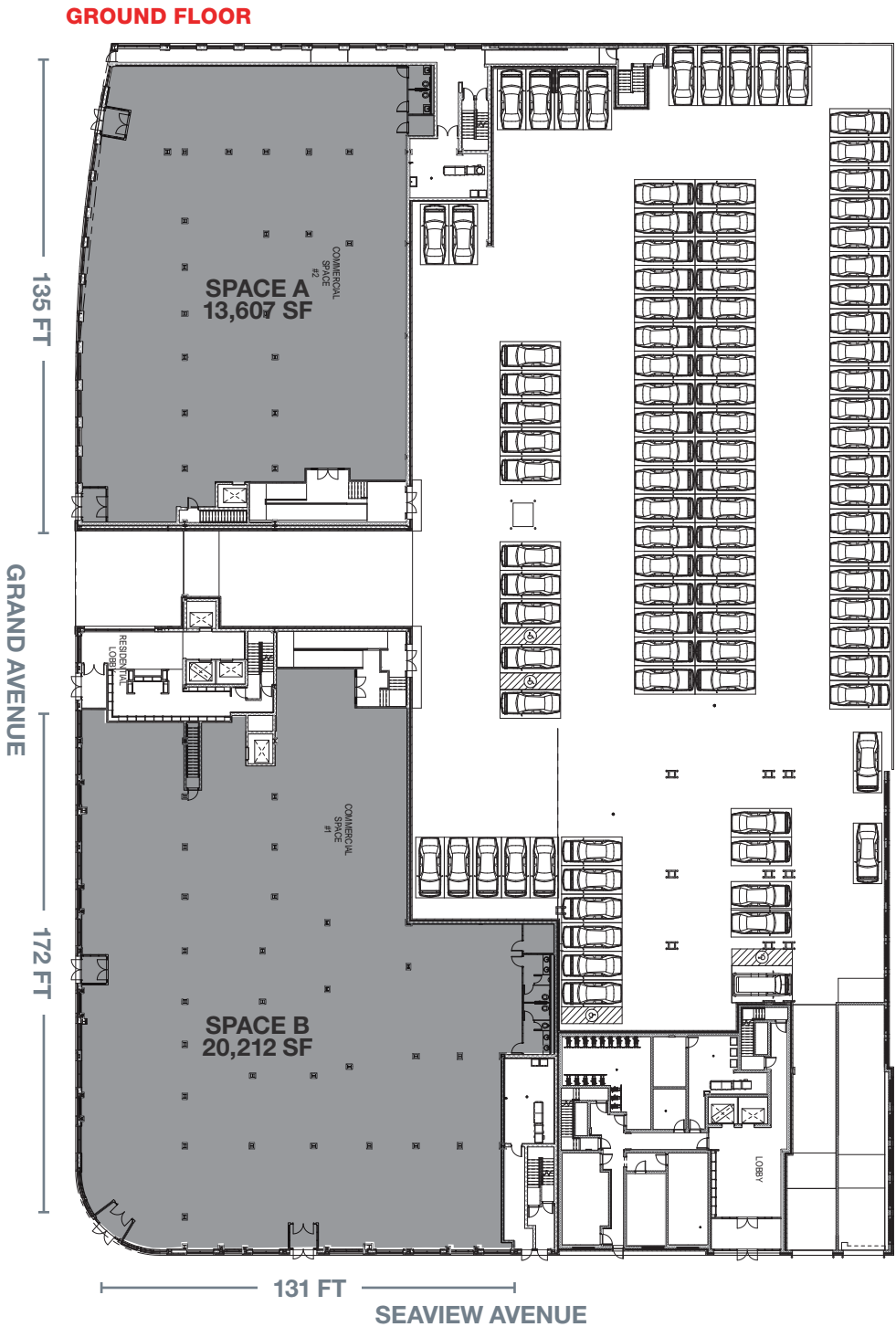

AREA RETAIL



AREA RETAIL



CONTACT EXCLUSIVE AGENT

BARRY FISHBACH
212.331.0115
barry.fishbach@ngkf.com

ALEX HEDAYA
212.351.9343
alex.hedaya@ngkf.com



NGKF.COM

© 2019 NEWMARK KNIGHT FRANK RETAIL. The information contained herein has been obtained from sources deemed reliable but has not been verified and no guarantee, warranty or representation, either express or implied, is made with respect to such information. Terms of sale or lease and availability are subject to change or withdrawal without notice.