



Available  
350,000 s.f. - 1,112,108 s.f.



# Old Augusta Commerce Center

## **Building 3 | Effingham County**

1301 Logistics Parkway, Savannah, GA



# Building 3 | Property specifications

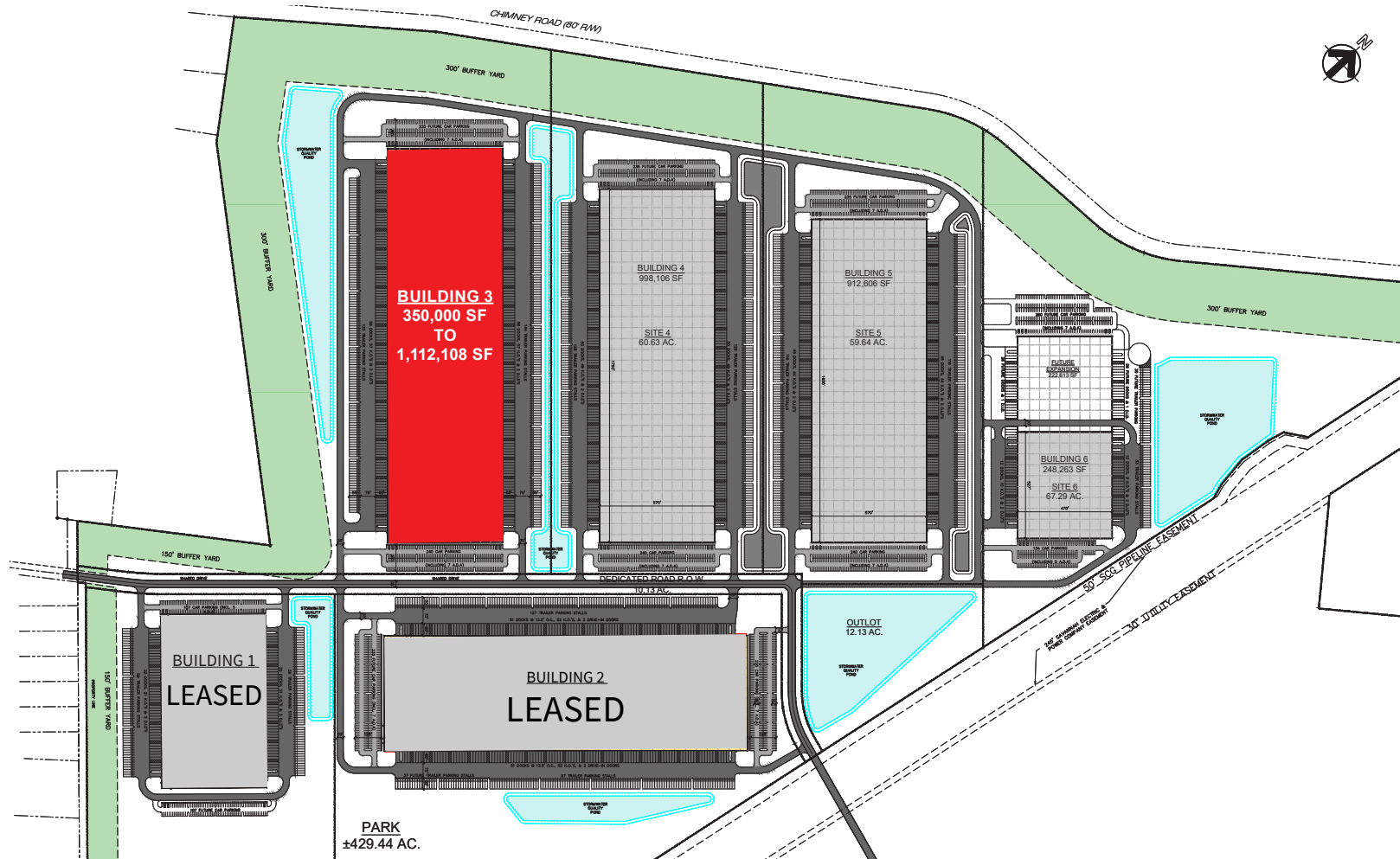

<b>Building s.f.</b>	+/- 1,112,108	<b>Clear height</b>	40'	<b>Sprinkler</b>	ESFR
<b>Available s.f.</b>	350,000 - 1,112,108	<b>Trailer parks</b>	277	<b>Power</b>	4,000 amps 480v 3 phase
<b>Building dimensions</b>	1950' x 570'	<b>Auto parks</b>	240	<b>Slab</b>	7" unreinforced
<b>Column spacing</b>	54' X 50'	<b>Docks</b>	226	<b>Warehouse lighting</b>	25 FC LEDs @ 36"
<b>Speed bay</b>	60'	<b>Levelers</b>	112 with 40,000 lb capacity	<b>Office s.f.</b>	2,012 spec
<b>Truck court depth</b>	190'	<b>Drive in doors</b>	4	<b>Warehouse finish</b>	White box

# Driving radius industries

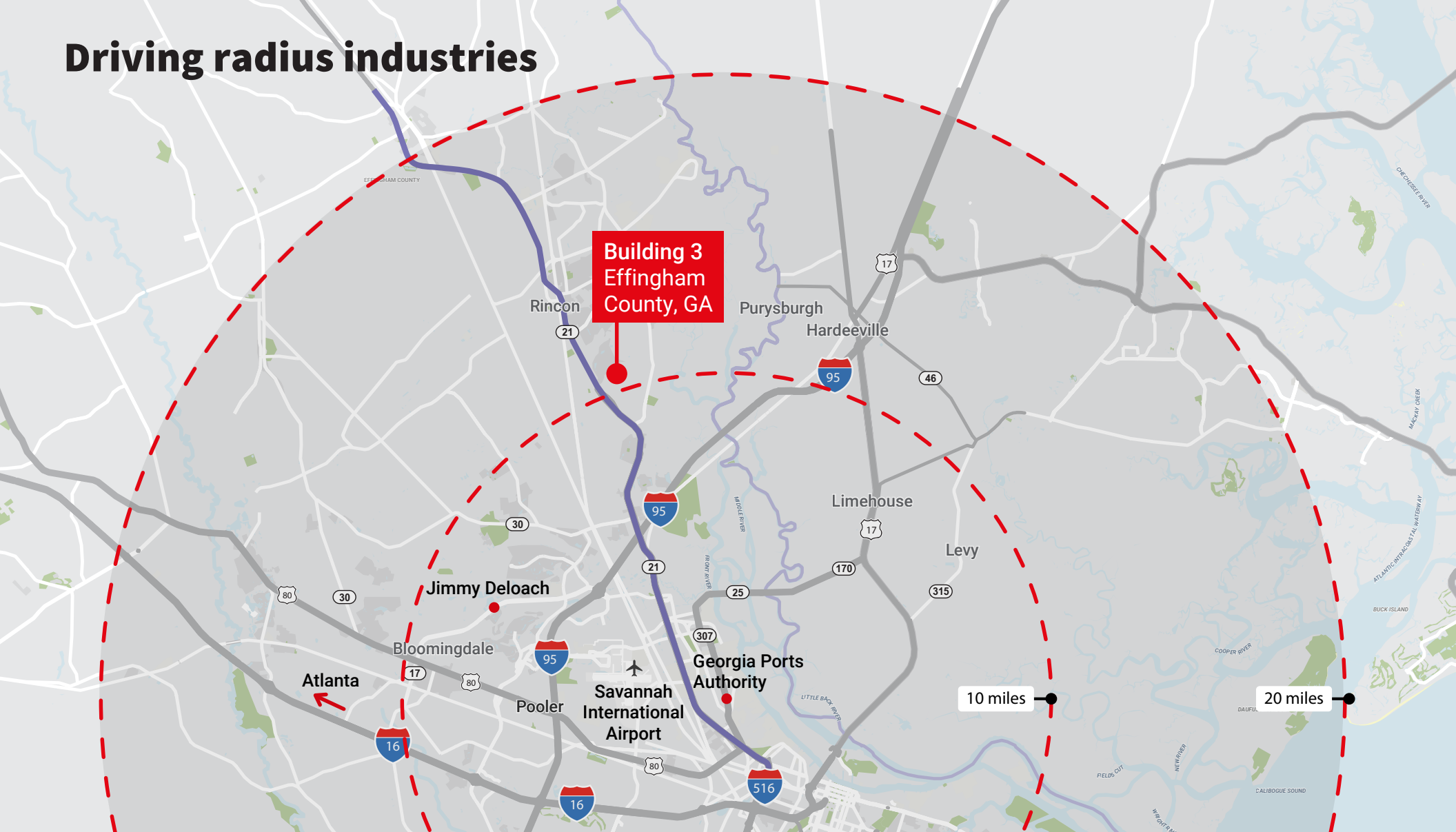

**240**

miles from  
Atlanta



**7**

miles from  
Jimmy DeLoach  
Parkway



**10.8**

miles from  
Georgia Ports  
Authority



**14.3**

miles from  
I-16



**5**

miles from  
I-95



# Area map



Bennett Rudder, SIOR  
Executive Managing Director  
JLL  
+1 912 250 4595  
bennett.rudder@jll.com

Ryan Hoyt, SIOR  
Senior Managing Director  
JLL  
+1 404 995 2090  
ryan.hoyt@jll.com

Chris Tomasulo, SIOR  
Executive Managing Director  
JLL  
+1 404 995 2462  
chris.tomasulo@jll.com

Lindsey Wilmot  
Senior Associate  
JLL  
+1 912 663 9394  
lindsey.wilmot@jll.com

Matt Neumann  
Vice President - Leasing  
Becknell Industrial  
+1 708 571 0561  
mneumann@becknellindustrial.com

