



For Lease or Sale | Medical/Office Condominiums from ± 862 to 2,544 SF

**3191 W. TEMPLE AVENUE
POMONA, CA 91768**



Please contact:

RICKY LEE
Broker
C: 909-348-3956
RJ Realty
DRE#: 01932116
RickyJessie.Lee@gmail.com

Daniel Huang
Senior Associate
C: 626-382-8240
PYC Commercial
DRE# 01959072
626CARE@gmail.com



57

TEMPLE AVENUE



For Lease or Sale

Medical/Office Condominiums

from ±862 to 2,544 SF

PROPERTY FEATURES:

- Two-Store Office Building
- Major renovation completed in 2024
- Located in City of Pomona Opportunity Zone
- Medical suites available
- 4.8/1,000 Parking ratio
- Located in the Eastern SGV Submarket
- State-of-the-art building systems
- Amenity rich location
- Elevator served
- Immediate access to the 57, 60, & 10 freeways
- Excellent Owner User or Investment Opportunity



**3191 W. TEMPLE AVENUE
POMONA, CA 91768**



Please contact:

RICKY LEE
Broker
C: 909-348-3956
RJ Realty
DRE#: 01932116
RickyJessie.Lee@gmail.com

Daniel Huang
Senior Associate
C: 626-382-8240
PYC Commercial
DRE# 01959072
626CARE@gmail.com

FIRST FLOOR



AVAILABILITY

Suite	Size	Occupancy
-------	------	-----------

160	862 SF	Vacant
165	1,120SF	Vacant
130	1,142SF	Vacant

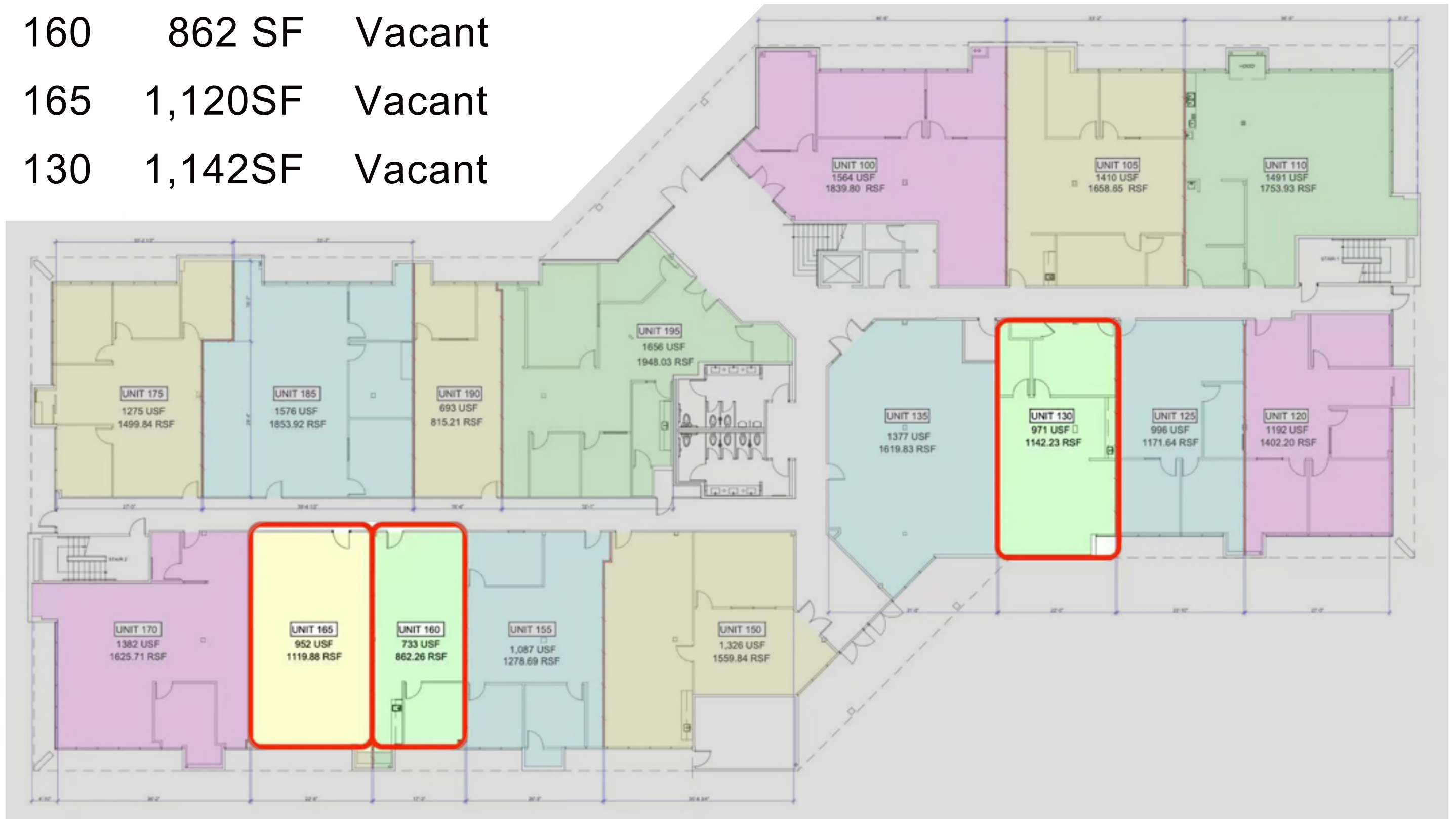

SECOND FLOOR

AVAILABILITY

Suite	Size	Occupancy
-------	------	-----------

290	1,269 SF	Vacant
-----	----------	--------

288	1,275 SF	Vacant
-----	----------	--------

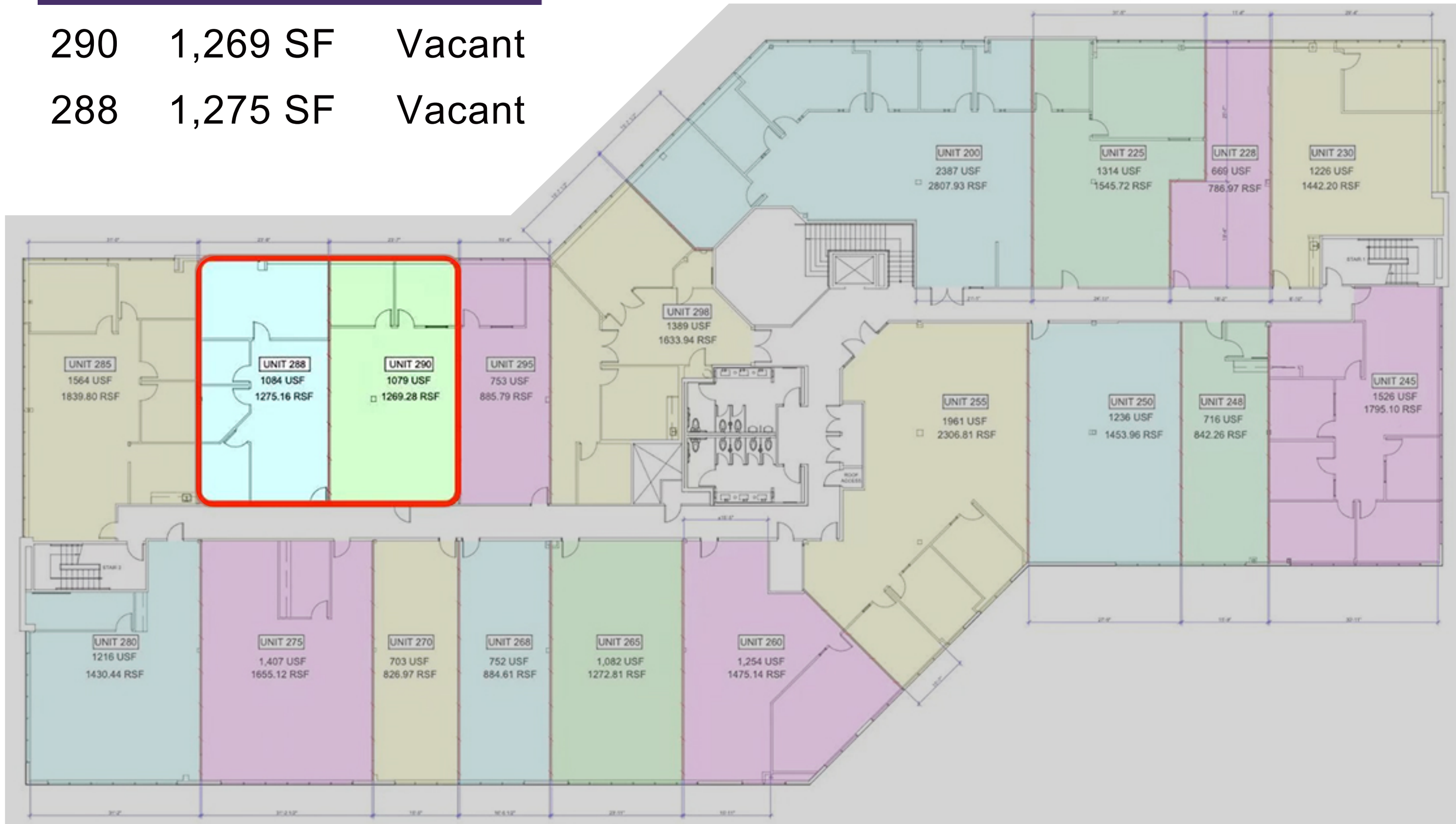

For Lease or Sale

Medical/Office Condominiums

from ±862 to 2,544 SF

Area Amenities



For Lease or Sale

Medical/Office Condominiums

from ±862 to 2,544 SF

Eastern SGV Location

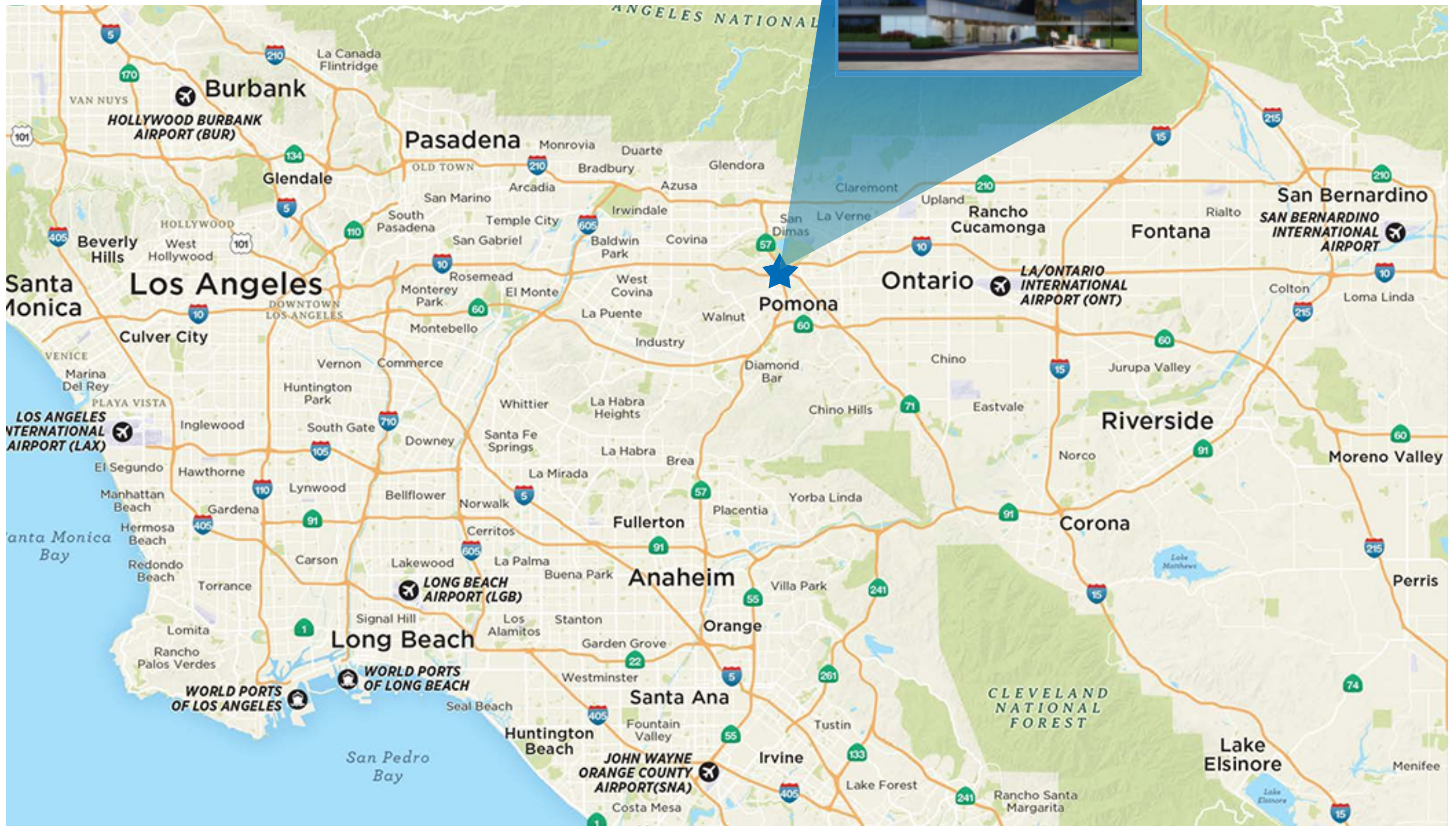

The broker for a purchaser of the property shall be entitled to receive a real estate commission only in the event that broker and the property's owner execute a written commission agreement containing the manner of calculation of that commission and all conditions to its payment, and the satisfaction of those conditions. Absent a written agreement to the contrary between that broker and Newmark that broker shall not look to Newmark for payment of such a commission or any other compensation. Although all information furnished regarding property for sale, lease, or financing has been obtained from sources deemed to be reliable, that information has not been verified by Newmark and no express representation is made nor is any to be implied as to the accuracy thereof. That information is subject to errors, omissions, change of price, rental or other conditions, prior sale, lease or financing, or withdrawal without notice and to any special conditions imposed by Newmark's client.

For Lease or Sale | Medical/Office Condominiums
from ±862 to 2,544 SF

3191 W TEMPLE AVENUE POMONA, CA 91768



888 Brea Canyon Road
Suite 200
Diamond Bar, CA 91789

Please contact:

RICKY LEE
Broker
C: 909-348-3956
RJ Realty
DRE#: 01932116
RickyJessie.Lee@gmail.com

Daniel Huang
Senior Associate
C: 626-382-8240
PYC Commercial
DRE# 01959072
626CARE@gmail.com