

# CENTERLINKS

Oriole Road & Alico Road | Fort Myers, FL 33912

Warehouse/Flex For Lease



**LQ Commercial**  
REAL ESTATE SERVICES

**LQCRE.COM**



**\$16.00 PSF**  
**LEASE RATE**  
**(GREY SHELL)**



**16,400 SF**  
**MIN. SIZE**  
**AVAILABLE**



**39,400 SF**  
**MAX SIZE**  
**AVAILABLE**



**\$3.25**  
**CAM PSF**  
**(DELIVERY ESTIMATE)**



**2023**  
**BUILT**  
**(CURRENT PHASE)**

- 41 acre mixed use industrial commercial park located along Oriole Road, 1,000 feet north of Alico Road & 0.7 miles west of the I-75/Alico Rd. interchange.
- The project has been developed in phases and consists of nine buildings ranging in size from 37,800 SF to 63,000 SF.
- The development will benefit from 3 phase power, 75-120' truck courts, 120-200' building depths, ESPR fire sprinkler system and a total of 822 parking spaces at build-out.

## GOOGLE TOUR

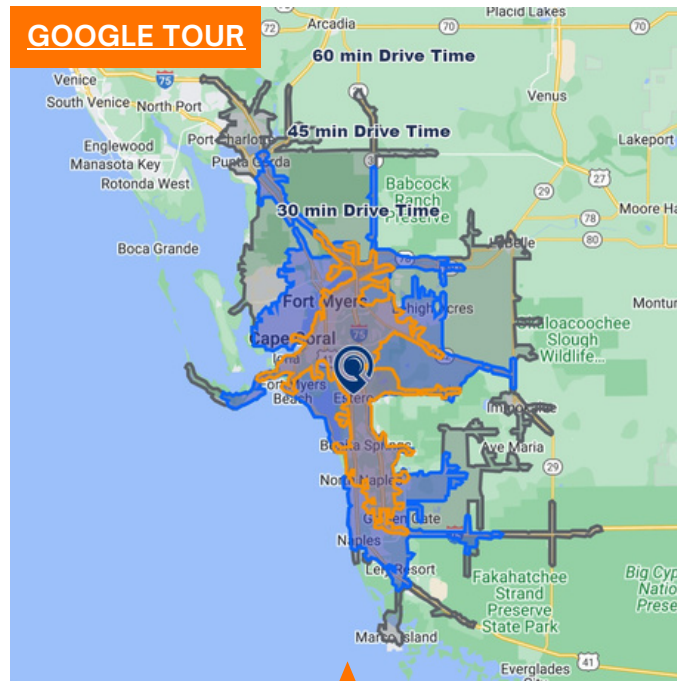

[LQCRE.COM/CENTERLINKS](https://www.lqcre.com/centerlinks)

BUILDING	SF	CONSTRUCTION
1	100% LEASED	18' CLEAR - TILT WALL CONST.
2	100% LEASED	20' CLEAR - TILT WALL CONST.
3	100% LEASED	20' CLEAR - TILT WALL CONST.
4	100% LEASED	18' CLEAR - TILT WALL CONST.
5	100% LEASED	20' CLEAR - TILT WALL CONST.
6	100% LEASED	20' CLEAR - TILT WALL CONST.
7	100% LEASED	18' CLEAR - TILT WALL CONST.
8	100% LEASED	20' CLEAR - TILT WALL CONST.
9	39,400 SF	20' CLEAR - TILT WALL CONST.



3555 Kraft Rd. #260  
Naples, FL 34105

[LQCRE.COM](https://www.lqcre.com)

**Adam Palmer, CCIM, SIOR**  
Principal, Managing Director

D: 239.333.2507

C: 239.898.8686

[apalmer@lqcre.com](mailto:apalmer@lqcre.com)

**Mike Doyle, CCIM**  
Senior Associate

D: 239.333.4361

C: 239.851.3164

[mdoyle@lqcre.com](mailto:mdoyle@lqcre.com)

# CENTERLINKS

Oriole Road & Alico Road | Fort Myers, FL 33912

Warehouse/Flex For Lease



**LQ Commercial**  
REAL ESTATE SERVICES

**LOCRE.COM**

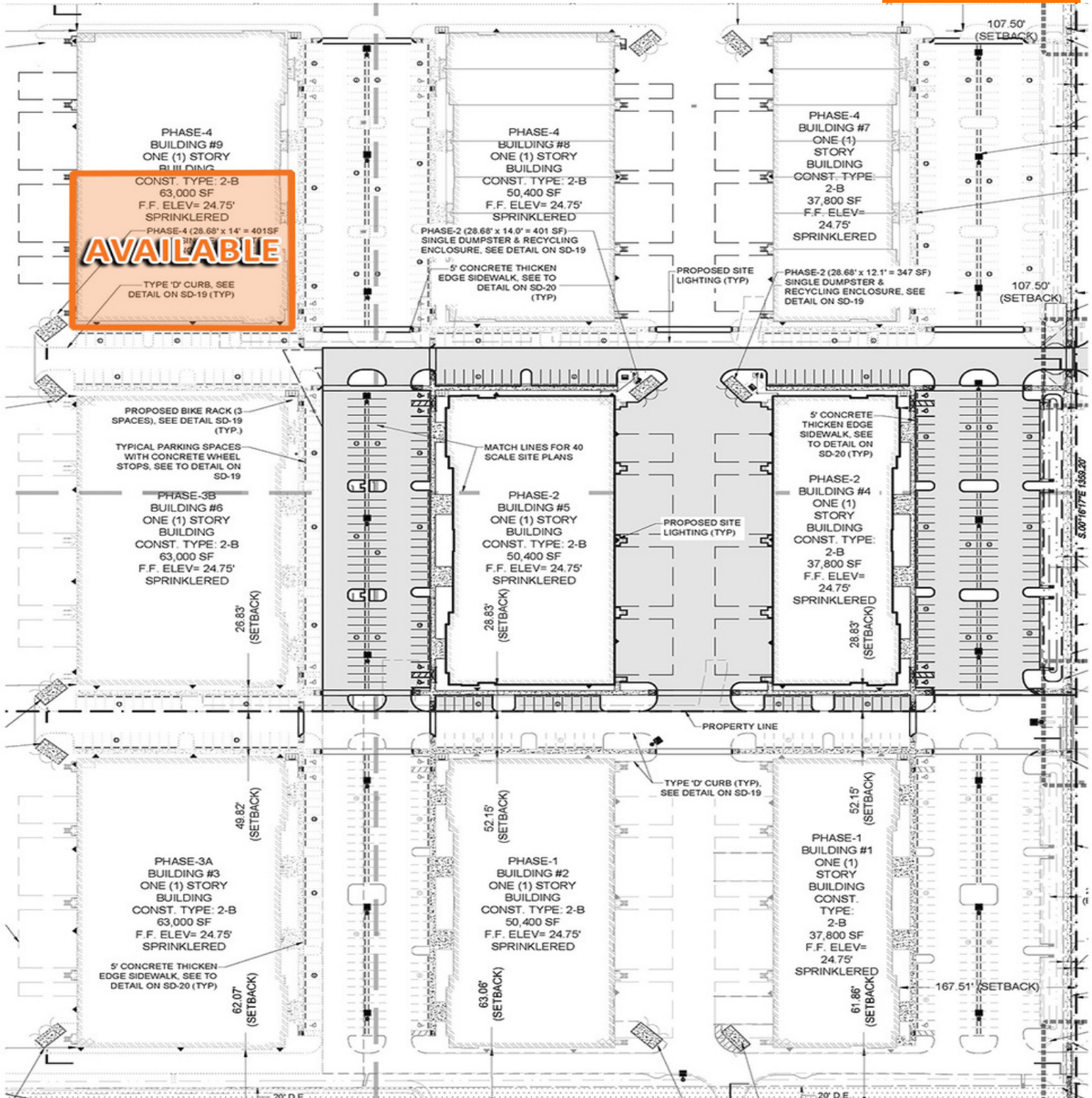

3555 Kraft Rd. #260  
Naples, FL 34105

**LOCRE.COM**

**Adam Palmer, CCIM, SIOR**  
Principal, Managing Director

D: 239.333.2507

C: 239.898.8686

[apalmer@lqcre.com](mailto:apalmer@lqcre.com)

**Mike Doyle, CCIM**  
Senior Associate

D: 239.333.4361

C: 239.851.3164

[mdoyle@lqcre.com](mailto:mdoyle@lqcre.com)