



MEDICAL OFFICE | FOR LEASE

9821 S MAY AVENUE, OKLAHOMA CITY, OK 73159

VICKI KNOTTS
vknotts@newmarkrp.com
O: 405.879.4761

NEWMARK
ROBINSON PARK

9821 S MAY AVENUE, OKLAHOMA CITY, OK / FOR LEASE

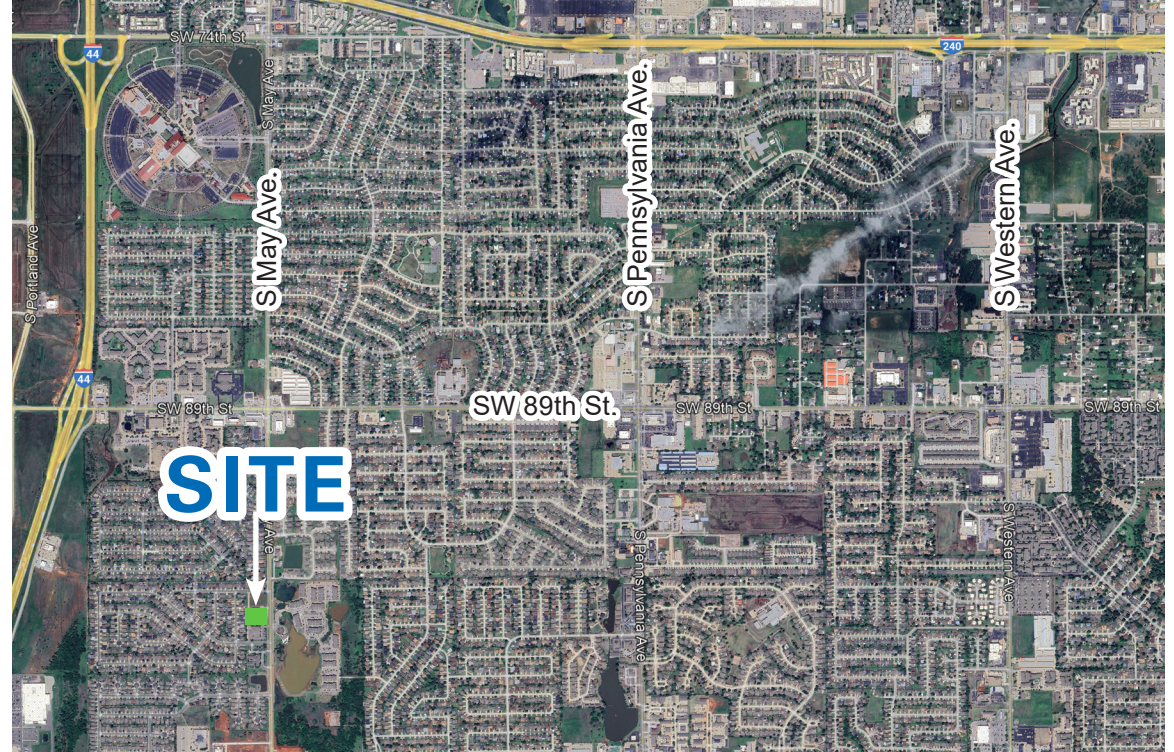
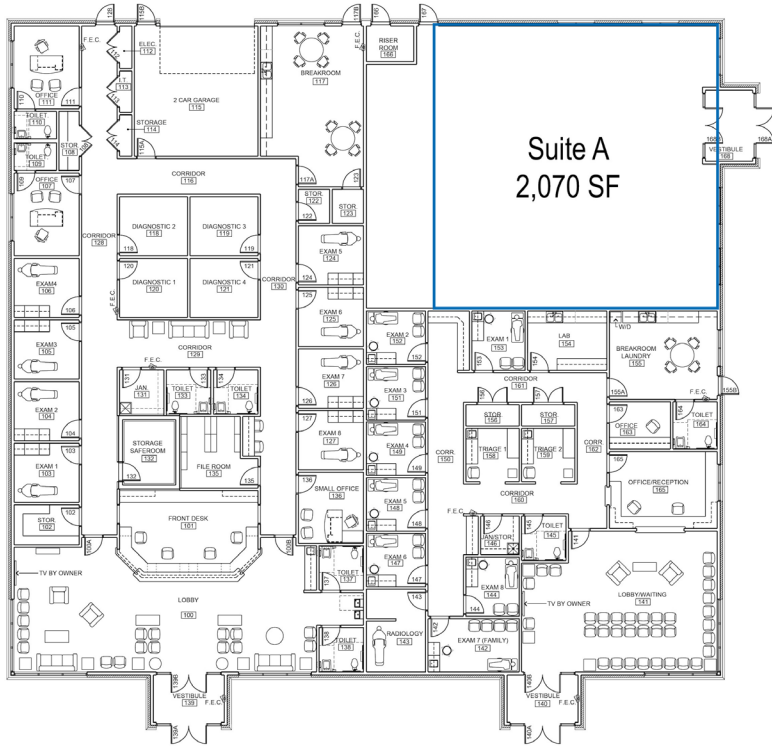

DETAILS

Available

Suite A 2,070 RSF

Lease Rate \$22.00/SF

Lease Type Modified Gross

Term 3 - 5 Years

Market Oklahoma City

HIGHLIGHTS

Drive up parking

Surrounding medical centers

Street lamps in parking lot

Monument signage

Immediate access to I-44

Convenient to fast food & restaurants

PROPERTY OVERVIEW

Located on S May Avenue just east of I-44. Situated in a medical development which includes Southwest Eye & Surgery Center, Weir Laser, and Retina Consultants of Oklahoma. Suite A is in shell condition and can be custom built to tenant's needs. The suite has a private entrance on the north side and monument signage available facing May Ave.