

# 68/69

OLD KATY ROAD

DOWNTOWN HOUSTON

GREENWAY PLAZA

RIVER OAKS

MEMORIAL PARK

OLD KATY RD



## PREMIER CORPORATE HQ OPPORTUNITY

±140,000 SF OFFICE/SHOWROOM/WAREHOUSE SPACE AVAILABLE

IN DESIGN DISTRICT

# PROPERTY OVERVIEW

**Address:** 6869 Old Katy Rd

**Property:** ±140,000 SF

**Office:** 60,000 SF

**Warehouse:** 80,000 SF

**Acreage:** 9.51 Acres

**6869 Old Katy Rd:** 7.21 Acres

**CNP Easement:** 2.30 Acres

## FEATURES

Located within best-in-class demographics in one of Houston's most affluent and supply constrained corridors

Attractive, move-in ready office buildout designed for functionality and flow

Interstate Billboard - fronting on I-10, exclusive Tenant/User signage

Preferably located with easy access to local, regional and interstate transportation infrastructure

Best-in-class demographics within a 5-mile radius

Efficient warehouse featuring 26' clear height and a generous truck court

Minutes from Houston's Memorial Park, the city's premier public park with an extensive trails system and home of PGA Houston Open, planned access to Park from north of I-10.

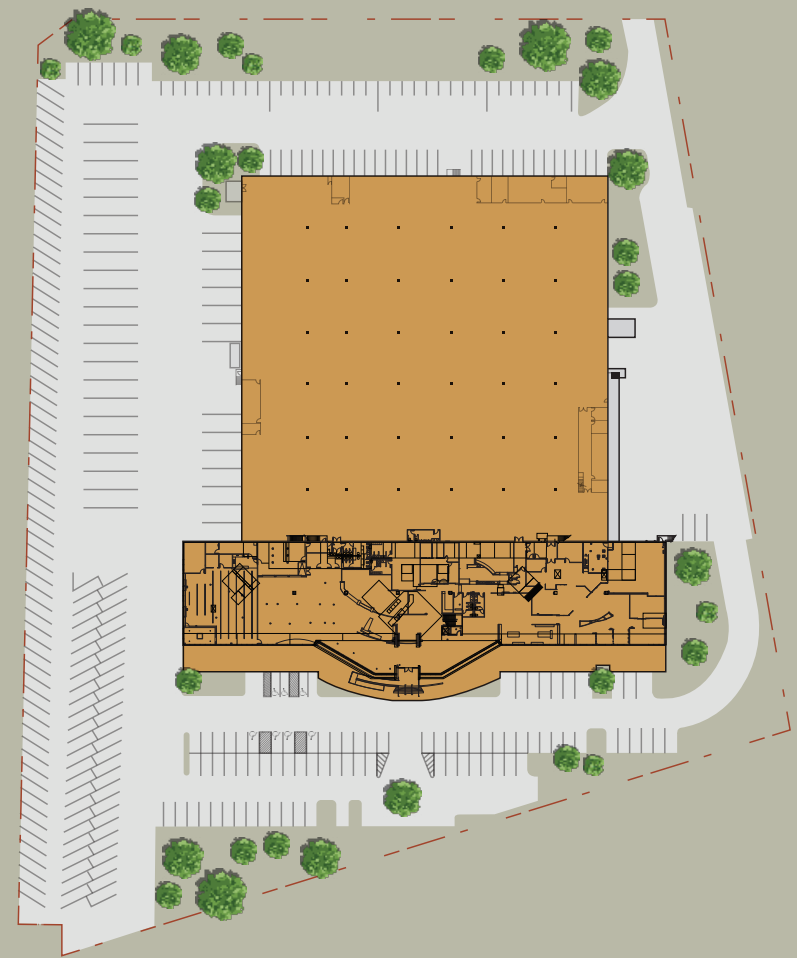



**FOR MORE INFORMATION, PLEASE CONTACT:**

**MICHAEL FOREMAN**

Managing Director

Direct: +1 713 963 2850

Mobile: +1 713 818 6217

michael.foreman@cushwake.com

**JIM FOREMAN**

Vice Chairman

Direct: +1 713 963 2824

jim.foreman@cushwake.com

**JP HUTCHESON**

Executive Director

Direct: +1 713 260 0234

Mobile: +1 713 703 9219

jp.hutcheson@cushwake.com

©2026 Cushman & Wakefield. All rights reserved. The information contained in this communication is strictly confidential. This information has been obtained from sources believed to be reliable but has not been verified. No warranty or representation, express or implied, is made as to the condition of the property (or properties) referenced herein or as to the accuracy or completeness of the information contained herein, and same is submitted subject to errors, omissions, change of price, rental or other conditions, withdrawal without notice, and to any special listing conditions imposed by the property owner(s). Any projections, opinions or estimates are subject to uncertainty and do not signify current or future property performance.

