

Redevelopment  
Anchor and Shop Spaces  
Available



## Mission Plaza Redevelopment

800-870 S. Mountain Avenue, Ontario, CA

### Property Highlights

- Anchor Space Available 10,000–16,000 SF
- End-cap and shop spaces available
- 40,388 SF shopping center
- Professionally managed with beautiful landscaping
- Great parking with easy access
- Busy intersection with over 70,000 cars per day
- Restaurant space in great condition
- Excellent office space for immediate occupancy
- High percent of renters in trade area

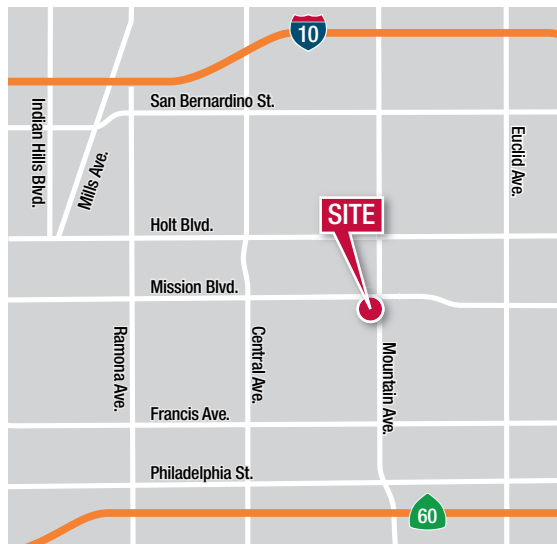

For more information:

**Lidia Talavera**  
Executive Vice President  
909-945-2339 • LTalavera@naicapital.com  
Cal DRE Lic. #01407598

800 N Haven Ave.  
Suite 400  
Ontario, CA 91764  
fax 909 945 2338  
www.naicapital.com

DEMOGRAPHICS	1 MILES	3 MILES	5 MILES
POPULATION	27,248	215,529	459,824
DAYTIME WORK POPULATION	7,499	57,716	174,660
AVG. HH INCOME	\$67,933	\$75,328	\$81,316

# Redevelopment Anchor and Shop Spaces Available

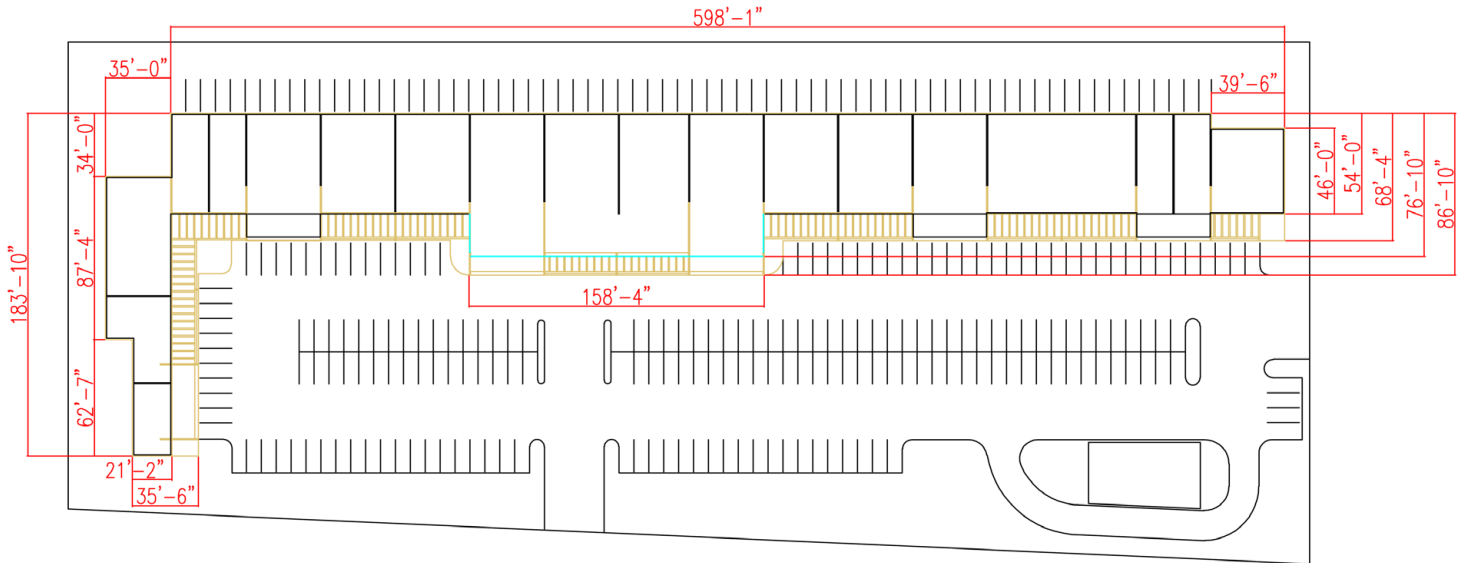

Proposed Redevelopment Site Plan

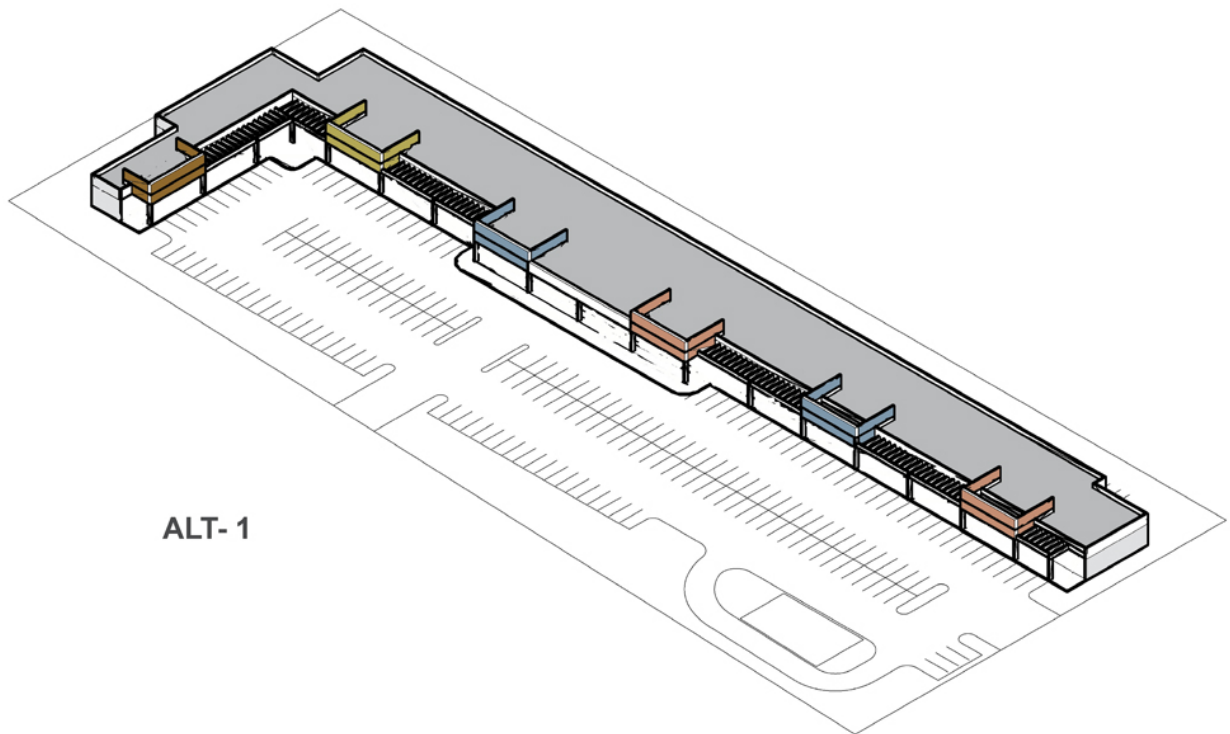

ALT-1



COMMERCIAL REAL ESTATE SERVICES, WORLDWIDE

No warranty, express or implied, is made as to the accuracy of the information contained herein. This information is submitted subject to errors, omissions, change of price, rental or other conditions, withdrawal without notice, and is subject to any special listing conditions imposed by our principals. Cooperating brokers, buyers, tenants and other parties who receive this document should not rely on it, but should use it as a starting point of analysis, and should independently confirm the accuracy of the information contained herein through a due diligence review of the books, records, files and documents that constitute reliable sources of the information described herein. Logos are for identification purposes only and may be trademarks of their respective companies. NAI Capital, Inc. Cal DRE Lic. #02130474.

**Lidia Talavera**  
Executive Vice President  
909-945-2339  
LTalavera@naicapital.com  
Cal DRE Lic. #01407598

800 N Haven Ave.  
Suite 400  
Ontario, CA 91764  
fax 909 945 2338  
www.naicapital.com

# Redevelopment Anchor and Shop Spaces Available

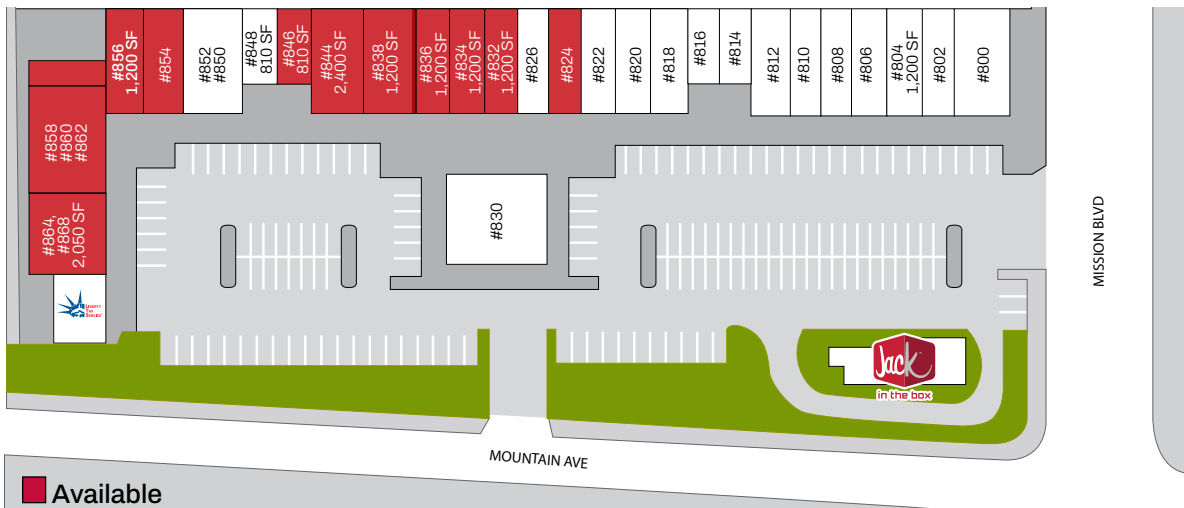

UNIT	LEASE NAME	SIZE
800	ABC Tobacco	1,800
802	Dental	1,200
804	Staffing Agency	1,200
806-808	Mother's Nutritional	4,773
810,812	Marisco's Restaurant	5,312
814	Chela's Bakery	810
816	House of Nutrition	810
818, 820	Carnitas Estillo Michoacan	2,400
822	Carnitas Estillo Michoacan	1,200
824	AVAILABLE	1,200
826	Day Spa	1,200
830	Mountain Market	3,000
832	AVAILABLE	1,200
834	AVAILABLE	1,200
836	AVAILABLE	1,200
838	AVAILABLE	1,200
844	AVAILABLE	2,400
846	AVAILABLE	810
848	Beauty Salon	810
850-852	PWS Laundry	2,400
854	AVAILABLE	1,200
856	AVAILABLE	1,200
858-862	AVAILABLE (Former Restaurant)	3,400
864-868	AVAILABLE	2,050
870	Liberty Tax Service	1,200
PAD	Jack In The Box	2,036



COMMERCIAL REAL ESTATE SERVICES, WORLDWIDE

No warranty, express or implied, is made as to the accuracy of the information contained herein. This information is submitted subject to errors, omissions, change of price, rental or other conditions, withdrawal without notice, and is subject to any special listing conditions imposed by our principals. Cooperating brokers, buyers, tenants and other parties who receive this document should not rely on it, but should use it as a starting point of analysis, and should independently confirm the accuracy of the information contained herein through a due diligence review of the books, records, files and documents that constitute reliable sources of the information described herein. Logos are for identification purposes only and may be trademarks of their respective companies. NAI Capital, Inc. Cal DRE Lic. #02130474.

**Lidia Talavera**  
Executive Vice President  
909-945-2339  
LTalavera@naicapital.com  
Cal DRE Lic. #01407598

800 N Haven Ave.  
Suite 400  
Ontario, CA 91764  
fax 909 945 2338  
www.naicapital.com