

# MILL RUN SQUARE

## RETAIL FOR LEASE

3641-3681 FISHINGER BOULEVARD, HILLIARD, OHIO  
43026



**NOAH HEATH** *ADVISOR*

**MOBILE** 614.949.9876 | **DIRECT** 614.334.7783  
**NHEATH@EQUITY.NET**



**AARON HEATH** *SENIOR V.P.*

**M:** 614.804.9836 | **DIRECT:** 614.334.7786  
**AHEATH@EQUITY.NET**



# PROPERTY HIGHLIGHTS

## MILL RUN SQUARE

RETAIL FOR LEASE

3641-3681 FISHINGER BOULEVARD, HILLIARD, OHIO 43026

- +/- 1,200 SF available
- Asking \$20.00 per square foot/NNN
- \$6.71 per SF operating expenses
- 41,445 vehicles per day on Fishinger Blvd. (MORPC: 2020)
- 46,711 square foot shopping center anchored by highly trafficked Lowe's and Floor & Décor
- Close proximity with easy access to I-270
- Professionally managed and maintained
- Join co-tenants Dollar Tree, Hale's Ales, Aquarium Adventure, Boot Barn, and State Farm Insurance

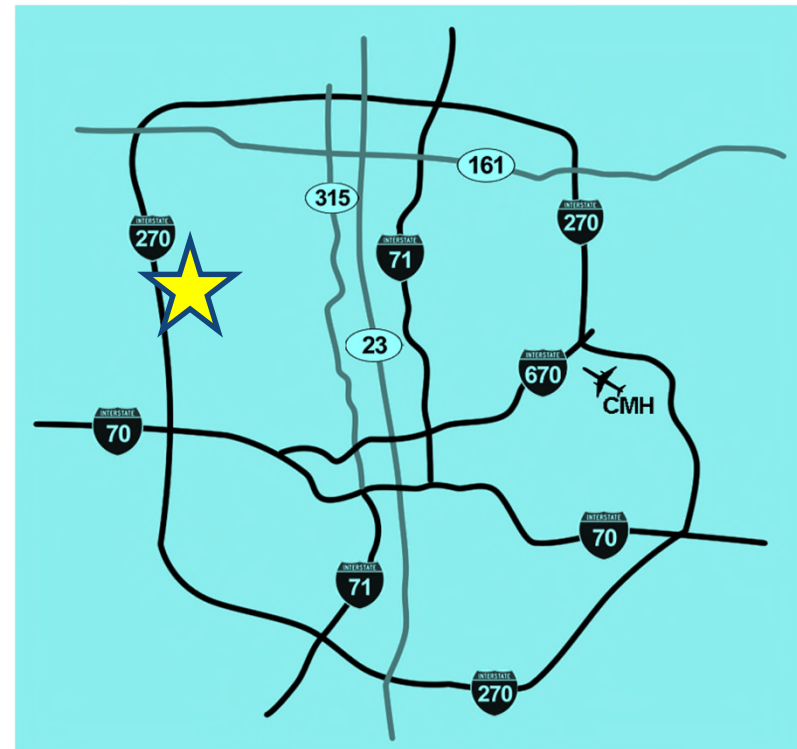

# AERIAL: MILL RUN



# SITE PLAN



# SPACE PLAN

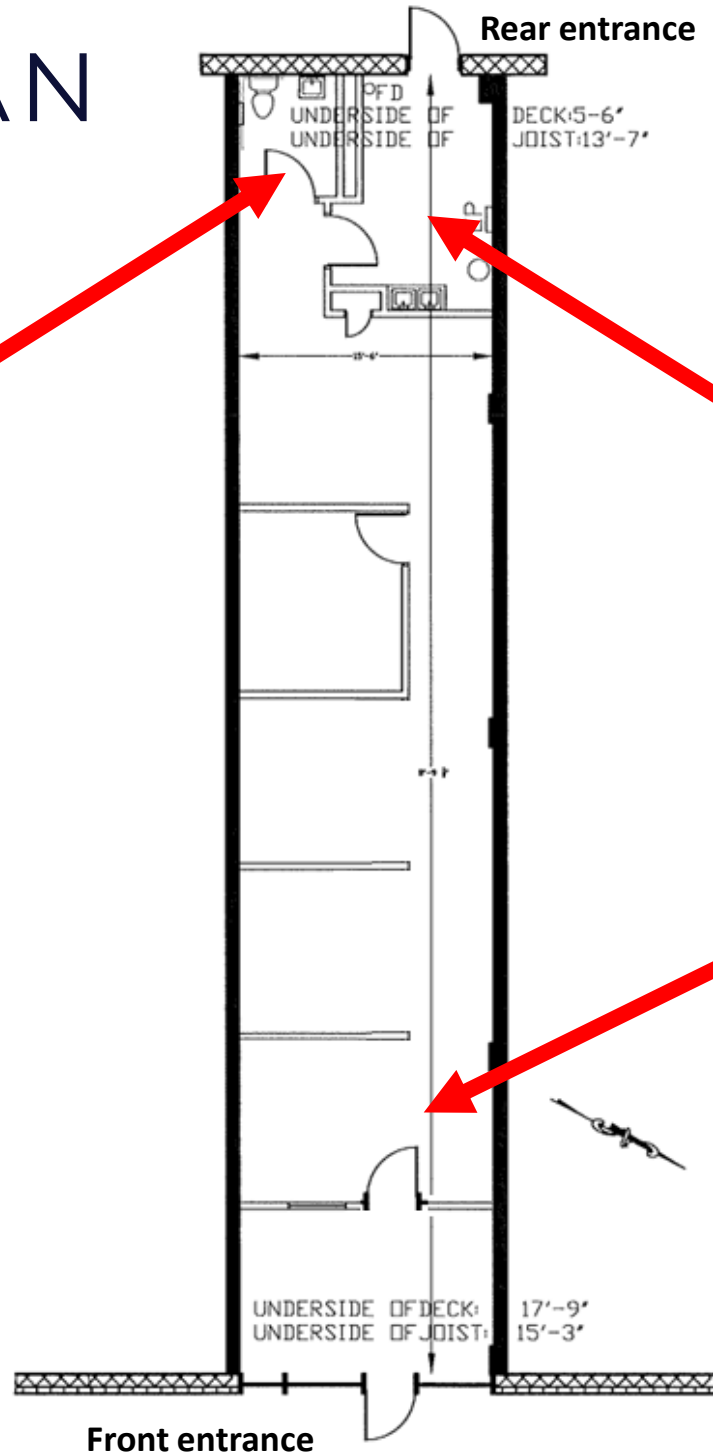

# VACANCY FRONTAGE



**1,200 SF**

**AVAILABLE**

**equity** | brokerage

[www.equity.net](http://www.equity.net)

The information contained herein has been obtained from the property owner or other sources that we deem reliable. Although we have no reason to doubt its accuracy, no representation or warranty is made regarding the information, and the property is offered "as is". The submission may be modified or withdrawn at any time by the property owner.

# 1-MILE RADIUS DEMOS

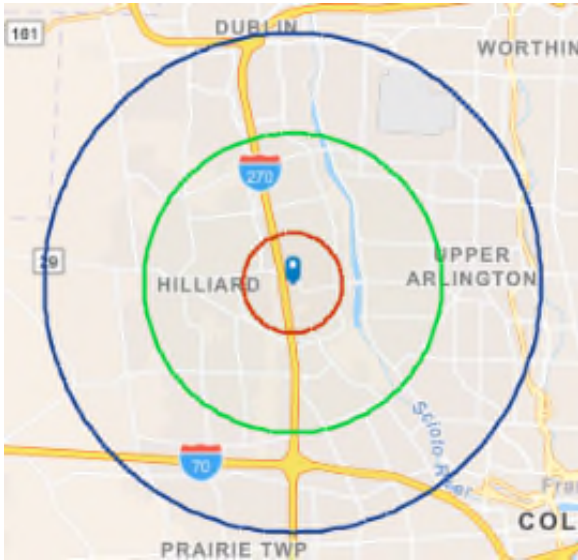

## KEY FACTS

**7,050**  
Population

**2.1**  
Average  
Household Size

**42.8**  
Median Age

**\$98,852**  
Median Household Income

## BUSINESS

**433**

Total Businesses

**7,345**

Total Employees

## EDUCATION

**3%**

No High School  
Diploma

**17%**

High School  
Graduate

**24%**

Some  
College

**56%**

Bachelor's/Grad/Prof  
Degree

## INCOME



**\$58,771**

Per Capita  
Income



**\$98,852**

Median  
Household  
Income



**\$129,542**

Average  
Household  
Income

## EMPLOYMENT



**78.9**

White  
Collar %



**10.4**

Blue  
Collar %



**10.8**

Services  
%

**equity** | brokerage

The information contained herein has been obtained from the property owner or other sources that we deem reliable. Although we have no reason to doubt its accuracy, no representation or warranty is made regarding the information, and the property is offered "as is." The submission may be modified or withdrawn at any time by the property owner.

# 3-MILE RADIUS DEMOS

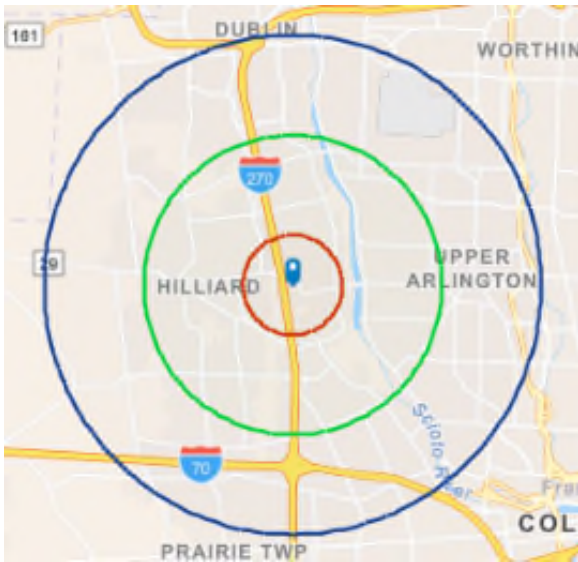

## KEY FACTS

**89,555**  
Population

**2.4**  
Average  
Household Size

**38.2**  
Median Age

**\$98,970**  
Median Household Income

## BUSINESS

**2,710**

Total Businesses

**39,669**

Total Employees

## EDUCATION

**3%**

No High School  
Diploma

**13%**

High School  
Graduate

**21%**

Some  
College

**63%**

Bachelor's/Grad/Prof  
Degree

## INCOME



**\$54,961**  
Per Capita  
Income



**\$98,970**  
Median  
Household  
Income



**\$132,756**  
Average  
Household  
Income

## EMPLOYMENT

**78.7**  
White  
Collar %

**11.1**  
Blue  
Collar %

**10.2**  
Services  
%

**equity** | brokerage

The information contained herein has been obtained from the property owner or other sources that we deem reliable. Although we have no reason to doubt its accuracy, no representation or warranty is made regarding the information, and the property is offered "as is." The submission may be modified or withdrawn at any time by the property owner.



# 5-MILE RADIUS DEMOS

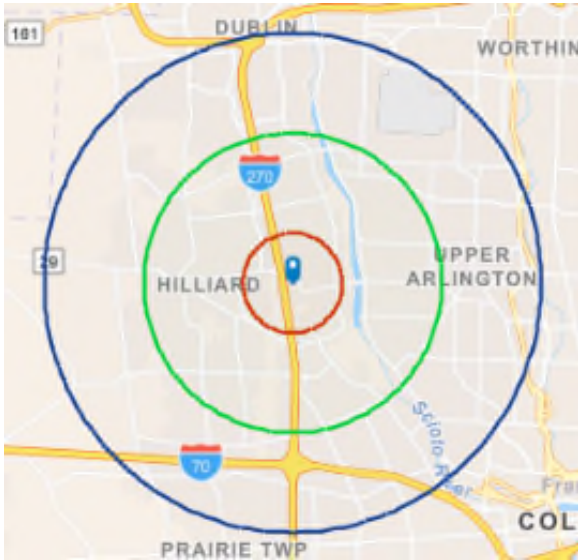

## KEY FACTS

**236,125**  
Population

**2.3**  
Average  
Household Size

**36.4**  
Median Age

**\$84,936**  
Median Household Income

## BUSINESS

**9,039**

Total Businesses

**140,426**

Total Employees

## EDUCATION

**3%**  
No High School  
Diploma

**14%**  
High School  
Graduate

**20%**  
Some  
College

**63%**  
Bachelor's/Grad/Prof  
Degree

## INCOME

**\$51,987**  
Per Capita  
Income

**\$84,936**  
Median  
Household  
Income

**\$118,847**  
Average  
Household  
Income

## EMPLOYMENT

**76.3**  
White  
Collar %

**12.4**  
Blue  
Collar %

**11.2**  
Services  
%

**equity** | brokerage

The information contained herein has been obtained from the property owner or other sources that we deem reliable. Although we have no reason to doubt its accuracy, no representation or warranty is made regarding the information, and the property is offered "as is." The submission may be modified or withdrawn at any time by the property owner.