

# Sketch

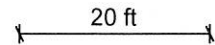

Living Area	Area Calculation			
Lower Level	1105.5 ft <sup>2</sup>	<input type="checkbox"/>	<b>Lower Level</b>	<b>x 1.00 = 1105.5 ft<sup>2</sup></b>
Upper Level	1904.5 ft <sup>2</sup>	<input type="checkbox"/>	14' x 13' x	1.00 = 182 ft <sup>2</sup>
<b>Nonliving Area</b>	<b>742 ft<sup>2</sup></b>	<input type="checkbox"/>	2' 6" x 1' x	1.00 = 2.5 ft <sup>2</sup>
2 Car Attached	742 ft <sup>2</sup>	<input type="checkbox"/>	24' 6" x 27' x	1.00 = 661.5 ft <sup>2</sup>
		<input type="checkbox"/>	5' x 1' 6" x	1.00 = 7.5 ft <sup>2</sup>
		<input type="checkbox"/>	14' x 18' x	1.00 = 252 ft <sup>2</sup>
		<input type="checkbox"/>	<b>Upper Level</b>	<b>x 1.00 = 1904.5 ft<sup>2</sup></b>
		<input type="checkbox"/>	2' 6" x 16' x	1.00 = 40 ft <sup>2</sup>
		<input type="checkbox"/>	2' x 10' 6" x	1.00 = 21 ft <sup>2</sup>
		<input type="checkbox"/>	25' 6" x 42' x	1.00 = 1071 ft <sup>2</sup>
		<input type="checkbox"/>	21' x 26' x	1.00 = 546 ft <sup>2</sup>
		<input type="checkbox"/>	7' x 1' 6" x	1.00 = 10.5 ft <sup>2</sup>
<b>Total Living Area (rounded):</b>	<b>3010 ft<sup>2</sup></b>	<input type="checkbox"/>	12' x 18' x	1.00 = 216 ft <sup>2</sup>

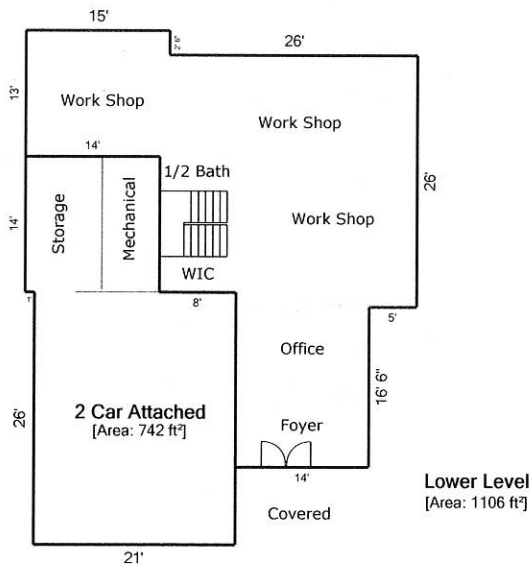
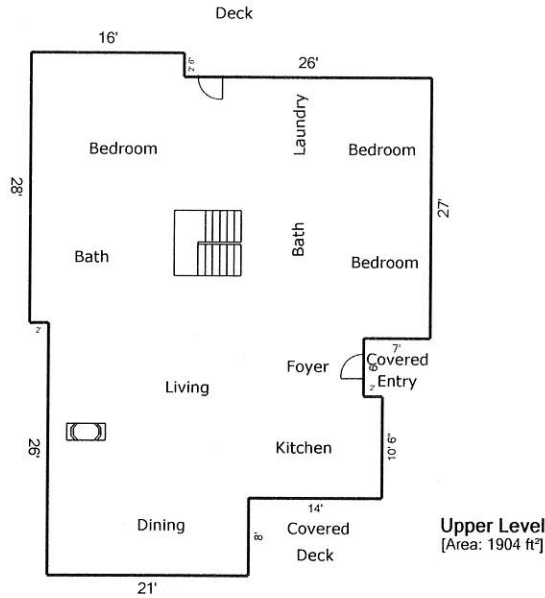