

9235 EASTMAN
PARK DR
WINDSOR, CO

FOR LEASE

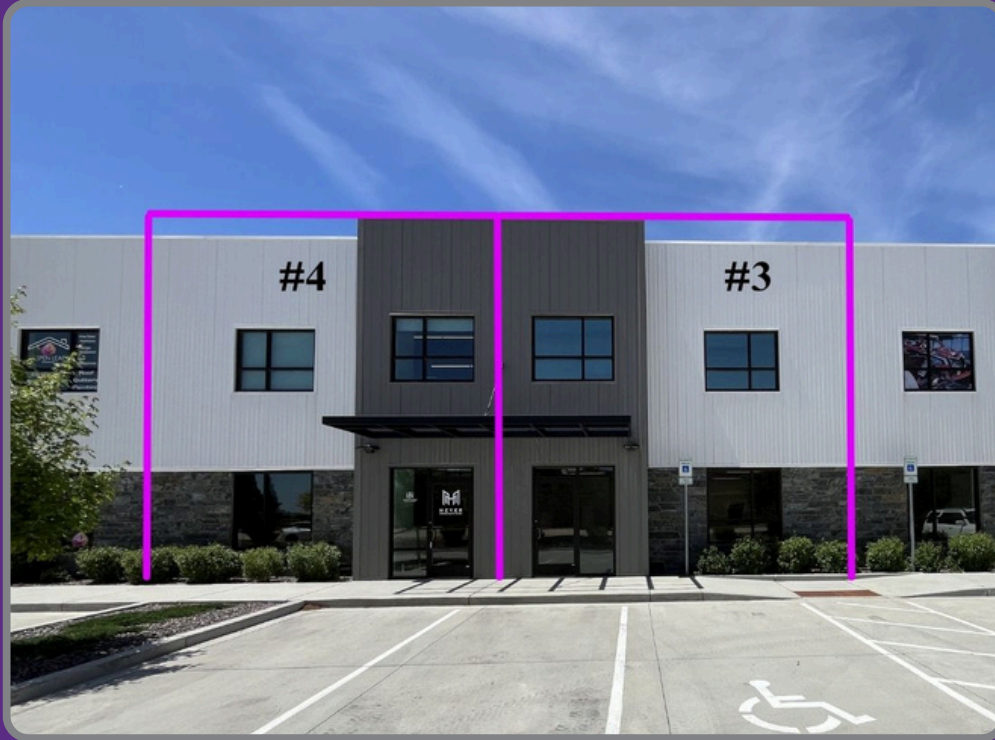

NEW CONSTRUCTION FLEX SPACE | BUILT 2022

Units 3: 2,155 SF Base Rate: \$16.00 / SF NNN: \$6.50 / SF
Total Rent: \$4040/Monthly

Units 4: 2,155 SF Base Rate: \$17.00 / SF NNN: \$6.50 / SF
Total Rent: \$4220/Monthly



Collective NoCo Properties

Marc Agnew

970 - 518 - 7802

CollectiveNoCoProperties.com



Information contained herein is not guaranteed. Potential purchasers and tenants are advised to verify all information. Price, terms and information are subject to change.

COLLECTIVE
— NOCO PROPERTIES —

BUILDING LAYOUT

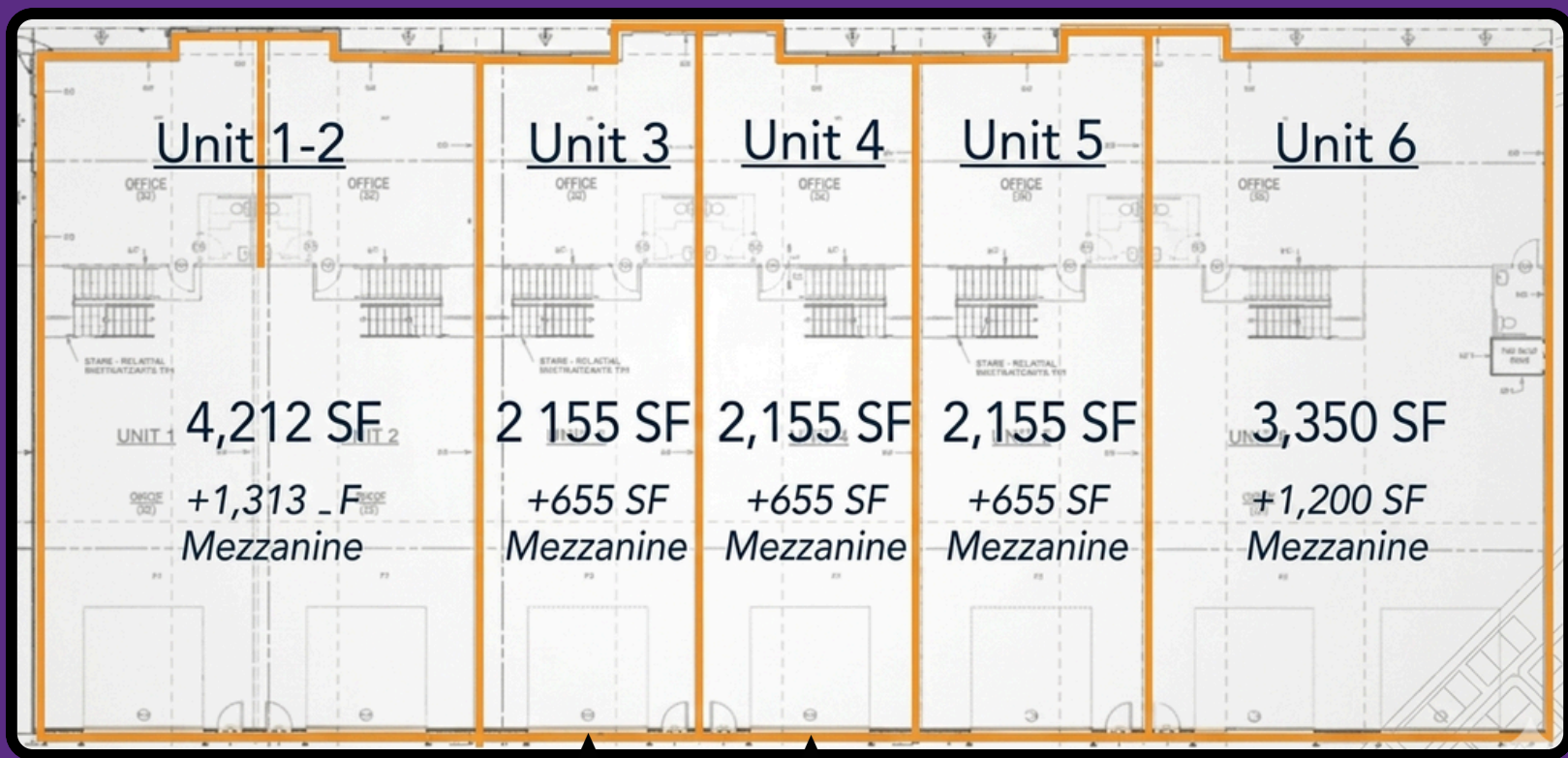

Available!

Mezzanine SqFt Free!!

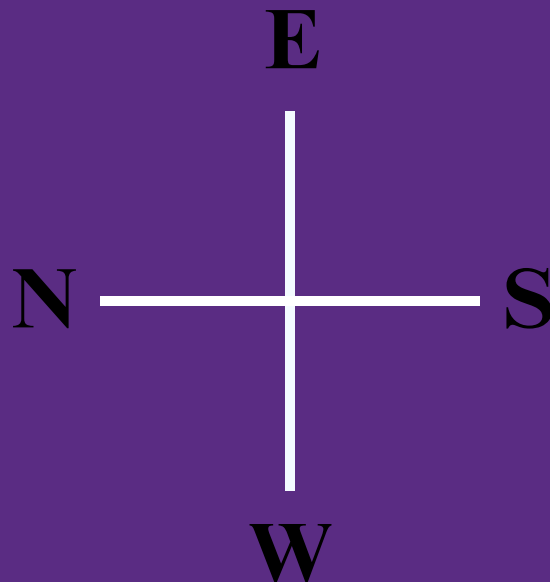

Information contained herein is not guaranteed. Potential purchasers and tenants are advised to verify all information. Price, terms and information are subject to change.



COLLECTIVE
— NOCO PROPERTIES —

PROPERTY SPECIFICATIONS

- **Modern Workspace:** Insulated steel-stud walls, Level 4 drywall finish and grid ceilings.
- **Functional Design:** 20' clear height, (1) 14' overhead Garage Door, and 5" concrete floors including the FREE mezzanine.
- **Full Utilities:** 3-phase power, full AC/HVAC, tankless hot water, and fire sprinklers
- **Turnkey Amenities:** Finished bathrooms and shop-to-office man doors.
- **Parking:** Double parking is allowed in rear trailer spots and behind the doors. Front customer parking is first-come, first-served.
- **Unit 3:** Currently available at a reduced rate as the front entrance remains unfinished.
- **Unit 4:** Move-in ready with a fully finished front entrance.



Information contained herein is not guaranteed. Potential purchasers and tenants are advised to verify all information. Price, terms and information are subject to change.

COLLECTIVE
— NOCO PROPERTIES —

EXTERIOR PHOTOS



Information contained herein is not guaranteed. Potential purchasers and tenants are advised to verify all information. Price, terms and information are subject to change.



COLLECTIVE
— NOCO PROPERTIES —

INTERIOR PHOTOS

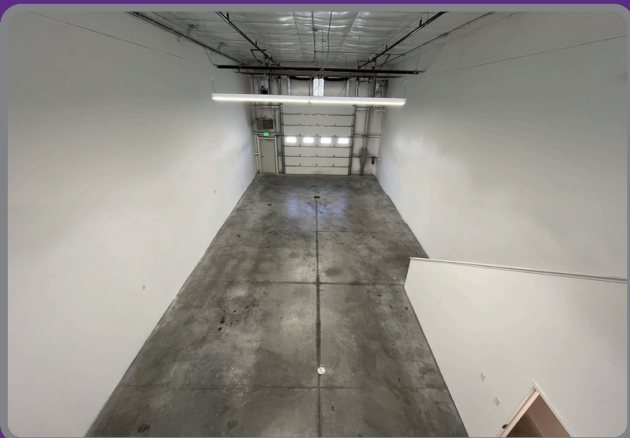

Information contained herein is not guaranteed. Potential purchasers and tenants are advised to verify all information. Price, terms and information are subject to change.

COLLECTIVE
— NOCO PROPERTIES —

MAP LOCATION

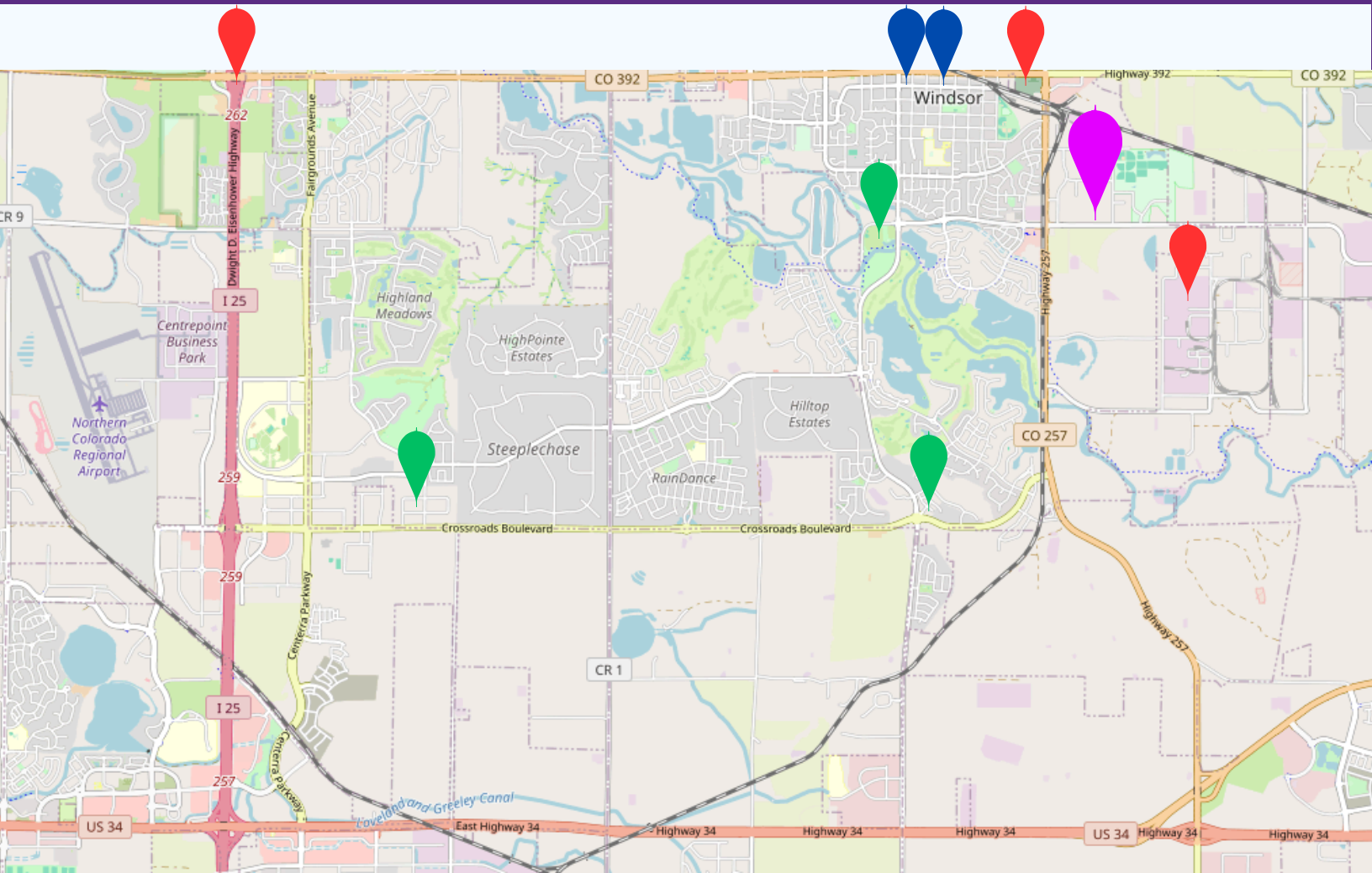

9235 Eastman Park Dr



GlobalAI Data Center, King Soopers Expansion, and I-25.



Eastman Park, Ziggi's Coffee, and Mash Lab Brewing & Kitchen.



The Chamber of Commerce and the Post Office.



Information contained herein is not guaranteed. Potential purchasers and tenants are advised to verify all information. Price, terms and information are subject to change.

COLLECTIVE
— NOCO PROPERTIES —