

# FOR SALE

**WHITNEY**  
Commercial Real Estate Services

## 410 CONESTOGO RD, WATERLOO



### OPPORTUNITY FOR INVESTORS OR OWNER OCCUPIER

This prominent two-storey office building offers a remarkable 38,707 square feet of flexible workspace, designed to accommodate businesses of all kinds seeking an inspiring and adaptable environment. Step inside to experience a bright and airy atmosphere, enhanced by expansive windows that invite an abundance of natural light, fostering creativity and productivity. The property features ample on-site parking, providing convenience for both tenants and visitors.

Join a dynamic and diverse tenant mix within a well-established business community, where collaboration and growth thrive. The strategic location offers excellent signage visibility, ensuring your brand stands out in a competitive market. With easy access to the LRT, Conestoga Mall, Uptown Waterloo, and a wide range of amenities, your business will benefit from unparalleled convenience.

Stay connected with high-speed internet powered by Rogers and Bell fibre optics, allowing for seamless communication and operations. Embrace sustainability with two dedicated EV charging stations on-site, catering to eco-conscious tenants and visitors.

**AVAILABLE SPACE** | 38,707 SF

**LAND AREA** | 2.603 Acres

**NUMBER OF UNITS** | 9

**ZONING** | E2B-27

**ASKING PRICE** | \$9,000,000

**TAXES** | \$192,848.51



# FLOOR PLAN

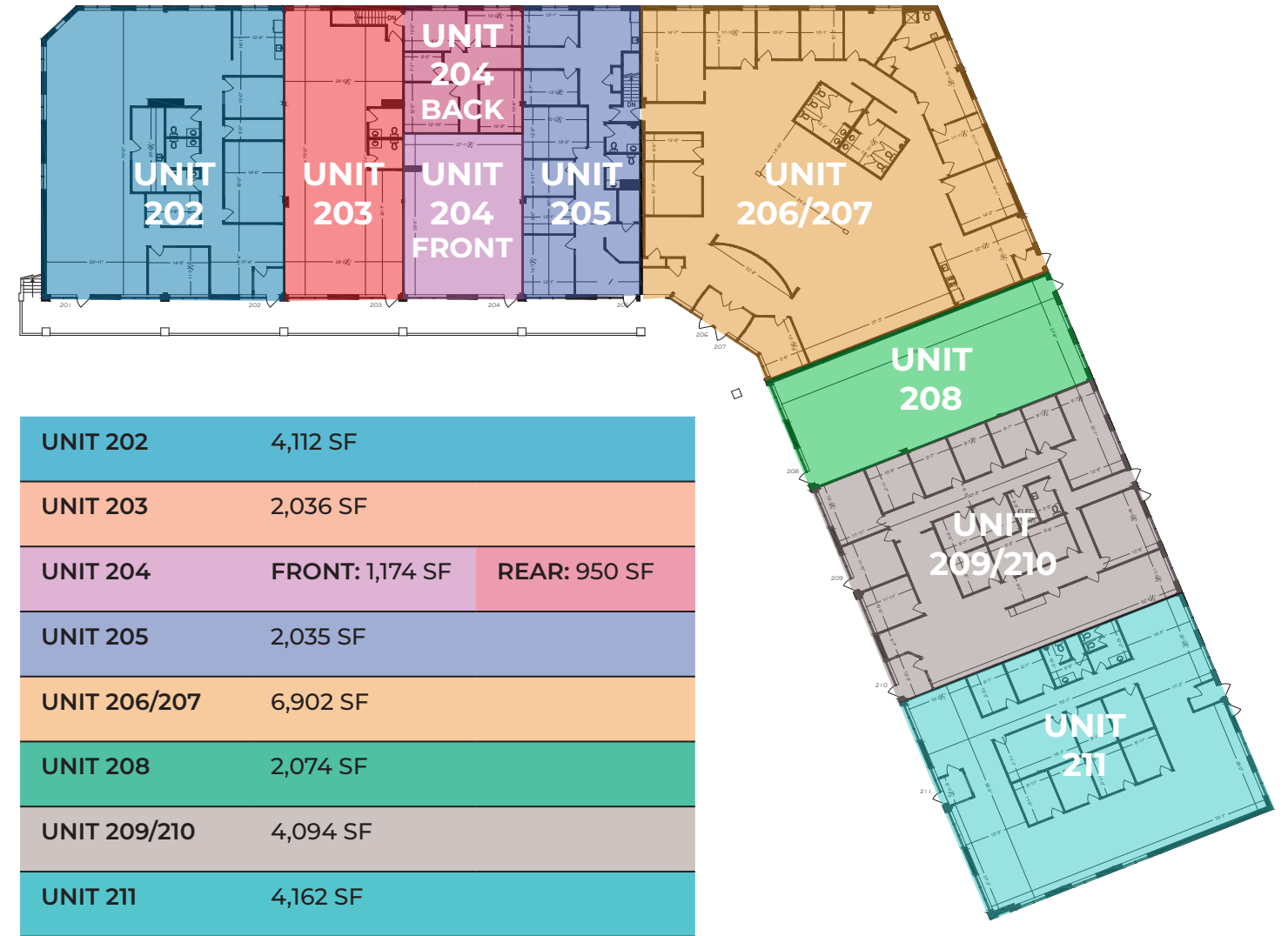

## PERMITTED USES

- Advanced Tech
- Business Incubator
- Communication Production
- Data Centre
- Government Use
- 'Light' Industrial Assembly
- 'Light Industrial Manufacturing
- 'Light' Industrial Processing
- Makerspace (Class A)
- Medical Clinic
- Office
- Printing Establishment
- Tech Office
- Training Facility

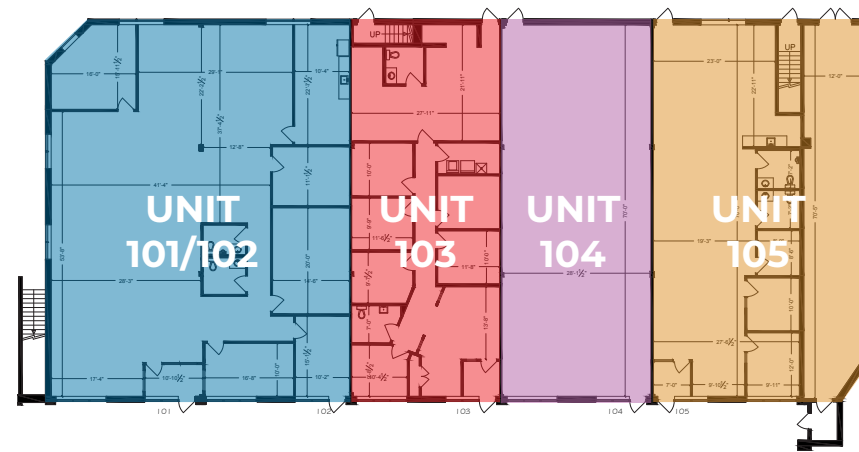

UNIT 101/102	4,087 SF
UNIT 103	2,024 SF
UNIT 104	2,068 SF
UNIT 105	1,942 SF



With close proximity to the LRT, Conestoga Mall, Uptown Waterloo, and a variety of other amenities, this office space is ideally situated to support your business growth. This is an exceptional opportunity to establish your office in a thriving location!

## Contact us for more information



**Ginger Whitney, SIOR, CCIM**  
 Broker, Partner, Vice President  
 519.590.5242  
[ginger.whitney@whitneyre.com](mailto:ginger.whitney@whitneyre.com)



**Jack Hayward**  
 Sales Representative  
 519.270.3314  
[jack.hayward@whitneyre.com](mailto:jack.hayward@whitneyre.com)

**WHITNEY**  
 Commercial Real Estate Services

WHITNEY & Company Realty Limited, Brokerage  
 103 Bauer Place, Suite 2, Waterloo, ON N2L 6B5

519.746.6300 | [www.whitneyre.com](http://www.whitneyre.com)

The information provided herein, including but not limited to images, assumptions, estimates, and descriptions (the "Information"), is obtained from sources considered reliable. However, WHITNEY & Company Realty Limited ("Whitney") and its representatives, agents, or brokers do not warrant, guarantee, or make any representations as to the accuracy, correctness, or completeness of the Information. Whitney disclaims any liability or responsibility for the information or for any reliance the recipient places upon it. Recipients are advised to perform their own due diligence to verify the Information before relying on it. The Information is subject to change, and any property referenced herein may be withdrawn from the market at any time without prior notice. Property outlines are approximate and may not represent actual boundaries. All Rights Reserved. © Whitney & Company Realty Limited, Brokerage - 2025

\*\*Broker \*Sales Representative