



OFFICE AVAILABLE FOR LEASE

**5110 GRANITE STREET  
LOVELAND, CO 80538**





# PROPERTY HIGHLIGHTS

Unit A at 5110 Granite Street in Loveland is a recently updated, turnkey end-cap suite located within a well-maintained multi-tenant building comprised of four private units. This highly functional space features five private offices, an open work area ideal for collaborative use, a large conference or training room, a kitchenette/break room, and a private restroom. The end-cap location provides added privacy and natural light, making the suite well suited for a variety of professional or office users seeking a move-in-ready space in a convenient Loveland location.

Available Size:	Suite A; 1,917 SF
-----------------	-------------------

Lease Rate:	\$15.00/SF NNN
-------------	----------------

NNN Est. Expenses:	\$7.24/SF
--------------------	-----------

Building Size:	7,880 SF; 4 total units
----------------	-------------------------

Offices:	5 private offices
----------	-------------------

Available Date:	Now
-----------------	-----



5110 GRANITE STREET, LOVELAND, CO 80538



GRANITE STREET

N GARFIELD AVENUE (30,376 VPD)

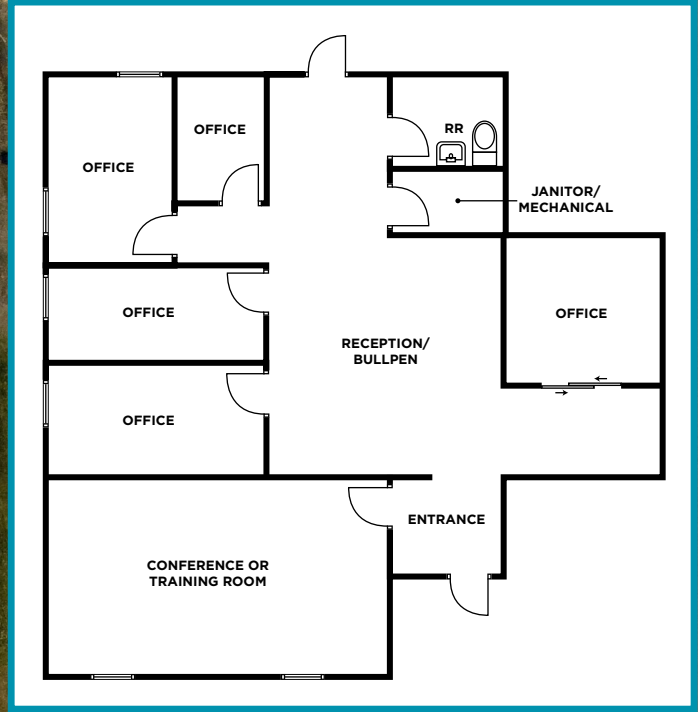

5110 GRANITE STREET, LOVELAND, CO 80538

1,917 TOTAL SF





## CONTACT

### Tyler Murray

Senior Director

+1 970 267 7404

tyler.murray@cushwake.com

### Ty Mashek

Senior Associate

+1 303 525 3125

ty.mashek@cushwake.com



**CUSHMAN &  
WAKEFIELD**

772 Whalers Way, Suite 200

Fort Collins, CO 80525

+1 970 776 3900

**cushmanwakefield.com**

©2025 Cushman & Wakefield. All rights reserved. The information contained in this communication is strictly confidential. This information has been obtained from sources believed to be reliable but has not been verified. NO WARRANTY OR REPRESENTATION, EXPRESS OR IMPLIED, IS MADE AS TO THE CONDITION OF THE PROPERTY (OR PROPERTIES) REFERENCED HEREIN OR AS TO THE ACCURACY OR COMPLETENESS OF THE INFORMATION CONTAINED HEREIN, AND SAME IS SUBMITTED SUBJECT TO ERRORS, OMISSIONS, CHANGE OF PRICE, RENTAL OR OTHER CONDITIONS, WITHDRAWAL WITHOUT NOTICE, AND TO ANY SPECIAL LISTING CONDITIONS IMPOSED BY THE PROPERTY OWNER(S). ANY PROJECTIONS, OPINIONS OR ESTIMATES ARE SUBJECT TO UNCERTAINTY AND DO NOT SIGNIFY CURRENT OR FUTURE PROPERTY PERFORMANCE