

FOR LEASE

# LITTLE TOKYO SHOPPING CENTER

333 S ALAMEDA ST, LOS ANGELES, CA 90013

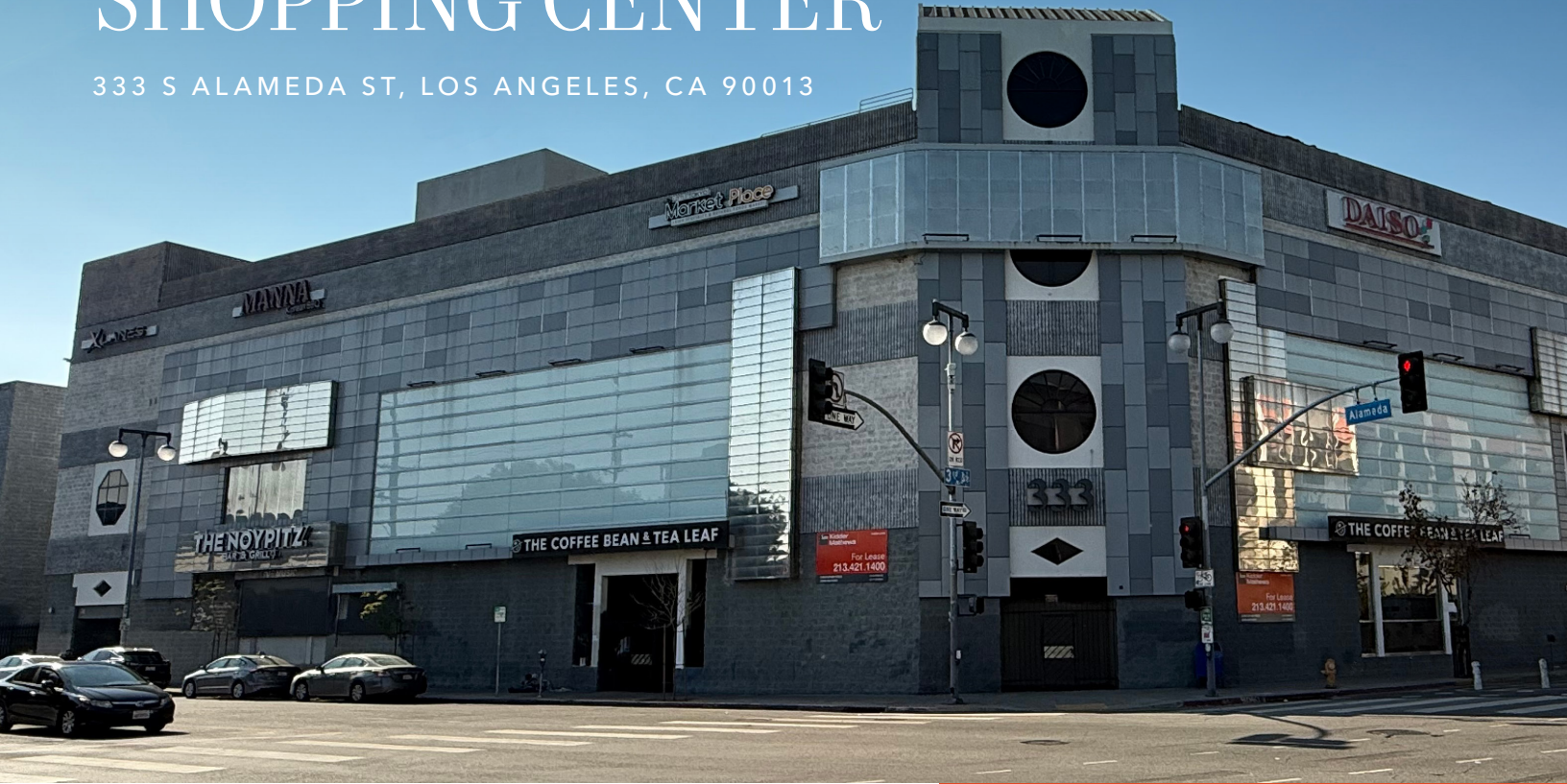

*Prime Retail Leasing Opportunity in the  
Heart of Little Tokyo.*

## SUITE AVAILABILITY

Unit #	Total SF
109	1,100
200	42,000
206	3,068
212	1,189

**JOHN ANTHONY, SIOR**  
213.225.7218  
john.anthony@kidder.com  
LIC N° 01226464

**CHRISTOPHER STECK, CCIM**  
213.225.7231  
christopher.steck@kidder.com  
LIC N° 01841338

[KIDDER.COM](http://KIDDER.COM)

This information supplied herein is from sources we deem reliable. It is provided without any representation, warranty, or guarantee, expressed or implied as to its accuracy. Prospective Buyer or Tenant should conduct an independent investigation and verification of all matters deemed to be material, including, but not limited to, statements of income and expenses. Consult your attorney, accountant, or other professional advisor.

 **Kidder  
Mathews**

# 1ST FLOOR PLAN

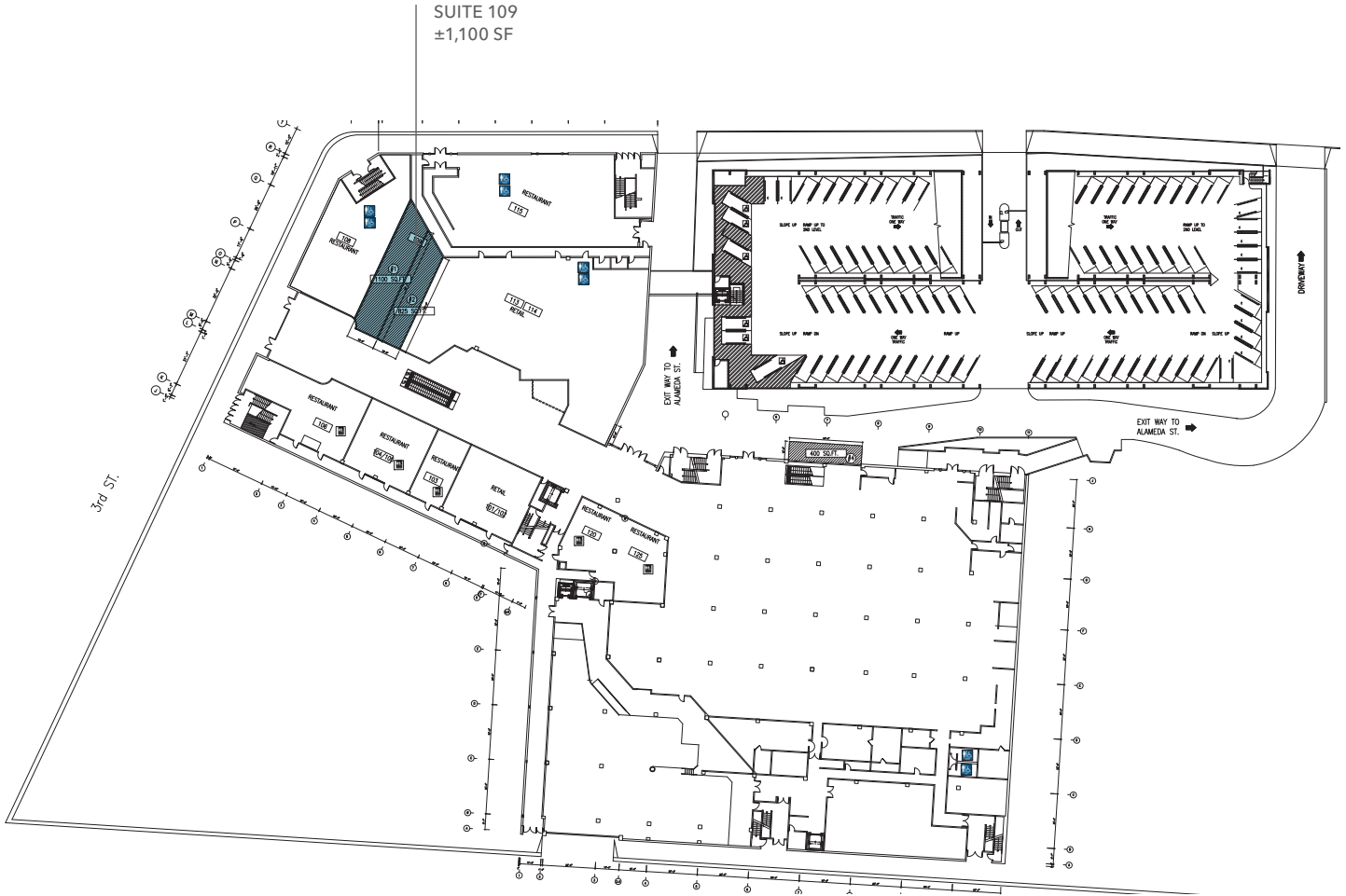

**JOHN ANTHONY, SIOR**  
213.225.7218  
john.anthony@kidder.com  
LIC N° 01226464

**CHRISTOPHER STECK, CCIM**  
213.225.7231  
christopher.steck@kidder.com  
LIC N° 01841338

**KIDDER.COM**

This information supplied herein is from sources we deem reliable. It is provided without any representation, warranty, or guarantee, expressed or implied as to its accuracy. Prospective Buyer or Tenant should conduct an independent investigation and verification of all matters deemed to be material, including, but not limited to, statements of income and expenses. Consult your attorney, accountant, or other professional advisor.



# 2ND FLOOR PLAN

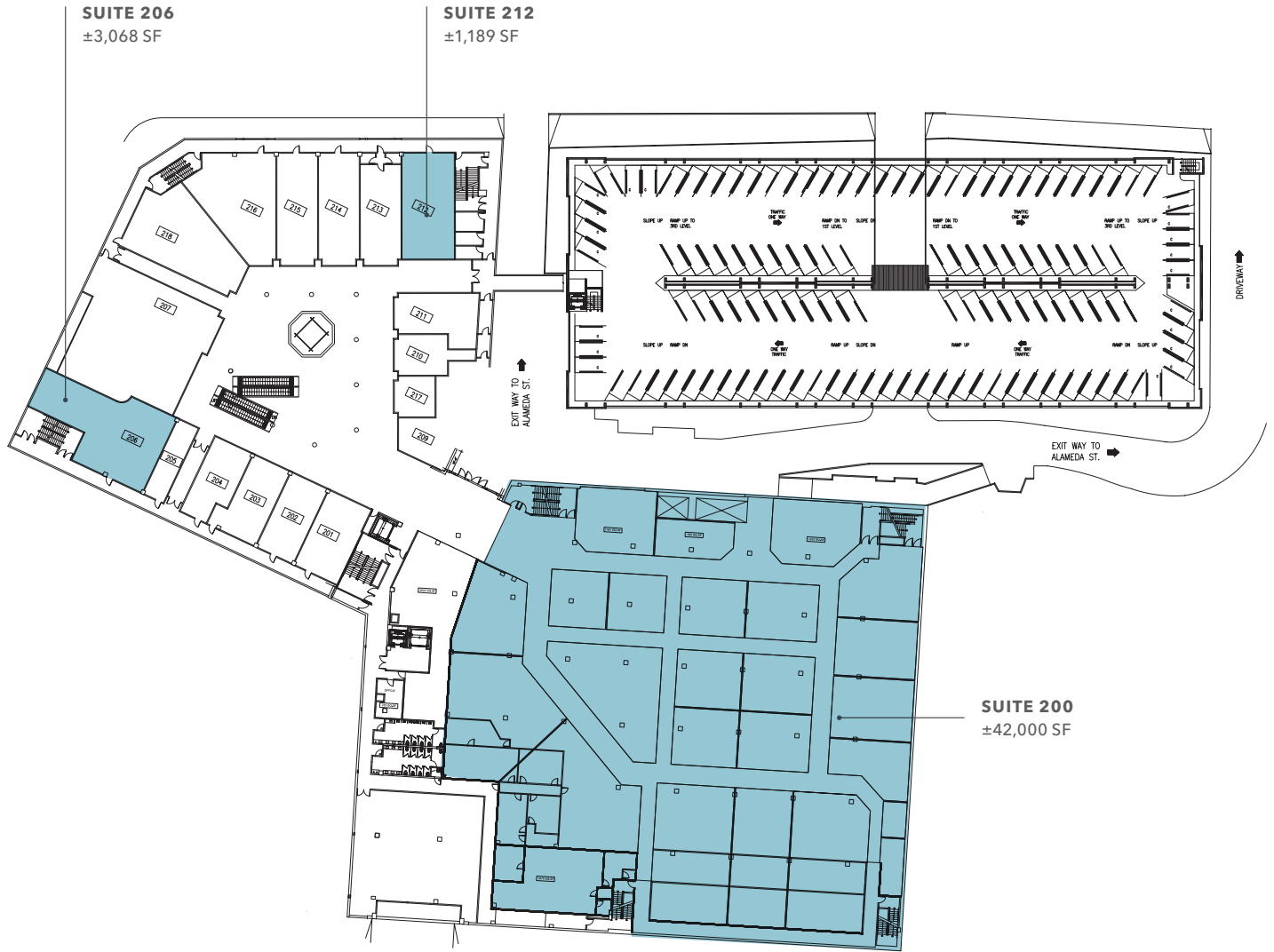

**JOHN ANTHONY, SIOR**  
213.225.7218  
john.anthony@kidder.com  
LIC N° 01226464

**CHRISTOPHER STECK, CCIM**  
213.225.7231  
christopher.steck@kidder.com  
LIC N° 01841338

**KIDDER.COM**

This information supplied herein is from sources we deem reliable. It is provided without any representation, warranty, or guarantee, expressed or implied as to its accuracy. Prospective Buyer or Tenant should conduct an independent investigation and verification of all matters deemed to be material, including, but not limited to, statements of income and expenses. Consult your attorney, accountant, or other professional advisor.



# 3RD FLOOR PLAN

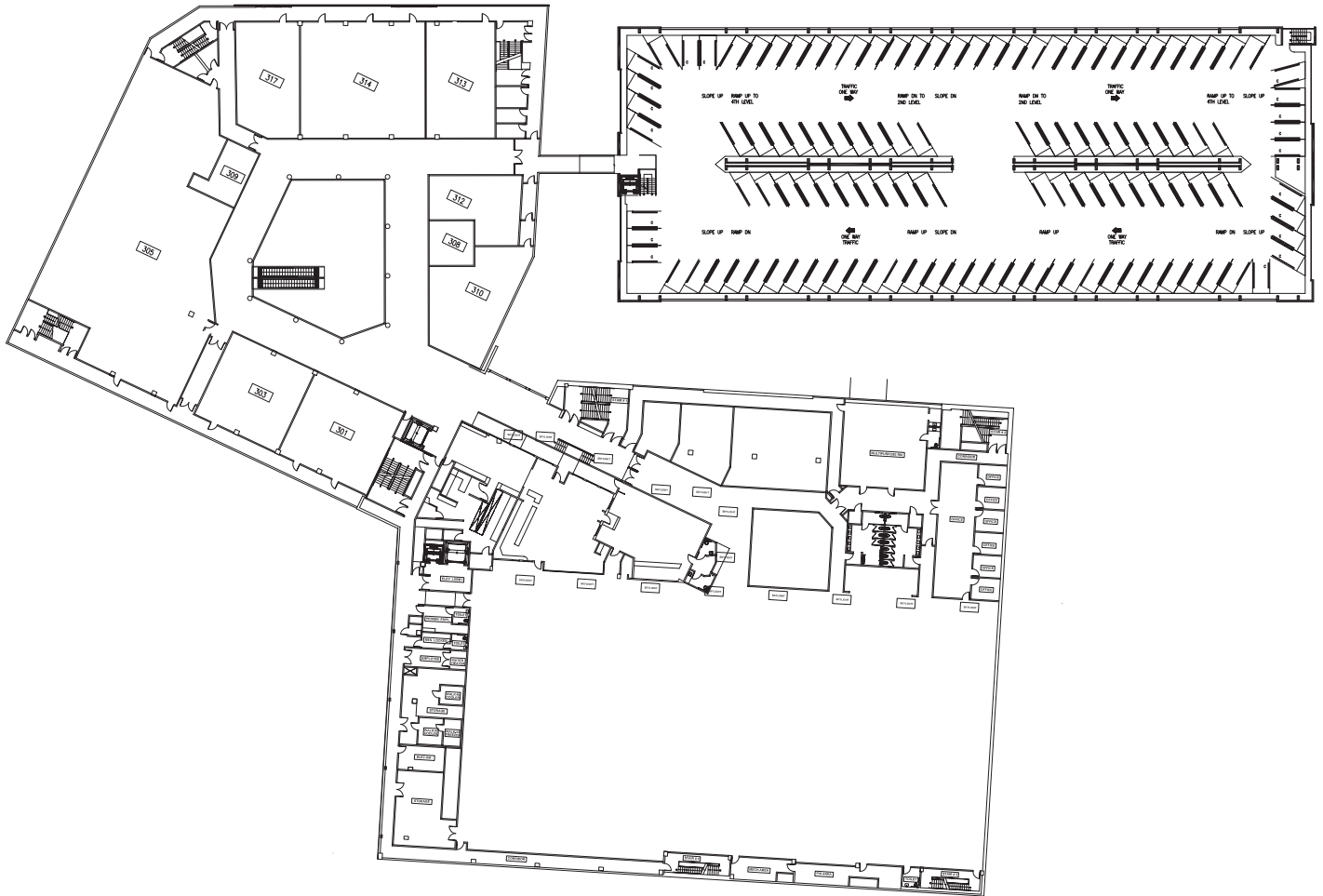

**JOHN ANTHONY, SIOR**  
213.225.7218  
john.anthony@kidder.com  
LIC N° 01226464

**CHRISTOPHER STECK, CCIM**  
213.225.7231  
christopher.steck@kidder.com  
LIC N° 01841338

**KIDDER.COM**

This information supplied herein is from sources we deem reliable. It is provided without any representation, warranty, or guarantee, expressed or implied as to its accuracy. Prospective Buyer or Tenant should conduct an independent investigation and verification of all matters deemed to be material, including, but not limited to, statements of income and expenses. Consult your attorney, accountant, or other professional advisor.





[KIDDER.COM](https://www.kidder.com)

This information supplied herein is from sources we deem reliable. It is provided without any representation, warranty, or guarantee, expressed or implied as to its accuracy. Prospective Buyer or Tenant should conduct an independent investigation and verification of all matters deemed to be material, including, but not limited to, statements of income and expenses. Consult your attorney, accountant, or other professional advisor.



[KIDDER.COM](http://KIDDER.COM)

This information supplied herein is from sources we deem reliable. It is provided without any representation, warranty, or guarantee, expressed or implied as to its accuracy. Prospective Buyer or Tenant should conduct an independent investigation and verification of all matters deemed to be material, including, but not limited to, statements of income and expenses. Consult your attorney, accountant, or other professional advisor.





[KIDDER.COM](http://KIDDER.COM)

This information supplied herein is from sources we deem reliable. It is provided without any representation, warranty, or guarantee, expressed or implied as to its accuracy. Prospective Buyer or Tenant should conduct an independent investigation and verification of all matters deemed to be material, including, but not limited to, statements of income and expenses. Consult your attorney, accountant, or other professional advisor.



## Demographics

TOTAL RESIDENTIAL UNITS	<b>106,284</b>	SF OF RETAIL SPACE UNDER CONSTRUCTION	<b>24.2K</b>
RESIDENTIAL UNITS UNDER CONSTRUCTION	<b>10,433</b>	HOTEL ROOMS UNDER CONSTRUCTION	<b>249</b>
UNITS IN THE PIPELINE	<b>246,062</b>	MEDIAN AGE	<b>35</b>
SF OF OFFICE SPACE	<b>99.8+ million</b>	ESTIMATED 2019 RESIDENTIAL POPULATION	<b>776,058</b>
SF OF OFFICE SPACE UNDER CONSTRUCTION	<b>23.7K</b>	AVERAGE HH INCOME	<b>\$93,805</b>

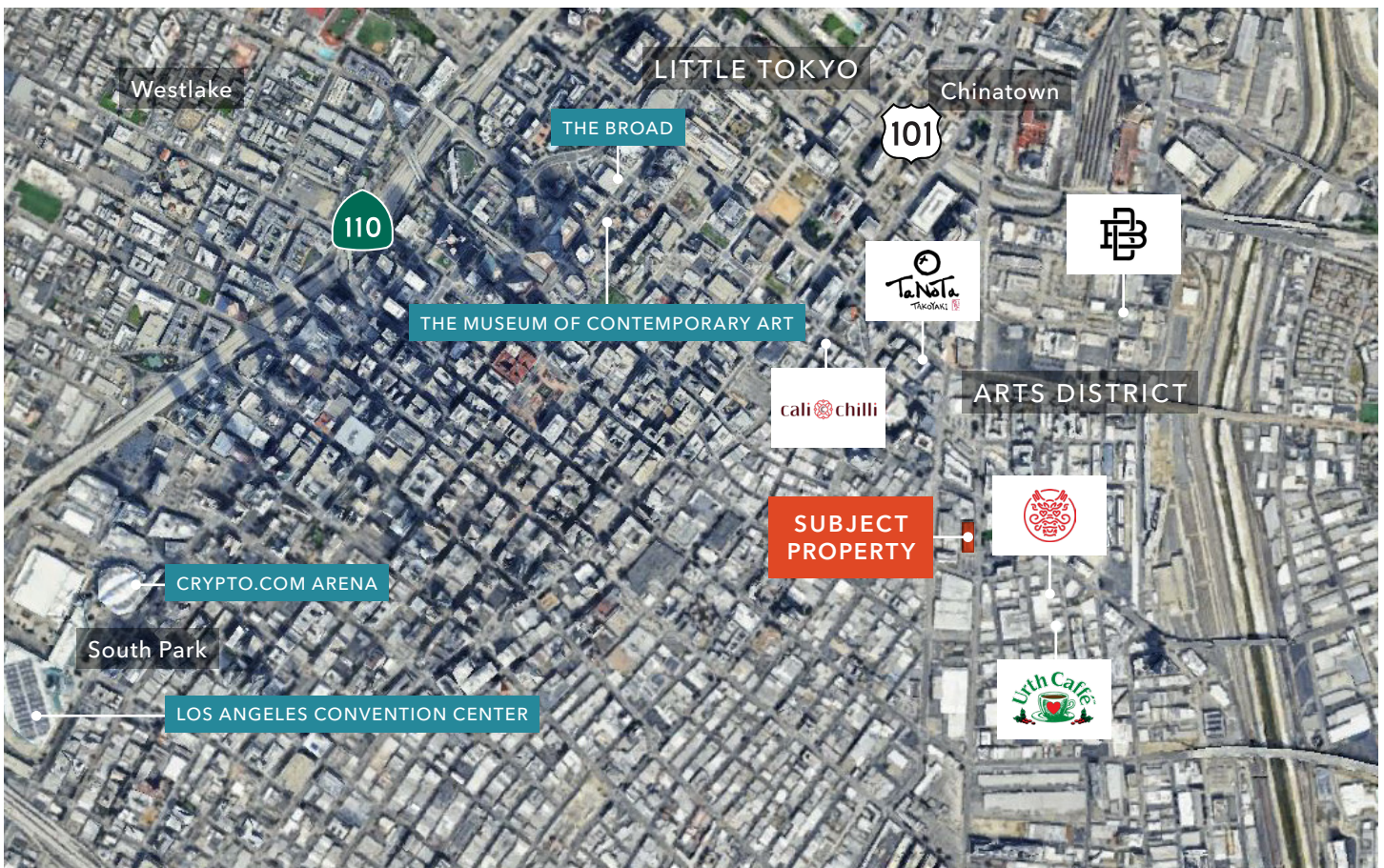



# LITTLE TOKYO, LOS ANGELES, CA

Little Tokyo, known as the Little Tokyo Historic District, is a culturally significant Japanese-American neighborhood located in downtown Los Angeles. The Little Tokyo area is situated on the eastern edge of Downtown Los Angeles, north of the Arts District. Little Tokyo District is a vibrant urban area that enhances the standard of living for its residents, creative professionals, and businesses. The urban neighborhood is located on the east side of Downtown, bordered by the Los Angeles River to the west, Alameda Street leading into The Arts District to the north, and Interstate 10 (I-10) to the south.

An innovative urban Asian community is thriving in downtown Los Angeles' Little Tokyo District. This area has experienced a resurgence, featuring a mix of luxury urban homes, live/work lofts, and a vibrant collection of premier breweries, art galleries, restaurants, shops, and creative office spaces. It is ideal for both work and leisure activities because of its excellent location and easy access to public transit. Little Tokyo's growth as a significant regional center for housing, jobs, and culture is accelerating, fueled by many ongoing and upcoming public and private projects.

## 5-Mile Demographics

**776,058**  
ESTIMATED POPULATION

**234,433**  
DAYTIME EMPLOYMENT

**\$93,805**  
AVERAGE HH INCOME)

**672,339**  
DAYTIME POPULATION



**JOHN ANTHONY, SIOR**  
213.225.7218  
john.anthony@kidder.com  
LIC N° 01226464

**CHRISTOPHER STECK, CCIM**  
213.225.7231  
christopher.steck@kidder.com  
LIC N° 01841338

**KIDDER.COM**

This information supplied herein is from sources we deem reliable. It is provided without any representation, warranty, or guarantee, expressed or implied as to its accuracy. Prospective Buyer or Tenant should conduct an independent investigation and verification of all matters deemed to be material, including, but not limited to, statements of income and expenses. Consult your attorney, accountant, or other professional advisor.

