



TWO OFFICE  
SUITES AVAILABLE  
AMPLE PARKING  
HANDICAP ACCESS

## NORTHSIDE/AUSTELL MEDICAL OFFICE BUILDING

1688 MULKEY RD, AUSTELL, GA 30106  
SUITE G 1,237 SF - SUITE H 1,427

### PROPERTY HIGHLIGHTS

- DIRECT FIRST-FLOOR ACCESS FOR PATIENTS AND STAFF
- EXCELLENT VISIBILITY AND SIGNAGE POTENTIAL
- POSITIONED IN A DENSE RESIDENTIAL AND HEALTHCARE-DRIVEN AREA
- HIGHLY FLEXIBLE MEDICAL/DENTAL/CHIROPRACTIC USE
- CONVENIENT PARKING WITH EASY IN/OUT ACCESS
- MINUTES TO WELLSTAR COBB HOSPITAL, MAJOR CORRIDORS, AND REGIONAL RETAIL



### CONTACT

Leo Griffin | 404.793.1617  
lgriffin@perimetercre.com

SUITE G  
1,237 SF

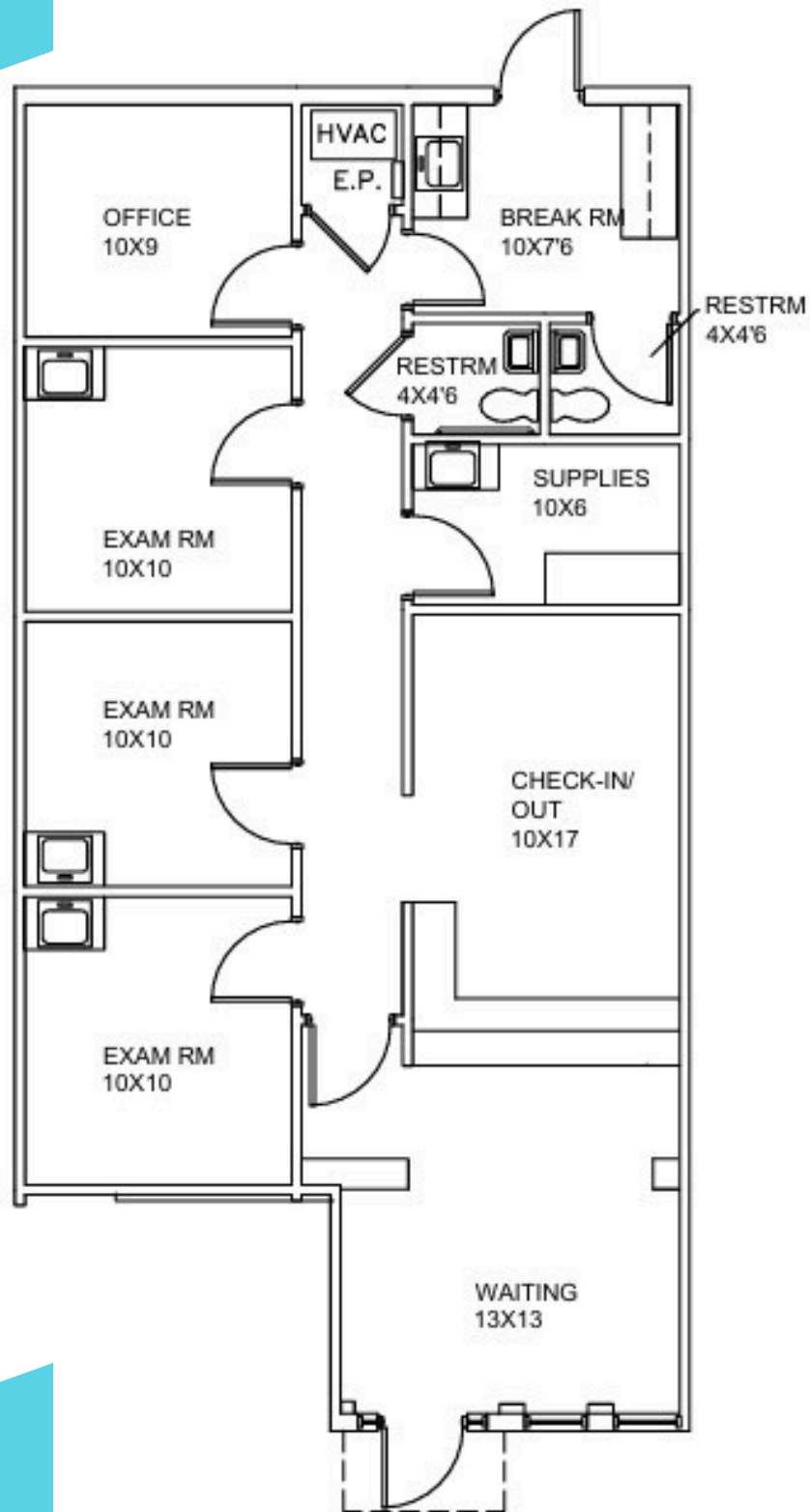

MEDICAL  
OFFICE SPACE

SUITE H  
1,427 SF

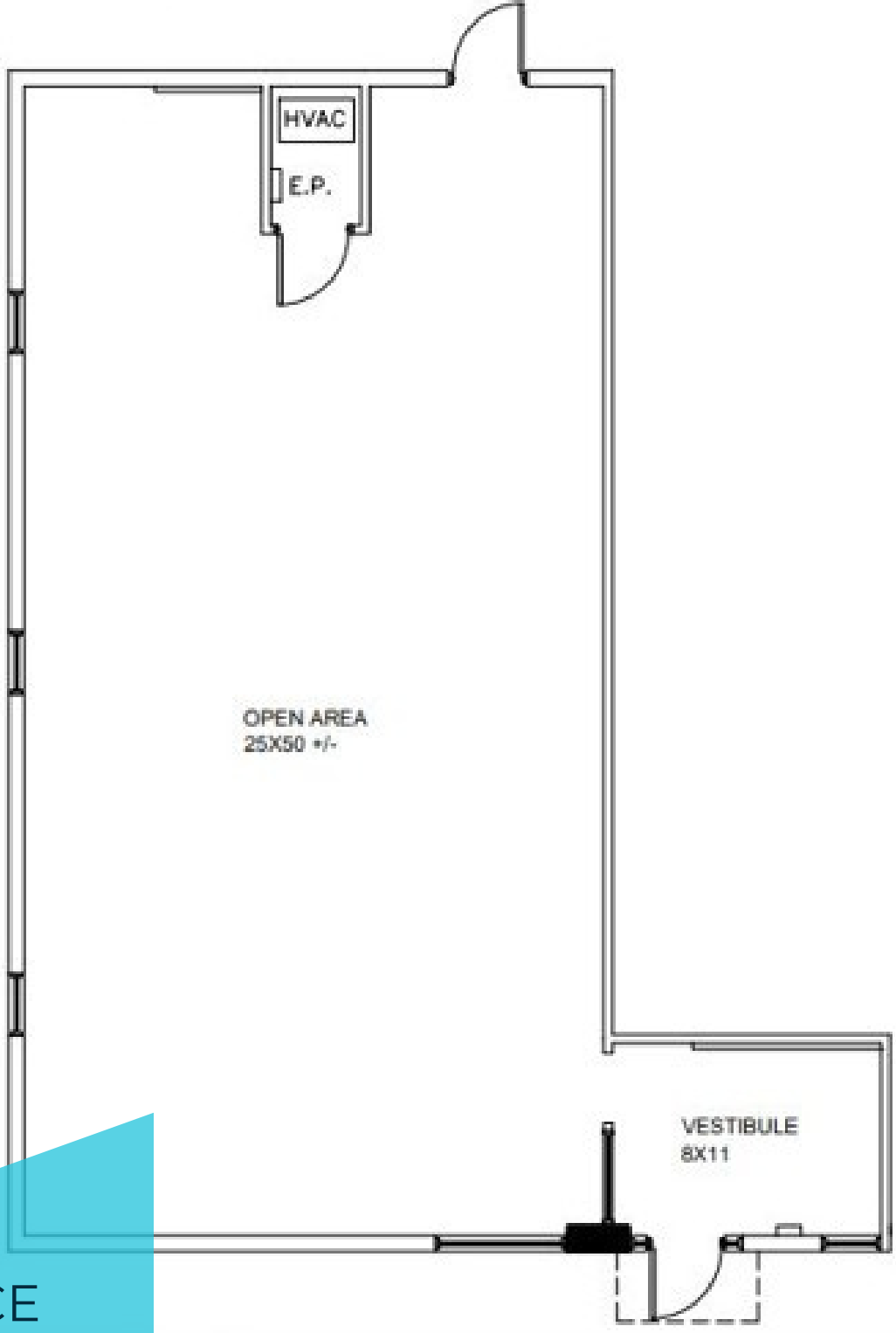

OFFICE  
SPACE

FIRST FLOOR  
MEDICAL OFFICE  
SUITES

SUITE G - 1,237 SF  
SUITE H - 1,427 SF

📍 **NORTHSIDE/AUSTELL  
MEDICAL OFFICE BUILDING**

1688 MULKEY RD  
AUSTELL, GA 30106  
SUITE G 1,237 SF - SUITE H 1,427

