



Kyle Selby, MSRE
kselby@selbyrealty.com
(386) 295-3313



**SELBY
REALTY**

200 E. Granada Blvd., Suite 207
Ormond Beach, FL 32176
(386) 238-4456 O.
(386) 238.8377 F.

13,000SF—25,000SF RETAIL SPACE FOR LEASE



333 W. Granada Blvd., UNIT 200 Ormond Beach, FL 32174

Property Highlights

- 333 West Granada— Multi-Tenant Retail Business Center
- Available space could be subdivided between 13,000sf and as large as 25,000sf.
- 20'+ Ceiling Height
- The red outline on the picture to the right is approximately 13,000SF and the blue is approximately 25,000SF
- Frontage of 13,000sf portion (red) is 84'. Depth is 155'.

Property Details

Site:	Highly Visible and Well-Known Plaza Located between US1 and Nova Rd. on the most desirable commercial corridor in Ormond Beach.
Building:	Single-story, Multi-Tenant Retail Building
Parking:	On-site parking lot
Unit 200:	13,000SF—25,000SF of move-in ready space
Rate:	\$19.50/SF NNN
Passthroughs:	Estimated to be \$4.14
Signage:	Building and monument signage
Zoning:	B-10, Central Business, City of Ormond Beach
Traffic:	36,000 (AADT 2020)
Location:	Granada Blvd (St. Rt. 40), 1 block West of A1A
Food Nearby:	Moe's, Jimmy John's, Wendy's, La Catrina Mexican, & many others
Availability:	October 2025

333 W GRANADA UNIT 100 FLOOR PLAN

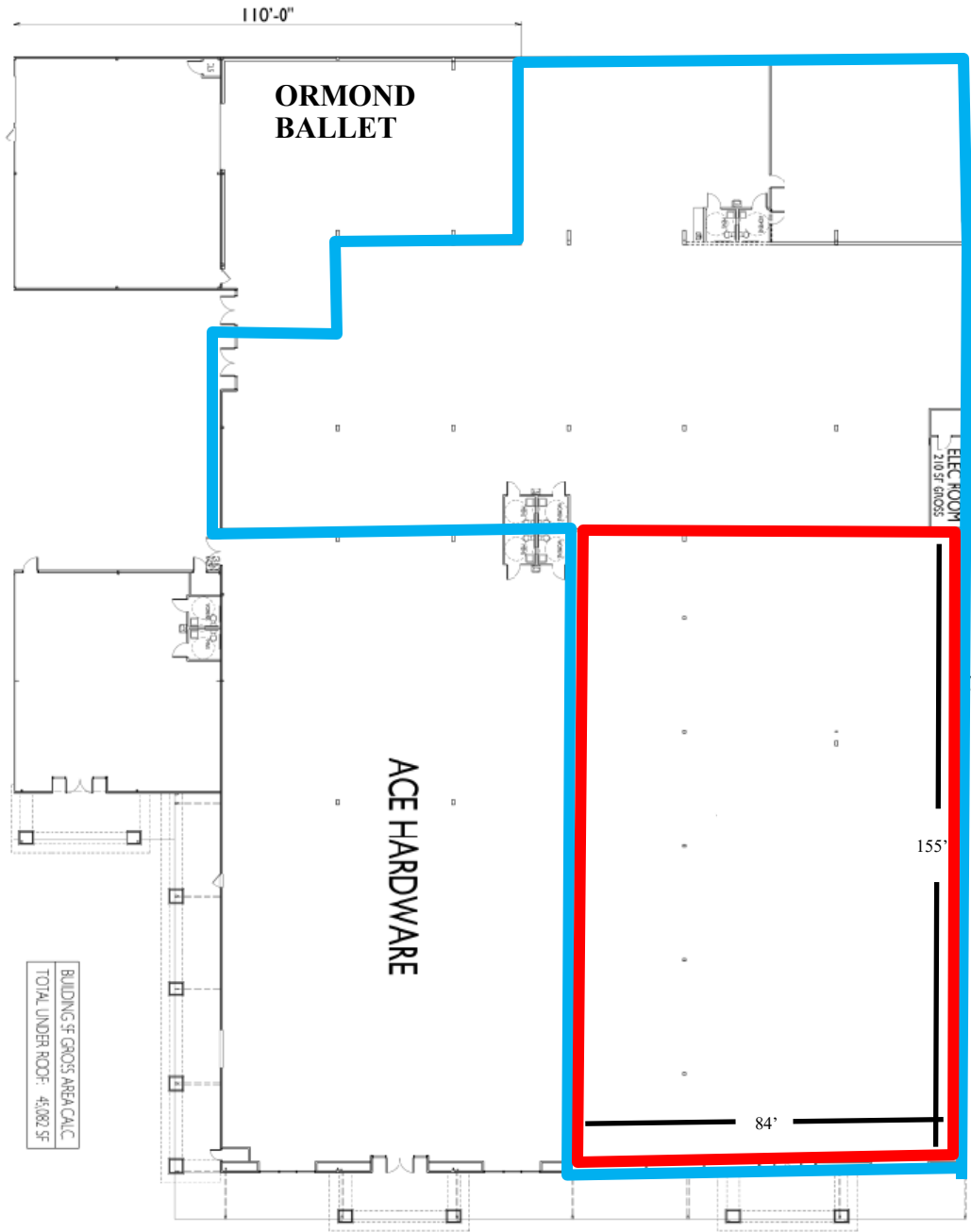

333 W. GRANADA UNIT 200 PROPERTY MAP

