

# FOR LEASE Industrial Suites

10027-10031 PROSPECT AVE, SANTEE, CA 92071

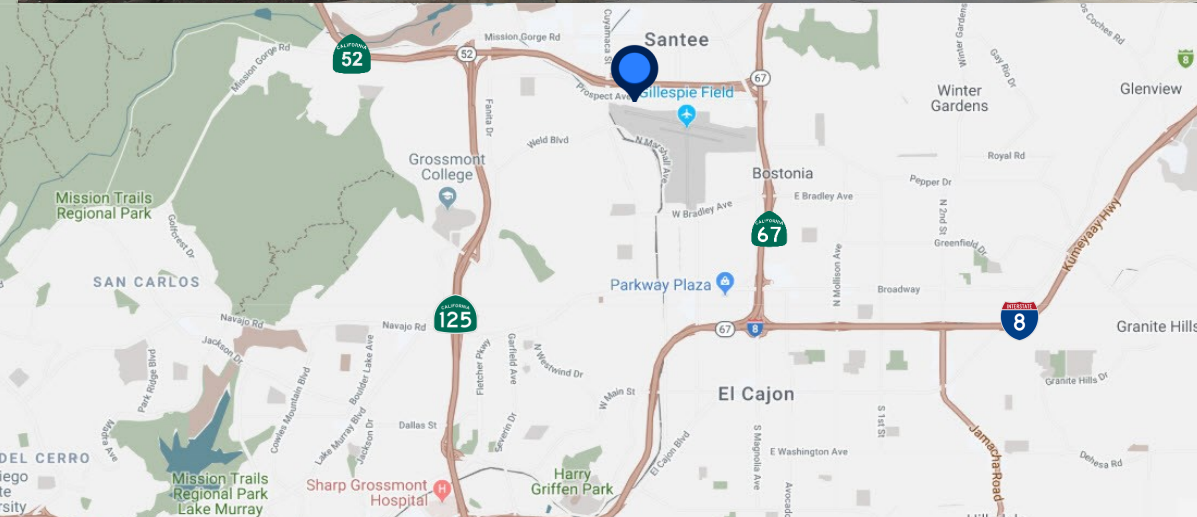

## Available

10027-A Prospect Ave: ± 1,212 SF Industrial Suite

10027-F Prospect Ave: ± 2,181 SF Industrial Suite

## Property Features

- Located Near Highway 52 & 67 Interchange
- City of Santee General Industrial Zoning
- Fire Sprinklers

Ken Robak | Lic. 01236527  
Vice President of Brokerage  
Tel (619) 469-3600  
Ken@PacificCoastCommercial.com

Nick Mane | Lic. 01939391  
Associate Vice President  
Tel (760) 840-7140  
Nick@PacificCoastCommercial.com

Jasmine Golia | Lic. 02131001  
Sales & Leasing Associate  
Tel (858) 337-7311  
Jasmine@PacificCoastCommercial.com

**PACIFIC COAST COMMERCIAL** | 10721 Treena St., Suite 200, San Diego, CA 92131 | Tel. 619.469.3600 | www.PacificCoastCommercial.com  
Disclaimer: The information contained herein has been given to us by the owner of the property or other sources we deem reliable, we have no reason to doubt its accuracy, but we do not guarantee it. All information, including zoning and use, should be verified prior to transaction. Lic. 01209930

  
**PACIFIC COAST  
COMMERCIAL**  
SALES - MANAGEMENT - LEASING

  
**ROBAK  
GROUP**

FOR LEASE

# Industrial Suites

10027-10031 PROSPECT AVE, SANTEE, CA 92071

## 10027-A Prospect Ave

- ± 1,212 SF Industrial Suite
- 1 Private Office
- 1 Private Restroom
- Grade Level Door
- Lease Rate: \$2,300 Per Month, Modified Gross
- Available February 1, 2025
- **Do Not Disturb Tenant**

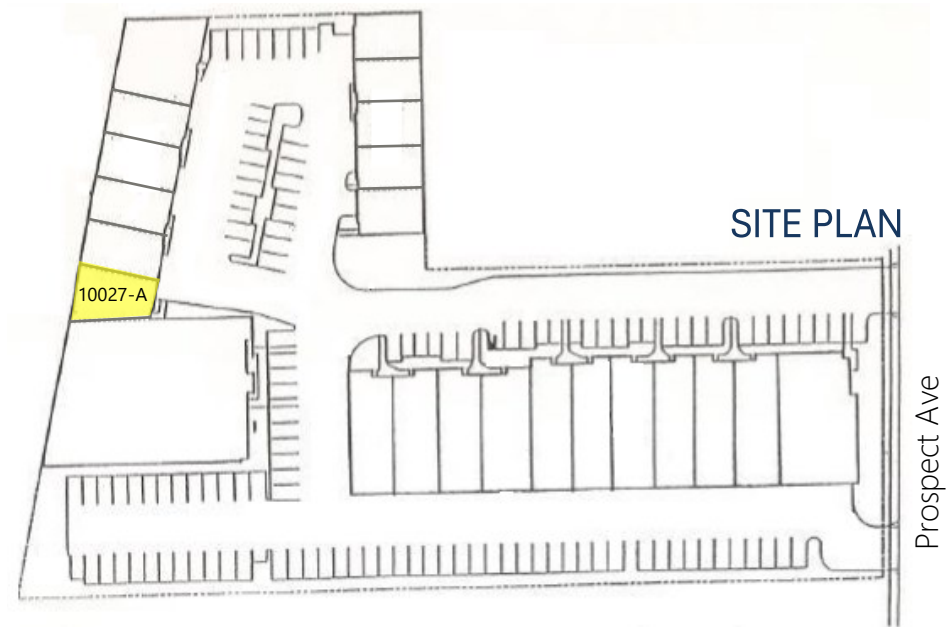
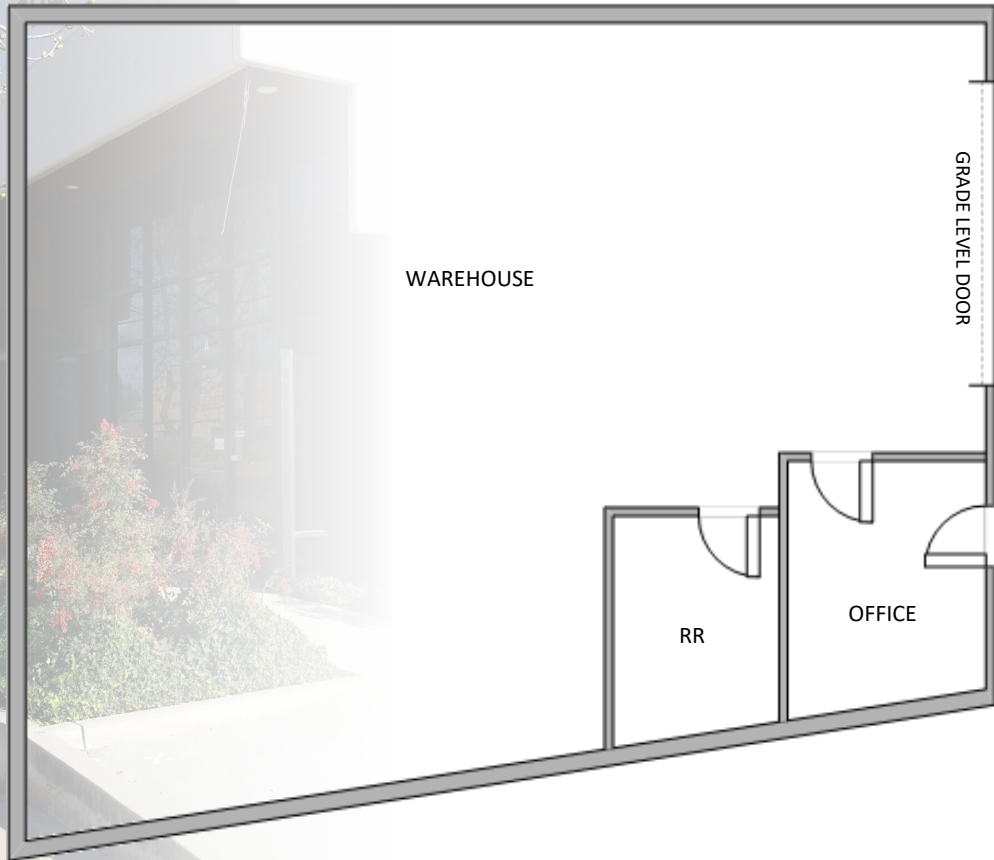

Floor Plan and Site Plan are not to scale; for reference purposes only.

Ken Robak | Lic. 01236527  
Vice President of Brokerage  
Tel (619) 469-3600  
Ken@PacificCoastCommercial.com

Nick Mane | Lic. 01939391  
Associate Vice President  
Tel (760) 840-7140  
Nick@PacificCoastCommercial.com

Jasmine Golia | Lic. 02131001  
Sales & Leasing Associate  
Tel (858) 337-7311  
Jasmine@PacificCoastCommercial.com

**PACIFIC COAST COMMERCIAL** | 10721 Treena St., Suite 200, San Diego, CA 92131 | Tel. 619.469.3600 | www.PacificCoastCommercial.com  
Disclaimer: The information contained herein has been given to us by the owner of the property or other sources we deem reliable, we have no reason to doubt its accuracy, but we do not guarantee it. All information, including zoning and use, should be verified prior to transaction. Lic. 01209930



FOR LEASE

# Industrial Suites

10027-10031 PROSPECT AVE, SANTEE, CA 92071

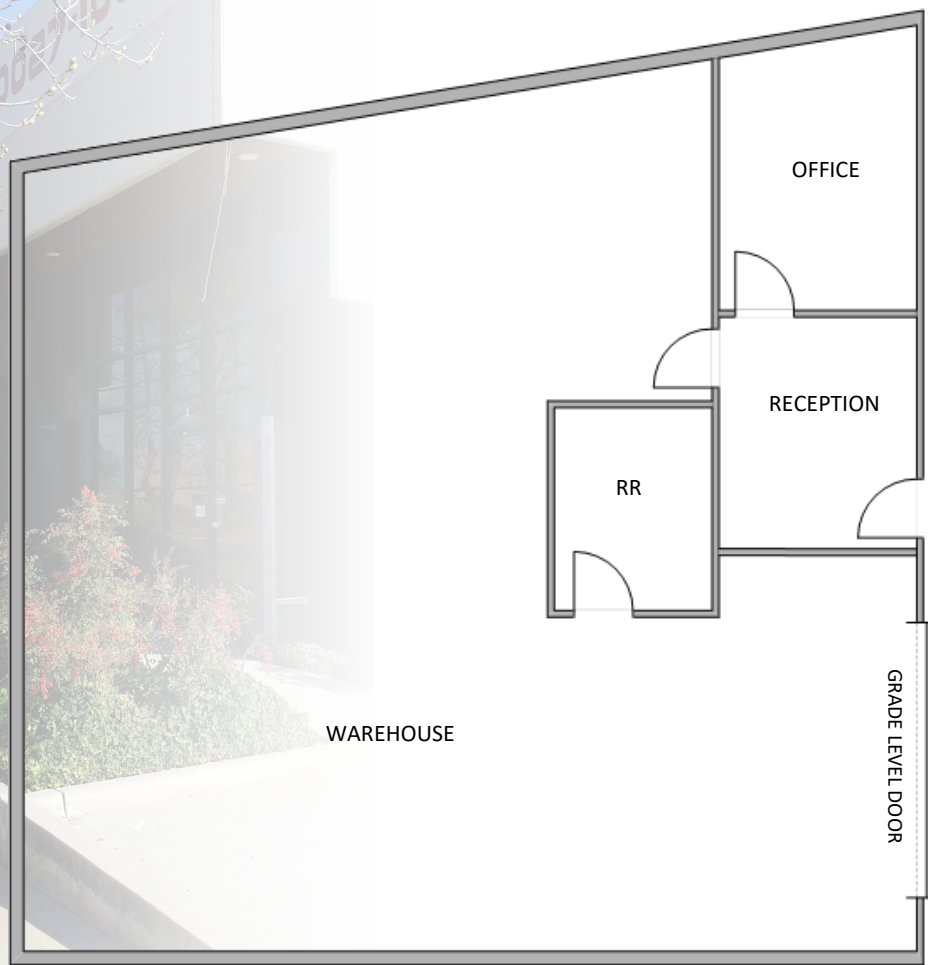

## 10027-F Prospect Ave

- ± 2,181 SF Industrial Suite
- Reception
- 1 Private Office
- 1 Private Restroom
- Grade Level Door
- Lease Rate: \$4,200 Per Month, Modified Gross
- Available February 1, 2025
- **Do Not Disturb Tenant**

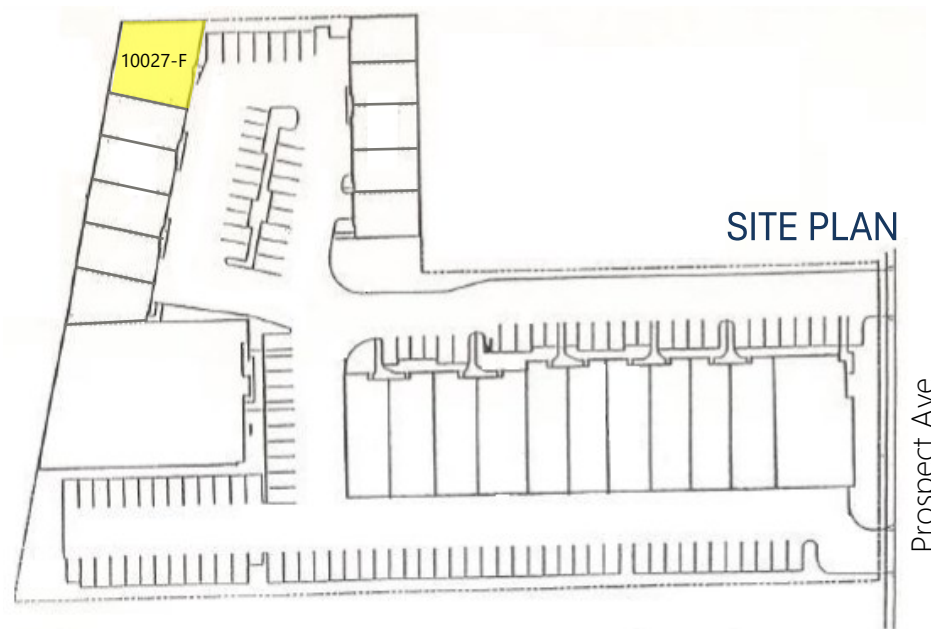

Floor Plan and Site Plan are not to scale; for reference purposes only.

Ken Robak | Lic. 01236527  
Vice President of Brokerage  
Tel (619) 469-3600  
Ken@PacificCoastCommercial.com

Nick Mane | Lic. 01939391  
Associate Vice President  
Tel (760) 840-7140  
Nick@PacificCoastCommercial.com

Jasmine Golia | Lic. 02131001  
Sales & Leasing Associate  
Tel (858) 337-7311  
Jasmine@PacificCoastCommercial.com

**PACIFIC COAST COMMERCIAL** | 10721 Treena St., Suite 200, San Diego, CA 92131 | Tel. 619.469.3600 | www.PacificCoastCommercial.com  
Disclaimer: The information contained herein has been given to us by the owner of the property or other sources we deem reliable, we have no reason to doubt its accuracy, but we do not guarantee it. All information, including zoning and use, should be verified prior to transaction. Lic. 01209930

