

1524 A FREEDOM AVE

INDUSTRIAL PROPERTY FOR LEASE | CALDWELL, ID



CONTACT

GAVIN PHILLIPS, SIOR
208.401.4101
gavin@tokcommercial.com

HIGHLIGHTS

- Fully paved and fenced yard.
- Excellent I-84 access.
- 80' x 100' freespan warehouse with 900 SF of office.
- Great Sky Ranch Business Park location.
- Office finishes include a reception, private offices, and a conference room.

DETAILS

SPACE:	SF:	RATE:	MONTHLY RENT:
1524 A	8,900 SF	\$1.05/SF mo.	\$9,345.00
Yard	13,775 SF	\$0.10/SF mo.	\$1,377.50

NNN Exp. \$0.23/SF mo.

BLDG TYPE:	Steel	CLEAR HEIGHT:	20' Warehouse
BLDG SIZE:	8,900 SF	GRADE LEVEL:	(2) 14' x 14'
LOT SIZE:	1.80 AC	POWER:	3 Phase Power
LEASE TERM:	5 years	AVAILABLE:	Immediately

UPDATED: 12.9.2024

THIS PROPERTY IS EXCLUSIVELY MARKETED BY TOK BOISE LLC DBA TOK COMMERCIAL
This information was obtained from sources believed reliable but cannot be guaranteed. Any opinions or estimates are used for example only.

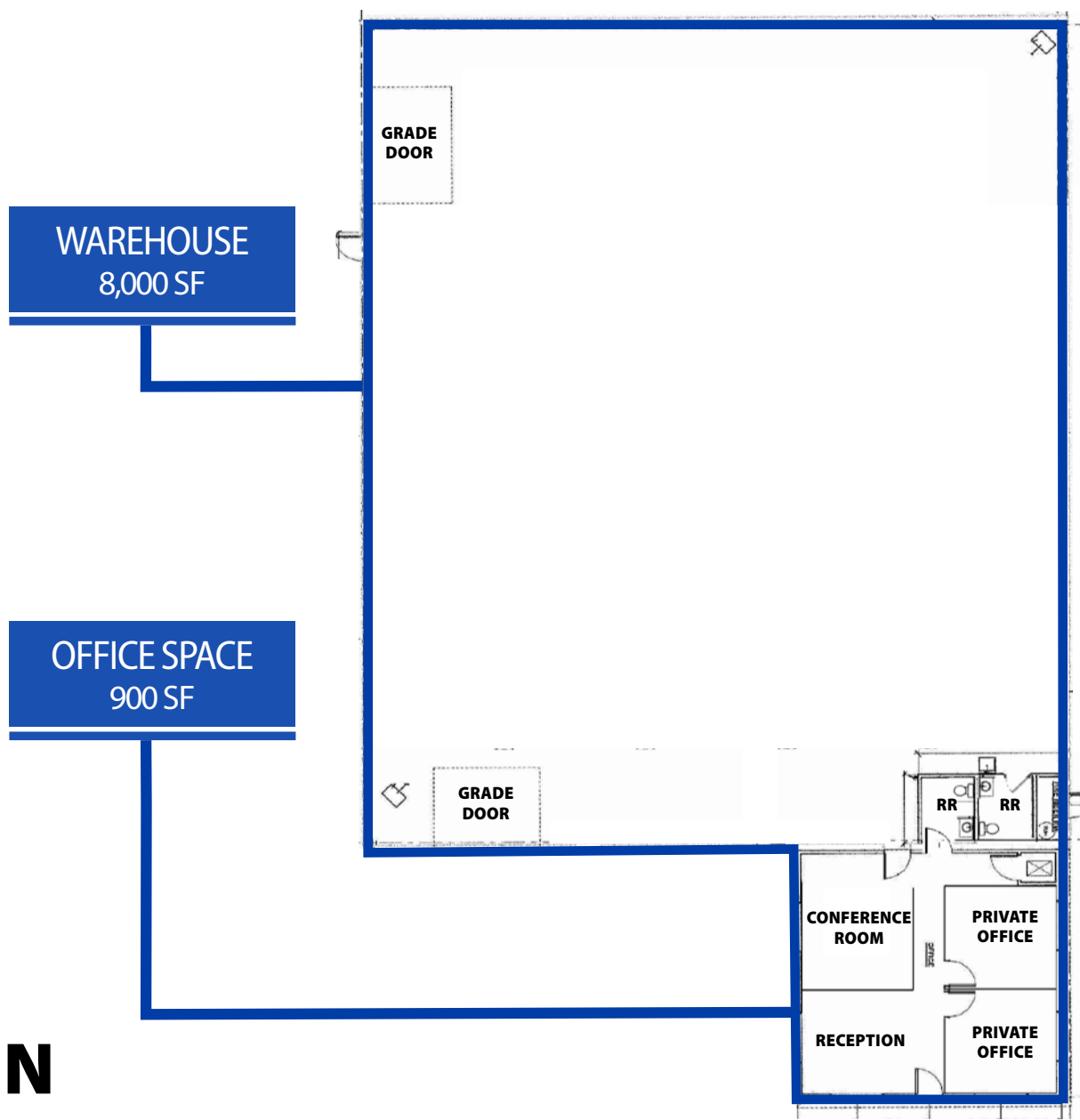

FLOOR PLAN

UPDATED: 12.9.2024

THIS PROPERTY IS EXCLUSIVELY MARKETED BY TOK BOISE LLC DBA TOK COMMERCIAL
This information was obtained from sources believed reliable but cannot be guaranteed. Any opinions or estimates are used for example only.

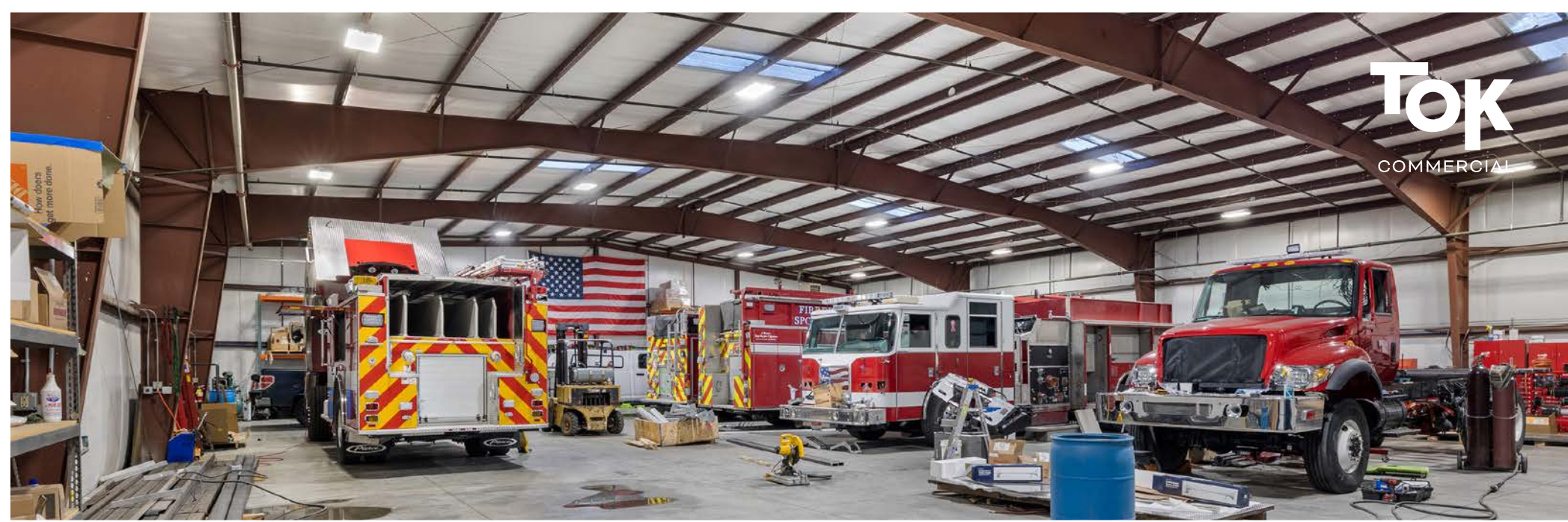

UPDATED: 12.9.2024

THIS PROPERTY IS EXCLUSIVELY MARKED BY TOK BOISE LLC DBA TOK COMMERCIAL

This information was obtained from sources believed reliable but cannot be guaranteed. Any opinions or estimates are used for example only.



UPDATED: 12.9.2024

THIS PROPERTY IS EXCLUSIVELY MARKETED BY TOK BOISE LLC DBA TOK COMMERCIAL

This information was obtained from sources believed reliable but cannot be guaranteed. Any opinions or estimates are used for example only.

TokCOMMERCIAL.COM

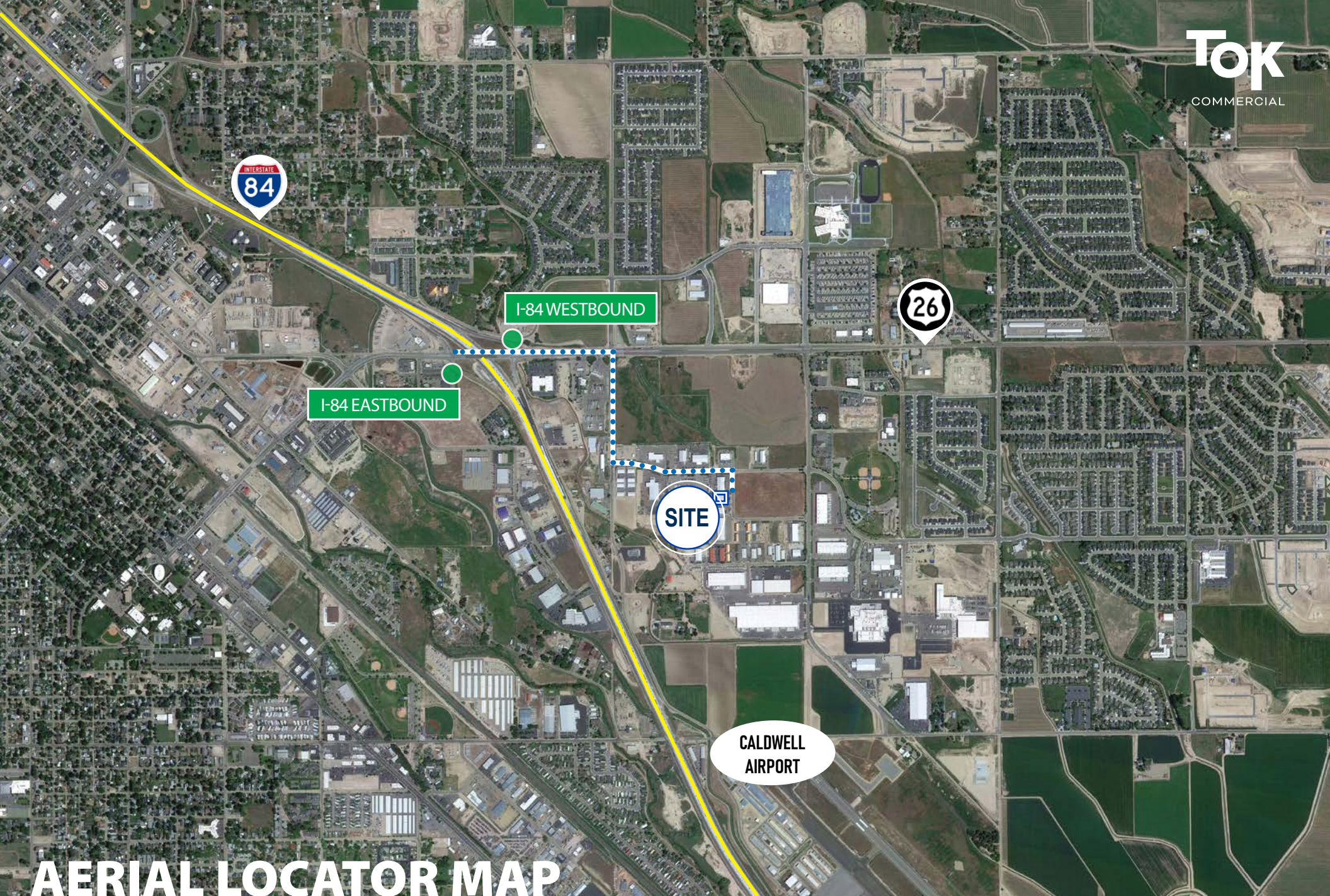

AERIAL LOCATOR MAP

UPDATED: 12.9.2024

THIS PROPERTY IS EXCLUSIVELY MARKED BY TOK BOISE LLC DBA TOK COMMERCIAL

This information was obtained from sources believed reliable but cannot be guaranteed. Any opinions or estimates are used for example only.