



Conceptual Rendering

For Lease

Small Bay Industrial Units

Dan Scanlon, JD, CCIM

Senior Associate
+1 603 860 1806
dan.scanlon@colliers.com

Cassandra Farley

Senior Associate
+1 603 703 5617
cassandra.farley@colliers.com



175 Canal Street, Suite 401
Manchester, NH 03101
+1 603 623 0100
colliersnh.com

4 Marsha Drive Northfield, NH

Property Highlights

- Brand new high efficiency industrial warehouse space in a modern development just a 2 minute drive from I-93
- 6,000± to 30,000± SF available for lease, designed for flexibility and performance, ideal for distribution, light manufacturing, contractors, storage users, and growing businesses
- Features include 22'± to 32'± clear height, wet and dry sprinklers, 14' x 14' drive-in doors, and 10' x 10' dock height doors with levelers
- Secure your space early while customization options are still available
- Anticipated completion by June 2026

Information herein has been obtained from sources deemed reliable, however its accuracy cannot be guaranteed by Colliers International | New Hampshire & Maine. The user is required to conduct their own due diligence and verification. Colliers International | New Hampshire & Maine is independently owned and operated.

For Lease

Specifications

Address:	4 Marsha Drive
Location:	Northfield, NH 03276
Building Type:	Industrial
Year Built:	2026
Total Building SF:	36,000±
Available SF:	6,000± to 30,000±
Road Frontage:	175'± on Industrial Drive
Utilities:	Municipal water; septic; propane gas
Zoning:	C/I-2
Clear Height:	22'± to 32'±
Ceiling Height:	32'±
Drive-in Doors:	5
Loading Docks:	5
Sprinklers:	Wet & dry system
Power:	200A
NNN Expenses:	TBD
Lease Rate:	\$14.00 NNN
Availability:	June 2026

Locator Map

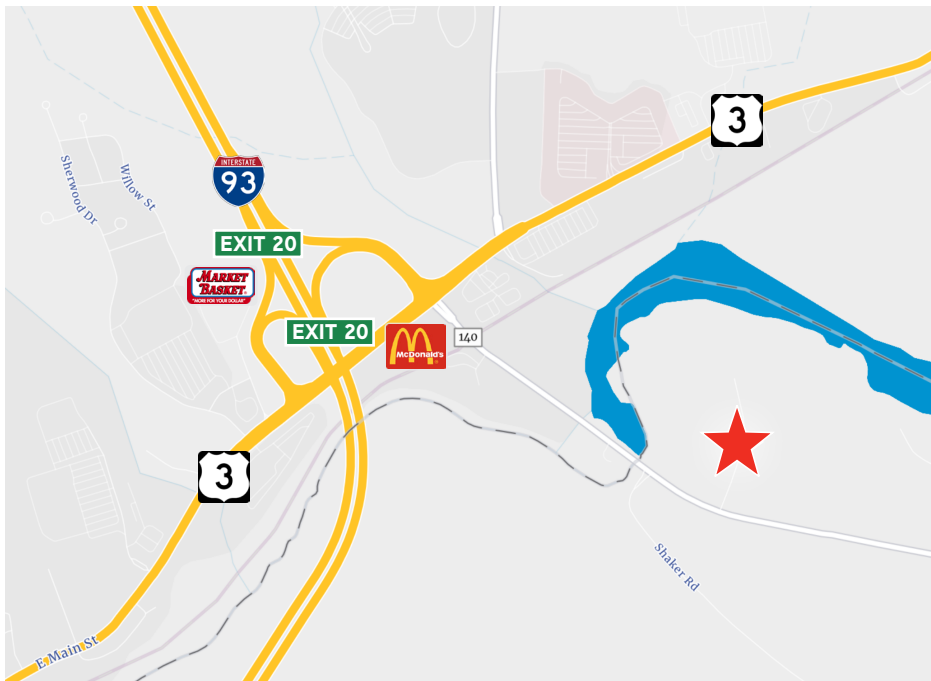

Contact us:

Dan Scanlon, JD, CCIM

Senior Associate
+1 603 860 1806
dan.scanlon@colliers.com

Cassandra Farley

Senior Associate
+1 603 703 5617
cassandra.farley@colliers.com



175 Canal Street, Suite 401
Manchester, NH 03101
+1 603 623 0100
colliersnh.com

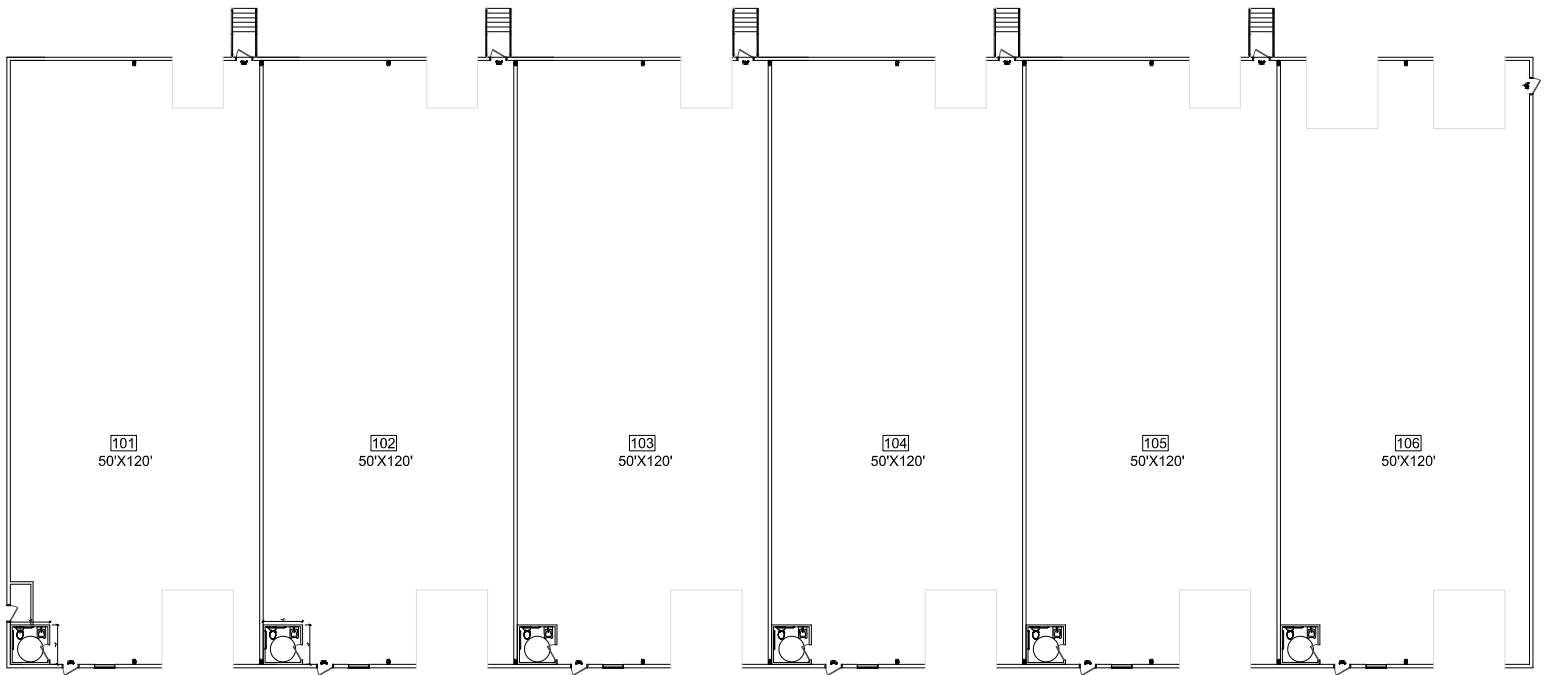

<div> <div>ENDRIUNAS BROTHERS</div> <div>ENDRIUNAS BLDG. 2 NH</div> <div>INDUSTRIAL ROAD, NORTHFIELD, NH 03276</div> </div>		<div> <div>DATE</div> <div>NO.</div> <div>DESCRIPTION</div> </div>
<div> <div>PROJECT</div> <div>ENDRIUNAS NH</div> </div>		<div> <div>REVISIONS</div> </div>
<div> <div>DATE</div> <div>10/08/2025</div> </div>		
<div> <div>SCALE</div> <div>NA</div> </div>		
<div> <div>DESIGNER</div> <div>DF</div> </div>	<div> <div>APPROVAL</div> </div>	
<div> <div>DATE</div> <div>10/08/2025</div> </div>		
<div> <div>FLOOR PLAN</div> </div>		
<div> <div>DATE</div> <div>10/08/2025</div> </div>		
<div> <div>00</div> </div>		