

FOR LEASE

# 7132 JOHNSON DRIVE

PLEASANTON, CA 94588

*±5,800 SF of Premier  
Commercial Space*



KIDDER.COM

**NEWMARK**

**km** Kidder  
Mathews

7132 JOHNSON DRIVE



SUBJECT  
PROPERTY

*±5,800 RSF*

AVAILABLE FOR LEASE

*CONTACT*

BROKERS FOR PRICING & TOURING

## SUITE HIGHLIGHTS

### PREMIER PLEASANTON LOCATION

Positioned along the highly trafficked I-580/I-680 interchange, at the gateway to the Tri-Valley's primary retail and business corridor

### EXCEPTIONAL FREEWAY VISIBILITY

Prominent building exposure with strong identity and signage opportunities visible from major commuter routes

### ESTABLISHED RETAIL CORRIDOR

Surrounded by national retailers, hotels, and high-performing service businesses including the Pleasanton Hilton and Bay Club Pleasanton

### STRONG DEMOGRAPHICS

Affluent and dense trade area with high household incomes and daytime population driven by nearby office and residential communities

### LOCAL OWNERSHIP

Professionally maintained asset with responsive, long-term local ownership and property management

### FLEXIBLE COMMERCIAL USE

Ideal for showroom, retail, fitness, service, or hybrid industrial/retail users

# FLOOR PLAN

*±5,800 RSF*  
AVAILABLE

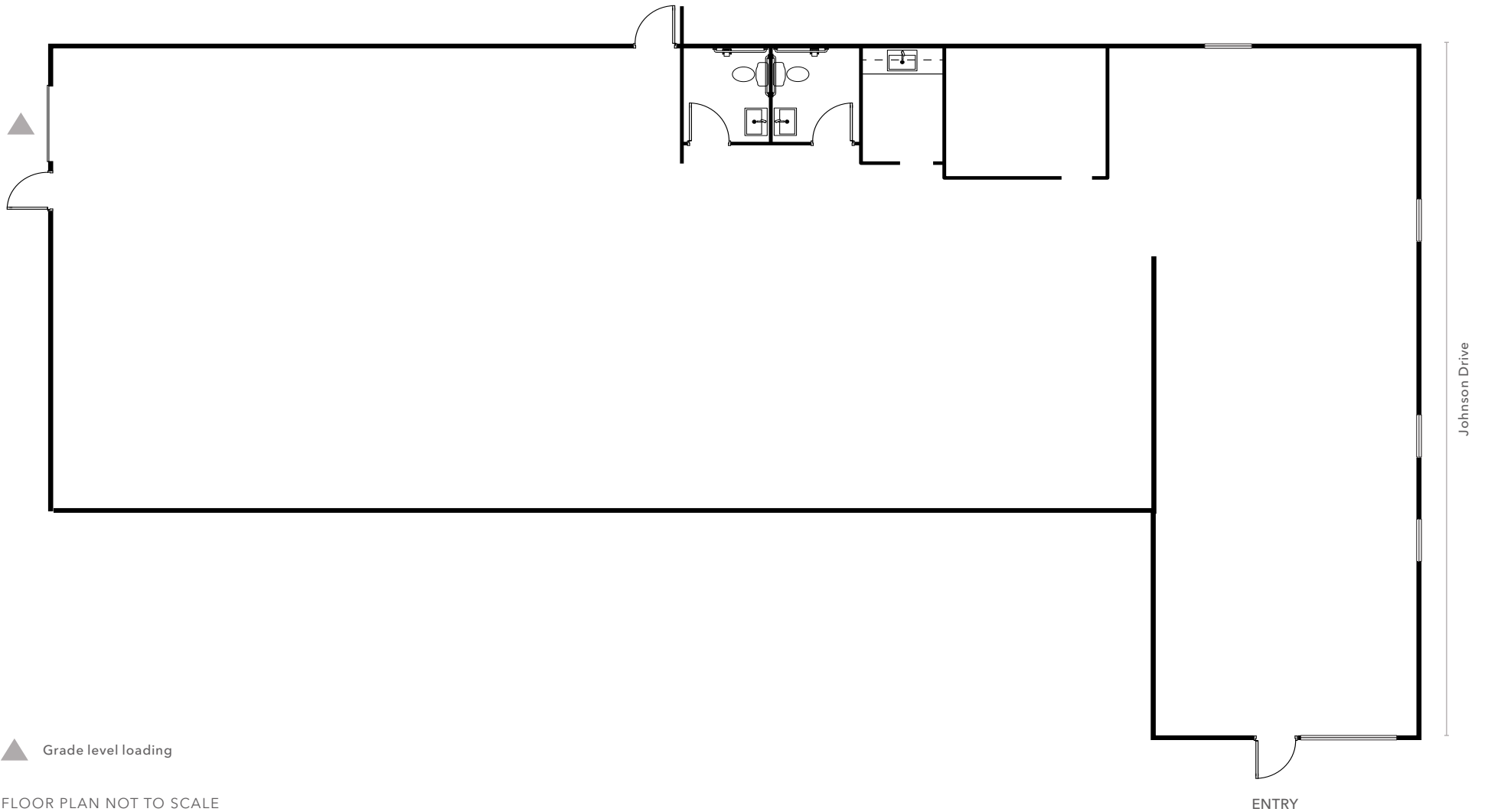

▲ Grade level loading

FLOOR PLAN NOT TO SCALE

AVAILABLE FOR LEASE

NEWMARK | KIDDER MATHEWS

# LOCAL AMENITIES

**DUBLIN PLACE**

**DUBLIN**

**BART STATION**  
Dublin / Pleasanton

**PLEASANTON SQUARE**

PERSIMMON PLACE			HACIENDA CROSSINGS		

**BART STATION**  
Dublin / Pleasanton

**STONERIDGE MALL**

**7132 JOHNSON DRIVE**

**PLEASANTON**

**GATEWAY SQUARE**

**THE CROSSROADS**

*Exclusively listed by*

**WILL BALLOWE**

Kidder Mathews  
925.389.2499  
will.ballowe@kidder.com

LIC N° 02053125

KIDDER.COM

**DAN WATSON**

Newmark  
925.200.6862  
dan.watson@nrmk.com

LIC N° 01879314

NMRK.COM

**NEWMARK**

