

218 SUITE C

South Van Brunt St
Englewood, New Jersey

4,782 SF

Industrial/Flex For Lease



Property Information

Available Space:	4,782 SF
Office Space:	1,500 SF
Building Size:	16,000 SF
Ceiling Height:	13' clear
Loading:	1 tailgate (<i>shared</i>) 1 drive-in
Parking:	5 spaces
Taxes/Insurance:	\$3.00 PSF
OPEX:	\$1.40 PSF

 **For more information**

Andrew Somple, SIOR

201 488 5800 x151
asomple@naihanson.com

Jessica Curry

201 488 5800 x199
jcurry@naihanson.com

FOLLOW US!      | Member of NAI Global with 300+ Offices Worldwide

NAI James E. Hanson
COMMERCIAL REAL ESTATE SERVICES, WORLDWIDE

195 North Street, Suite 100 • Teterboro, NJ 07608 | 201 488 5800 • 10 Lanidex Plaza W., Parsippany, NJ 07054 | 973 463 1011 • naihanson.com

THE INFORMATION CONTAINED HEREIN HAS BEEN OBTAINED FROM SOURCES CONSIDERED TO BE RELIABLE, BUT NO GUARANTEE OF ITS ACCURACY IS MADE BY NAI JAMES E. HANSON.

218 SUITE C

South Van Brunt St
Englewood, New Jersey

Property Floor Plan

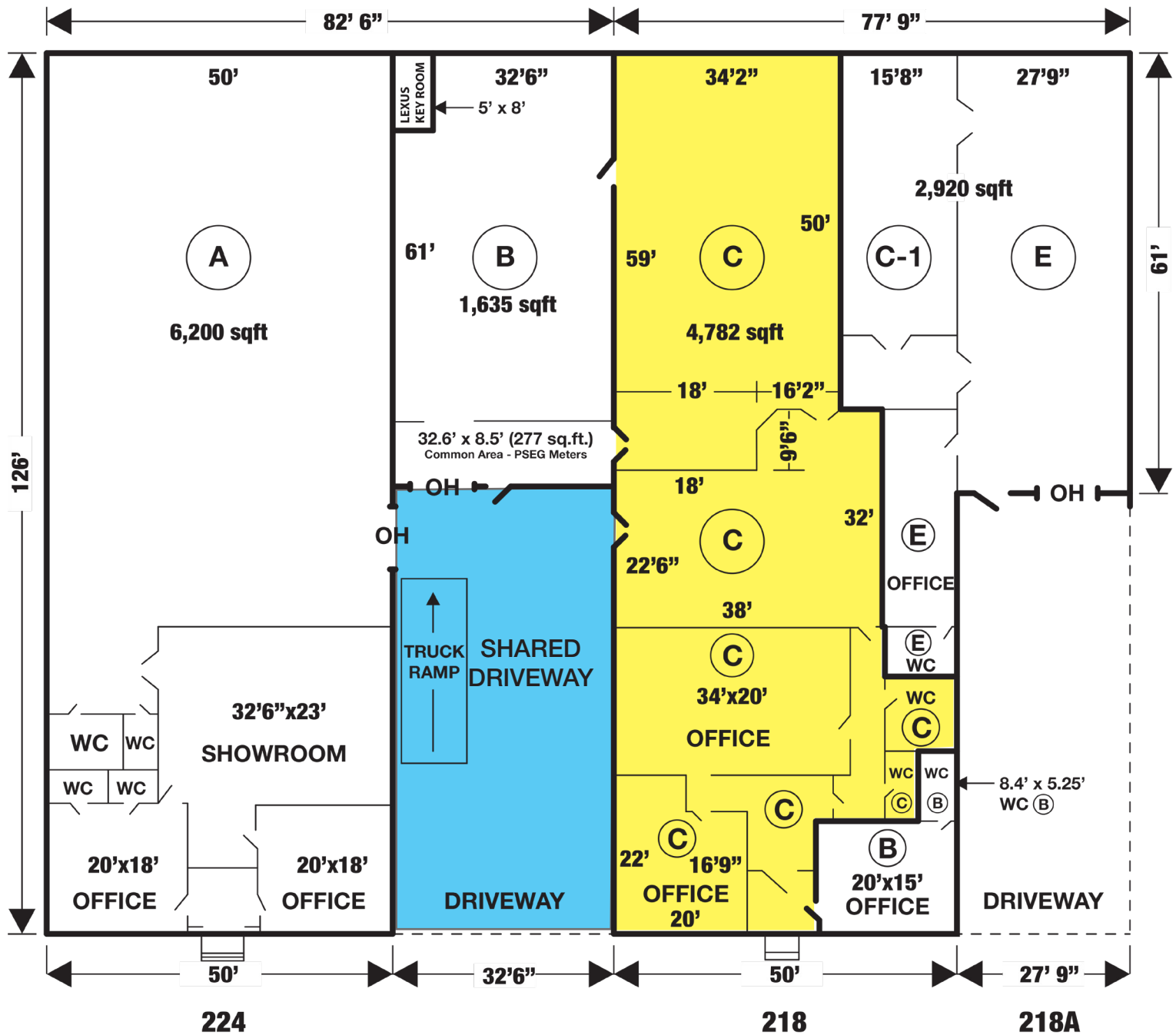

SOUTH VAN BRUNT STREET ENGLEWOOD NJ

(Dimension are approximate)

218 SUITE C

South Van Brunt St
Englewood, New Jersey

Aerial
& Map

REDEVELOPMENT
ZONE

PERMITTING
MULTIPLE USES

