

M E R I D I A N

147 S. CHERRY STREET, SUITE 200 | WINSTON-SALEM, NC 27101 | P 336.722.1986 | F 336.723.3173 | MERIDIANREALTY.COM

Dry Storage | 2,520± RSF

1100 Fairchild Road

Winston-Salem, NC 27105

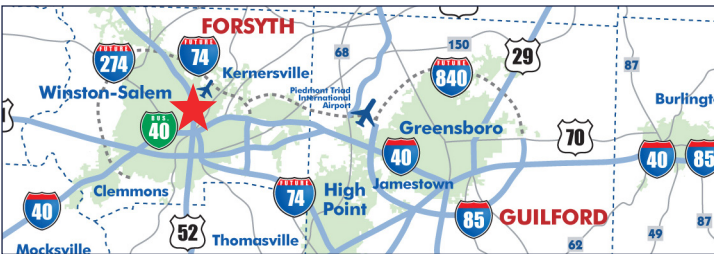

2,520± RSF of warehouse space available for sublease. Fully fenced in lot with gated entrance. Includes access to two dock areas. Zoned GI and suitable for dry storage. Convenient to Hwy 52 and across from Smith Reynolds Airport. Sublease extends through March 31, 2026.

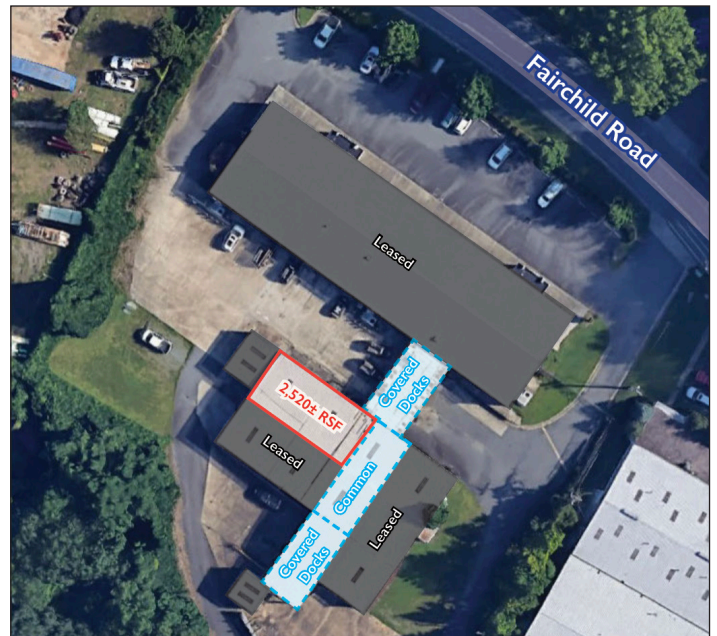

For more information:

John L. Ruffin, CCIM
jruffin@meridianrealty.com
336.480.2081

Allison Cain, CCIM
Allison@meridianrealty.com
336.480.2334

FOR SUBLEASE: \$1,500 per month

WWW.MERIDIANREALTY.COM

1100 Fairchild Road | Winston-Salem, NC 27105

WAREHOUSE

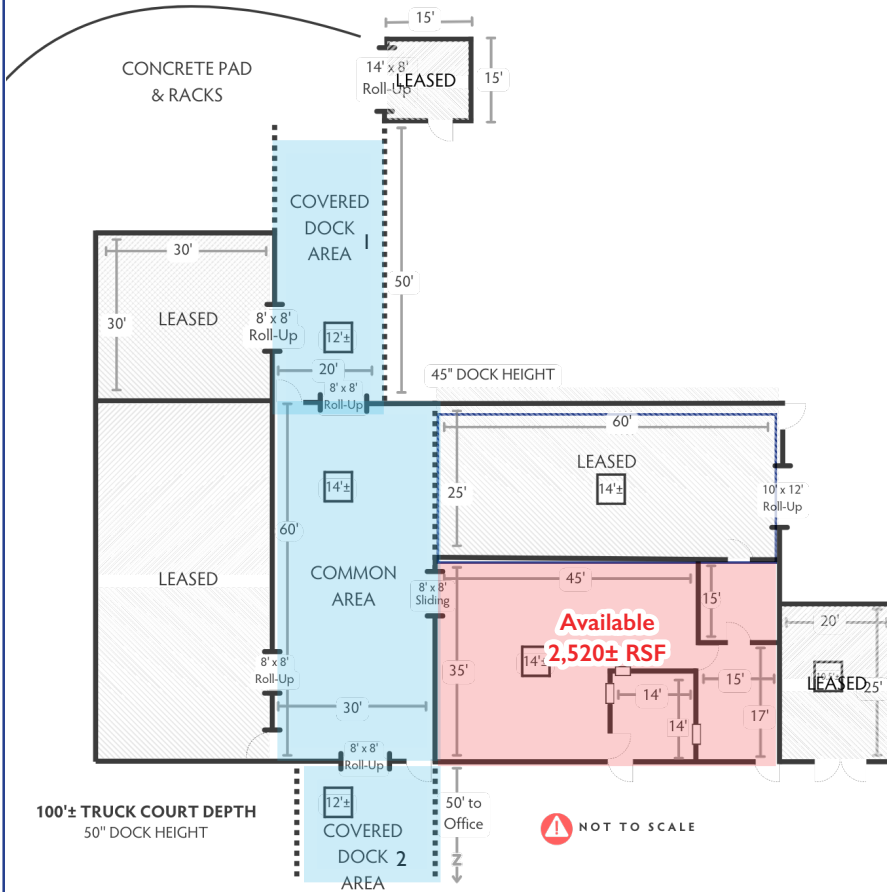

INTERIOR



DOCK 1



DOCK 2



Concrete Pad & Racks



No warranty or representation (express or implied) is made as to the accuracy or completeness of the information set forth herein. All information is submitted subject to errors, omissions, change of price, prior lease or sale, and withdrawal without notice. All marketing material produced by the Meridian Realty Group is proprietary. Any reproduction is expressly prohibited.



THE MERIDIAN REALTY GROUP | 147 S. CHERRY STREET, SUITE 200 | WINSTON-SALEM, NC 27101

P 336.722.1986 | F 336.723.3173

WWW.MERIDIANREALTY.COM