

# SIX CORNERS PLAZA



**MID-AMERICA®**  
Real Estate Corporation

PROPOSED **ROSS** DRESS FOR LESS PROPOSED **dd's** DISCOUNTS

# ANCHORED PROJECT

# SEC Milwaukee & Cicero / Chicago, IL

## 24,400 SF AVAILABLE

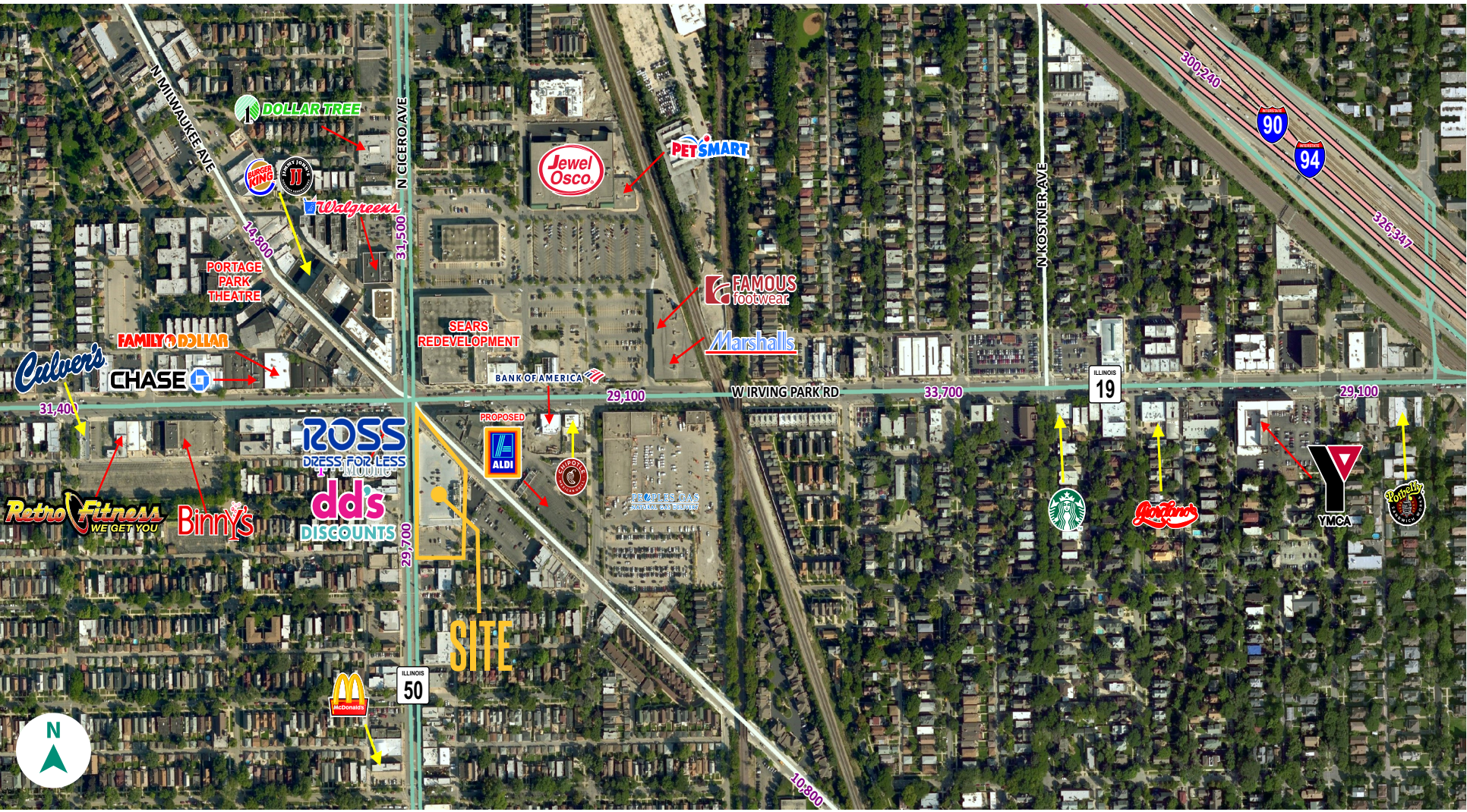

# RETAIL OPPORTUNITY



# SIX CORNERS PLAZA

PROPOSED



PROPOSED



ANCHORED PROJECT

## address

SEC Milwaukee & Cicero  
(3970-3982 N Milwaukee)  
Chicago, IL

## demographics

## highlights

- 24,400 SF Available for Lease
- 11' Ceiling Height
- Shared Building Signage
- +60,000 VPD at Intersection
- Rooftop and Surface Parking
- Building to be completely renovated

|                      | 1M       | 2M       | 3M       |
|----------------------|----------|----------|----------|
| POPULATION           | 47,223   | 221,984  | 455,155  |
| HOUSEHOLDS           | 17,649   | 75,590   | 155,333  |
| AVG HOUSEHOLD INCOME | \$80,215 | \$74,424 | \$75,203 |
| DAYTIME POPULATION   | 35,020   | 156,331  | 331,336  |



# SIX CORNERS PLAZA

PROPOSED **ROSS** DRESS FOR LESS PROPOSED **dd's** DISCOUNTS ANCHORED PROJECT

SEC Milwaukee & Cicero / Chicago, IL

## LOWER LEVEL

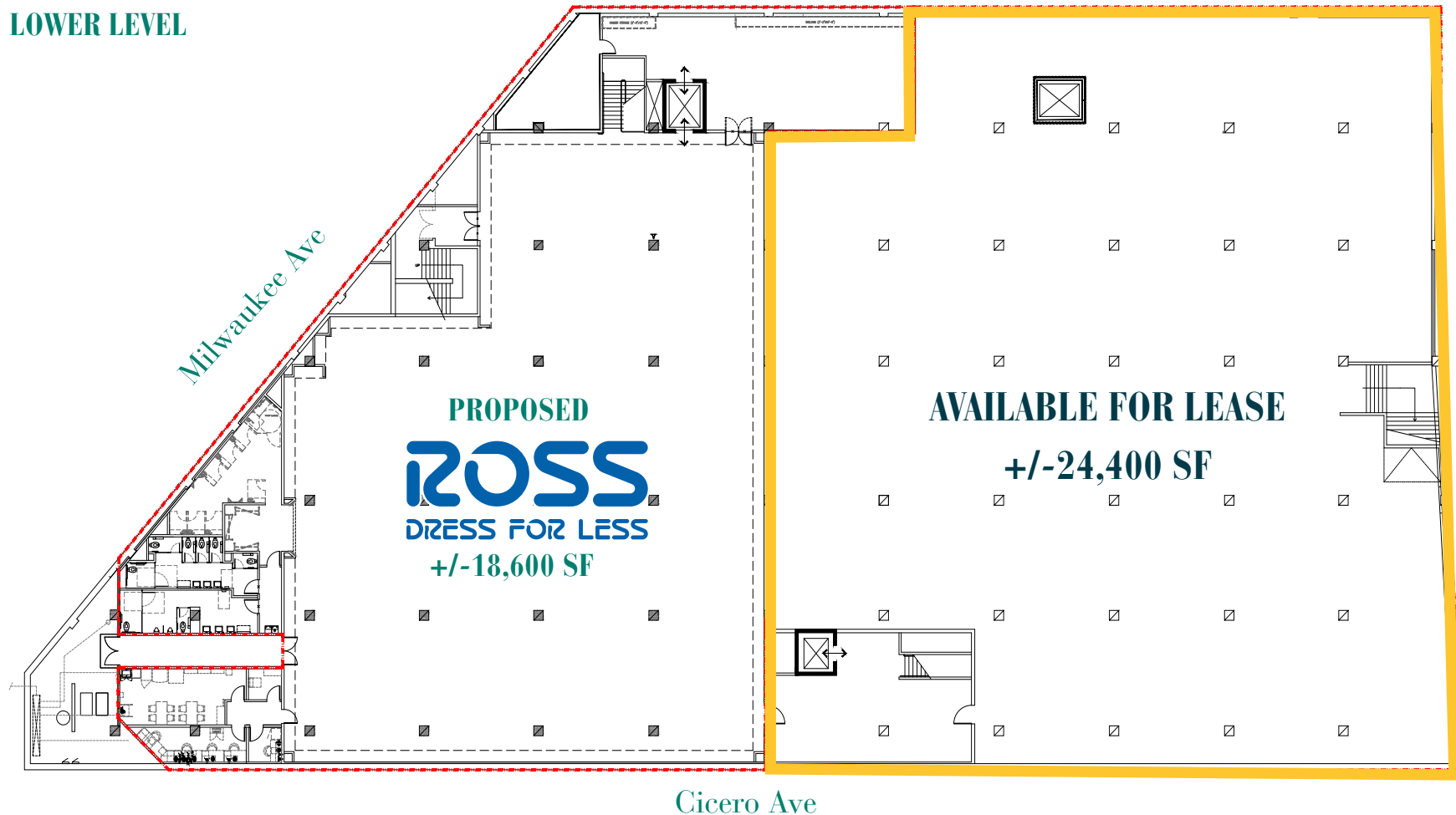

# SIX CORNERS PLAZA

PROPOSED **ROSS** DRESS FOR LESS PROPOSED **dd's** DISCOUNTS ANCHORED PROJECT

SEC Milwaukee & Cicero / Chicago, IL

PARKING LEVEL

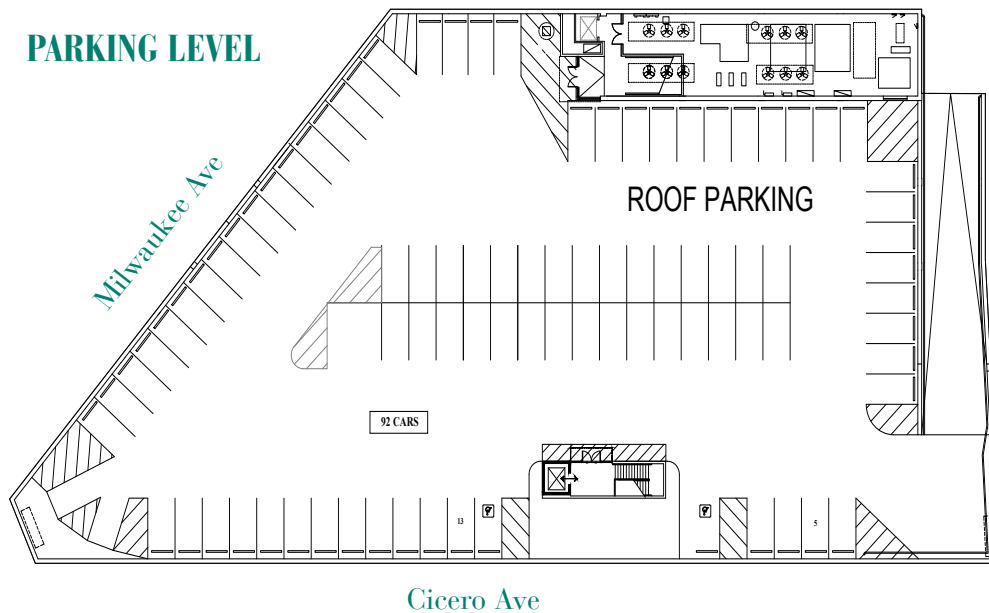

STREET LEVEL

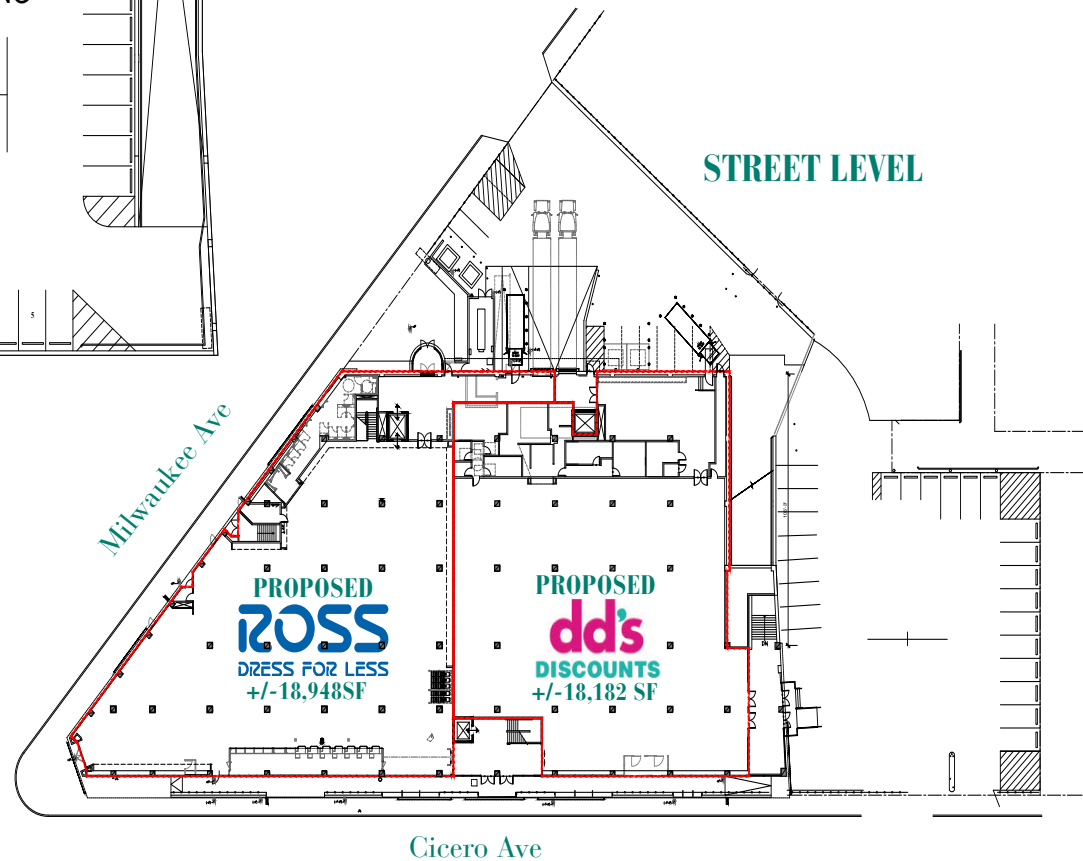

< n

SITE PLAN

# SIX CORNERS PLAZA

PROPOSED **ROSS** DRESS FOR LESS PROPOSED **dd's** DISCOUNTS ANCHORED PROJECT  
SEC Milwaukee & Cicero / Chicago, IL



CICERO AVENUE

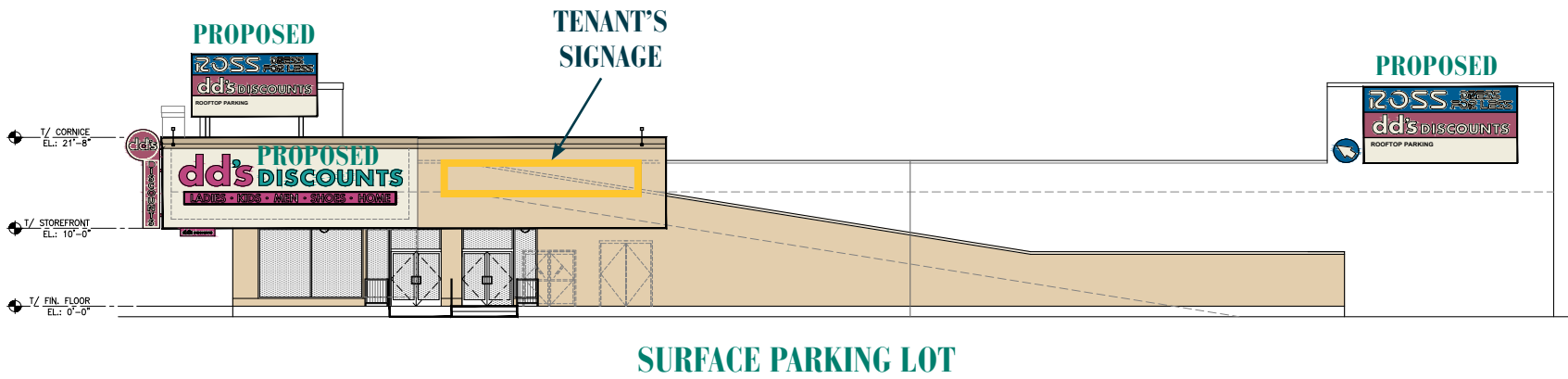

SURFACE PARKING LOT

ELEVATIONS

# SIX CORNERS PLAZA

PROPOSED

**ROSS**  
DRESS FOR LESS

PROPOSED

**dd's**  
DISCOUNTS

ANCHORED PROJECT

SEC Milwaukee & Cicero / Chicago, IL

Mike  
Phillips

T: 630.954.7358

F: 630.954.7304

MPhillips@MidAmericaGrp.com



**MID-AMERICA®**  
Real Estate Corporation

One Parkview Plaza, 9th Floor  
Oakbrook Terrace, IL 60181  
630.954.7300  
MidAmericaGrp.com



CONTACT