

Cavalier Inn Greensboro

312 W J J Dr, Greensboro NC 27406



THE SPACE

Location

312 W J J Dr
Greensboro, NC, 27406



POPULATION

1.00 MILE	3.00 MILE	5.00 MILE
5,256	79,846	156,301



AVERAGE HOUSEHOLD INCOME

1.00 MILE	3.00 MILE	5.00 MILE
\$59,223	\$60,160	\$74,371



NUMBER OF HOUSEHOLDS

1.00 MILE	3.00 MILE	5.00 MILE
2,289	29,465	60,256

PROPERTY FEATURES

TOTAL ROOMS	100
GBA (SF)	17,576
LAND ACRES	3.01
YEAR BUILT	1972
BUSINESS PRICE	\$125,000
SECURITY DEPOSIT	\$18,000
MONTHLY RENT	\$18,000
ROYALTY	10% of monthly gross
NUMBER OF STORIES	1



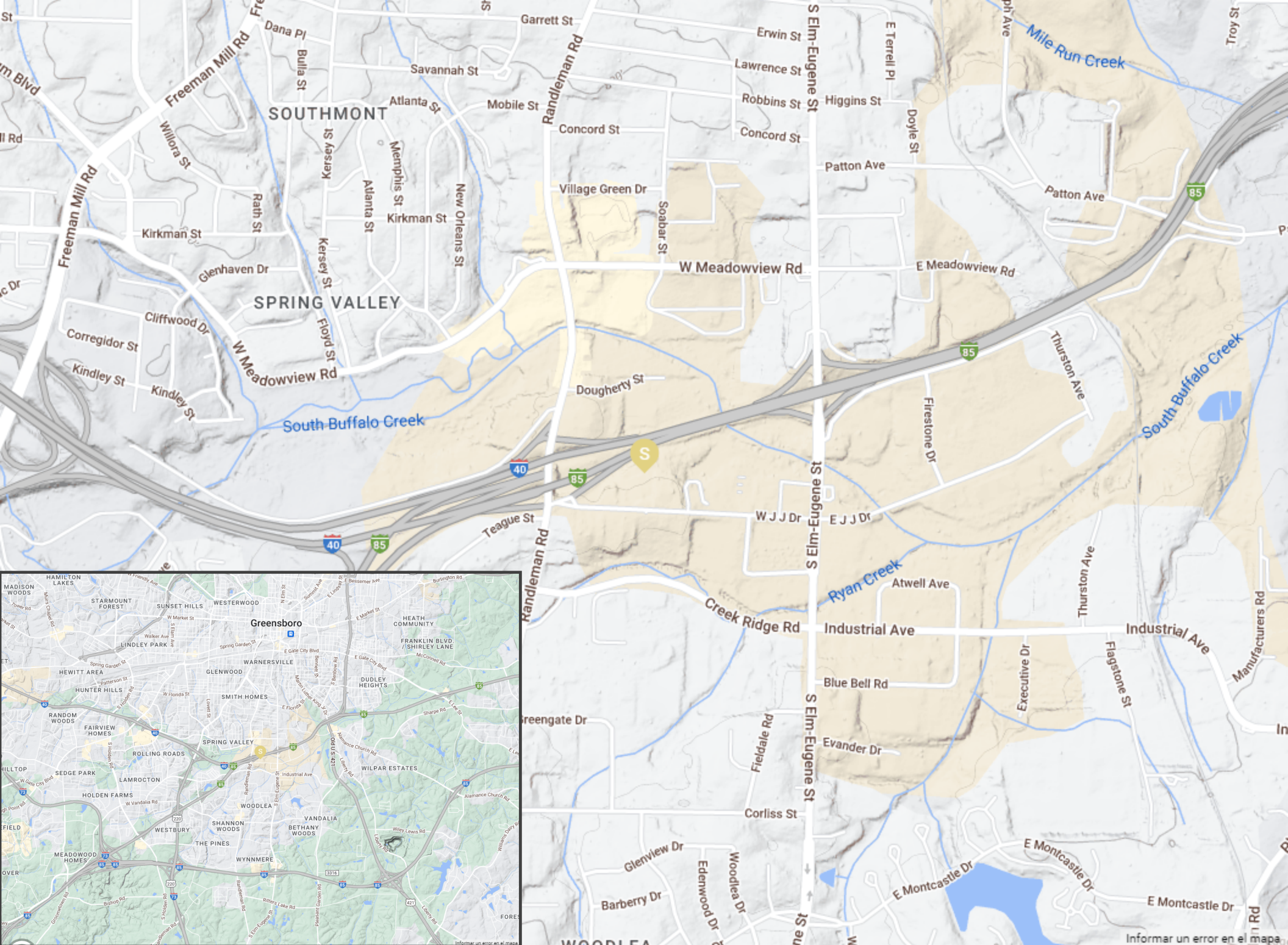



[Informar un error en el mapa](#)













POPULATION	1 MILE	3 MILE	5 MILE
2000 Population	4,951	64,206	133,595
2010 Population	5,167	69,655	140,479
2023 Population	5,256	79,846	156,301
2028 Population	5,259	80,536	157,943
2023 African American	3,612	44,757	76,428
2023 American Indian	46	692	1,240
2023 Asian	119	3,826	7,112
2023 Hispanic	828	10,888	20,629
2023 Other Race	568	6,421	12,310
2023 White	574	18,542	48,481
2023 Multiracial	336	5,554	10,620
2023-2028: Population: Growth Rate	0.05 %	0.85 %	1.05 %
2023 HOUSEHOLD INCOME	1 MILE	3 MILE	5 MILE
less than \$15,000	320	4,922	8,951
\$15,000-\$24,999	240	3,143	6,307
\$25,000-\$34,999	315	3,095	5,991
\$35,000-\$49,999	358	5,136	9,154
\$50,000-\$74,999	530	5,978	11,260
\$75,000-\$99,999	233	3,202	6,550
\$100,000-\$149,999	210	2,824	7,045
\$150,000-\$199,999	50	580	2,078
\$200,000 or greater	33	584	2,919
Median HH Income	\$45,318	\$44,277	\$49,391
Average HH Income	\$59,223	\$60,160	\$74,371

HOUSEHOLDS	1 MILE	3 MILE	5 MILE
2000 Total Housing	2,476	26,617	57,122
2010 Total Households	2,219	27,059	55,558
2023 Total Households	2,289	29,465	60,256
2028 Total Households	2,309	29,905	61,215
2023 Average Household Size	2.24	2.31	2.31
2000 Owner Occupied Housing	1,106	12,790	28,131
2000 Renter Occupied Housing	1,082	11,779	24,764
2023 Owner Occupied Housing	928	12,601	28,434
2023 Renter Occupied Housing	1,361	16,864	31,822
2023 Vacant Housing	158	2,982	5,807
2023 Total Housing	2,447	32,447	66,063
2028 Owner Occupied Housing	967	12,916	29,675
2028 Renter Occupied Housing	1,342	16,990	31,540
2028 Vacant Housing	154	3,177	6,328
2028 Total Housing	2,463	33,082	67,543
2023-2028: Households: Growth Rate	0.85 %	1.50 %	1.60 %

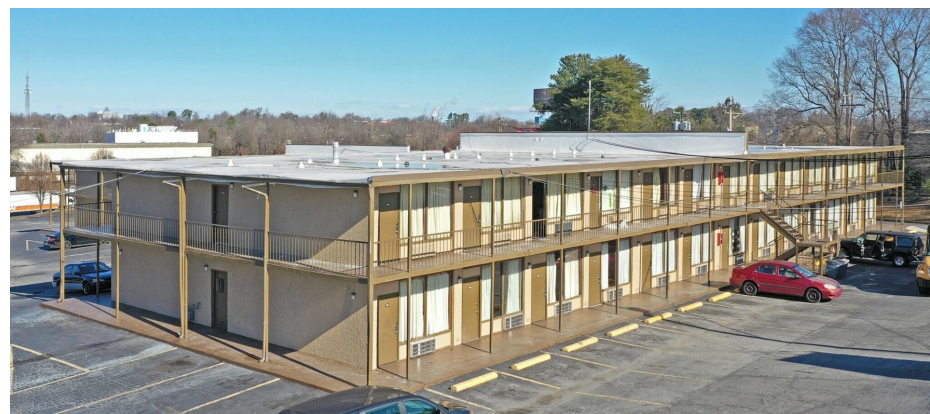

Source: esri

2023 POPULATION BY AGE	1 MILE	3 MILE	5 MILE
2023 Population Age 30-34	428	5,672	11,079
2023 Population Age 35-39	344	4,626	9,484
2023 Population Age 40-44	364	4,256	8,935
2023 Population Age 45-49	318	3,805	8,098
2023 Population Age 50-54	302	3,804	8,241
2023 Population Age 55-59	289	3,718	8,060
2023 Population Age 60-64	330	3,884	8,306
2023 Population Age 65-69	304	3,371	7,323
2023 Population Age 70-74	260	2,692	5,855
2023 Population Age 75-79	164	1,789	3,980
2023 Population Age 80-84	105	1,132	2,536
2023 Population Age 85+	119	1,033	2,343
2023 Population Age 18+	4,093	64,099	125,142
2023 Median Age	39	30	33

2023 INCOME BY AGE	1 MILE	3 MILE	5 MILE
Median Household Income 25-34	\$52,156	\$46,776	\$49,834
Average Household Income 25-34	\$66,485	\$61,620	\$66,855
Median Household Income 35-44	\$52,580	\$52,681	\$56,841
Average Household Income 35-44	\$68,957	\$70,267	\$82,824
Median Household Income 45-54	\$51,799	\$53,771	\$60,030
Average Household Income 45-54	\$66,040	\$71,429	\$91,328
Median Household Income 55-64	\$45,257	\$47,321	\$53,753
Average Household Income 55-64	\$54,918	\$63,966	\$86,023
Median Household Income 65-74	\$39,729	\$39,904	\$44,950
Average Household Income 65-74	\$50,062	\$53,797	\$71,701
Average Household Income 75+	\$44,090	\$45,461	\$59,744

2028 POPULATION BY AGE	1 MILE	3 MILE	5 MILE
2028 Population Age 30-34	320	4,843	9,726
2028 Population Age 35-39	393	5,263	10,441
2028 Population Age 40-44	340	4,465	9,203
2028 Population Age 45-49	361	4,094	8,756
2028 Population Age 50-54	306	3,696	7,952
2028 Population Age 55-59	293	3,665	8,004
2028 Population Age 60-64	276	3,438	7,534
2028 Population Age 65-69	285	3,448	7,505
2028 Population Age 70-74	260	2,895	6,368
2028 Population Age 75-79	215	2,213	4,870
2028 Population Age 80-84	135	1,403	3,188
2028 Population Age 85+	131	1,158	2,682
2028 Population Age 18+	4,106	64,799	126,956
2028 Median Age	40	30	34

2028 INCOME BY AGE	1 MILE	3 MILE	5 MILE
Median Household Income 25-34	\$58,354	\$53,146	\$56,120
Average Household Income 25-34	\$76,823	\$70,836	\$78,127
Median Household Income 35-44	\$59,194	\$59,769	\$65,820
Average Household Income 35-44	\$81,062	\$81,689	\$95,407
Median Household Income 45-54	\$55,176	\$60,040	\$69,432
Average Household Income 45-54	\$74,458	\$83,025	\$105,270
Median Household Income 55-64	\$52,279	\$53,810	\$61,952
Average Household Income 55-64	\$64,905	\$74,872	\$99,880
Median Household Income 65-74	\$43,740	\$44,409	\$51,862
Average Household Income 65-74	\$55,916	\$63,153	\$84,946
Average Household Income 75+	\$51,350	\$53,928	\$72,122

2023 Household Income

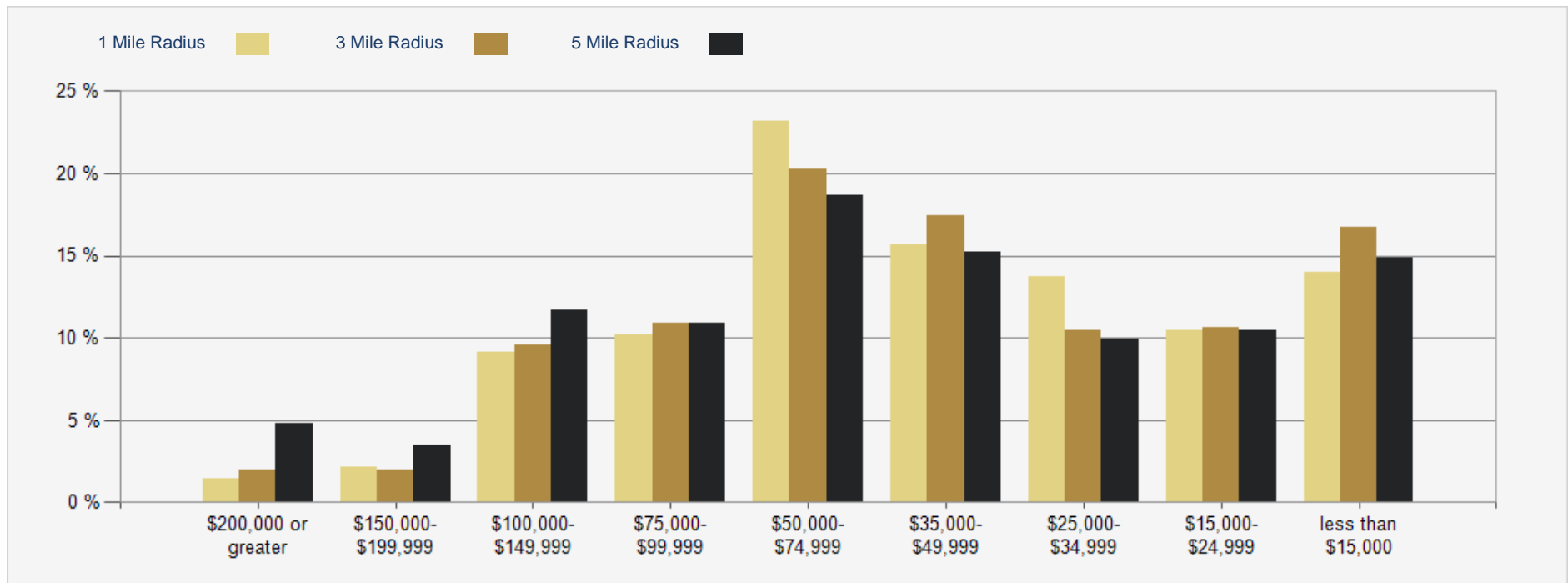

2023 Population by Race

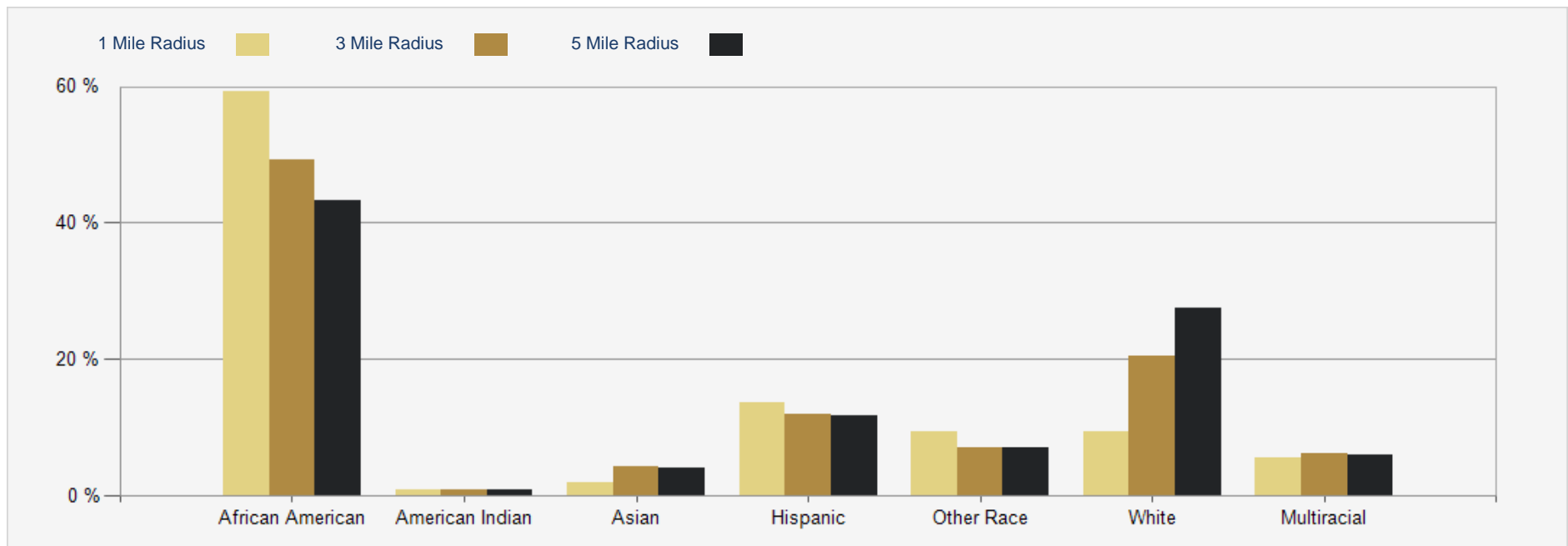

2023 Household Occupancy - 1 Mile Radius

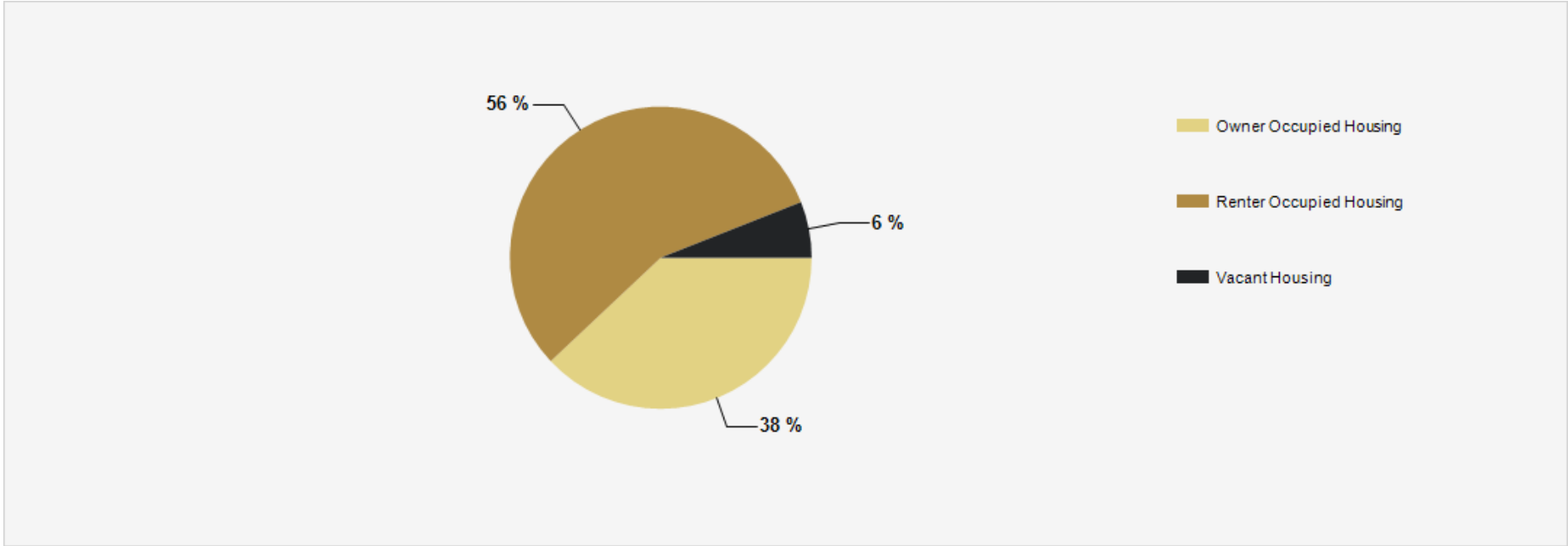

2023 Household Income Average and Median

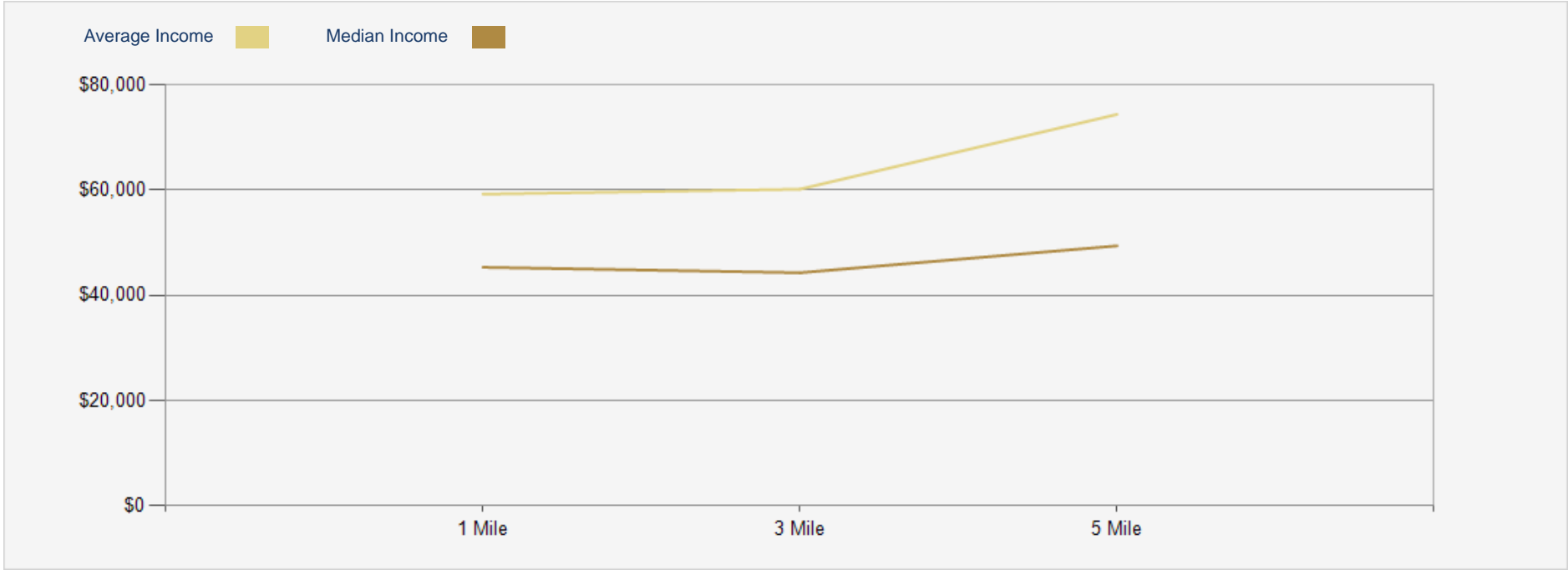

Cavalier Inn Greensboro

CONFIDENTIALITY and DISCLAIMER

The information contained in the following offering memorandum is proprietary and strictly confidential. It is intended to be reviewed only by the party receiving it from Century 21 Commercial Cornerstone Group and it should not be made available to any other person or entity without the written consent of Century 21 Commercial Cornerstone Group.

By taking possession of and reviewing the information contained herein the recipient agrees to hold and treat all such information in the strictest confidence. The recipient further agrees that recipient will not photocopy or duplicate any part of the offering memorandum. If you have no interest in the subject property, please promptly return this offering memorandum to Century 21 Commercial Cornerstone Group. This offering memorandum has been prepared to provide summary, unverified financial and physical information to prospective purchasers, and to establish only a preliminary level of interest in the subject property.

The information contained herein is not a substitute for a thorough due diligence investigation. Century 21 Commercial Cornerstone Group has not made any investigation, and makes no warranty or representation with respect to the income or expenses for the subject property, the future projected financial performance of the property, the size and square footage of the property and improvements, the presence or absence of contaminating substances, PCBs or asbestos, the compliance with local, state and federal regulations, the physical condition of the improvements thereon, or financial condition or business prospects of any tenant, or any tenant's plans or intentions to continue its occupancy of the subject property.

The information contained in this offering memorandum has been obtained from sources we believe reliable; however, Century 21 Commercial Cornerstone Group has not verified, and will not verify, any of the information contained herein, nor has Century 21 Commercial Cornerstone Group conducted any investigation regarding these matters and makes no warranty or representation whatsoever regarding the accuracy or completeness of the information provided. All potential buyers must take appropriate measures to verify all of the information set forth herein. Prospective buyers shall be responsible for their costs and expenses of investigating the subject property.

Inquire today:

Silvestre Madrigal

Century 21 Commercial Cornerstone Group

(562) 843-3495

c21ccgroup@gmail.com

Lic: CalDRE #01363650