

FOR SALE OR LEASE

15023-15035

CALIFA STREET



39,186 SF TOTAL AVAILABILITY

VAN NUYS, CA 91411

CBRE

FOR SALE

15023-15035 CALIFA STREET
39,186 SF | PRICE: NEGOTIABLE

15023-15035 Califa St is an excellent manufacturing/distribution project comprised of two industrial buildings totaling approximately 20,000 SF each. Centrally located in Sherman Oaks with close proximity to the 405/101 Freeway. The project features a beautiful bow truss ceiling, functional layout, and prominent street frontage.

FEATURES

- 13'-32' Clear Height
- A: 400 V: 120/240 0: 3 W: 3 And Two Additional 400 Amp Panels
- 1,223 SF Metal Structure In The Rear
- Fully Fenced And Paved Yard
- Oversized Loading Door
- Rare Clear Span Warehouse Space Throughout



LEASE AVAILABILITIES

39,186 SF

15 Offices | 5,592 SF

- Asking Rate: \$1.35 Gross
- Power: A: 400 V: 120/240 0: 3 W: 3 And Two Additional 400 Amp Panels
- 13'-32' Clear Height
- 7 Ground-Level Doors
- 1,223 SF Metal Structure In The Rear

29,786 SF

10 Offices | 3,924 SF

- Asking Rate: \$1.37 Gross
- Two Power Panels:
A: 400 V: 120-240 0: 3 W: 3
A: 400 V: 120-240 0: 1 W: 3
- 13'-32' Clear Height
- 5 Ground-Level Doors
- 1,223 SF Metal Structure In The Rear

18,880 SF

4 Offices | 2,117 SF

- Asking Rate: \$1.39 Gross
- Power: A: 400 V: 120-240 0: 3 W: 3
- 13'-32' Clear Height
- 2 Ground-Level Doors
- 1,223 SF Metal Structure In The Rear

10,906 SF

6 Offices | 1,807 SF

- Asking Rate: \$1.41 Gross
- Power: A: 400 V: 120-240 0: 1 W: 3
- 14'-17' Clear Height
- 3 Ground-Level Doors
- Oversized Loading Door

9,400 SF

5 Offices | 1,668 SF

- Asking Rate: \$1.43 Gross
- Power: A: 400 V: 120-240 0: 1 W: 3
- 14'-17' Clear Height
- 2 Ground-Level Doors

SITE PLAN

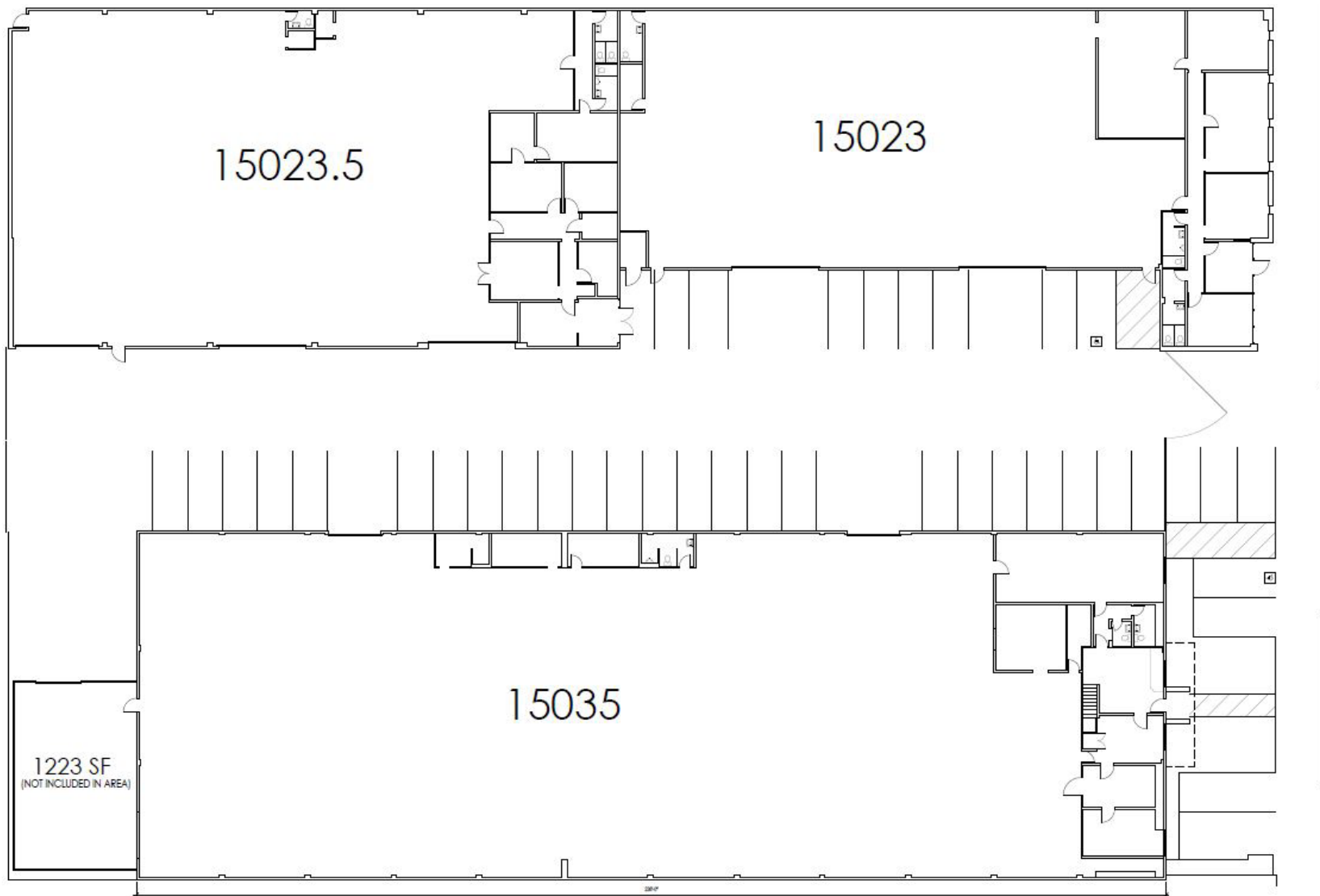



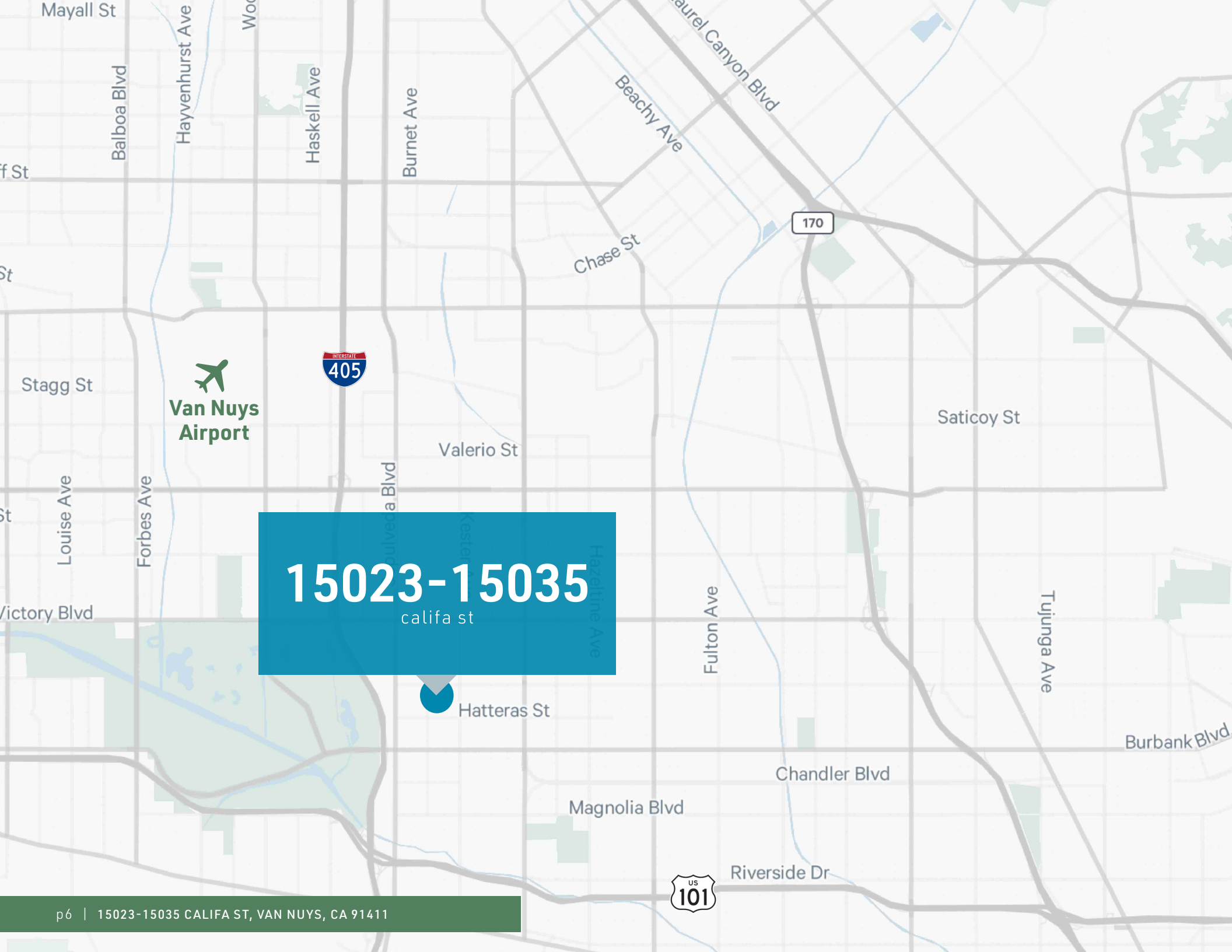

**Van Nuys
Airport**

15023-15035

califa st



15023-15035

califa st

FOR MORE INFORMATION, PLEASE CONTACT:

MICHAEL BOGLE

Senior Vice President

+1 818 907 4746

Lic. 01797136

michael.bogle@cbre.com

© 2025 CBRE, Inc. All rights reserved. This information has been obtained from sources believed reliable but has not been verified for accuracy or completeness. You should conduct a careful, independent investigation of the property and verify all information. Any reliance on this information is solely at your own risk. CBRE and the CBRE logo are service marks of CBRE, Inc. All other marks displayed on this document are the property of their respective owners, and the use of such logos does not imply any affiliation with or endorsement of CBRE. Photos herein are the property of their respective owners. Use of these images without the express written consent of the owner is prohibited. CMPM 15023-15035 Califa St_BRO_Bogle_v09_GG 04/30/25

CBRE