

150 CAPITAL DRIVE SUITE 140 & 150

GOLDEN, CO 80401

6,500 RSF

WAREHOUSE SUBLEASE | AVAILABLE IMMEDIATELY



BUILDING SPECIFICATIONS

Complex	Corporate Center
Address	150 Capital Drive Suite 140 & 150 Golden, CO 80401
Available	Immediately
Asking Rate	\$12.00/SF Modified Gross
Size	6,500 SF
Lease Term	Through 8/31/2027

HIGHLIGHTS

- Warehouse/Storage space available
- Gas/Heat subject to additional cost
- Sky Lights
- Dock High Loading (x4)
- 14'-16' Clearance Height
- Easily Divisible
- Private Front Entrances
- Shorter length lease terms and less than full premises deals will be considered, but rate may be subject to change
- Potential for shared restrooms
- Shared workspace opportunities will be considered on a case-by-case basis

Building Exterior



Loading Area



Warehouse & Loading

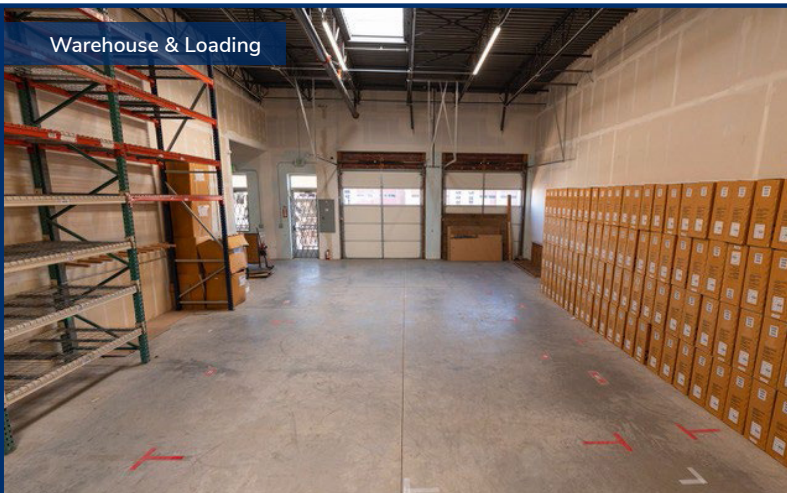

Overall Building



FLOOR PLAN

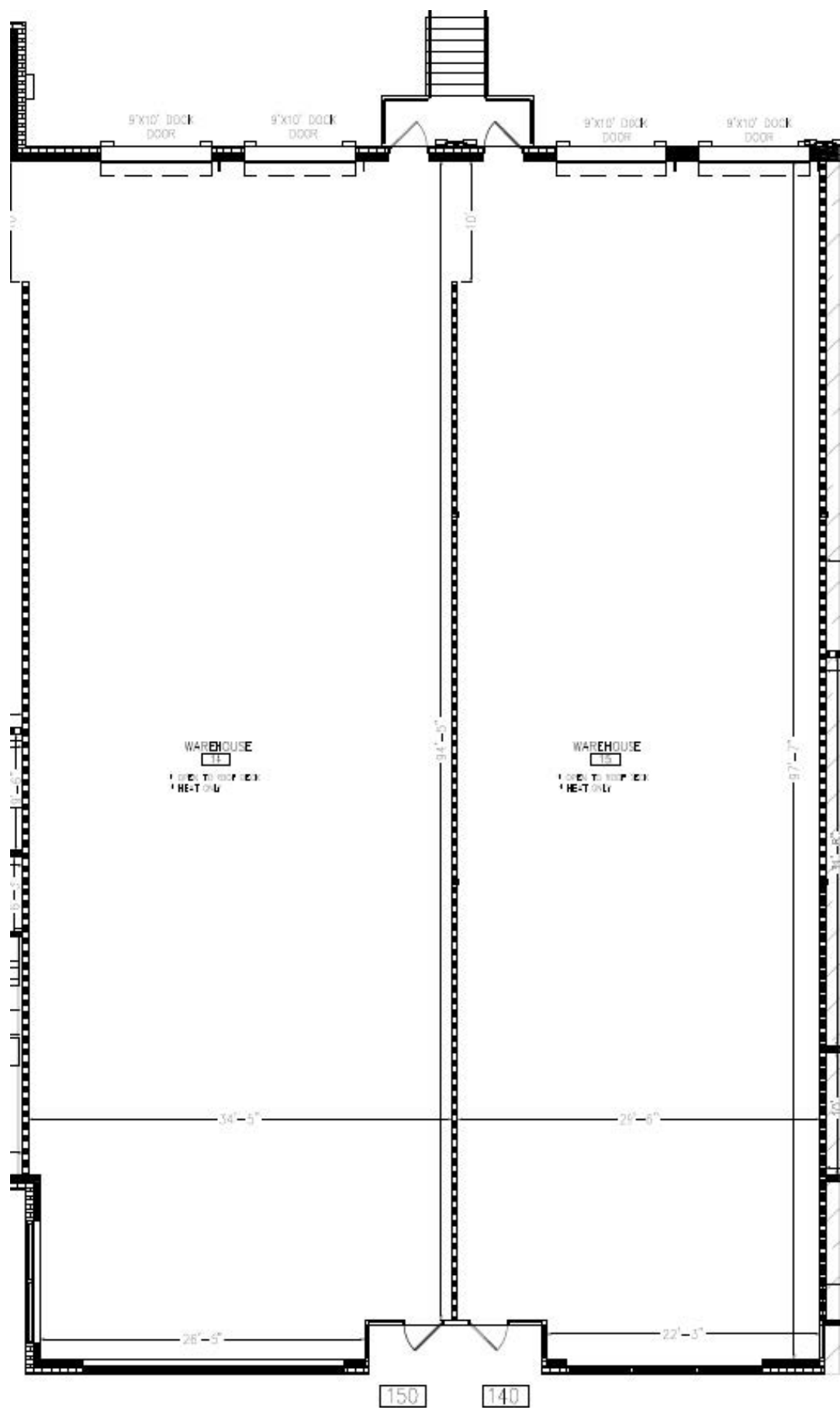

MAP

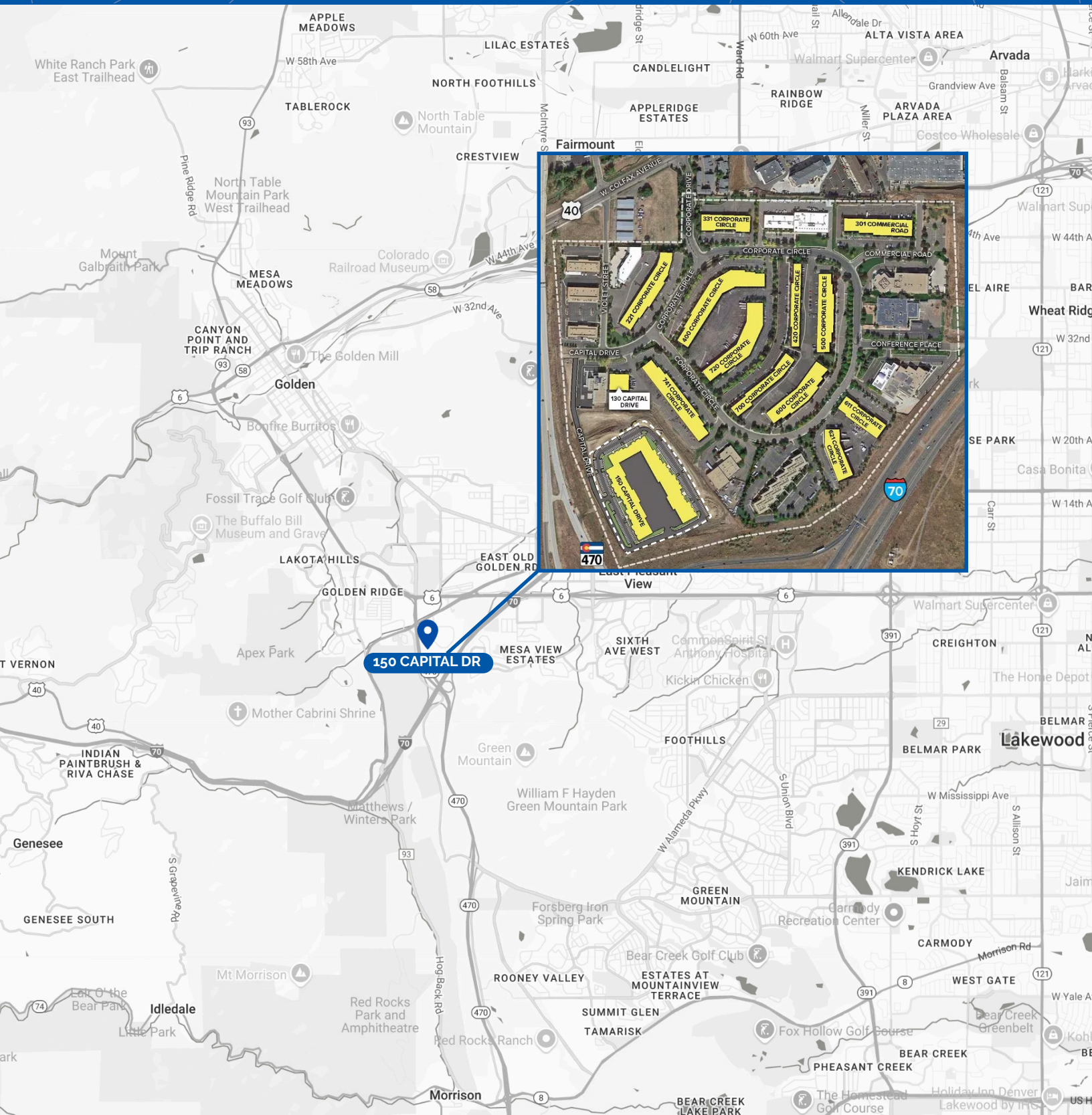

FOR LEASE INFORMATION:

MARC FELDMAN
marc.feldman@streamrealty.com
303.957.5307

