

Publix #0705 - Pinellas Shopping Center

857 West Bay Drive
Largo, FL 33770
Lat 27.915, Long -82.798

FOR LEASE



2,567 - 7,588 SF AVAILABLE

PROPERTY HIGHLIGHTS

- Publix-Anchored Center
- Located at a Primary Intersection in the Trade Area
- Densely Populated
- Signalized Intersection
- Pylon Signage Available
- Established Mix of Local and National Tenants
- Combined Traffic Count: 36,000 VPD

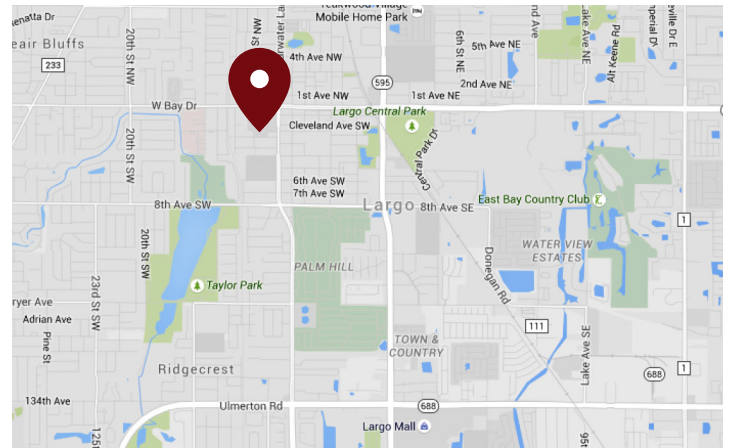

DEMOGRAPHICS	1 Mile	3 Miles	5 Miles
Total Population	13,209	102,834	243,339
Daytime Population	13,042	96,105	241,220
Total Households	6,409	47,846	110,089
Avg. HH Income	\$71,539	\$71,651	\$76,960

Data provided by Placer Labs Inc. (www.placer.ai) & Esri

Sandra Woodworth

813.210.7509 | swoodworth@crossmanco.com
9950 Princess Palm Avenue, Suite 340, Tampa, FL

Licensed Real Estate Broker. No warranty expressed or implied has been made to the accuracy of the information provided herein, no liability assumed for error or omission.



www.crossmanco.com

Publix #0705 - Pinellas Shopping Center

857 West Bay Drive
 Largo, FL 33770
 Lat 27.915, Long -82.798

SITE PLAN

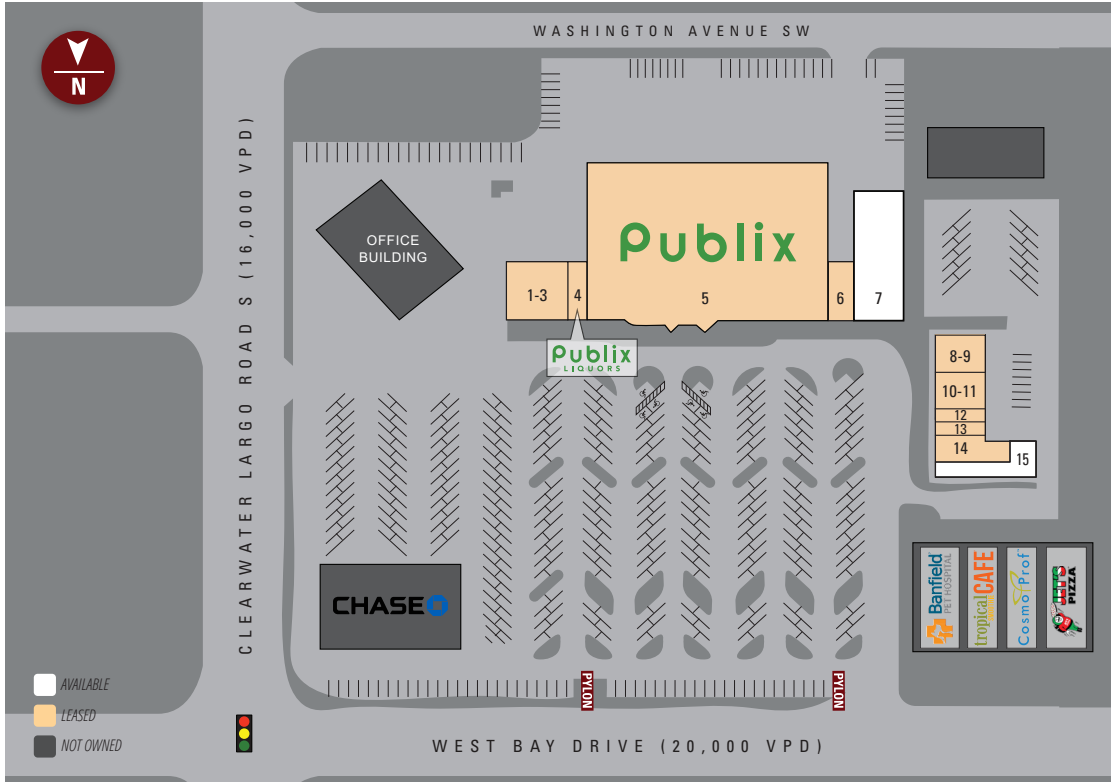

Suite	Tenant	Size
5	Publix	44,702
1-3	Salon West	4,225
4	Publix Liquors	1,386
6	Sound Advice Hearing Solutions	1,761
7	AVAILABLE	7,588
8-9	Paris Nails	1,280
10-11	Pearl Dental	2,000
12	Great Hair Expectations	500
13	Wok & Roll	1,250
14	Sage's West Bay Bistro	2,023
15	AVAILABLE	2,567

TOTAL 70,282



Sandra Woodworth

813.210.7509 | swoodworth@crossmanco.com
 9950 Princess Palm Avenue, Suite 340, Tampa, FL

Licensed Real Estate Broker. No warranty expressed or implied has been made to the accuracy of the information provided herein, no liability assumed for error or omission.



Crossman & Company

www.crossmanco.com

Publix #0705 - Pinellas Shopping Center

857 West Bay Drive
Largo, FL 33770
Lat 27.915, Long -82.798

FOOT TRAFFIC OVERVIEW

EST. # OF CUSTOMERS ANNUALLY



EST. # OF VISITS ANNUALLY



AVG. VISITS / CUSTOMER



AVG. LENGTH-OF-STAY / VISIT



TOP 3 DAYS



Friday	161,722
Monday	161,630
Saturday	155,566

OF VISITS

TOP 3 HOURS



12-1 PM	207,113
3-4 PM	202,254
1-2 PM	198,517

OF VISITS

Data provided by Placer Labs Inc. (www.placer.ai) March 1, 2021 - February 28, 2022

SITE VISIT DENSITY

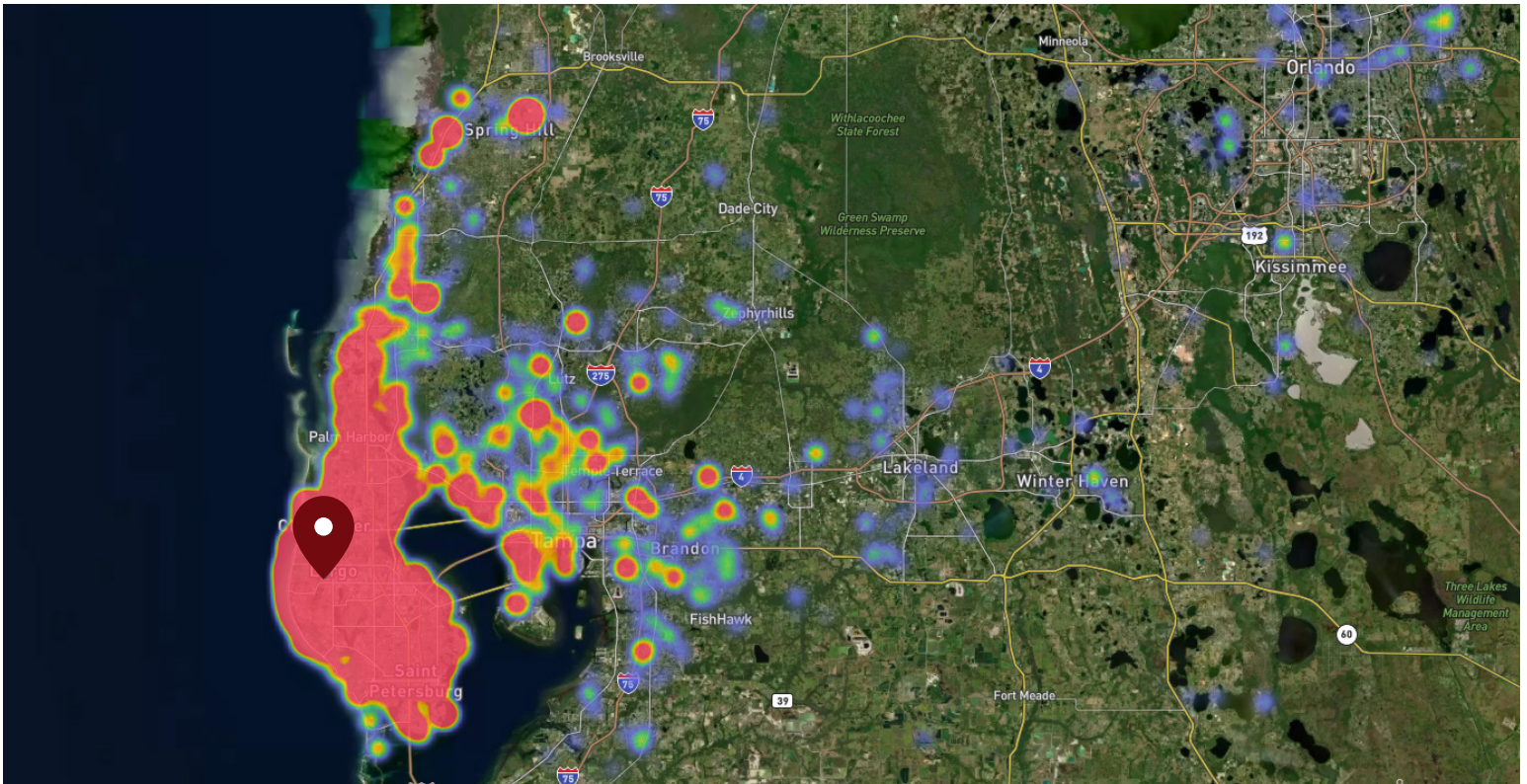

Red, orange, and yellow colors represent the location of 60% of site visitors

Data provided by Placer Labs Inc. (www.placer.ai)

Sandra Woodworth

813.210.7509 | swoodworth@crossmanco.com
9950 Princess Palm Avenue, Suite 340, Tampa, FL

Licensed Real Estate Broker. No warranty expressed or implied has been made to the accuracy of the information provided herein, no liability assumed for error or omission.



Crossman & Company

www.crossmanco.com