

# 49,783 SF Office/Warehouse for Sublease

Colliers

3190 RIDER TRAIL SOUTH  
EARTH CITY, MO 63045



## CONTACT US

### Dan Lesinski

Senior Vice President  
+1 314 412 4345  
dan.lesinski@colliers.com

### Billy Spence

Associate  
+1 636 278 0565  
billy.spence@colliers.com

### Colliers

101 South Hanley Road  
Suite 1400  
St. Louis, MO 63105  
+1 314 863 4447  
colliers.com/stlouis

# Property Overview

<b>Property Address</b>	3190 Rider Trail South Earth City, MO 63045
<b>Total Available Area</b>	49,783 SF
<b>Use</b>	Office/Warehouse
<b>Availability Date</b>	Immediately available
<b>Office SF</b>	37,337 SF (approx. 18,000 SF in 2nd floor mezzanine)
<b>Warehouse SF</b>	12,446 SF
<b>Loading</b>	Four (4) docks One (1) drive-in
<b>Ceiling Height</b>	30'
<b>Sublease Expiration Date</b>	7/31/2026

## Sublease Rate

\$11.50/SF, Gross

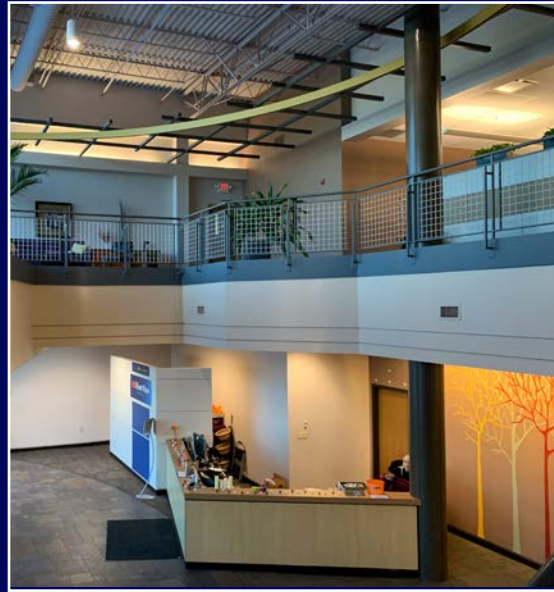

# Floor Plan

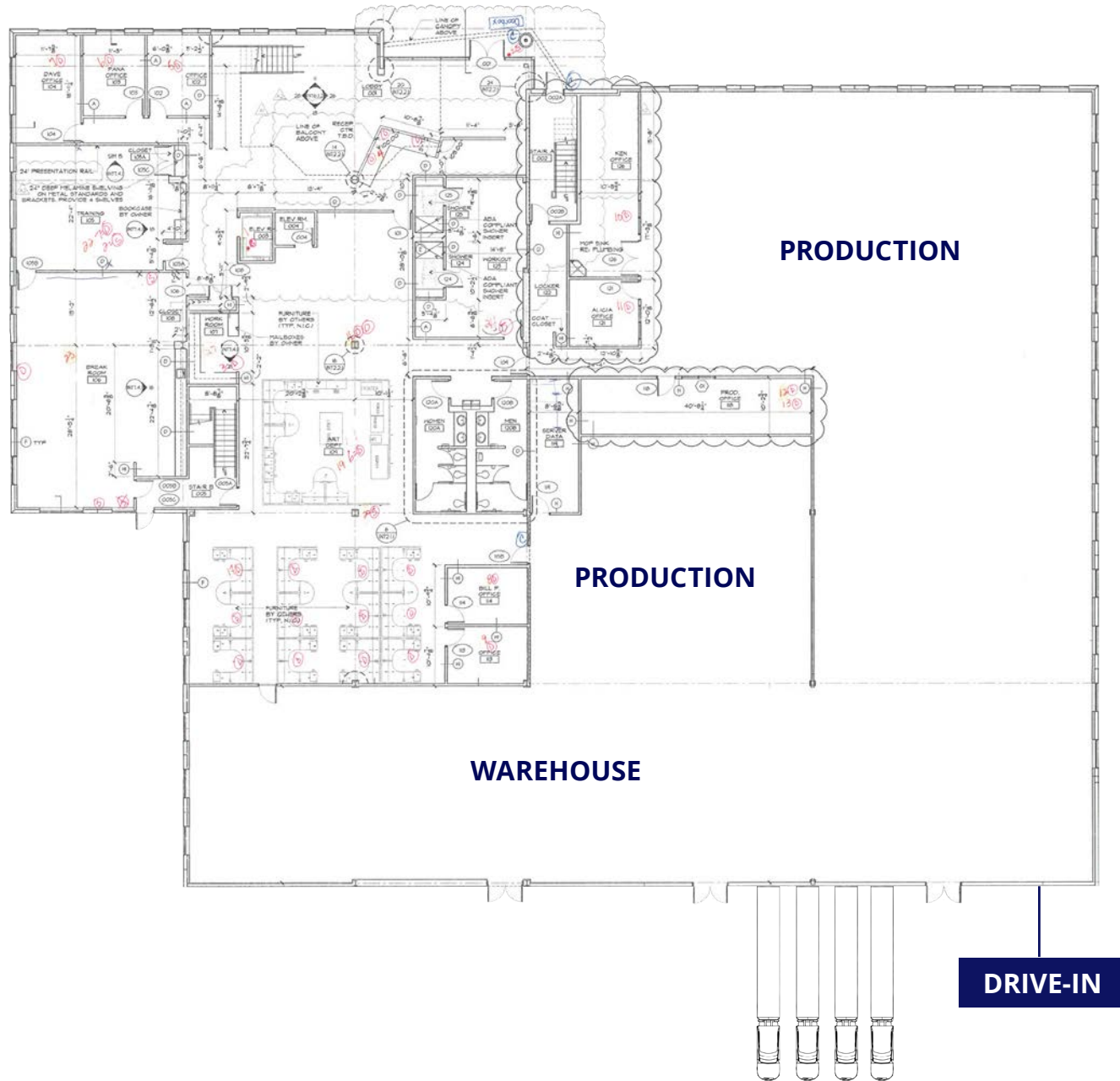

# Convenient Highway Access





**CONTACT US**

**Dan Lesinski**  
 Senior Vice President  
 +1 314 412 4345  
 dan.lesinski@colliers.com

**Billy Spence**  
 Associate  
 +1 636 278 0565  
 billy.spence@colliers.com

**Colliers**  
 101 South Hanley Road  
 Suite 1400  
 St. Louis, MO 63105  
 +1 314 863 4447  
 colliers.com/stlouis

This document/email has been prepared by Colliers for advertising and general information only. Colliers makes no guarantees, representations or warranties of any kind, expressed or implied, regarding the information including, but not limited to, warranties of content, accuracy and reliability. Any interested party should undertake their own inquiries as to the accuracy of the information. Colliers excludes unequivocally all inferred or implied terms, conditions and warranties arising out of this document and excludes all liability for loss and damages arising there from. This publication is the copyrighted property of Colliers and /or its licensor(s). ©2024. All rights reserved. This communication is not intended to cause or induce breach of an existing listing agreement.