



# MIDTOWN PLAZA

## One. Two

**CLASS A OFFICE SPACE FOR LEASE**

### **One MIDTOWN PLAZA**

1360 Peachtree Street  
Atlanta, Georgia 30309

### **Two MIDTOWN PLAZA**

1349 West Peachtree Street  
Atlanta, Georgia 30309

# Property Specs

One Midtown Plaza	1360 Peachtree St, Atlanta, GA 30309
Two Midtown Plaza	1349 West Peachtree St, Atlanta GA 30309
Submarket	Midtown
Classification	Class A Office
Year Built	1984 / 1986
No. of Stories	14 / 20
RSF Total	506,108 RSF
One Midtown Plaza	233,344 RSF
Two Midtown Plaza	272,764 RSF
Parking	2.0 / 1,000







Fitness  
Center

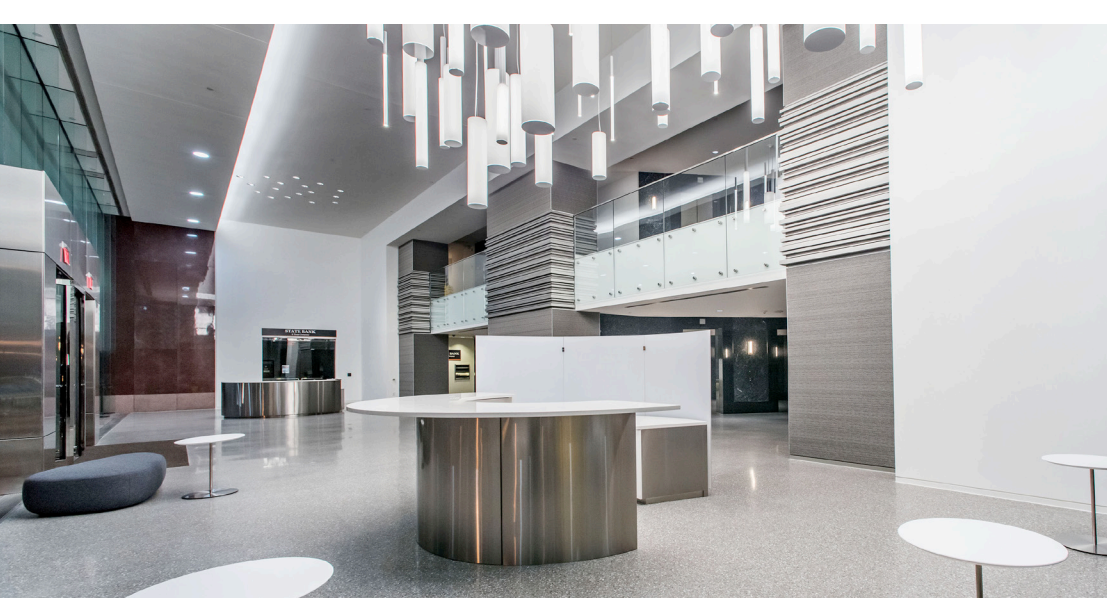

Onsite Cafē -  
Metro Fresh



Bank / ATM

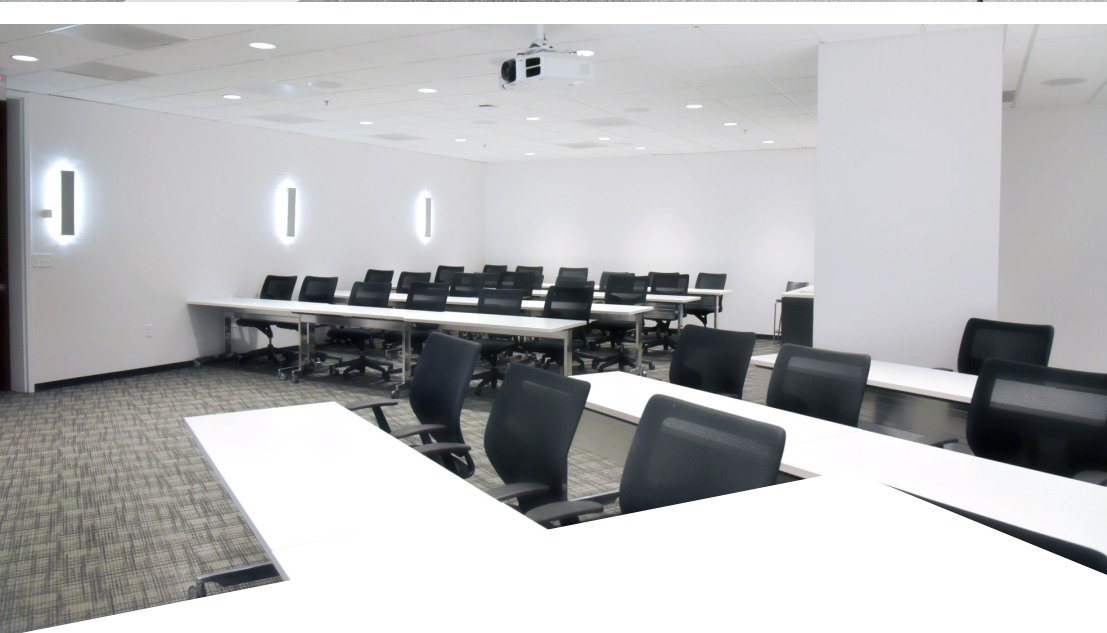

24-Hour  
Security and  
card access



EV charging  
stations



Access to  
I-75/85 and  
MARTA

# Premium Amenities



# Prime Location



**PIEDMONT  
PARK**

**MIDTOWN  
ATLANTA**

**DOWNTOWN  
ATLANTA**

**MIDTOWN PLAZA  
One . Two**

**WOODRUFF  
ARTS CENTER**

INGRESS   
EGRESS 



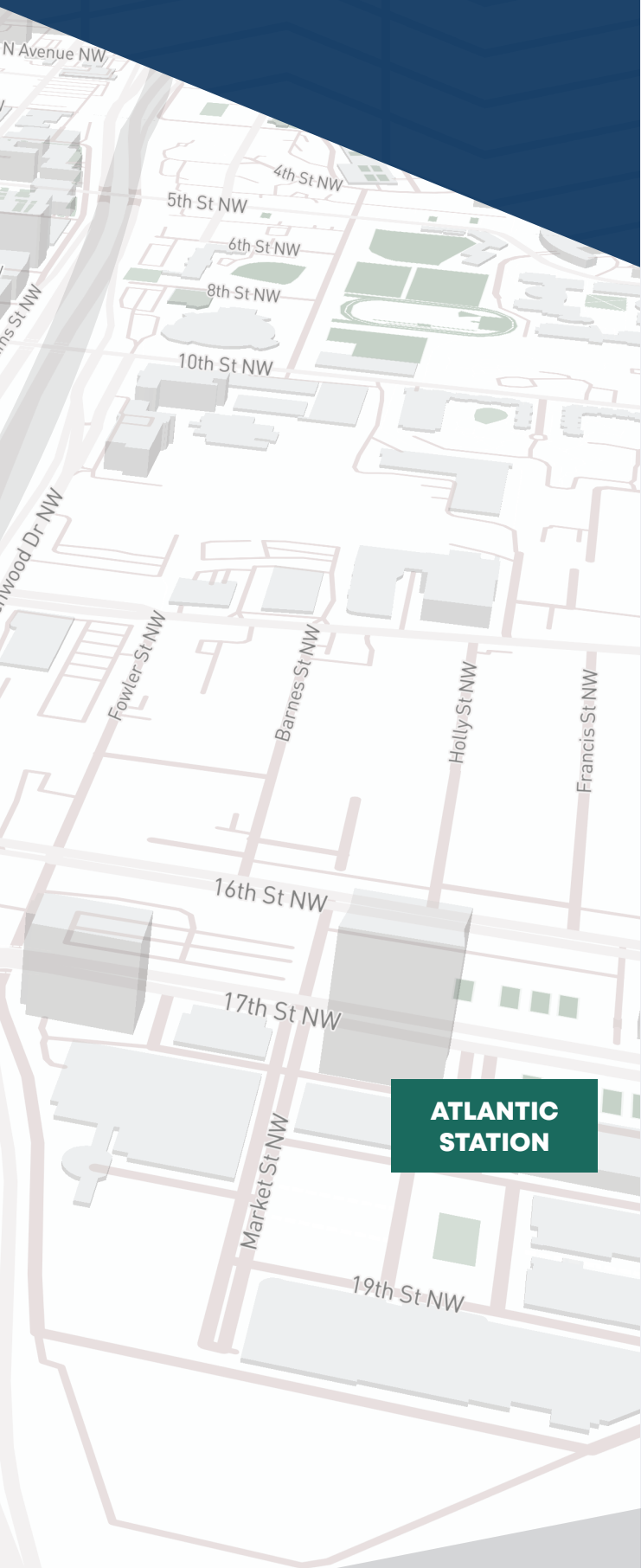

- Prestigious Peachtree Street Class A office environment with timeless appeal.
- Strategic location at the intersection of Peachtree Street & 17th Street with three points of egress at the Property creates unrivaled accessibility.
- Direct access to mass transit via the Arts Center MARTA Station just steps away.
- Full complement of on-site amenities including a high-end conference center, fitness center, full service cafe, coffee bar, bank, and EV charging station.
- Ample and convenient parking within two interconnected garage structures.
- Unique vibrant setting within Atlanta's most urbanized and mixed-use submarket
- "Millennial Appeal" - Midtown Plaza offers the urban environment and amenity base that appeals to companies trying to attract and retain millennial talent.



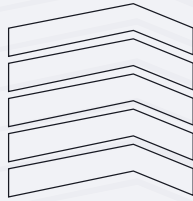

# MIDTOWN PLAZA

## One . Two



One Midtown Plaza . 1360 Peachtree Street  
Two Midtown Plaza . 1349 West Peachtree Street  
Atlanta, Georgia 30309



**Lincoln**

**Michael Howell**  
Executive VP  
mhowell@lpc.com

**Gil Russell**  
Vice President  
grussell@lpc.com

**Alex Port**  
Leasing Associate  
rdegolian@lpc.com