

4290 Delp St.

Memphis, Tennessee 38118

NAI Saig Company

Available for Lease
63,840 SF +/- Industrial Space



7 (10' x 10')
Dock High Doors with
EOD's & seals



22' Clear height



Convenient to I-240, I-385, Hwy 78
Memphis International Airport, and
FedEx and UPS hubs

Property Features

5 (10' x 10') Rail Doors

1 Drive-in door

Ample parking

42' x 38' Column Spacing

Sprinkler: 0.79gpm/1,500 SF

Concrete tilt-up construction

Please contact

Brian Califf, CCIM

Executive Vice President
(901) 526-3100

bcaliff@saigcompany.com

Reynolds Willis

Associate
(901) 526-3100

rwillis@saigcompany.com



Faropoint

FLOOR PLAN

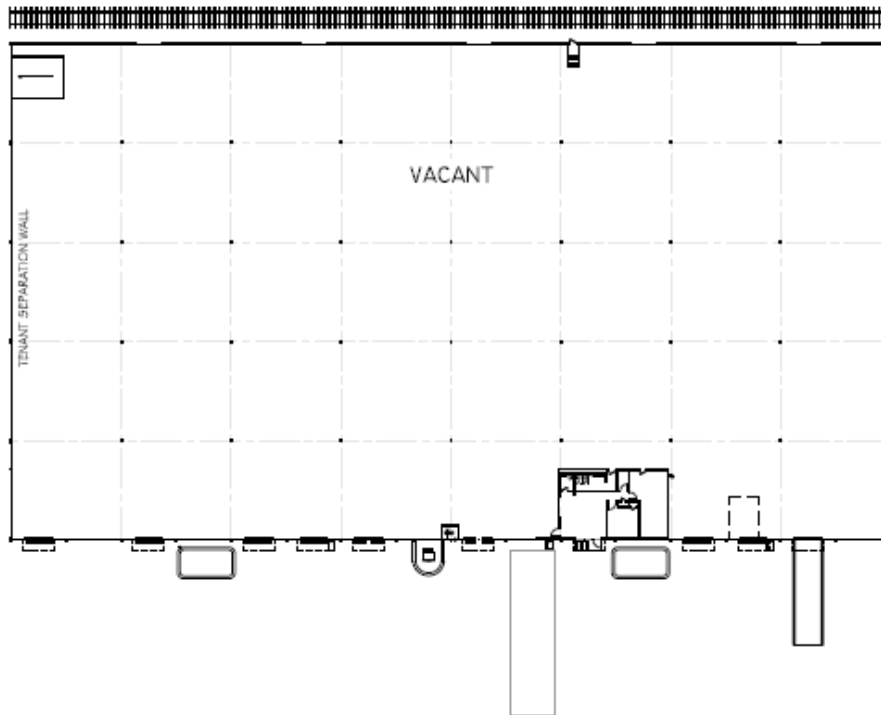

BUILDING PLAN

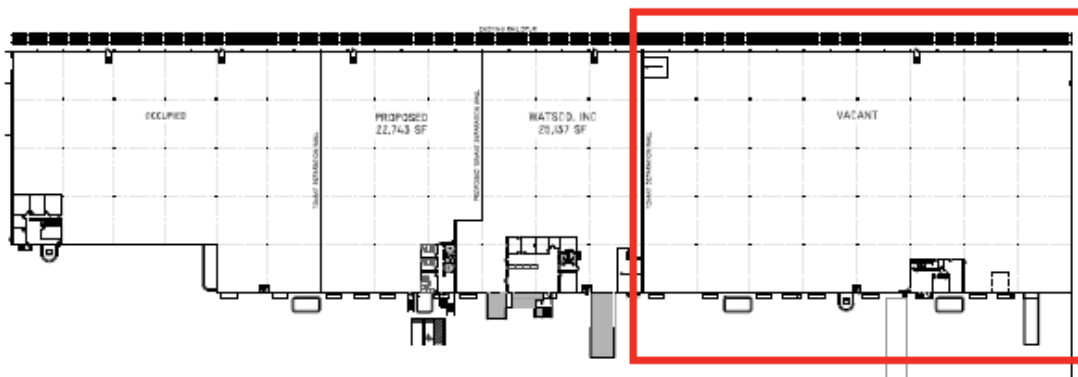

Please contact

Brian Califf, CCIM

Executive Vice President

(901) 526-3100

bcaliff@saigcompany.com

Reynolds Willis

Associate

(901) 526-3100

rwillis@saigcompany.com



Faropoint

SAI Saig Company

NO WARRANTY OR REPRESENTATION, EXPRESS OR IMPLIED, IS MADE AS TO THE ACCURACY OF THE INFORMATION CONTAINED HEREIN, AND THE SAME IS SUBMITTED SUBJECT TO ERRORS, OMISSIONS, CHANGE OF PRICE, RENTAL OR OTHER CONDITIONS, PRIOR SALE, LEASE OR FINANCING, OR WITHDRAWAL WITHOUT NOTICE, AND OF ANY SPECIAL LISTING CONDITIONS IMPOSED BY OUR PRINCIPALS NO WARRANTIES OR REPRESENTATIONS ARE MADE AS TO THE CONDITION OF THE PROPERTY OR ANY HAZARDS CONTAINED THEREIN ARE ANY TO BE IMPLIED.