

AVAILABLE FOR SUBLEASE

1672 DELTA COURT | HAYWARD, CA



COMMERCIAL REAL ESTATE SERVICES



LISTING DATA:

- 6,500± SF Shared Space
- 2 Exclusive Docks
- 1 Shared Grade Level Door
- 2 Exclusive Offices
- 1 Exclusive Restroom
- Easy Access to I-880

ECONOMIC DATA:

- Lease Rate: \$1.05/SF, I.G.
- LED: August 31, 2027
(Shorter Term Considered)
- Available Now

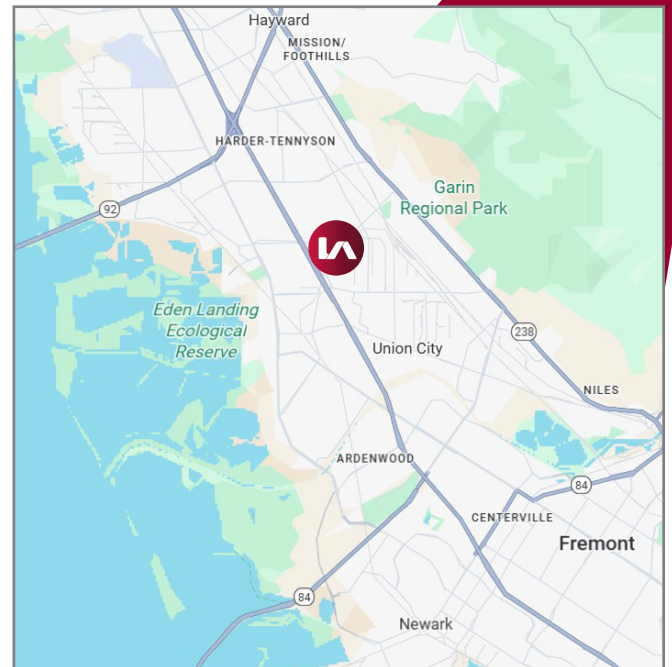

EXCLUSIVE AGENTS:

Michael MacDonald, Associate
E || mmacdonald@lee-associates.com
P || 510.907.3024 | LIC# 02180613

Chris Schofield, SIOR/Principal
E || cschofield@lee-associates.com
P || 510.903.7608 | LIC# 01326198

Lee & Associates Oakland Commercial Real Estate | 555 12th Street, Suite 1725, Oakland, CA 94607 | www.lee-associates.com

All information furnished regarding property for sale, rental or financing is from sources deemed reliable, but no warranty or representation is made to the accuracy thereof and same is submitted to errors, omissions, change of price, rental or other conditions prior to sale, lease or financing or withdrawal without notice. No liability of any kind is to be imposed on the broker herein.

AVAILABLE FOR SUBLEASE

1672 DELTA COURT | HAYWARD, CA



COMMERCIAL REAL ESTATE SERVICES

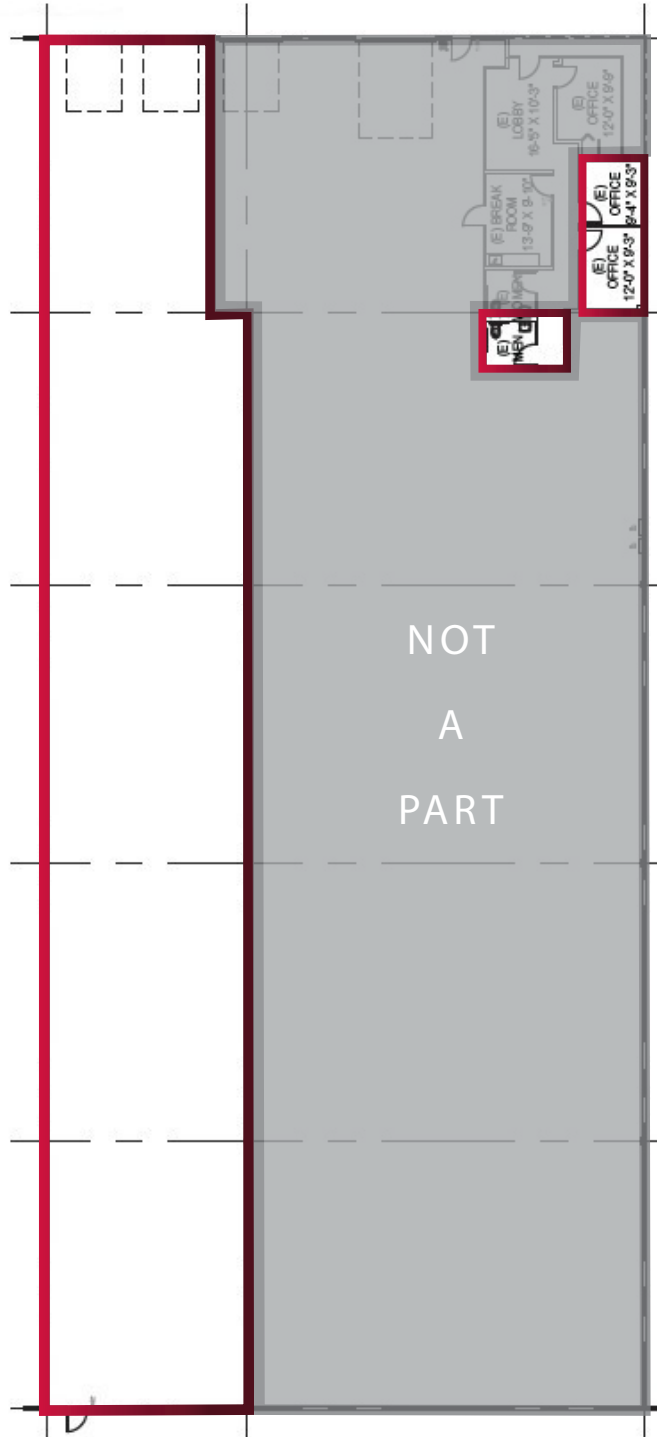

EXCLUSIVE AGENTS:

Michael MacDonald, Associate
E \\ mmacdonald@lee-associates.com
P \\ 510.907.3024 | LIC# 02180613

Chris Schofield, SIOR/Principal
E \\ cschofield@lee-associates.com
P \\ 510.903.7608 | LIC# 01326198

Lee & Associates Oakland Commercial Real Estate \ 555 12th Street, Suite 1725, Oakland, CA 94607 \ www.lee-associates.com

All information furnished regarding property for sale, rental or financing is from sources deemed reliable, but no warranty or representation is made to the accuracy thereof and same is submitted to errors, omissions, change of price, rental or other conditions prior to sale, lease or financing or withdrawal without notice. No liability of any kind is to be imposed on the broker herein.