

# Building Sketch

Borrower				
Property Address 2726 Brownsboro Rd				
City	Louisville	County	Jefferson	State KY Zip Code 40206
Lender/Client				

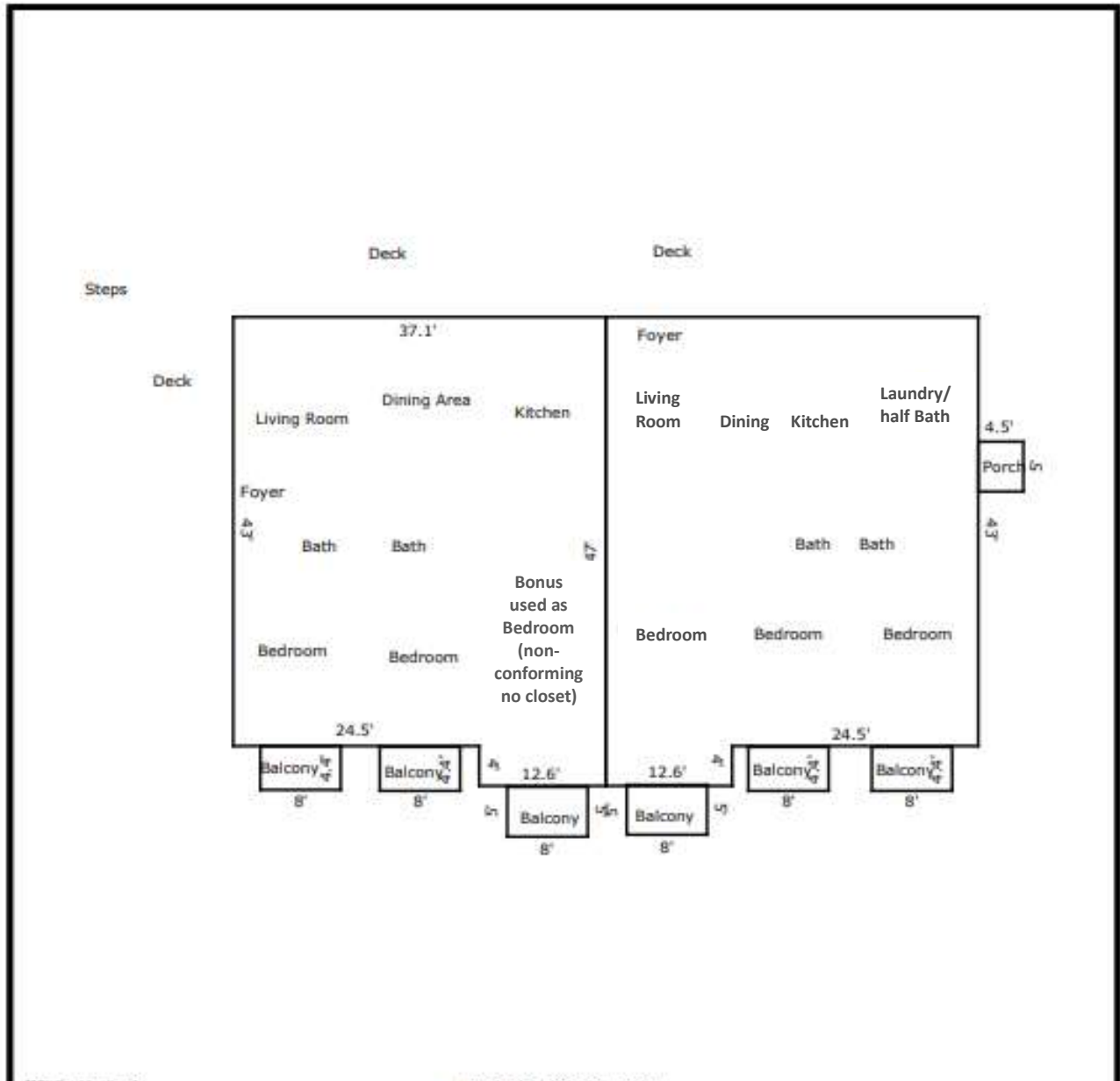

TOTAL Sketch by a to scale

### Area Calculations Summary

Living Area	Calculation Details	
First Floor	1645.7 Sq ft	37.1 × 43 = 1595.3 4 × 12.6 = 50.4
First Floor	1645.7 Sq ft	37.1 × 43 = 1595.3 4 × 12.6 = 50.4
<b>Total Living Area (Rounded):</b>	<b>3291 Sq ft</b>	
Non-living Area		
Porch	22.5 Sq ft	4.5 × 5 = 22.5
Balcony	40 Sq ft	5 × 8 = 40
Balcony	35.2 Sq ft	8 × 4.4 = 35.2
Balcony	35.2 Sq ft	8 × 4.4 = 35.2
Balcony	35.2 Sq ft	8 × 4.4 = 35.2
Balcony	35.2 Sq ft	8 × 4.4 = 35.2
Balcony	40 Sq ft	5 × 8 = 40

Borrower				
Property Address	2726 Brownsboro Rd			
City	Louisville	County	Jefferson	State KY Zip Code 40206
Lender/Client				

The attached sketch is based upon exterior dimension measurement for the main level and porches. Measurements were made to the nearest inch, but calculations were rounded to the nearest square foot for calculation. Porch/balconies were measured in a similar manner. Deck is wrap style and irregular along the side and rear area of the building.

\*\* Interior inspection was only made of the LEFT unit. NO INTERIOR INSPECTION WAS MADE OF THE RIGHT UNIT.  
\*\* Blueprints/floor plans were provided by the agent, with rooms listed per those plans.

No inspection was made of the crawl space.

Measurement accuracy is sometimes limited by the required use of interior measurements and vegetation; however, the measurements herein are considered to be reliable.

Measurements were taken on 10/3/2024.

Total Above Grade area: 3,291 square feet

\*\* Each unit has 1645.7 square feet