



informa

@ PORT EVERGLADES

1700 Eller Drive, Suite B | Hollywood, FL 33316

CONTACT US

Tom O'Loughlin
Vice Chairman
+1 954 356 0468
tom.oloughlin@cbre.com

Larry Dinner
Senior Vice President
+1 561 289 1144
larry.dinner@cbre.com

informa

50,000 SF
Available

*Exceptional
Class A New Construction
with Unmatched
Connectivity*

Property Features

- + ±50,000 SF - Suite B Available
- + Warehouse: ±48,220 SF
- + Office: ±1,780 SF
- + ±7 trailer drops
- + ±36' clear height
- + 6 dock high doors (1 pit leveler)
- + 1 oversized drive-in ramp
- + Concrete tilt-wall construction
- + Double height hurricane impact glass
- + 1/1,000 SF Parking Ratio
- + ESRF
- + 400 Amps of 3-phase 480v power
- + 185' private truck court
- + 6 points of ingress/egress to the site (2 dedicated for trucks)
- + Great location within Port
- Everglades, Fort Lauderdale/Hollywood Airport and I-595
- + Potential Foreign-Trade Zone (FTZ)
- + Available Immediately

Location Access

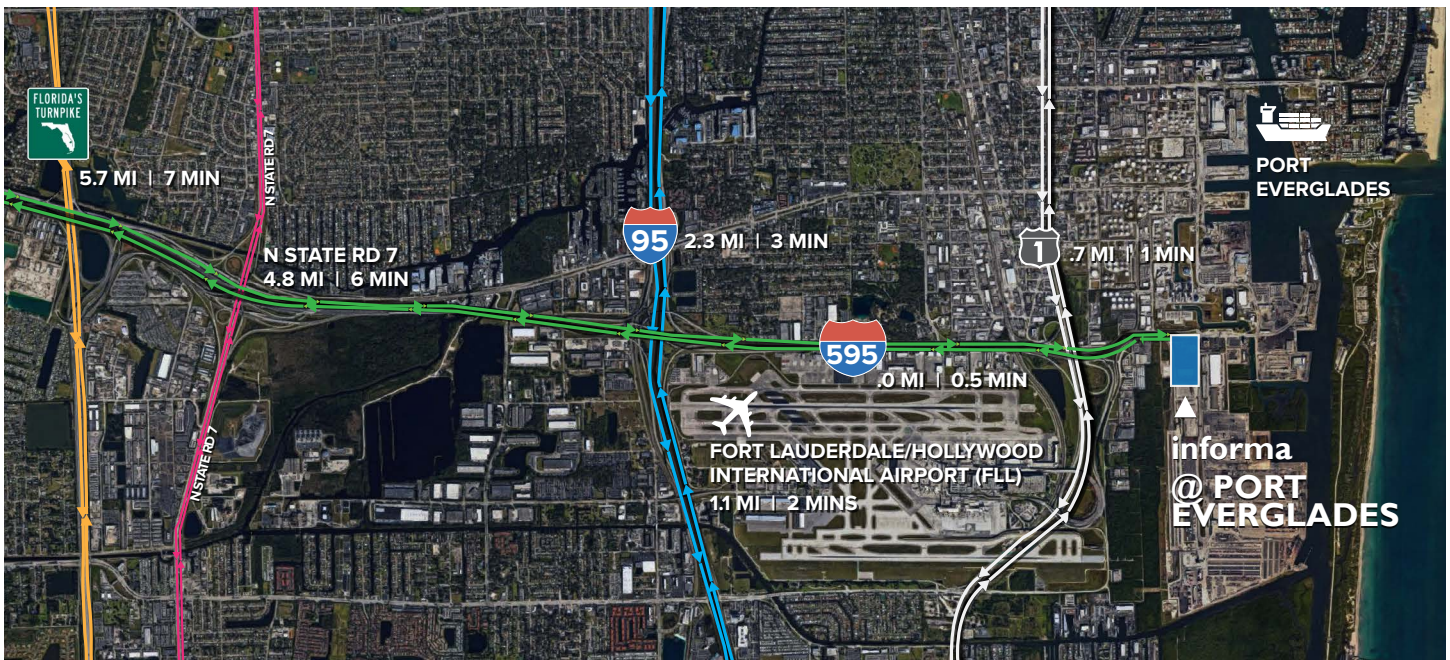

Rear Loading



Site Plan



© 2024 CBRE, Inc. All rights reserved. This information has been obtained from sources believed reliable, but has not been verified for accuracy or completeness. You should conduct a careful, independent investigation of the property and verify all information. Any reliance on this information is solely at your own risk. CBRE and the CBRE logo are service marks of CBRE, Inc. All other marks displayed on this document are the property of their respective owners, and the use of such logos does not imply any affiliation with or endorsement of CBRE. Photos herein are the property of their respective owners. Use of these images without the express written consent of the owner is prohibited.

Office Floor Plan

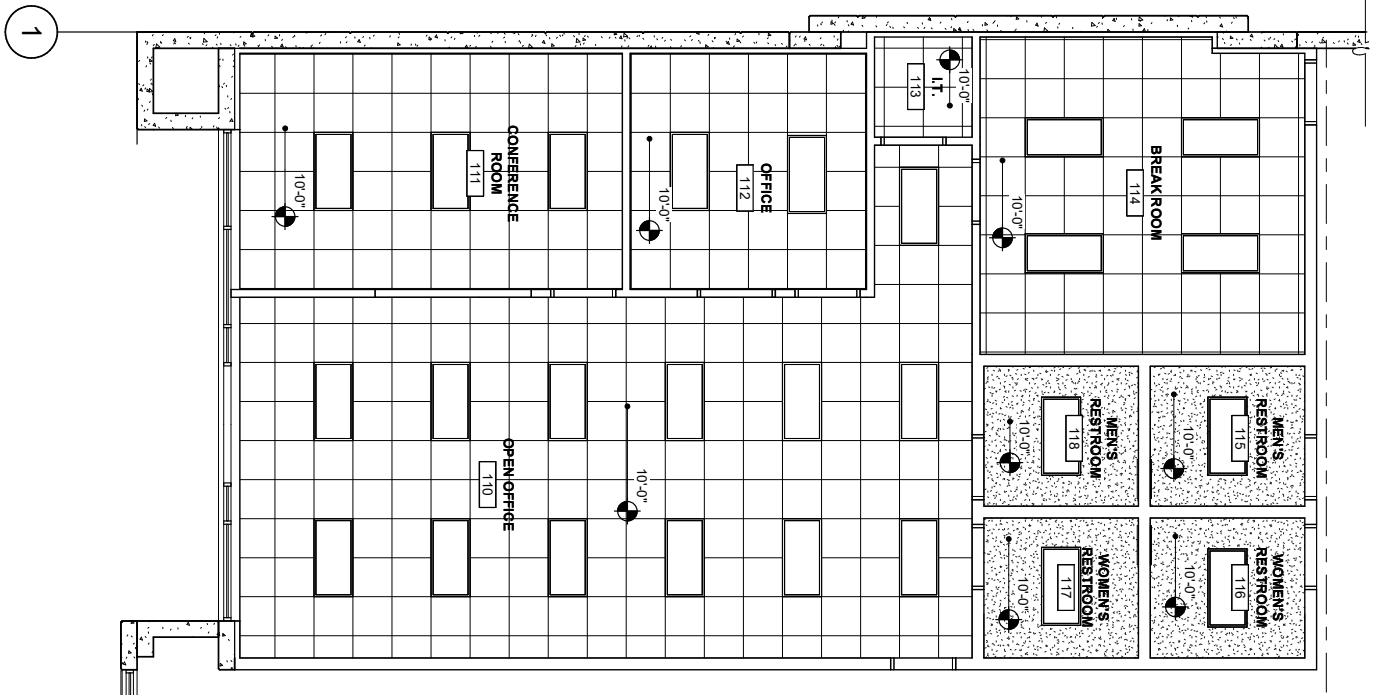

Building Floor Plan

