

SUBLEASE

±35,880 – 75,348 SF AVAILABLE



STEPHANIE COMMERCE CENTER

1300 WIGWAM PARKWAY, HENDERSON, NV 89074



PROPERTY HIGHLIGHTS

Stephanie Commerce Center is a Class A distribution building in Henderson, Nevada. The building is located minutes off the I-215 via Stephanie St.

LOCATION HIGHLIGHTS

- + 0.8 Miles to I-215 via Stephanie St.
- + Henderson Jurisdiction
- + Zoned: IP-MP Industrial Park Master Plan

PROPERTY FEATURES

- + Building Size: $\pm 260,448$ SF
- + Available: $\pm 35,880 - 75,348$ SF
- + 32' Clear Height
- + Up to 16 Dock High Doors
- + 1 Drive Up Ramp
- + 480/277 V, 3-Ph power
- + ESFR fire suppression system
- + LED lighting
- + Column spacing: 50' x 52', with 52' x 60' speed bay at docks
- + 60' concrete dock apron
- + **Sublease Expires: September 30, 2027**

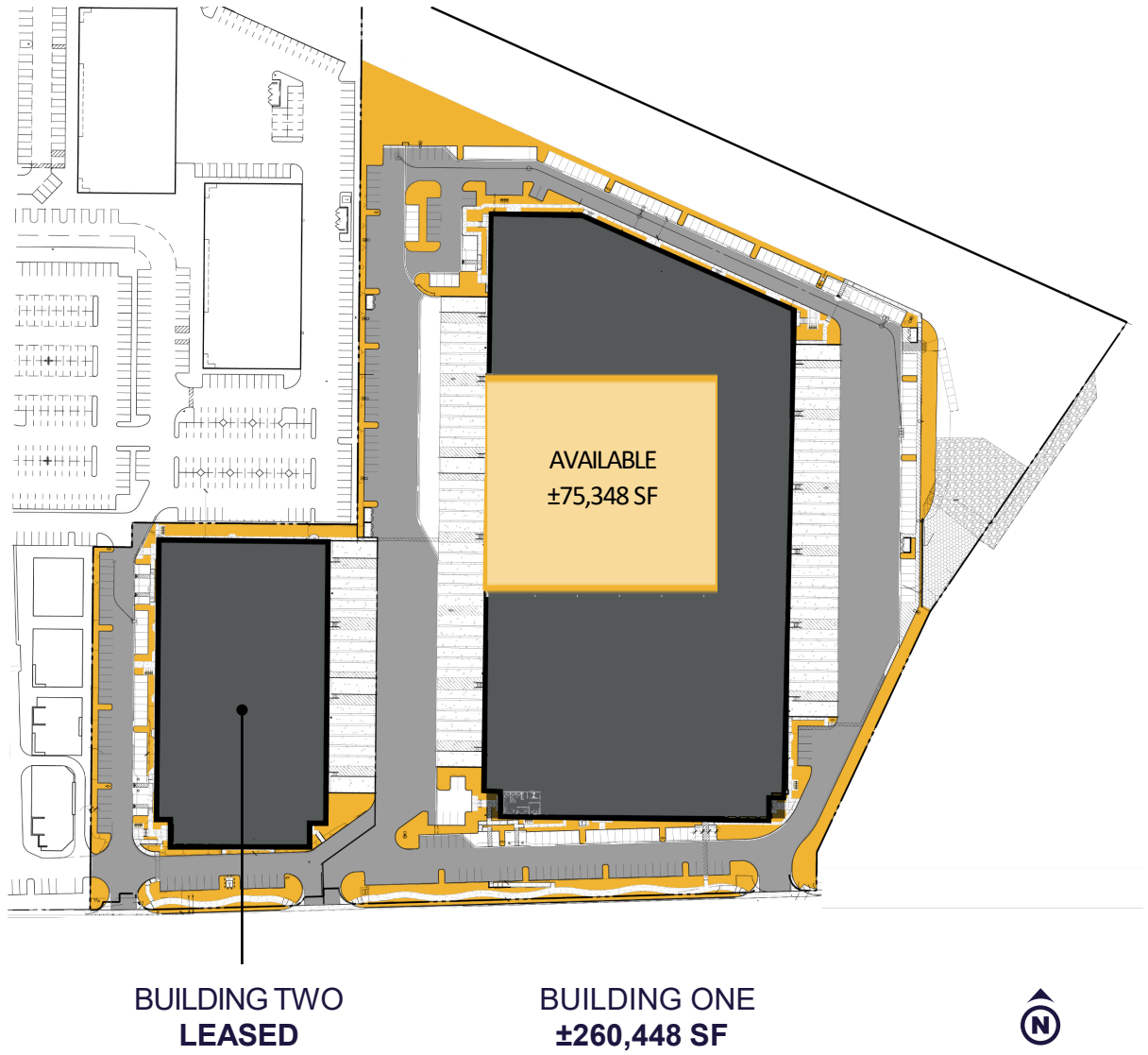

For Illustration Purposes Only. Not To Scale.

■ LEASED ■ AVAILABLE

SITE PLAN

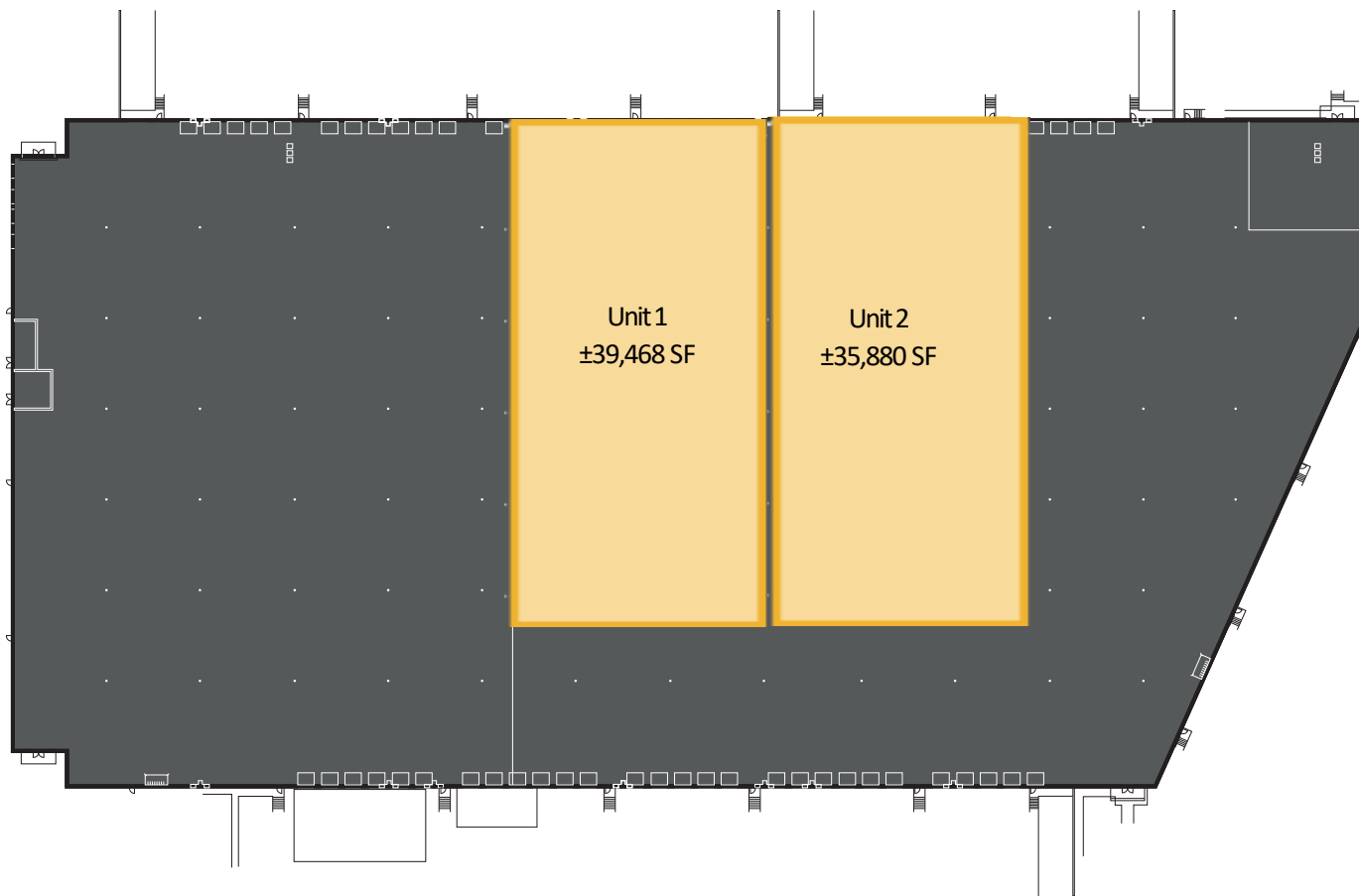

LEASED

AVAILABLE

PROPERTY LOCATION

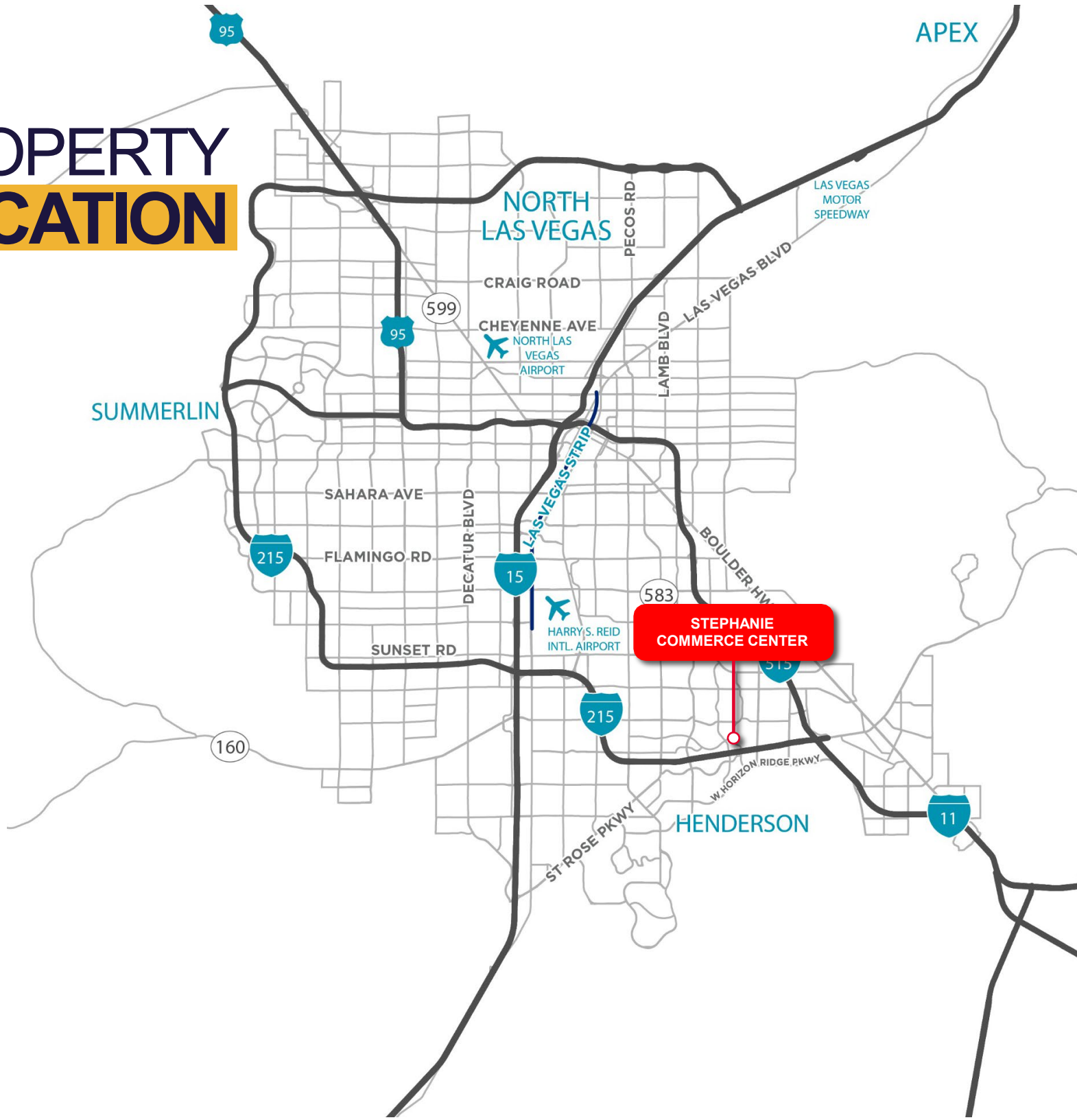



CONTACT INFORMATION



Alma Cuevas, SIOR

Managing Director

+1 702 303 4412

alma.cuevas@cushwake.com

S.0180089.LLC



Jason Griffis, SIOR

Managing Director

+1 702 205 3861

jason.griffis@cushwake.com

S.0178374

10845 Griffith Peak Dr., Suite 160 | Las Vegas, NV 89135 | +1 702 796 7900 | cushmanwakefield.com



©2026 Cushman & Wakefield. All rights reserved. The information contained in this communication is strictly confidential. This information has been obtained from sources believed to be reliable but has not been verified. NO WARRANTY OR REPRESENTATION, EXPRESS OR IMPLIED, IS MADE AS TO THE CONDITION OF THE PROPERTY (OR PROPERTIES) REFERENCED HEREIN OR AS TO THE ACCURACY OR COMPLETENESS OF THE INFORMATION CONTAINED HEREIN, AND SAME IS SUBMITTED SUBJECT TO ERRORS, OMISSIONS, CHANGE OF PRICE, RENTAL OR OTHER CONDITIONS, WITHDRAWAL WITHOUT NOTICE, AND TO ANY SPECIAL LISTING CONDITIONS IMPOSED BY THE PROPERTY OWNER(S). ANY PROJECTIONS, OPINIONS OR ESTIMATES ARE SUBJECT TO UNCERTAINTY AND DO NOT SIGNIFY CURRENT OR FUTURE PROPERTY PERFORMANCE.