

277 PILOT RD.

±39,746 SF FREESTANDING BUILDING ON ±2.15 ACRES

LAS VEGAS, NV 89119



CBRE

FOR LEASE

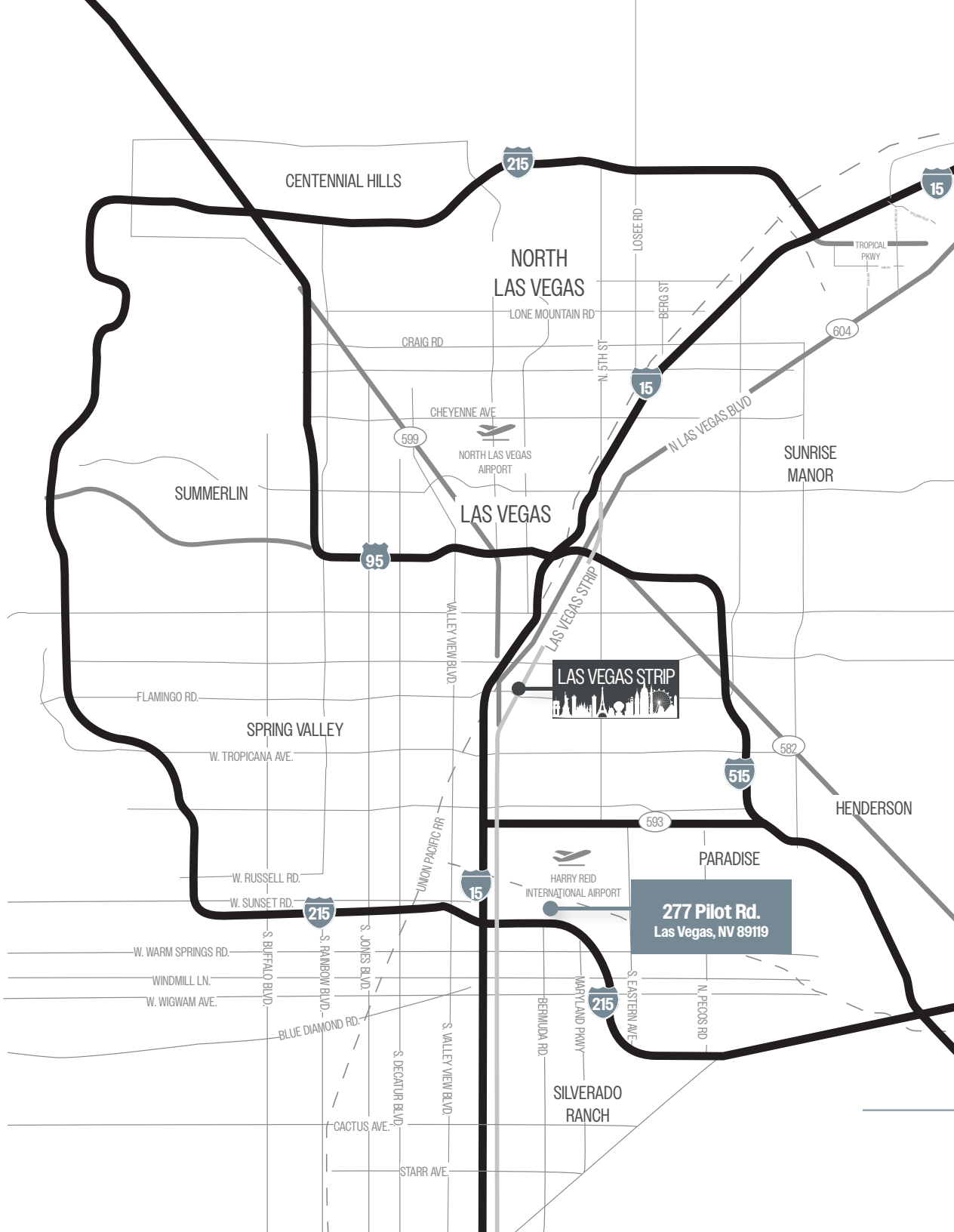

LOCATION HIGHLIGHTS

- Located in the highly desired Hughes Airport Center
- In close proximity to the Las Vegas Strip, Harry Reid International Airport, Town Square and numerous other amenities
- Excellent connectivity with access to the I-15 and 215 freeways via Sunset Road

PROPERTY HIGHLIGHTS

- ±39,746 SF freestanding building on ±2.15 acres
- Ideal corporate headquarters facility
- Secured yard
- IL Zoning (Clark County Jurisdiction)
- Evaporative cooled warehouse

CONTACT BROKER
FOR PRICING

SITE PLAN

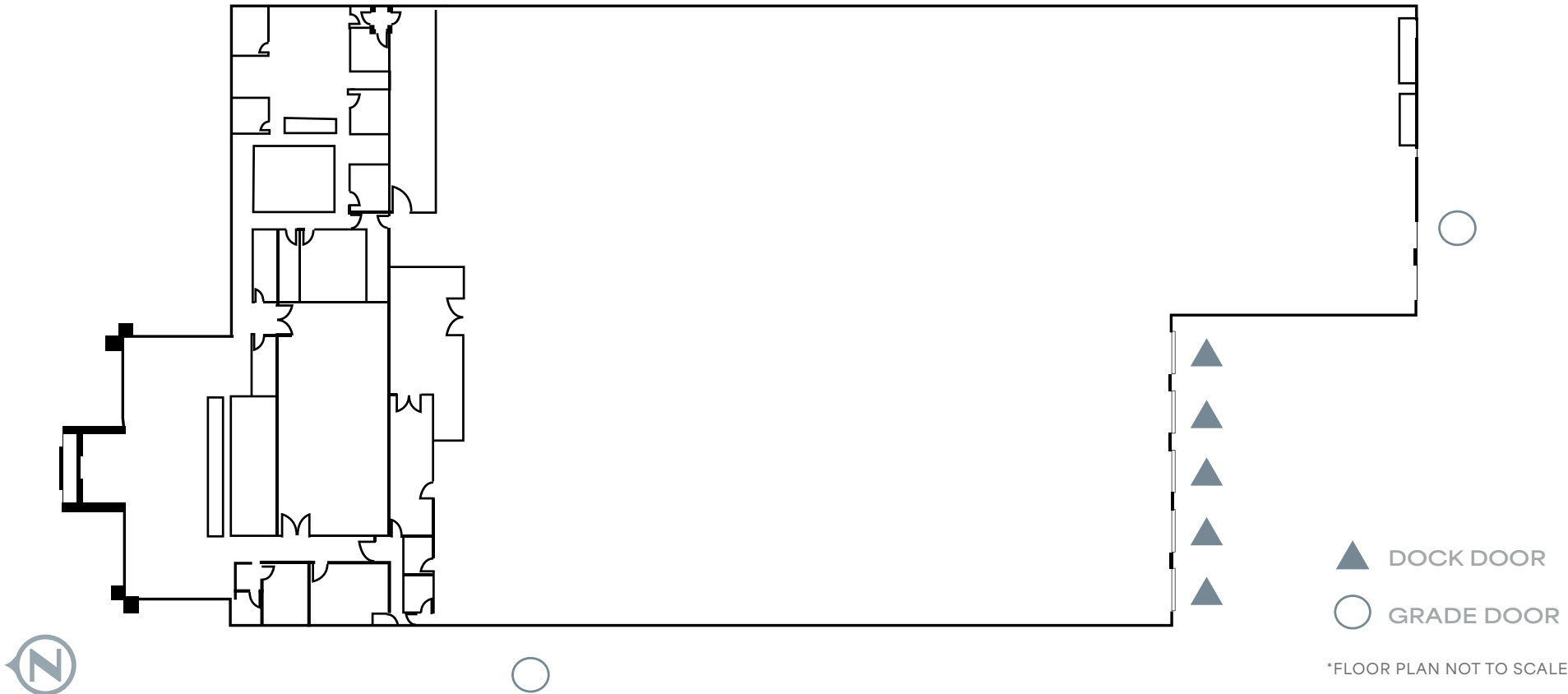

BUILDING SPECIFICATIONS

Total SF	±39,746 SF	Dock Doors	5 with pit levelers
Office SF	±9,746 SF	Grade Doors	2
Acres	±2.15	Fire Sprinklers	Yes
Yard	±0.32 acres	Auto Parking	63 stalls
Clear Height	22'	Insulation	Fully insulated warehouse walls
Configuration	Rear-loaded		

AMENITY MAP





277 PILOT RD.

LAS VEGAS, NV
89119

±39,746 SF FREESTANDING BUILDING ON ±2.15 ACRES

GARRETT TOFT, SIOR

Vice Chairman
+1 702 369 4868
garrett.toft@cbre.com
Lic. BS.0061824

JAKE HIGGINS, SIOR

Executive Vice President
+1 702 369 4844
jake.higgins@cbre.com
Lic. S.0176473

TYCE O'NEILL

Associate
+1 702 369 4860
tyce.oneill@cbre.com
Lic. S.0199727

CBRE LAS VEGAS
8548 Rozita Lee Ave.,
Suite 200
Las Vegas, Nevada 89113
www.cbre.us/lasvegas

CBRE

© 2025 CBRE, Inc. All rights reserved. This information has been obtained from sources believed reliable but has not been verified for accuracy or completeness. CBRE, Inc. makes no guarantee, representation or warranty and accepts no responsibility or liability as to the accuracy, completeness, or reliability of the information contained herein. You should conduct a careful, independent investigation of the property and verify all information. Any reliance on this information is solely at your own risk. CBRE and the CBRE logo are service marks of CBRE, Inc. All other marks displayed on this document are the property of their respective owners, and the use of such marks does not imply any affiliation with or endorsement of CBRE. Photos herein are the property of their respective owners. Use of these images without the express written consent of the owner is prohibited.