

Methodist Medical Plaza South

8820-8830 South Meridian Street, Indianapolis, IN 46217

For Lease



LOCATION DESCRIPTION

Located on the south side of Indianapolis, **MMP South** is a 2-story medical office building occupied by medical office users as well as an outpatient surgery center. The property features a soon to be renovated 1,675 SF spec suite available for lease, the perfect opportunity for a small private practitioner.

Ample parking, high visibility from SR 135, and a canopied entrance make this property one of the most accessible and visible office/surgery centers in the area.

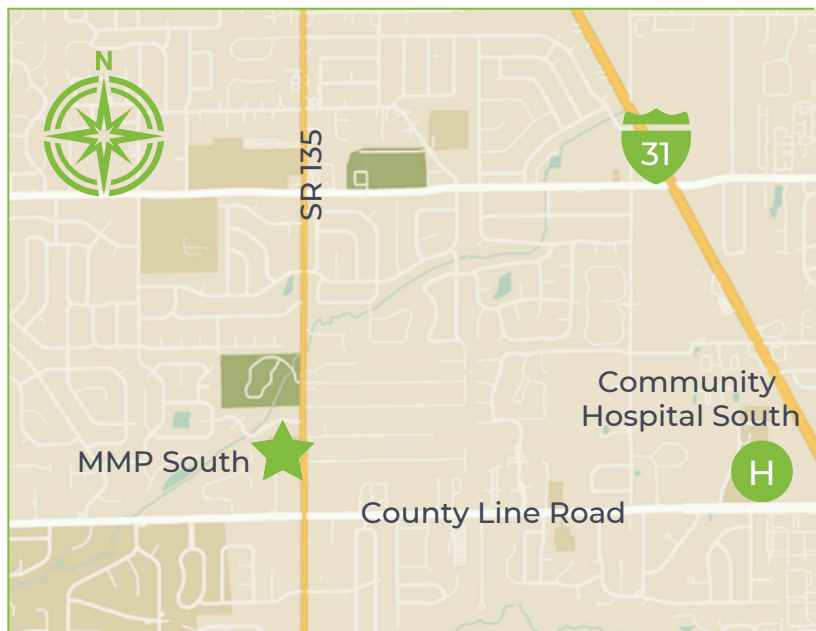

LEASING INFORMATION

Drew Deffner
Executive Vice President
Drew@alopg.com
C: 317.376.3897

Lora Moore
Executive Managing Director
Lora@alopg.com
C: 765.918.4999

ALO Property Group
9075 N Meridian St., Ste. 175
Indianapolis, IN 46260
O: 317.853.7500



Methodist Medical Plaza South

8820-8830 South Meridian Street, Indianapolis, IN 46217

For Lease

Central Business District

SR 135

30,000 VPD

MMP South

★ 8820 S Meridian St

★ 8830 S Meridian St

PROPERTY INFORMATION

- 71,739 SF Outpatient Surgery Center and Medical Office Building
- 1,675 SF Available for Lease - Suite 245
- On-site Lab, X-Ray, MRI and CT
- Minutes from Greenwood Park Mall, County Line Road and SR-37
- 120 Surface Parking Spaces

DEMOGRAPHIC DETAILS

- Within a five-mile radius, \$118,748,766 was spent on health care last year alone.
- The market boasts a growing population of 189,170 within a five-mile radius.
- Large employee base with 18.6% of workers in the health care and social assistance sector.

KEY TENANTS



Riley Children's Health
Indiana University Health



Indiana University Health



LEASING INFORMATION

Drew Deffner
Executive Vice President
Drew@alopg.com
C: 317.376.3897

Lora Moore
Executive Managing Director
Lora@alopg.com
C: 765.918.4999

ALO Property Group
9075 N Meridian St., Ste. 175
Indianapolis, IN 46260
O: 317.853.7500

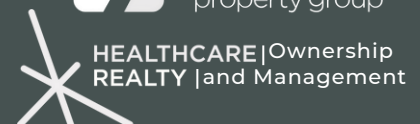

Methodist Medical Plaza South

8820-8830 S Meridian Street, Indianapolis, IN 46217

Floor Plan

SUITE 245 - 1,675 SF

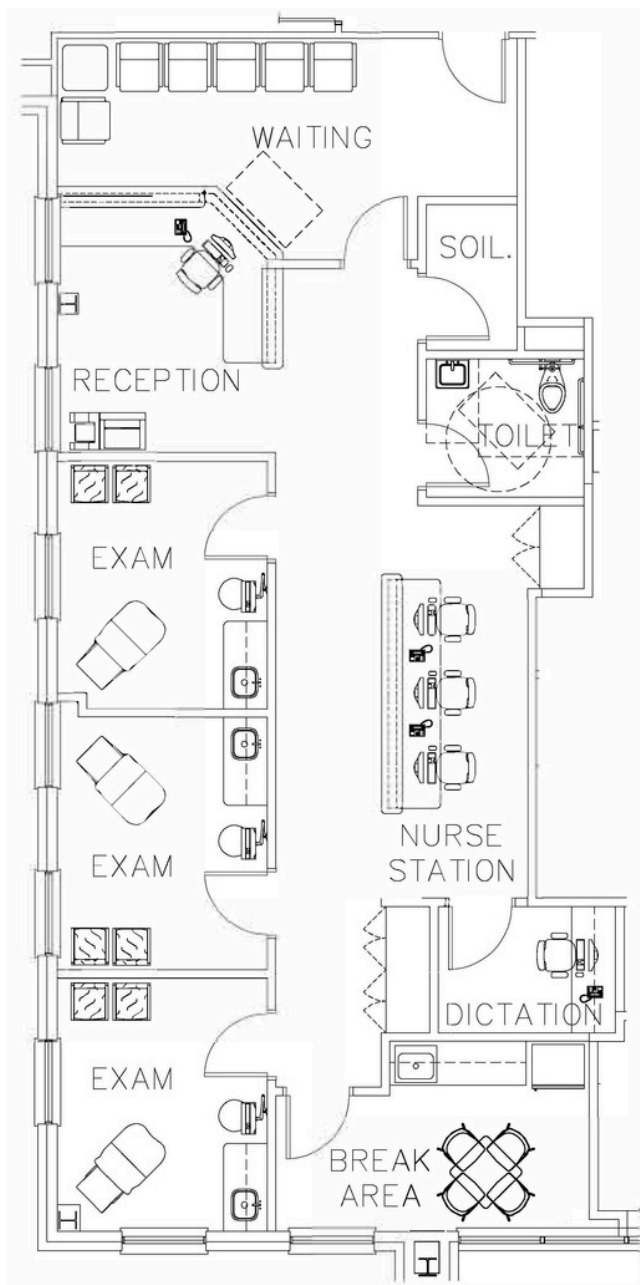

LEASING INFORMATION

Drew Deffner
Executive Vice President
Drew@alopg.com
C: 317.376.3897

Lora Moore
Executive Managing Director
Lora@alopg.com
C: 765.918.4999

ALO Property Group
9075 N Meridian St., Ste. 175
Indianapolis, IN 46260
O: 317.853.7500

