

“AS-BUILT”

RECORD DRAWINGS:
 THESE DRAWINGS ARE PREPARED IN ACCORDANCE WITH OUR CONSTRUCTION RECORDS AND/OR WITH OUR CONSTRUCTION RECORDS AND/OR THEY SHOW THE PROJECT “AS-BUILT” TO THE BEST OF OUR KNOWLEDGE BUT ARE NOT GUARANTEED TO BE SHOWN IN EXACT AND CORRECT DETAIL.
 NOTES:
 AS-BUILT INFORMATION DEPICTED IN BOLD LINES/LETTERS.

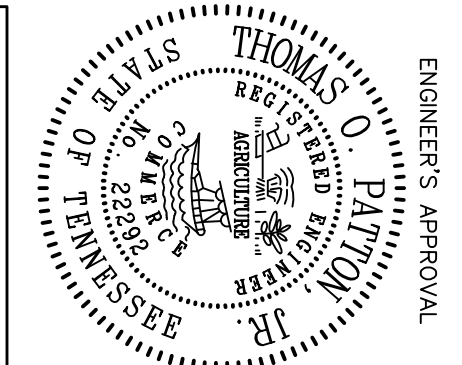
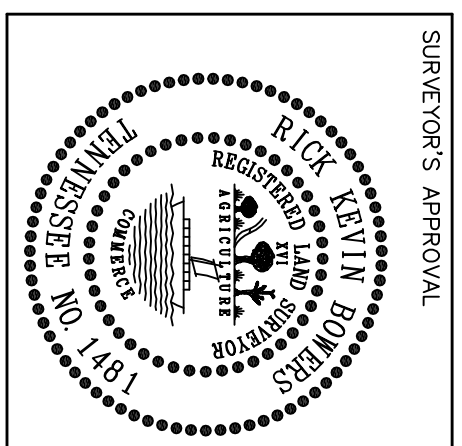
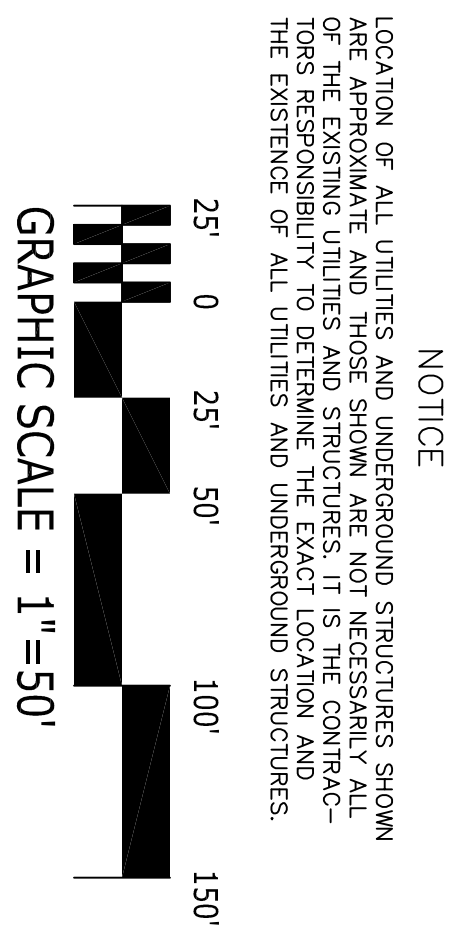

TH&P
 THOMAS W. HEMSELY & PARTNERS
 ARCHITECT
 3203 HANOVER ROAD
 JOHNSON CITY, TN 37604
 VOICE 423-952-2700
 FAX 423-952-2702
 email: twh@th&p.com

THOMAS W. HEMSELY & PARTNERS
 SOLUTIONS FOR THE FUTURE
 PLANNERS • ARCHITECTS
 ENGINEERS • SURVEYORS
 3203 HANOVER ROAD
 JOHNSON CITY, TENNESSEE 37604
 423-952-2700 • 423-952-2702
 FAX 423-952-2702
 http://www.th&p.com
 CAD FILE 022702.DWG
 CADD FILE 022702.DWG

CARDIOLOGY CONSULTANTS OF JOHNSON CITY, P.C.
 311 RINCEYTON ROAD
 JOHNSON CITY, TENNESSEE

CARDIOLOGY CONSULTANTS MEDICAL PARK
 STATE OF FRANKLIN ROAD
 AT MED TECH PARKWAY
 JOHNSON CITY, TENNESSEE

MARK	REVISION DESCRIPTION	DATE
1	CITY COMMENTS	6-14-06