

# 9616 MICRON AVENUE

MICRON CORPORATE CENTER  
SACRAMENTO, CA

**NEWMARK**

**JASON BRINITZER**

916-569-2341

[jason.brinitzer@nmrk.com](mailto:jason.brinitzer@nmrk.com)

CA RE License #02114854

Office Space

**AVAILABLE FOR LEASE**



## BUILDING FEATURES

- Immediate access to Highway 50 at Bradshaw
- Numerous eateries and amenities within walking distance
- Zoned BP (Business Professional Office which generally permits office and related uses such as banks, doctor's offices, general business and general uses)
- Ample parking at a ratio of 4/1,000 SF
- Highly visible from Micron Avenue and Highway 50
- Private, interior atriums

## AVAILABILITIES

Suite 600	±14,888 RSF
Suite 700	±3,884 RSF
Suite 825	±1,911 RSF
Suite 960	±2,143 RSF



9616 Micron Ave.

# FLOOR PLAN

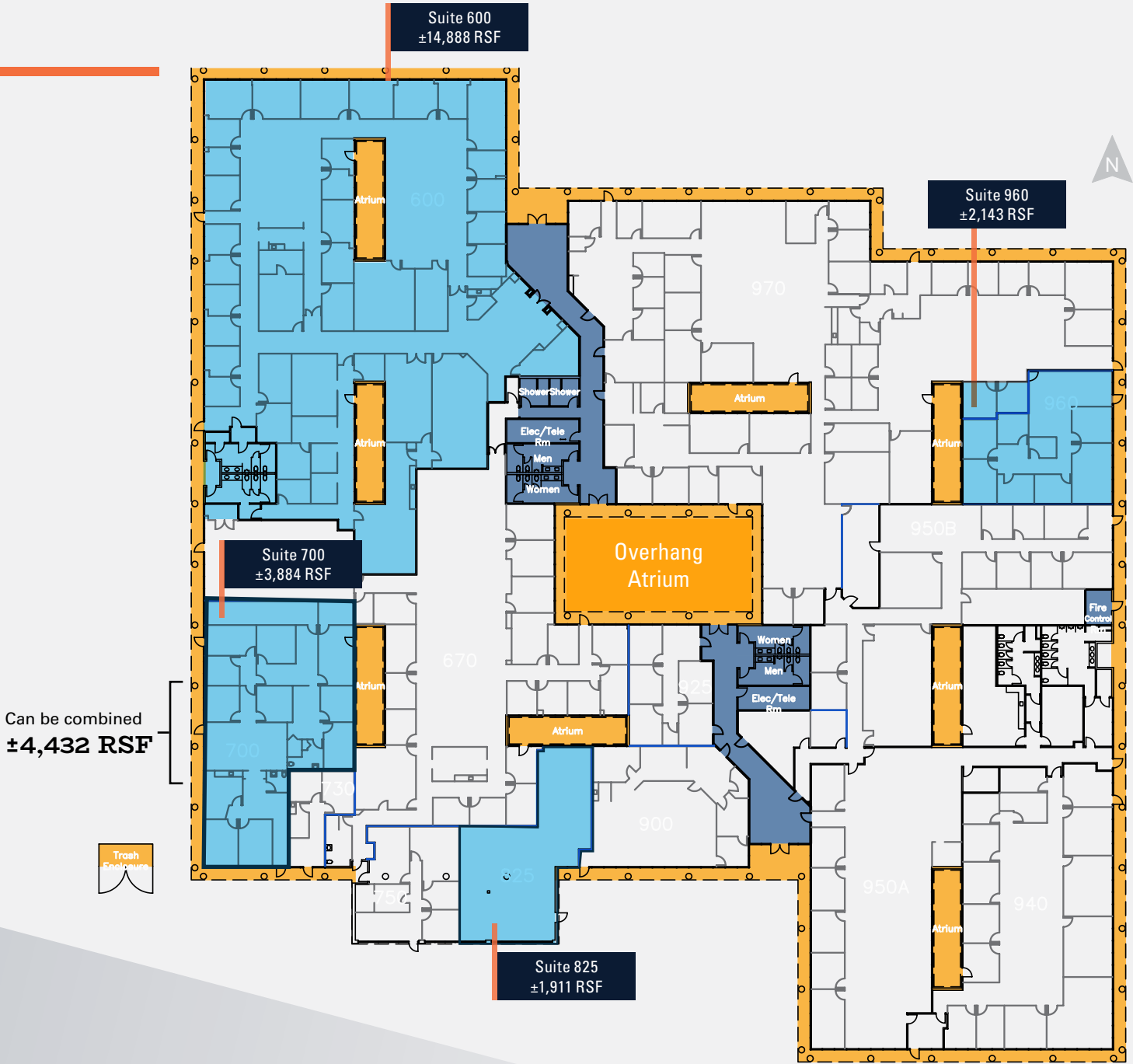



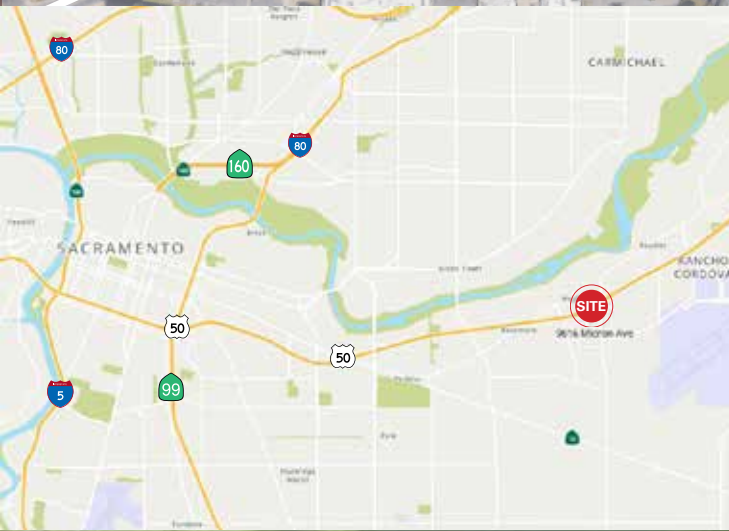
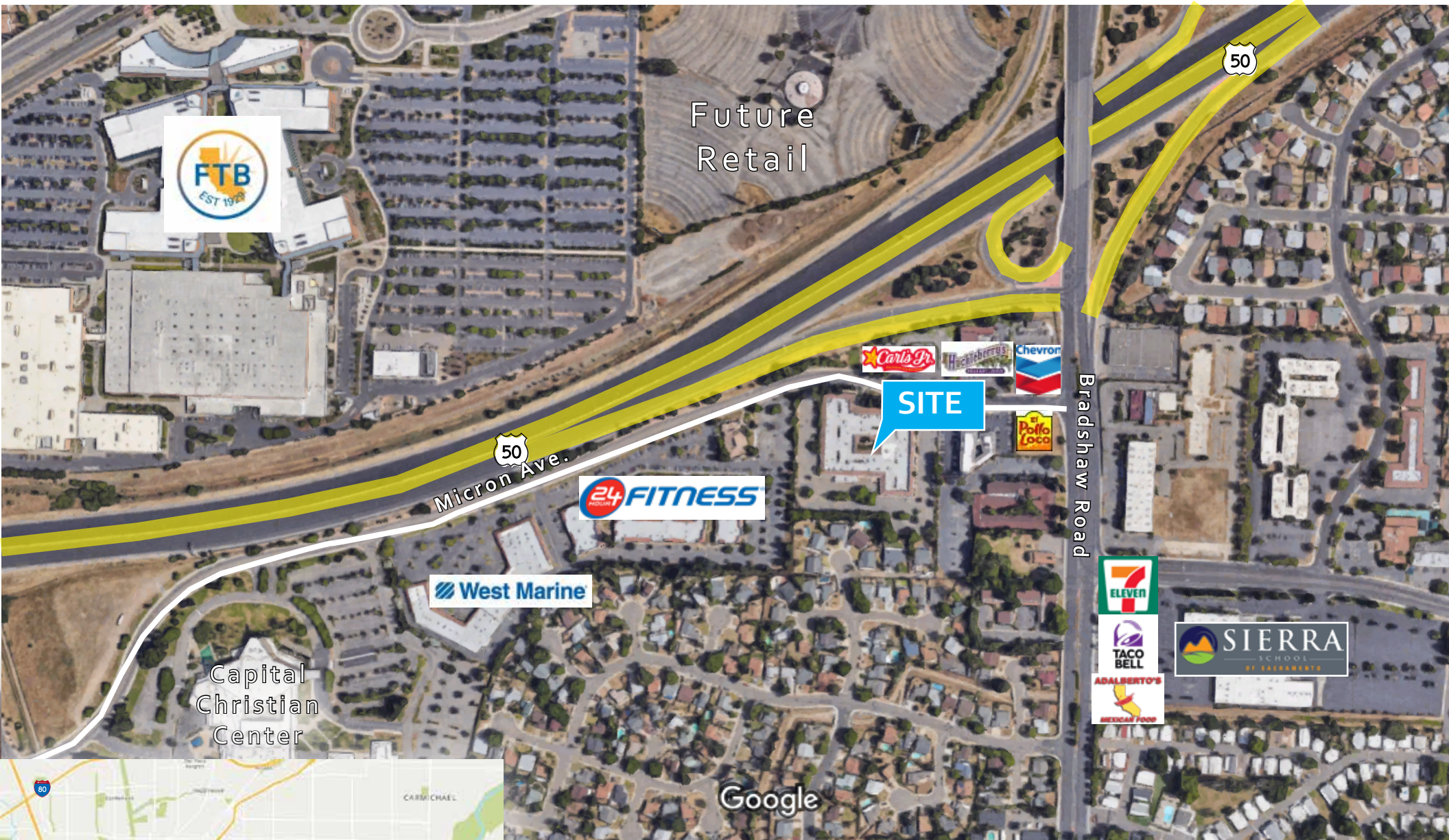







# 9616 MICRON AVENUE

MICRON CORPORATE CENTER  
SACRAMENTO, CA

**JASON BRINITZER**

916-569-2341

[jason.brinitzer@nmrk.com](mailto:jason.brinitzer@nmrk.com)

CA RE License #02114854

**NEWMARK**

The distributor of this communication is performing acts for which a real estate license is required. The information contained herein has been obtained from sources deemed reliable but has not been verified and no guarantee, warranty or representation, either express or implied, is made with respect to such information. Terms of sale or lease and availability are subject to change or withdrawal without notice. NMRK-NWMKTG 2024 • 19-0108 • 12/25