

PROPERTY DETAILS

Size: ±10,863 SF on ±19,907 SF Lot

Price: \$2,995,000 (\$275 / SF)

Zoning: LBIG

APN: 7432-022-020; 019; 027

- Fenced & Secured Yard
- Freestanding Industrial Building

- 12' - 14' Clear Height
- Heavy Power: 600 AMP, 277/480 V, 3 Phase
- 2 Oversized GL Doors (16' x 10')
- Approximately 21 Parking Spaces
- Minutes to 710 & 405 Freeways
- "Bonus" Overhang & Breezway not included in SF

LOCAL EXPERTISE. INTERNATIONAL REACH. WORLD CLASS.

Garrett Massaro, SIOR

Principal | Cal DRE# 01771471

P: +1(562) 354-2516

E: gmassaro@leelalb.com

Brandon Carrillo

Principal | Cal DRE# 01745362

P: +1(562) 354-2510

E: bcarrillo@leelalb.com

Max P. Eddy

Associate | Cal DRE# 02163858

P: +1(562) 354-2538

E: meddy@leelalb.com

Copyright © Lee & Associates. All rights reserved. No part of this work may be reproduced or distributed without written permission of the copyright owner. The information contained in this report was gathered by Lee & Associates from sources believed to be reliable. Lee & Associates, however, makes no representation concerning the accuracy or completeness of such information and expressly disclaims any responsibility for any inaccuracy contained herein.

FASHION AVE.

W. GAYLORD ST.

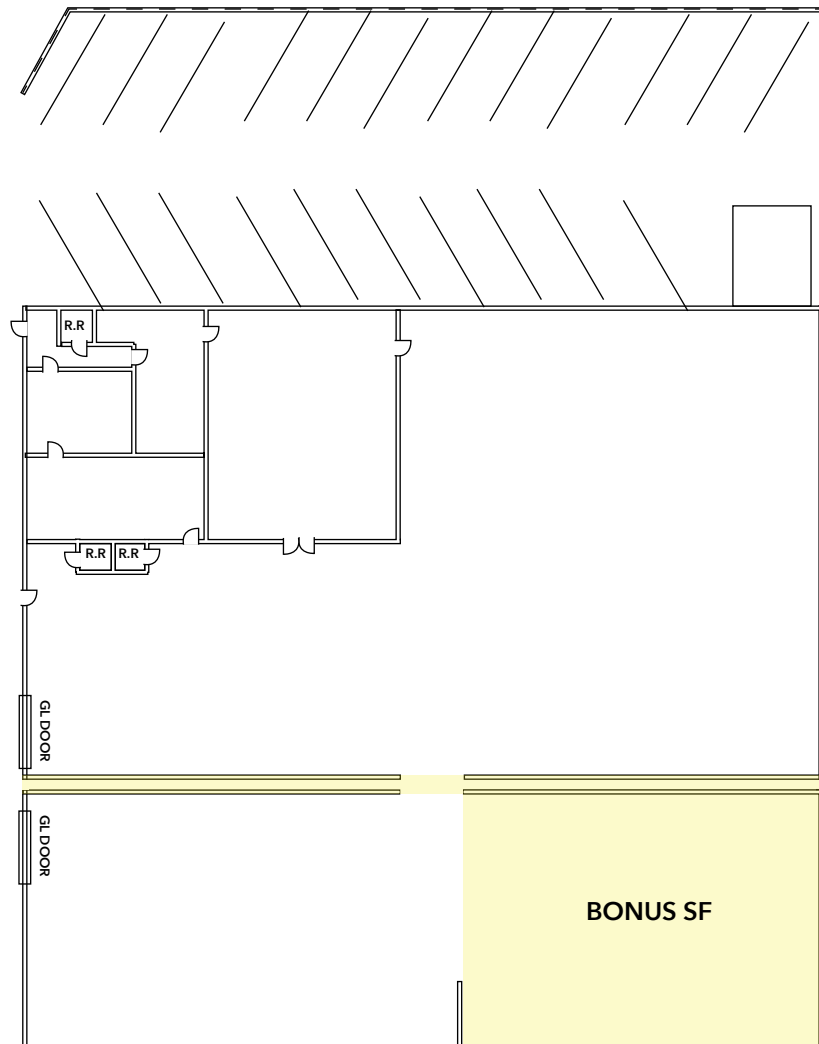

Approximate drawing, not to scale

LOCAL EXPERTISE. INTERNATIONAL REACH. WORLD CLASS.

Garrett Massaro, SIOR

Principal | Cal DRE# 01771471

P: +1(562) 354-2516

E: gmassaro@leelalb.com

Brandon Carrillo

Principal | Cal DRE# 01745362

P: +1(562) 354-2510

E: bcarrillo@leelalb.com

Max P. Eddy

Associate | Cal DRE# 02163858

P: +1(562) 354-2538

E: meddy@leelalb.com

Copyright © Lee & Associates. All rights reserved. No part of this work may be reproduced or distributed without written permission of the copyright owner. The information contained in this report was gathered by Lee & Associates from sources believed to be reliable. Lee & Associates, however, makes no representation concerning the accuracy or completeness of such information and expressly disclaims any responsibility for any inaccuracy contained herein.