

5995 KALAMAZOO AVE, SE  
KENTWOOD, MICHIGAN

RETAIL INVESTMENT FOR SALE  
17,787 Square Feet Available



**SIGNATURE ASSOCIATES**  
KNOW SIGNATURE | KNOW RESULTS

**NNN INVESTMENT**

**PRICE REDUCED**



## PROPERTY FEATURES

- 17,787 total building square feet
- Located on 2.17 acres
- 20' ceiling height
- Zoned C-2
- Sale Price: \$3,950,000 (\$222.07/sf)
- NOI (2024): \$249,307.50

**Comments:** Brand New Dollar Tree Triple Net lease tenant inside Former Rite Aid suite, situated on a hard, lighted corner intersection of 60th and Kalamazoo Avenue. Over 250' of frontage with ingress/egress on both 60th and Kalamazoo Avenue. Property is a half mile from M-6 interchange. Zoning is C-2 and allows for a variety of uses including, grocery, restaurant, liquor store, big box retailer, clothing and more!



For more information, please contact:

**JOE RIZQALLAH**  
(616) 822 6310  
jrizqallah@signatureassociates.com

**SIGNATURE ASSOCIATES**  
1188 East Paris Ave SE, Suite 220  
Grand Rapids, MI 49546  
www.signatureassociates.com

5995 Kalamazoo Ave., SE - Kentwood, Michigan  
Retail Investment for Sale

17,787  
Square Feet  
AVAILABLE

Site Plan

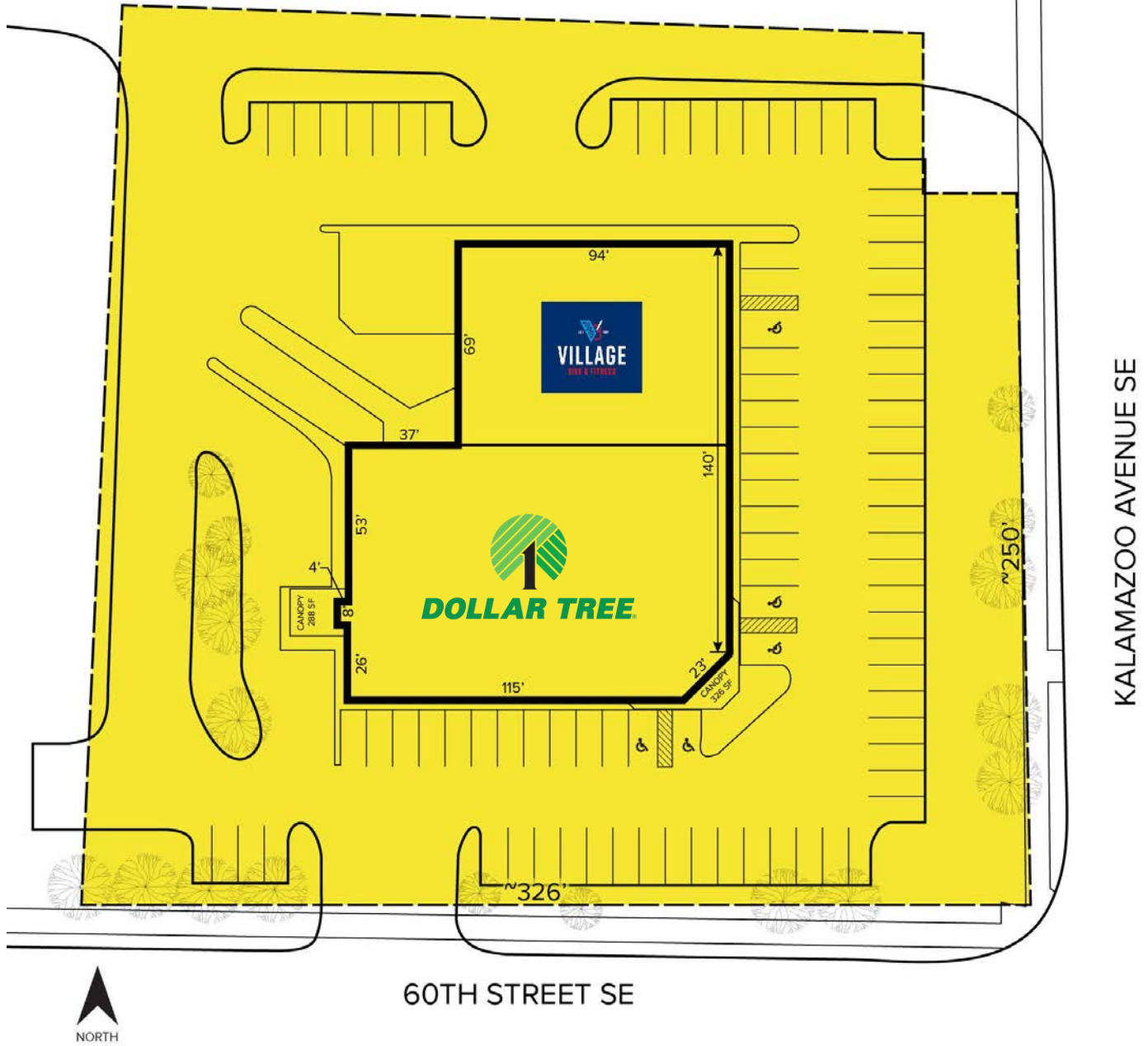

Rent Roll

TENANT	SQUARE FEET	LEASE TERM	RENT PER SQ. FT.	ANNUAL RENT
DOLLAR TREE	11,370	10 YEAR LEASE	\$14.75 NNN	\$167,707.50
VILLAGE BIKE SHOP	6,417	3 YEARS REMAIN*	\$12.72 NNN	\$81,600.00
			TOTAL:	\$249,307.50

\*Willing to sign a new 5-year lease with increased terms too for the right deal.

For more information, please contact:

**JOE RIZQALLAH**  
(616) 822 6310  
jrizqallah@signatureassociates.com

**SIGNATURE ASSOCIATES**  
1188 East Paris Ave SE, Suite 220  
Grand Rapids, MI 49546  
www.signatureassociates.com

# 5995 Kalamazoo Ave., SE - Kentwood, Michigan

## Retail Investment for Sale

17,787  
Square Feet  
AVAILABLE

### Additional Photos



For more information, please contact:

**JOE RIZQALLAH**  
(616) 822 6310  
jrizzqallah@signatureassociates.com

**SIGNATURE ASSOCIATES**  
1188 East Paris Ave SE, Suite 220  
Grand Rapids, MI 49546  
www.signatureassociates.com

# 5995 Kalamazoo Ave., SE - Kentwood, Michigan

## Retail Investment for Sale

17,787  
Square Feet  
AVAILABLE

### Aerial



DEMOGRAPHICS		
	POPULATION	MED. HH INCOME
1 MILE	12,493	\$71,771
3 MILE	83,183	\$73,437
5 MILE	152,822	\$72,811

TRAFFIC COUNTS (TWO-WAY)	
14,322	60 <sup>th</sup> St SE west of Kalamazoo Ave SE
24,424	Kalamazoo Ave SE north of 60 <sup>th</sup> St SE
12,983	60 <sup>th</sup> St SE east of Kalamazoo Ave SE
24,044	Kalamazoo Ave SE south of 60 <sup>th</sup> St SE

For more information, please contact:

**JOE RIZQALLAH**  
(616) 822 6310  
jrizqallah@signatureassociates.com

**SIGNATURE ASSOCIATES**  
1188 East Paris Ave SE, Suite 220  
Grand Rapids, MI 49546  
www.signatureassociates.com

# 5995 Kalamazoo Ave., SE - Kentwood, Michigan

## Retail Investment for Sale

17,787  
Square Feet  
AVAILABLE

### Nearby Retail



For more information, please contact:  
**JOE RIZQALLAH**  
(616) 822 6310  
jrizqallah@signatureassociates.com

**SIGNATURE ASSOCIATES**  
1188 East Paris Ave SE, Suite 220  
Grand Rapids, MI 49546  
www.signatureassociates.com

Information is subject to verification and no liability for errors or omissions is assumed. Price is subject to change and listing withdrawal.