

AVAILABLE FOR LEASE  
PROFESSIONAL OFFICE SPACE | 11,580± SF

# 5 RIVER PARK PLACE WEST

FRESNO, CA



**NEWMARK**  
PEARSON COMMERCIAL

**Phil Souza**  
Senior Vice President - Office Division  
t 559-447-6283  
psouza@pearsonrealty.com  
CA RE Lic. #00853867

**Nick Sorensen**  
Vice President - Office Division  
t 559-447-6240  
nsorensen@pearsonrealty.com  
CA RE Lic. #02081137

**Luke Tessman**  
Vice President - Office Division  
t 559-447-6243  
ltessman@pearsonrealty.com  
CA RE Lic. #02008140

*Independently Owned and Operated* | Corporate License #00020875 | [newmarkpearson.com](http://newmarkpearson.com)

The distributor of this communication is performing acts for which a real estate license is required. The information contained herein has been obtained from sources deemed reliable but has not been verified and no guarantee, warranty or representation, either express or implied, is made with respect to such information. Terms of sale or lease and availability are subject to change or withdrawal without notice.



# 5 RIVER PARK PLACE WEST

FRESNO, CA

## PROPERTY INFORMATION



<b>Availability:</b>	Suite 105   11,580± SF
<b>Lease Rate:</b>	\$2.20 PSF
<b>Lease Type:</b>	NNN
<b>Zoning:</b>	O ( <i>Office</i> )
<b>Tenant Improvements:</b>	Negotiable
<b>Load Factor:</b>	13.90%
<b>Building Class:</b>	A
<b>Number of Floors:</b>	3

### HIGHLIGHTS

- Class A Office Building
- Convenient Access to Freeway 41
- Great Freeway Visibility
- Near Woodward Park, the Valley's Largest Regional Park
- Close Proximity to Multiple Shopping Centers:
  - Park Crossing
  - River Park
  - The Villagio
  - Universal Park

**\$2.20** (PSF/Monthly)  
LEASE RATE

**NNN**  
LEASE TYPE



# 5 RIVER PARK PLACE WEST

FRESNO, CA

## PROPERTY DESCRIPTION

5 River Park Place West, is located just north of Friant Avenue between Freeway 41 and Fresno Street. The property is in close proximity to the Freeway 41 on and off-ramps, which allows convenient access to all areas of the city.

Containing three stories, the building offers views of the Sierra Nevadas as well as Woodward Park. All ancillary services including transportation, shopping, food-service, and banking are nearby with two major power centers, Park Crossing and River Park, in close proximity.



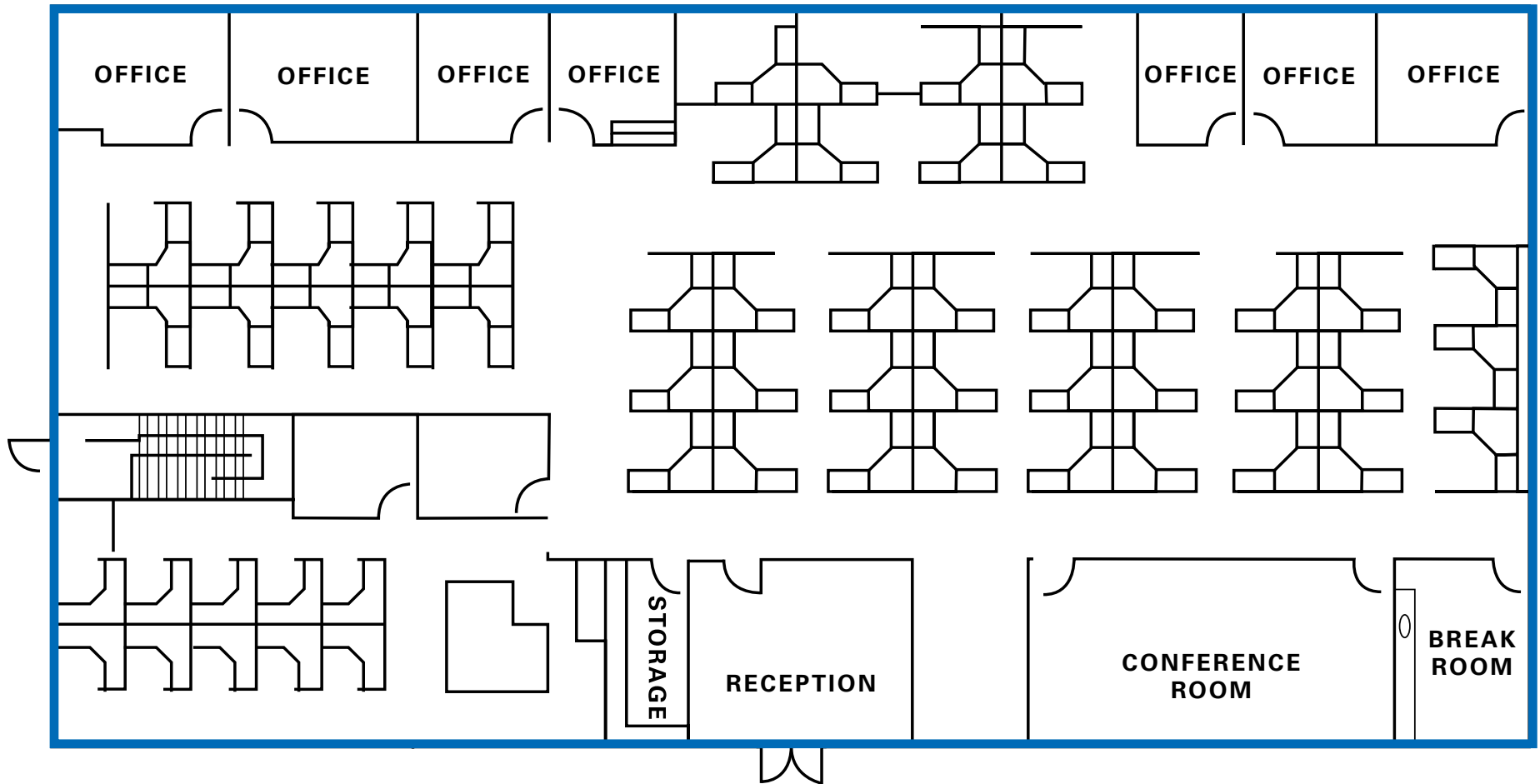



# 5 RIVER PARK PLACE WEST

FRESNO, CA





**AVAILABLE FOR LEASE**  
**PROFESSIONAL OFFICE SPACE | 11,580± SF**

# **5 RIVER PARK PLACE WEST**

**FRESNO, CA**

*For information, please contact:*

**Luke Tessman**

*Vice President - Office Division*

t 559-447-6243

ltessman@pearsonrealty.com

CA RE Lic. #02008140

**Nick Sorensen**

*Vice President - Office Division*

t 559-447-6240

nsorensen@pearsonrealty.com

CA RE Lic. #02081137

**Phil Souza**

*Senior Vice President - Office Division*

t 559-447-6283

psouza@pearsonrealty.com

CA RE Lic. #00853867

**NEWMARK**  
PEARSON COMMERCIAL

*Independently Owned and Operated*  
Corporate License #00020875  
[newmarkpearson.com](http://newmarkpearson.com)

**FRESNO OFFICE**  
7480 N. Palm Ave. #101  
Fresno, CA 93711  
t 559-432-6200

**VISALIA OFFICE**  
3447 S. Demaree St.  
Visalia, CA 93277  
t 559-732-7300

The distributor of this communication is performing acts for which a real estate license is required. The information contained herein has been obtained from sources deemed reliable but has not been verified and no guarantee, warranty or representation, either express or implied, is made with respect to such information. Terms of sale or lease and availability are subject to change or withdrawal without notice.