



345 & 353 SUTTER
SAN FRANCISCO | CA

**TWO GROUND FLOOR
RETAIL SPACES**



F E A T U R E S

345 Sutter Street offers two ground floor retail spaces consisting of +/- 1,321 and +/- 2,700 square feet with access to a full basement. Each space is highly visible by pedestrian and vehicle traffic, and features a wide storefront, vast windows, and 14' ceilings. The property has undergone a full renovation in recent years including a new elevator with basement access, upgraded electrical service, ADA improvements, and upgraded life safety systems. The retail spaces can be combined with the basement to provide an efficient 2-level space with rear delivery access from Campton Lane, all located in the core of the Union Square shopping district.

- +/- 1,321 SF & 2,700 SF Ground Floor Retail
- Located in the core of San Francisco's Union Square shopping district
- Fully renovated building including ADA, electrical, and life safety upgrades
- Vast display windows
- Wide storefront with excellent visibility
- Strong foot and vehicle traffic
- Elevator access to a full basement
- Rear delivery from Campton Place
- Excellent signage opportunity
- Close to public transportation and hourly/monthly parking



Floor Plans

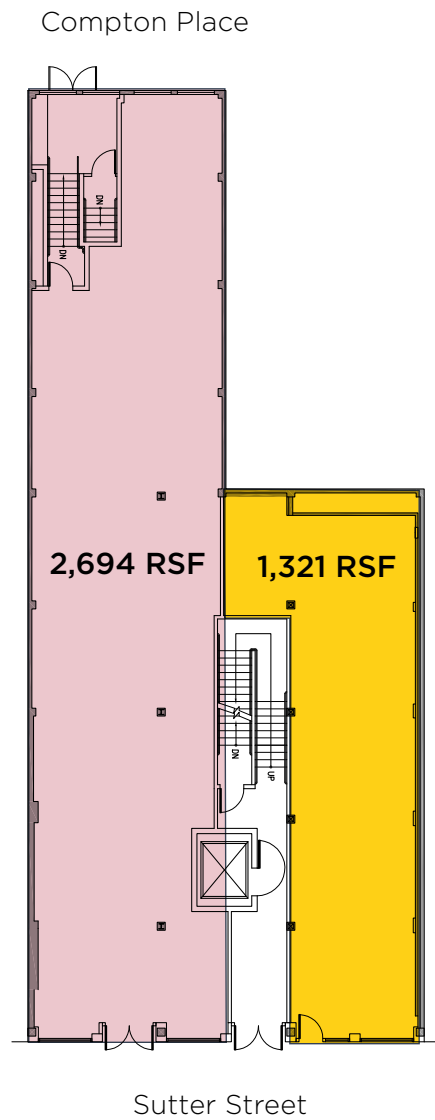

GROUND FLOOR RETAIL

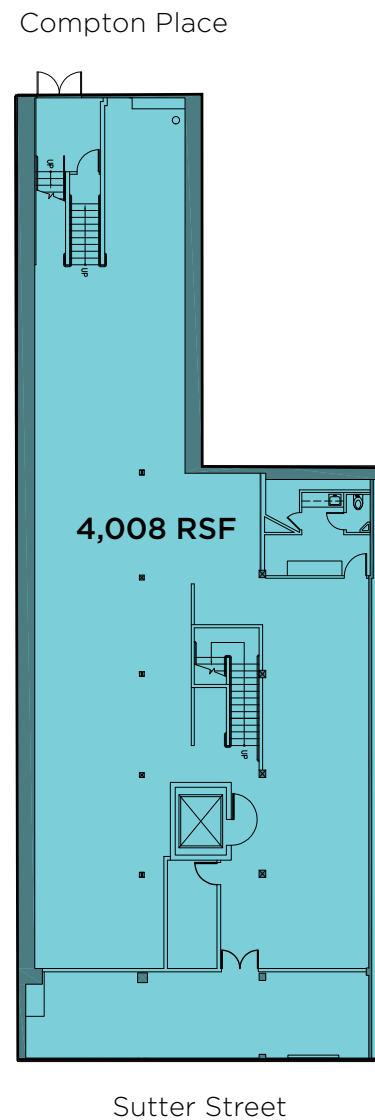

BASEMENT LEVEL



Union Square

345 & 353 Sutter is located on a bustling block in San Francisco's historic Union Square. The building is located on a street filled with trending shops and unique boutiques, many of them longtime destinations for Bay Area shoppers and tourists. This retail space also enjoys the proximity to major touristic landmarks such as the Powell St. Cable Car, Chinatown, and Union Square, as well as a multitude of nearby hotels and boarding accommodations. Several parking garages and public transportation are located nearby.



ST. FRANCIS



RIMOWA



COLE HAAN



ALLAN EDMONDS

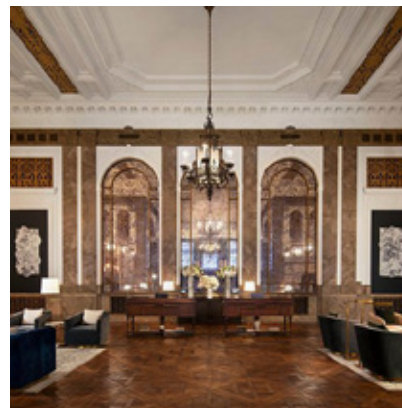

BEACON GRAND



DIOR



CHOTTO MATTE



APPLE



SHREVE & CO

MASON STREET

POWELL STREET

STOCKTON STREET

GRANT STREET

KEARNY STREET

BUSH STREET

Marriott   



SUTTER STREET

 TIFFANY & Co. WILLIAMS SONOMA 

     HARRY WINSTON

345 & 353 SUTTER

RIMOWA   SHREVE & Co.

POST STREET











Dior MaxMara GIORGIO ARMANI OLIVER PEOPLES 

GEARY STREET

O' FARRELL STREET

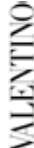



maven
RETAIL

PAMELA MENDELSON

office 415.404.6650
pam@mavenproperties.com
DRE #00953050

ALI MCEVOY

office 415.404.7343
ali@mavenproperties.com
DRE #01930635

HALEY KLEIN

office 415.404.7330
haley@mavenproperties.com
DRE #01907308

345 & 353 SUTTER — FOR LEASE

NOTICE: This information has been secured from sources we believe to be reliable but we make no representations, warranties, express or implied, as to the accuracy of the information. Listing broker has been given enough information to provide only a preliminary interest in the property. The materials are not to be considered fact. The information contained herein is not a substitute for thorough due diligence investigation. References to square footage, zoning, use, or age are approximate. Please contact the San Francisco Planning Department to verify zoning at (415) 558-6378, as neither broker or landlord represent that this space is suitable for your use. Tenant or Buyer must verify the information at their own expense and bears all the risk for any inaccuracies. By receiving these materials you are agreeing to the disclaimers set forth herein. DRE#01878802

466 Green Street Suite #203 | San Francisco, CA 94133 | 415-781-7700 | www.mavenproperties.com