



341-353 39TH STREET

FOR LEASE | RETAIL SPACE | SUNSET PARK, NY 11232

PROPERTY DESCRIPTION

Cross Streets: 3rd Avenue & 4th Avenue

Zoning: M1-2

Ground Floor: Space A: 10,244 SF 60' frontage (approx.) Space B: 5,392 SF 60' frontage (approx.)

Lower Level: 13,050 SF

RE Taxes: Pro Rata

Delivery: 3Q 2018



DEVELOPED BY



PROPERTY FEATURES

- Great exposure to vehicular traffic on Gowanus Expy.
One block away from Industry City
At the base of a 130,000 SF Class A office building
Lower level with plenty of natural light
Opportunity for signage with visibility from BQE

TRANSPORTATION

- Walking distance to the D, N, and R trains
Average of 141,821 vehicles daily along the Gowanus Expy.



ASKING PRICE: UPON REQUEST

For Further Information, Please Contact Exclusive Leasing Team:

Ryan Condren
718.687.4212
rcondren@cpeyre.com

George Danut
718.687.4220
gdanut@cpeyre.com

CPEX REAL ESTATE | 81 WILLOUGHBY STREET, 8TH FL | BROOKLYN, NY 11201 | TEL: (718) 935-1800 | FAX: (718) 935-1822 | WWW.CPEXRE.COM

All information contained herein was provided by or obtained from the owner of the property or from sources that we deem reliable. Though we have no reason to doubt the validity of the information, we do not warrant any information disclosed. IT IS STRONGLY URGED THAT THE PROSPECTIVE TENANT CAREFULLY VERIFY EACH ITEM OF SIZE, RE TAXES, PERMITTED LEGAL USE, AND ALL OTHER INFORMATION PRESENTED HEREIN.



REAL ESTATE

341-353

39TH STREET

FOR LEASE | RETAIL SPACE | SUNSET PARK, NY 11232

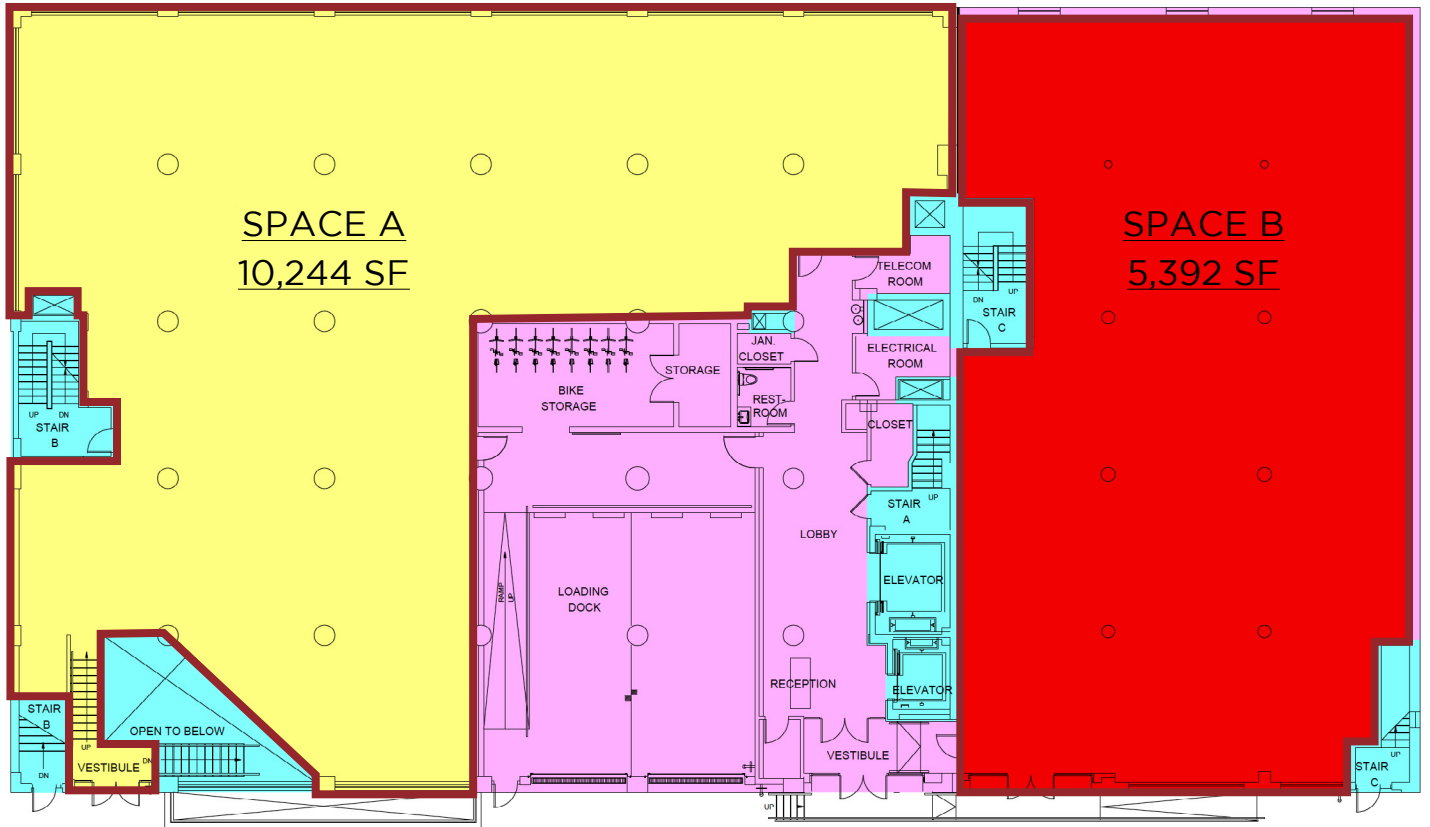

39TH ST

ASKING PRICE: UPON REQUEST

For Further Information, Please Contact Exclusive Leasing Team:

Ryan Condren

718.687.4212

rcondren@cpexre.com

George Danut

718.687.4220

gdanut@cpexre.com

CPEX REAL ESTATE | 81 WILLOUGHBY STREET, 8TH FL | BROOKLYN, NY 11201 | TEL: (718) 935-1800 | FAX: (718) 935-1822 | WWW.CPEXRE.COM

All information contained herein was provided by or obtained from the owner of the property or from sources that we deem reliable. Though we have no reason to doubt the validity of the information, we do not warrant any information disclosed.

IT IS STRONGLY URGED THAT THE PROSPECTIVE TENANT CAREFULLY VERIFY EACH ITEM OF SIZE, RE TAXES, PERMITTED LEGAL USE, AND ALL OTHER INFORMATION PRESENTED HEREIN.

