

## LOCATION

6620 Market St, Boardman, OH 44512

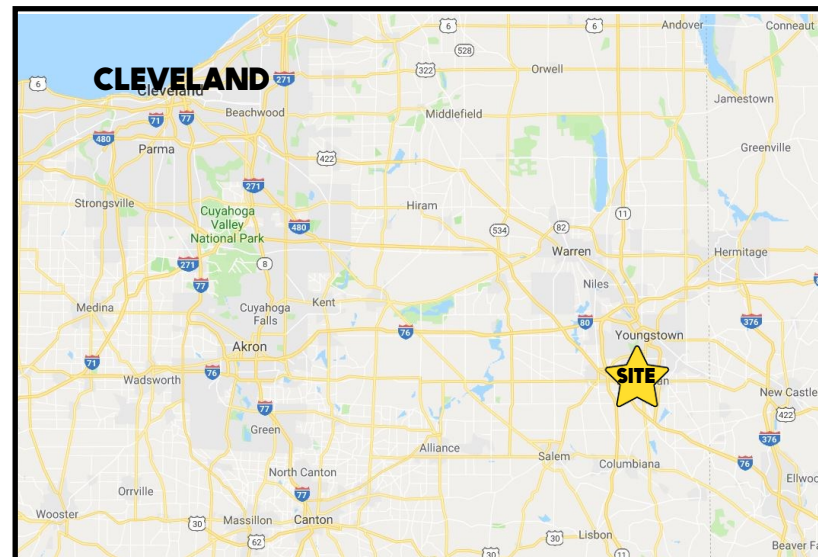

## TRAFFIC

Market St = 19,159 VPD

## HIGHLIGHTS

- Great location for retail owner / operator - Retail, Construction, Auto repair, etc.
- High Traffic area in the Center of Boardman Township
- Recently remodeled interior + 2 New Exterior Roll Up Doors
- Large Market Street Signage + Building Signage available

## CONTACT

**DON THOMAS**

501.269.3827

dthomas@platzrealtygroup.com

Office: 330.757.4889 | Fax: 330.294.5622 | 3830 Starr Centre Dr, Suite 2, Canfield, OH 44406

**www.PLATZREALTYGROUP.com**





Office: 330.757.4889 | Fax: 330.294.5622 | 3830 Starr Centre Dr, Suite 2, Canfield, OH 44406

**[www.PLATZREALTYGROUP.com](http://www.PLATZREALTYGROUP.com)**

The information presented was obtained from sources believed to be true and reliable. The Platz Realty Group makes no warranties or guarantees to the accuracy of the information.



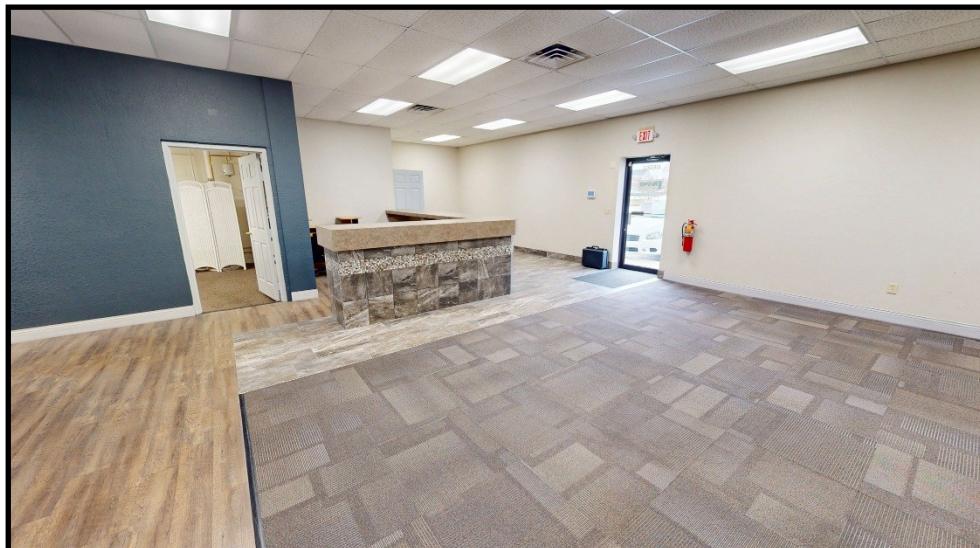

Office: 330.757.4889 | Fax: 330.294.5622 | 3830 Starr Centre Dr, Suite 2, Canfield, OH 44406

**[www.PLATZREALTYGROUP.com](http://www.PLATZREALTYGROUP.com)**

The information presented was obtained from sources believed to be true and reliable. The Platz Realty Group makes no warranties or guarantees to the accuracy of the information.

[3D Tour](#)

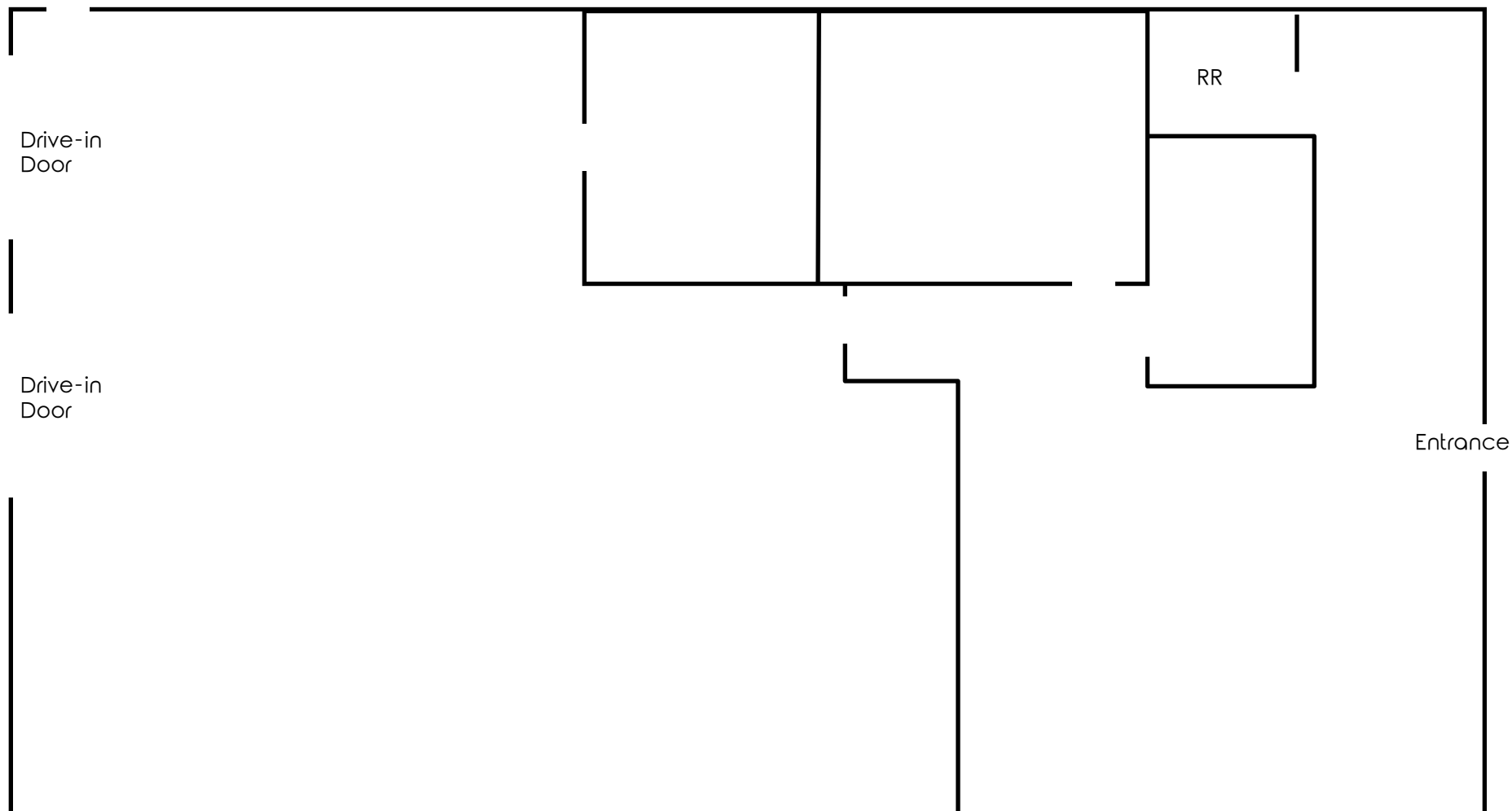

Office: 330.757.4889 | Fax: 330.294.5622 | 3830 Starr Centre Dr, Suite 2, Canfield, OH 44406

**[www.PLATZREALTYGROUP.com](http://www.PLATZREALTYGROUP.com)**



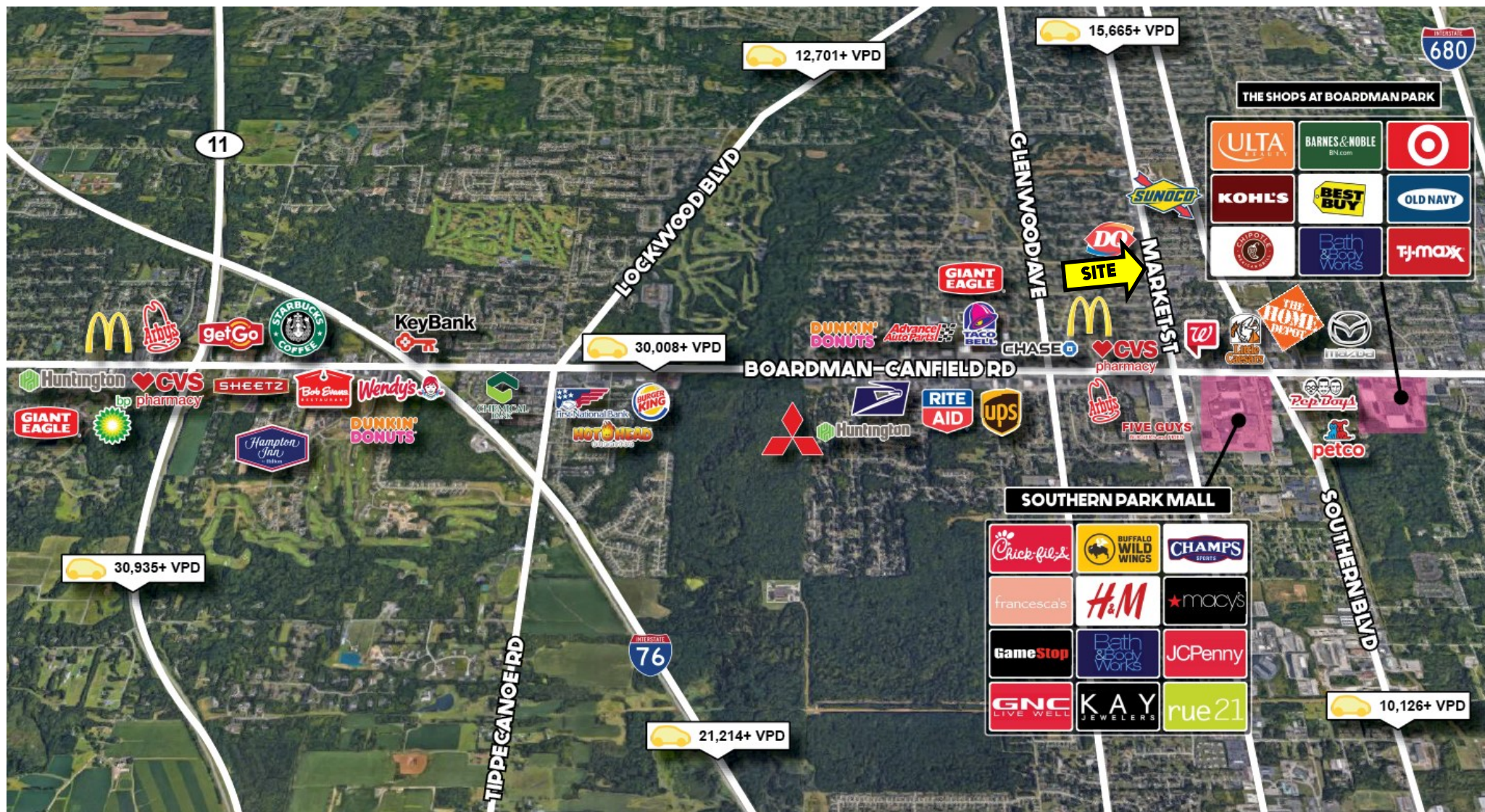

Office: 330.757.4889 | Fax: 330.294.5622 | 3830 Starr Centre Dr, Suite 2, Canfield, OH 44406

**www.PLATZREALTYGROUP.com**

The information presented was obtained from sources believed to be true and reliable. The Platz Realty Group makes no warranties or guarantees to the accuracy of the information.



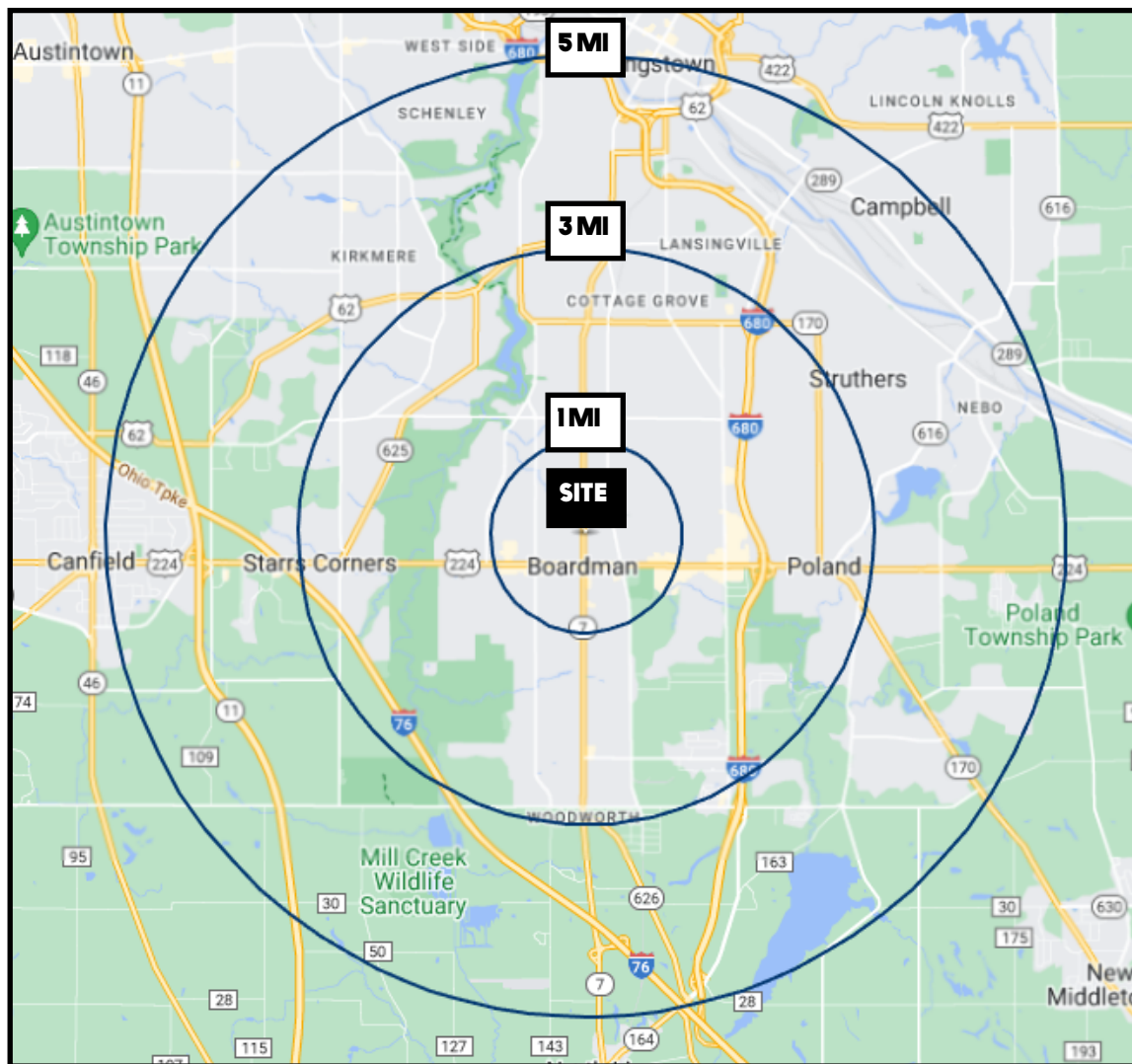

DEMOGRAPHICS	1 MI	3 MI	5 MI
<b>POPULATION</b>	8,390	56,819	117,842
<b>HOUSEHOLDS</b>	3,659	24,563	49,755
<b>MEDIAN AGE</b>	43	44	44
<b>AVERAGE HH INCOME</b>	\$69,198	\$69,283	\$67,241

SITE INFORMATION	
<b>LOCATION</b>	Boardman Township Mahoning County
<b>PROPERTY TYPE</b>	Retail / Flex / Showroom
<b>YEAR BUILT</b>	1962, Remodeled 2025
<b>SIZE</b>	3,520 SF
<b>ACREAGE</b>	.291 acres
<b>REAL ESTATE TAXES</b>	\$4,097/year
<b>PRICE</b>	\$375,000

Office: 330.757.4889 | Fax: 330.294.5622 | 3830 Starr Centre Dr, Suite 2, Canfield, OH 44406

**www.PLATZREALTYGROUP.com**