

# 3144-3146 DIABLO AVE HAYWARD, CA

*±7,888 SF Flex Warehouse for Sale  
on ±24,468 SF Parcel  
in Hayward, CA*





**CITYLIGHTS**<sup>™</sup>  
PROPERTY GROUP, INC.  
Real Estate • Management • Investments



**TURTON**  
COMMERCIAL REAL ESTATE

2131 CAPITOL AVE, STE 100  
SACRAMENTO, CA 95816  
916.573.3300 | [TURTONCRE.COM](http://TURTONCRE.COM)

**JUAN REYES**  
BROKER - LIC. 02044463  
408.218.1606  
[JREYESCITYLIGHTS@GMAIL.COM](mailto:JREYESCITYLIGHTS@GMAIL.COM)

**IAN FORNER**  
DIRECTOR - LIC. 01967116  
916.573.3314  
[IANFORNER@TURTONCRE.COM](mailto:IANFORNER@TURTONCRE.COM)

©2025 The information contained in the Offering memorandum is confidential and is not to be used for any other purpose or made available to other persons without the express written consent of Turton Commercial Real Estate ("TCRE"), Ken Turton or the owner. The material contained herein is based upon information supplied by owner in coordination with information provided by TCRE from sources it deems reasonably reliable. Summaries of documents are not intended to be comprehensive or all-inclusive but rather a general outline of the provisions contained herein and subject to more diligent investigation on the part of the prospective purchaser. No warranty, expressed or implied, is made by owner, TCRE or any other respective affiliates, as to the accuracy or completeness of the information contained herein or any other written or oral communication provided to a prospective purchaser in the course of its evaluation of the Property. No legal liability is assumed or to be applied in connection with the information or such other communication. Without limiting the general nature of the foregoing, the information shall not be deemed a representation of the state of affairs of the Property or constitute an indication that there has been no change in the business affairs, specific finances or specific condition of the Property since the date of preparation of the information. Prospective purchaser shall make their own projections and conclusions without reliance upon the materials contained herein and conduct their own independent due diligence, inspection and review of the Property, including but not limited to engineering and environmental inspections, to determine the condition of the Property and the existence of any potential hazardous material located at the site.



# THE OPPORTUNITY

**±7,888**

SF FLEX BUILDING

**±24,468**

SF PARCEL

**ZONING**

GENERAL INDUSTRIAL IG

**\$3,550,000**

PURCHASE PRICE

**600 AMP**

3 PHASE POWER

Turton Commercial Real Estate is pleased to offer for sale, 3144-3146 Diablo Avenue (the "Property"), an approximately ± 7,888 SF flex building in Hayward's Industrial Technology and Innovation Corridor.

The Property features a combination of a ± 7,400 SF warehouse with a small private office, two restrooms, yard space, and 600 amps on 3-phase power, all on

an approximately ± 24,468 SF parcel. The property offers immediate access to Highway 92, the San Mateo Bridge, and I-880, providing fast connectivity to the East Bay, Peninsula, and major Bay Area submarkets. A building of this size, location, and, ease of access is rare this close to Downtown Hayward. The Property offers the opportunity for a tenant to conduct their administration,

production and distribution all from one location, with nearby access to multiple major freeways, and less than 5 miles from Downtown Hayward. Take advantage of this opportunity to own a great building in the heart of Hayward's growing Industrial Technology and Innovation Corridor!

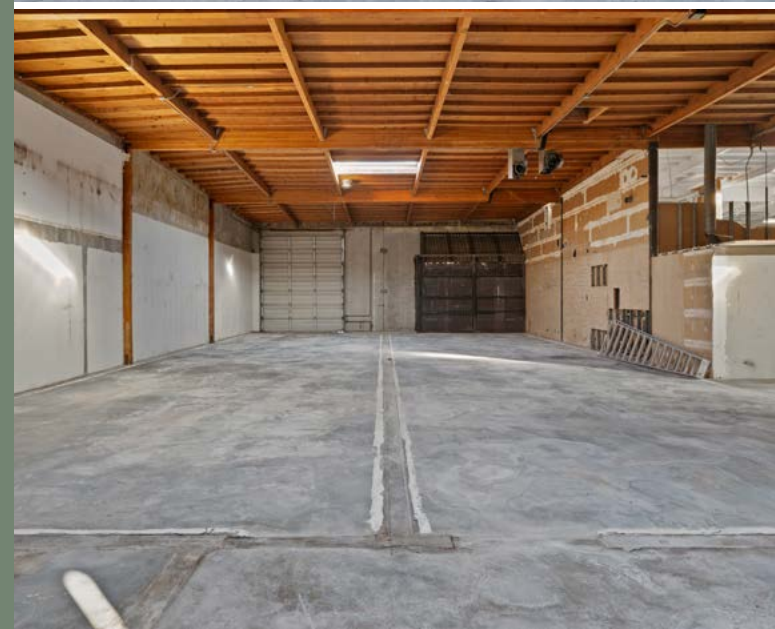





**1 THE OPPORTUNITY**  
3144-3146 DIABLO AVE

## PROPERTY INFO

Address:	3144-3146 Diablo Avenue, Hayward, CA 94545
Price:	\$3,550,000 (\$450/SF)
Total Size:	± 7,888 SF Concrete Tilt Up
Warehouse:	± 7,400 SF
Office:	± 388 SF (Not including Mezzanine)
Parcel Size:	± 24,468 SF
Zoning:	General Industrial IG
Clear Height:	± 18'
Yard Area:	± 7,500 SF Fenced, Paved and Secured
Doors:	1 - Dock High Door 3 - Drive-in Loading Doors
Power:	3 Phase, 600 Amp, 120/208 Volt



# THE FLOOR PLANS

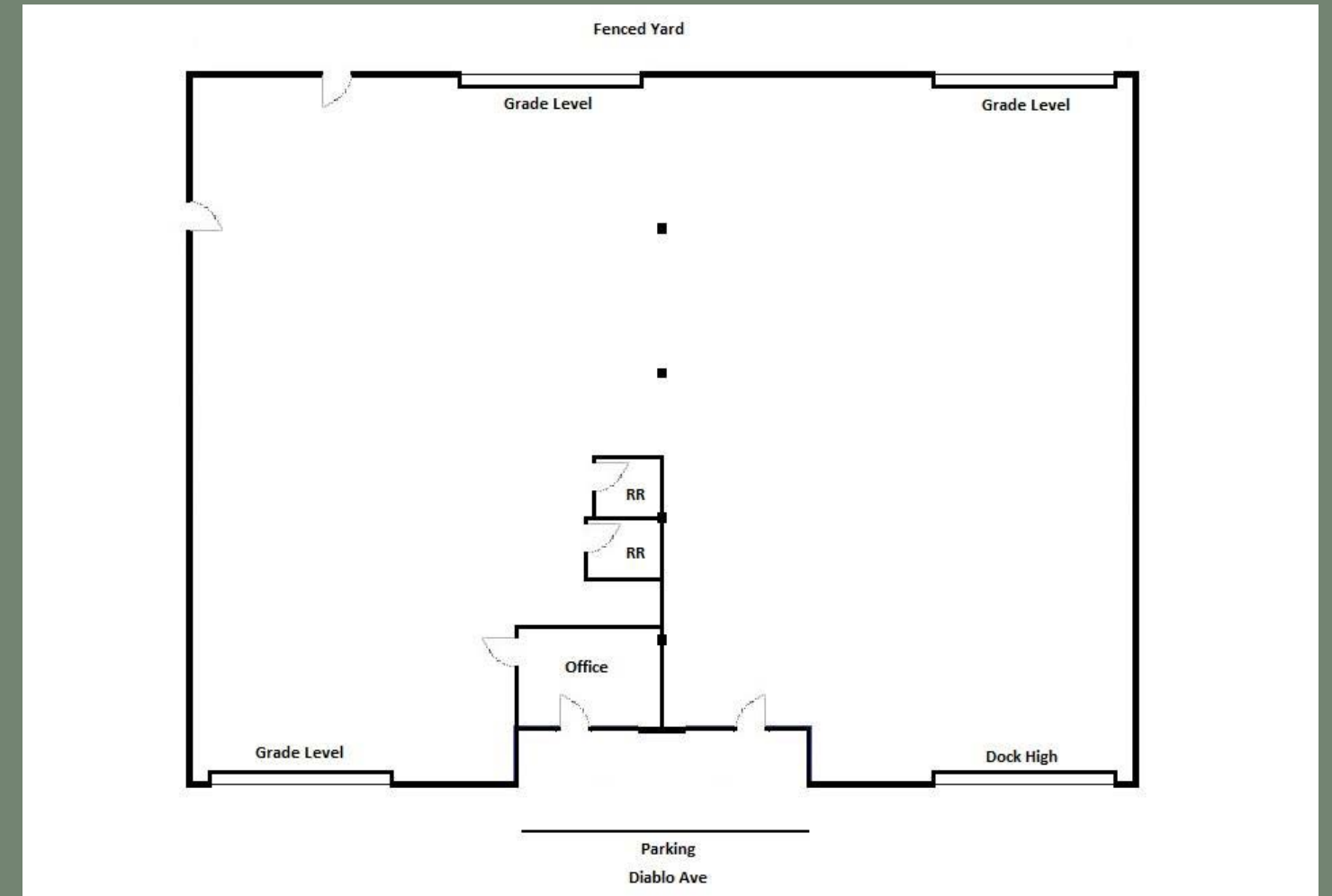
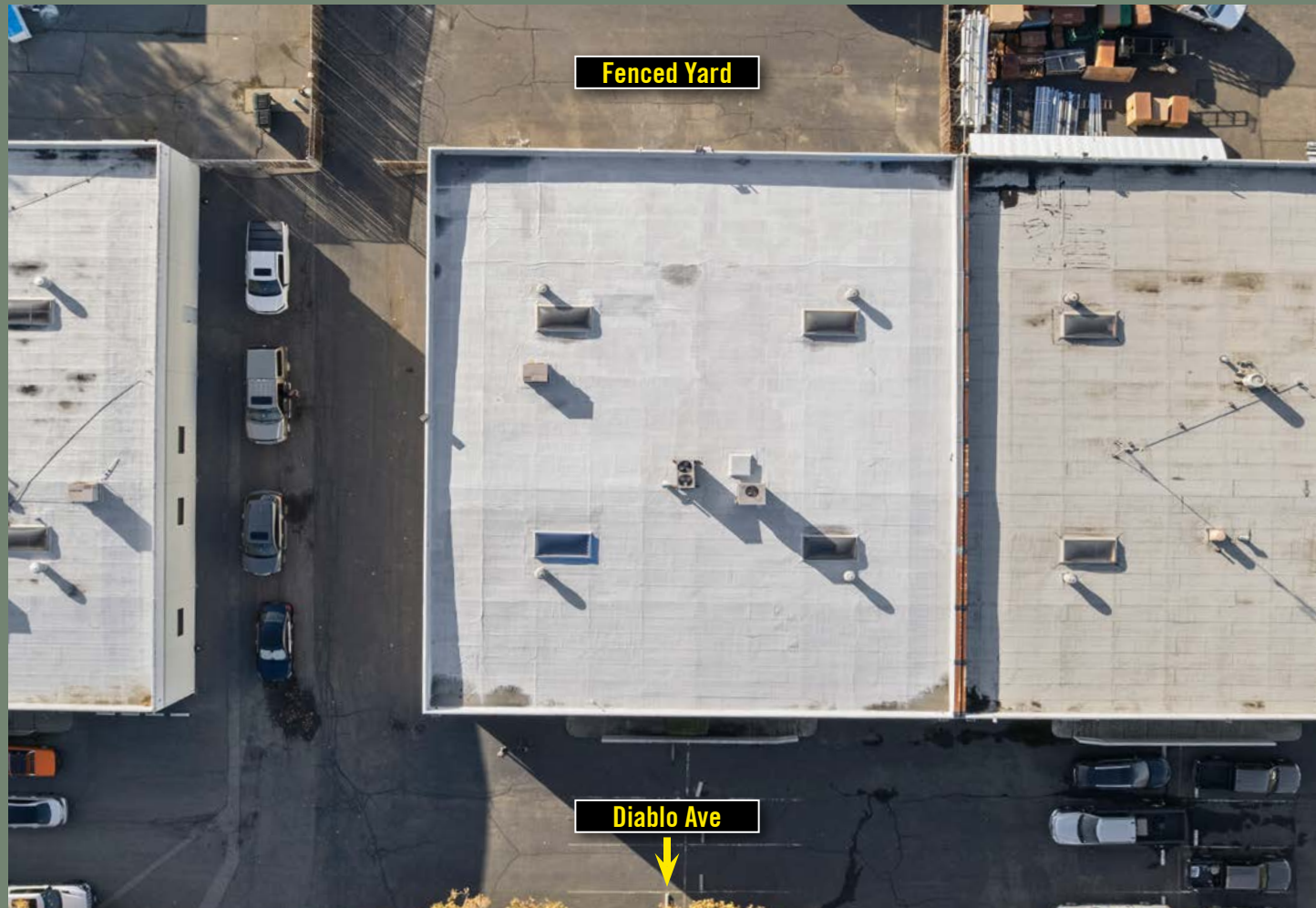



# THE LOCATION



## DOWNTOWN HAYWARD: FROM INDUSTRIAL ROOTS TO A VIBRANT MIXED-USE CENTER

The property sits just twelve minutes from the heart of Downtown Hayward, placing you within a dynamic and evolving East Bay hub that blends industrial heritage with community-oriented commerce, culture, and connectivity. Historically, Hayward served as a transit and trade crossroads, with ranchland giving way to commercial corridors and industrial activity over time. Today, Downtown Hayward is a lively central district that combines business, residential, retail, and cultural amenities in a walkable, accessible layout.

The area is anchored by the Hayward BART Station, convenient for commuting across the Bay Area, and enhancing access to labor, clients, and partners. Within walking distance in the Downtown area, you'll find a rich mix of shops, boutiques, vintage stores, and retail services that support both everyday needs and business convenience. Downtown's dining scene includes long-standing favorites like Casper's Hot Dogs (retro-style hot dog staple) and more eclectic offerings in local restaurants and cafés. Just four blocks away from Down-

town lies Heritage Plaza. The plaza is a large public park with mature trees, art pieces, and a children's garden, serving as community gathering spot and ideal for employee breaks.

Hayward reflects a blend of industrial, commercial, and residential uses, making the location adaptable to companies needing space, worker access, and amenities — whether for warehousing, light manufacturing, distribution, or office-industrial hybrid uses.

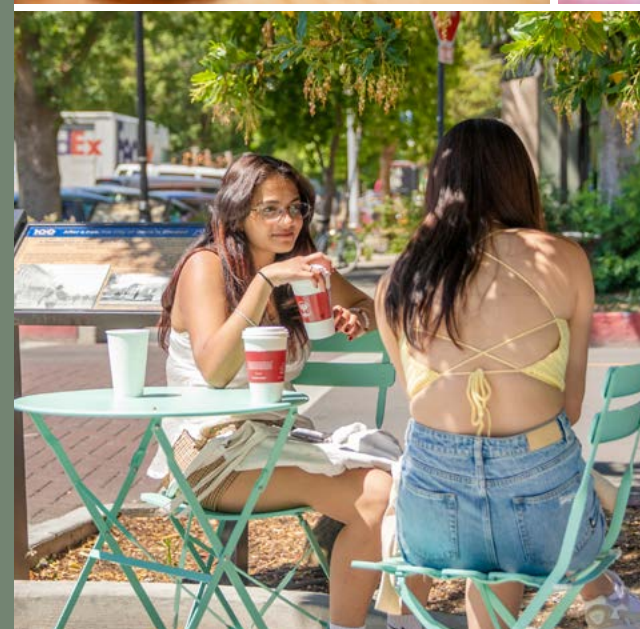
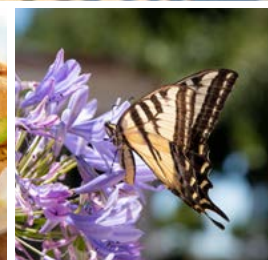
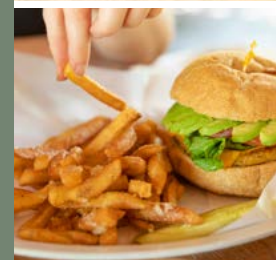





THE PROPERTY IS 40 MIN FROM SF

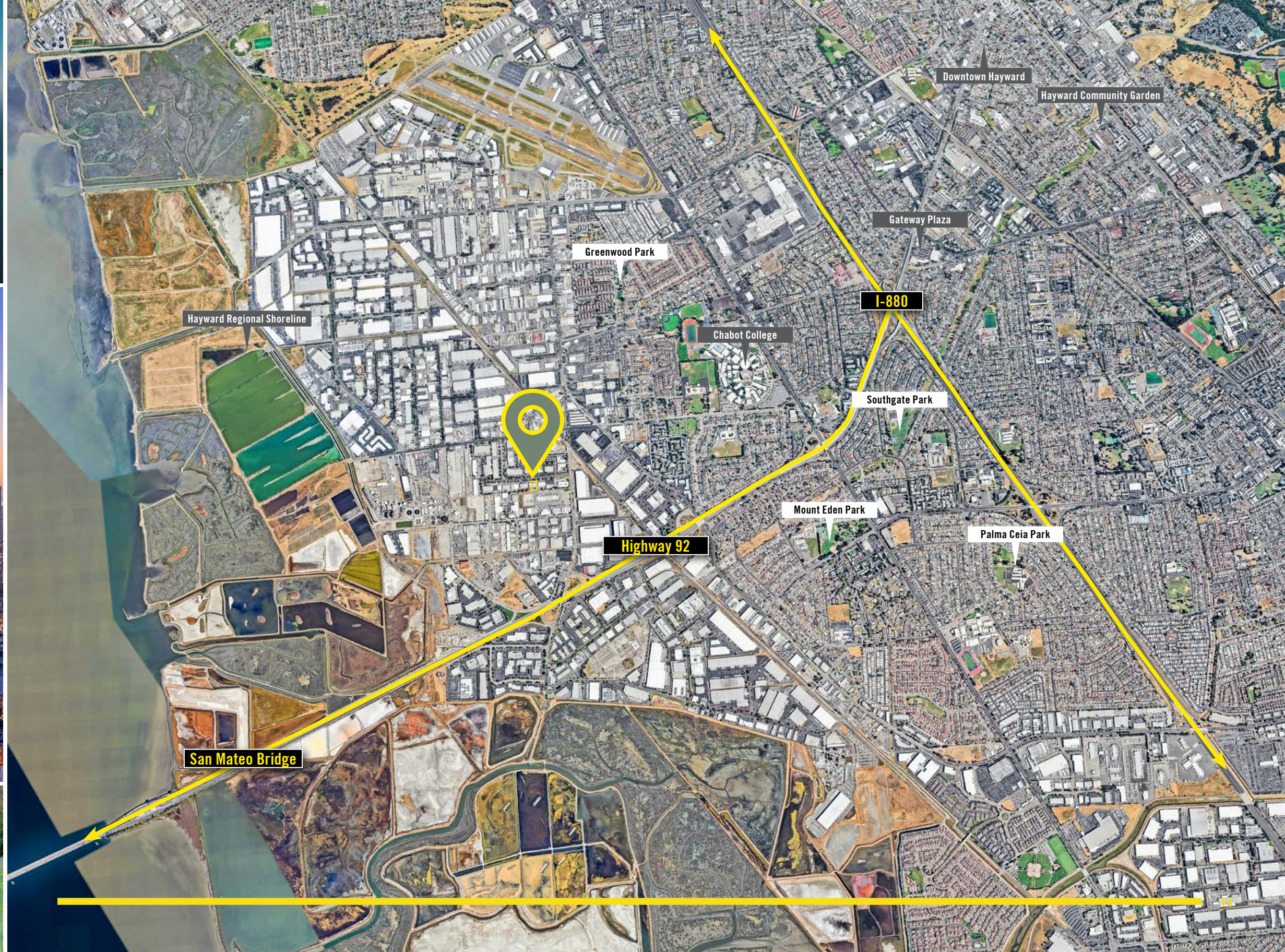





**CITYLIGHTS™**  
PROPERTY GROUP, INC.  
Real Estate • Management • Investments



**TURTON**  
COMMERCIAL REAL ESTATE

2131 CAPITOL AVE, STE 100  
SACRAMENTO, CA 95816  
916.573.3300 | [TURTONCRE.COM](http://TURTONCRE.COM)

**JUAN REYES**  
BROKER - LIC. 02044463  
408.218.1606  
[JREYESCITYLIGHTS@GMAIL.COM](mailto:JREYESCITYLIGHTS@GMAIL.COM)

**IAN FORNER**  
DIRECTOR - LIC. 01967116  
916.573.3314  
[IANFORNER@TURTONCRE.COM](mailto:IANFORNER@TURTONCRE.COM)

©2025 The information contained in the Offering memorandum is confidential and is not to be used for any other purpose or made available to other persons without the express written consent of Turton Commercial Real Estate ("TCRE"), Ken Turton or the owner. The material contained herein is based upon information supplied by owner in coordination with information provided by TCRE from sources it deems reasonably reliable. Summaries of documents are not intended to be comprehensive or all-inclusive but rather a general outline of the provisions contained herein and subject to more diligent investigation on the part of the prospective purchaser. No warranty, expressed or implied, is made by owner, TCRE or any other respective affiliates, as to the accuracy or completeness of the information contained herein or any other written or oral communication provided to a prospective purchaser in the course of its evaluation of the Property. No legal liability is assumed or to be applied in connection with the information or such other communication. Without limiting the general nature of the foregoing, the information shall not be deemed a representation of the state of affairs of the Property or constitute an indication that there has been no change in the business affairs, specific finances or specific condition of the Property since the date of preparation of the information. Prospective purchaser shall make their own projections and conclusions without reliance upon the materials contained herein and conduct their own independent due diligence, inspection and review of the Property, including but not limited to engineering and environmental inspections, to determine the condition of the Property and the existence of any potential hazardous material located at the site.



