

LEASE

OFFICE



200 DIVISION AVE. S



200 DIVISION AVE. S, GRAND RAPIDS, MI 49503

### PROPERTY OVERVIEW

Boasting huge store front windows and a brown brick façade, this space lends itself to a variety of different uses ranging from retail, office and warehouse. This building is located on the corner of Cherry St. and Division Ave. and is the perfect budget friendly building to call home! The space is currently in raw condition with a wide open floor plan and 12'ceilings, making it ideal for a variety of uses.

### PROPERTY HIGHLIGHTS

- 1/4 mile from US-131
- Walkable to multiple restaurants, retail, and Van Andel Arena
- Flex space allowing for multiple types of businesses

**LEASE RATE** **\$8.00 - 9.00 SF/YR (NNN)**

Available SF:	15,637 - 22,695 SF
Building Size:	22,695 SF



**BRADLEY COMPANY** **CHIP BOWLING**  
 220 Lyon St. NW, Suite 400 Senior Vice President  
 Grand Rapids, MI 49503 616.915.9080  
 616.254.0005 cbowling@bradleyco.com



BRADLEYCO.COM



200 DIVISION AVE. S, GRAND RAPIDS, MI 49503

LEASE

OFFICE

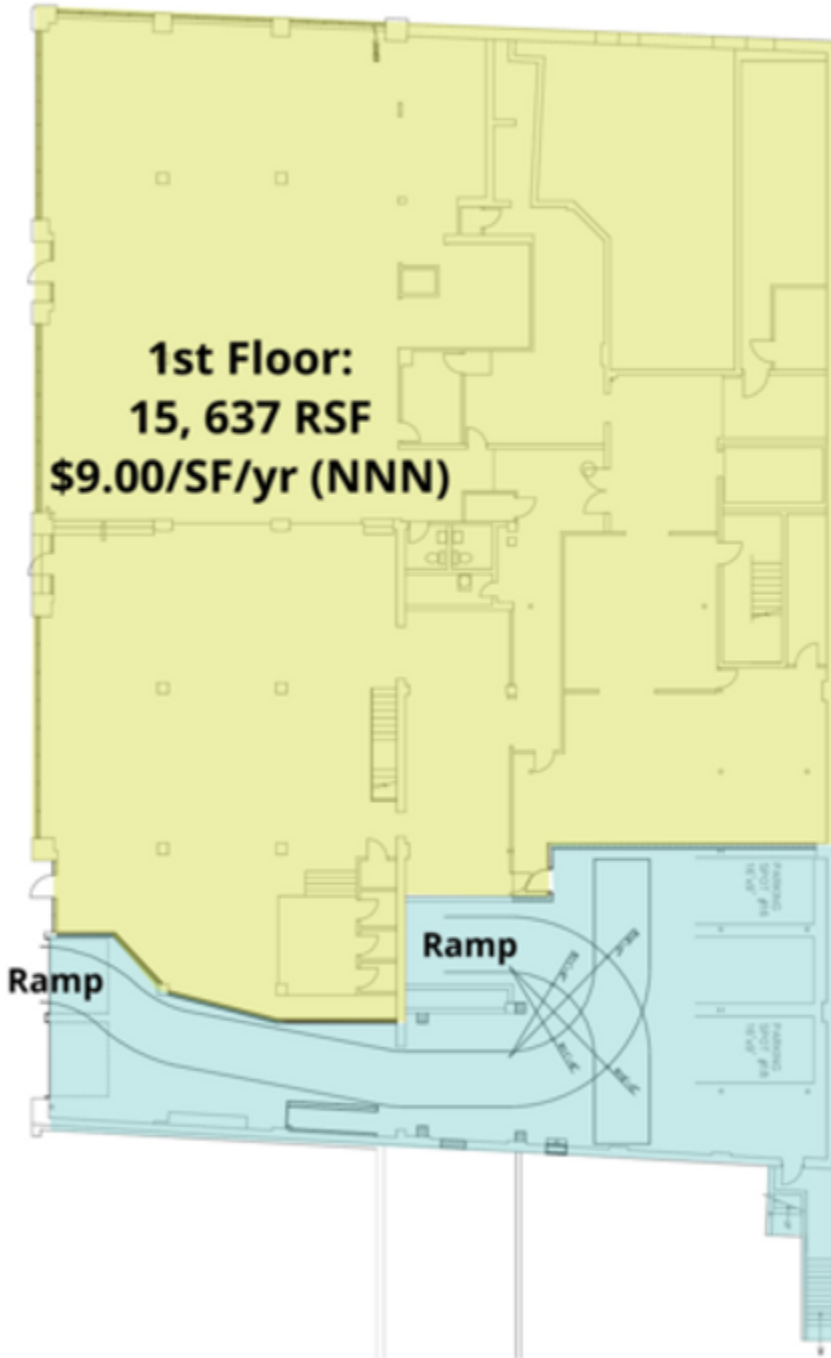

**1st Floor + Parking Garage:  
22,695 RSF  
\$8.00/SF/yr (NNN)**

CHIP BOWLING  
Senior Vice President  
616.915.9080  
cbowling@bradleyco.com



# ADDITIONAL PHOTOS

200 DIVISION AVE. S, GRAND RAPIDS, MI 49503

LEASE

OFFICE



**CHIP BOWLING**  
Senior Vice President  
616.915.9080  
[cbowling@bradleyco.com](mailto:cbowling@bradleyco.com)



200 DIVISION AVE. S, GRAND RAPIDS, MI 49503

LEASE

OFFICE



CHIP BOWLING  
Senior Vice President  
616.915.9080  
cbowling@bradleyco.com



# MEET YOUR NEIGHBORS

200 DIVISION AVE. S, GRAND RAPIDS, MI 49503

LEASE

OFFICE



**CHIP BOWLING**  
 Senior Vice President  
 616.915.9080  
 cbowling@bradleyco.com

©2021 Bradley Company, LLC and affiliates. Use of any third party name or mark is for informational purposes only and does not indicate sponsorship or endorsement by such party. Not all information has been independently verified, and the presenting broker makes no guarantee about its accuracy. Any projections, opinions, or estimates are for example only. Before completing a real estate transaction, you and your advisors should conduct an independent investigation of the property to determine its suitability for your needs.