



700 K Street Northwest

Space availability summary

WeWork @ 700 K Street Northwest
Washington, DC

wework

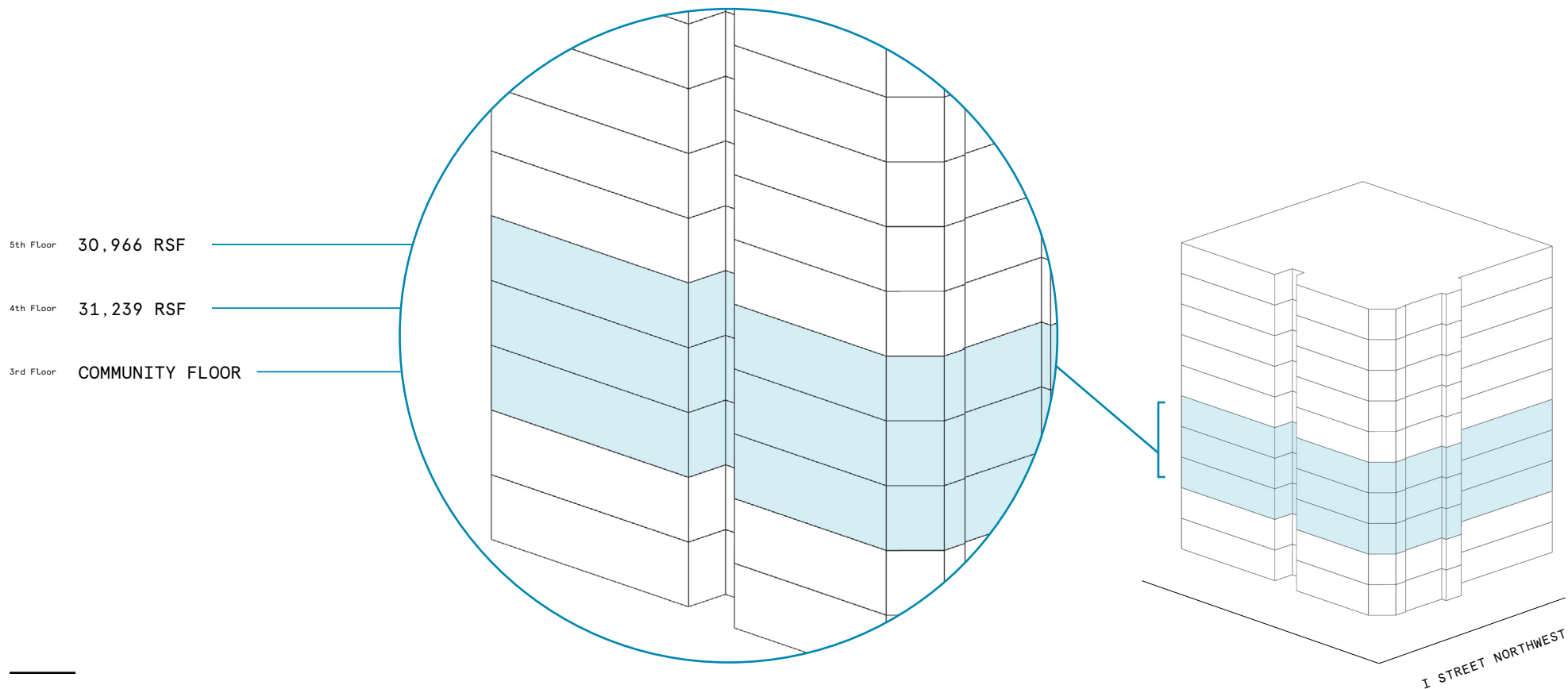

62,205 RSF

TOTAL WEWORK RSF

700 K Street Northwest

At a glance

Workspaces designed for productivity and creativity with flexible size & term

Dedicated, private suites available from 57 to 4,604 RSF

Move-in ready full floor of 30,966 RSF – furnished & wired

10

TOTAL BUILDING FLOORS

442,676

TOTAL BUILDING SQ FT

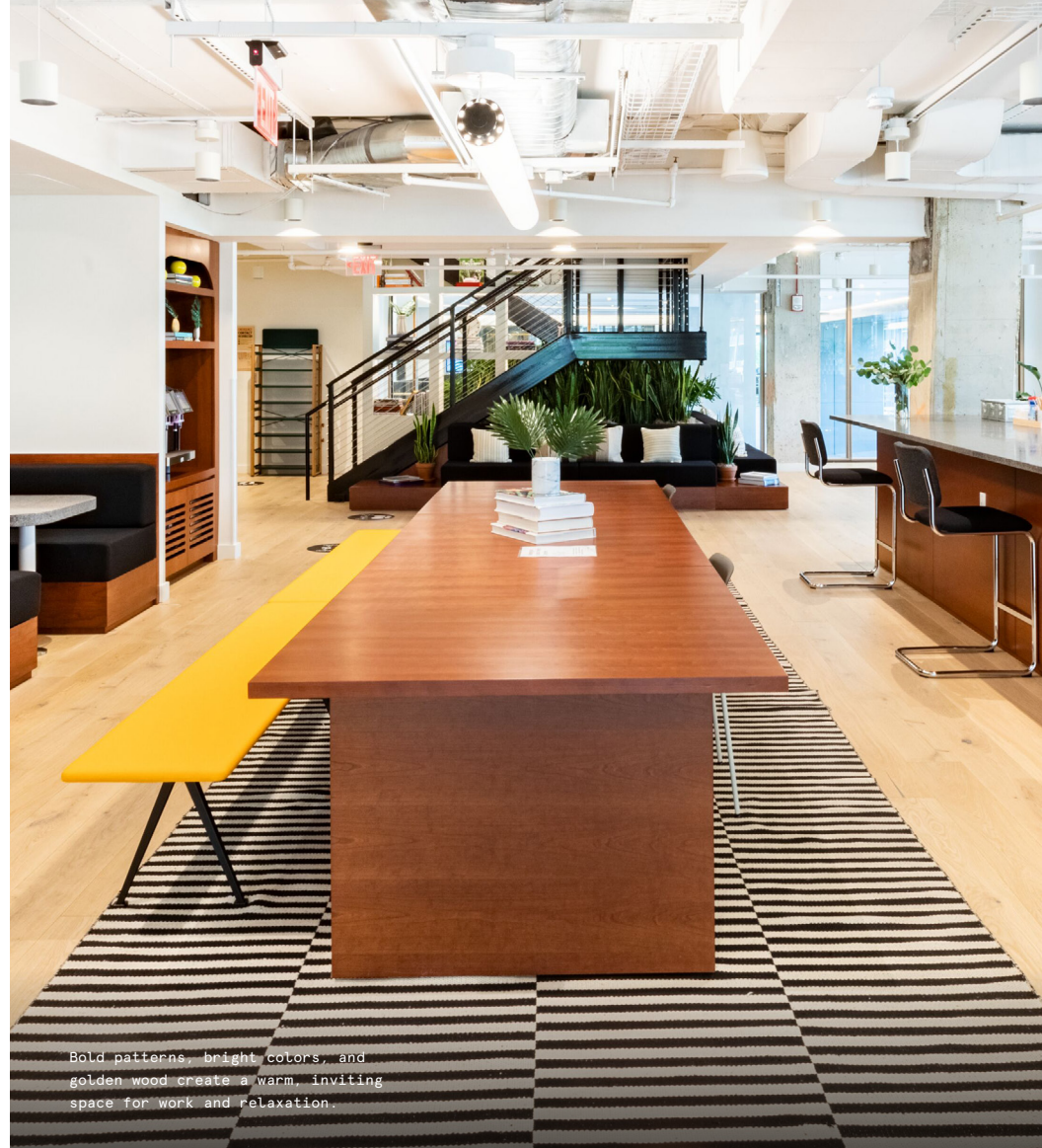

Mod meets industrial in the heart of Downtown DC

Built in 2019, 700 K Street Northwest is located in DC's Mount Vernon Square—a bustling Downtown enclave featuring active retail, bars and restaurants, and a variety of boutique fitness centers. WeWork's three floors in 700 K Street Northwest feature a mix of art-filled lounges, inviting meeting spaces, sleek private offices, and community pantries. With mid-century-inspired furnishings and plenty of bright natural light, this workspace is sure to foster creativity, productivity, and collaboration.



Oversized hardwood tabletops and seating in sleek silhouettes give workspaces a polished, professional feel.



Custom bench seating creates nooks for solo work and one-on-one collaboration.

Warm, bright, and welcoming

With sky-high ceilings and floor-to-ceiling windows, 700 K Street Northwest is an impressive, sun-soaked workspace with the style to match. Glass partition walls, rich materials, and a warm, neutral palette create a fusion between the indoors and the surrounding park, resulting in a naturally inspired office space.

- Warm, deep millwork and rich, vibrant textiles and décor bring the comfort and home to the workspace
- An interconnecting staircase with custom millwork serves as a striking focal point
- Abundant greenery, color, patterns, and textures add visual interest and complement the space's largely neutral palette

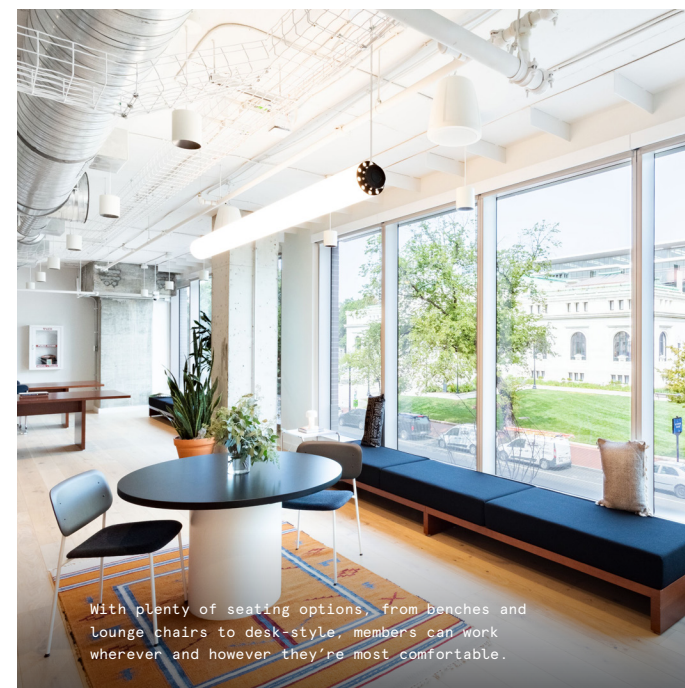
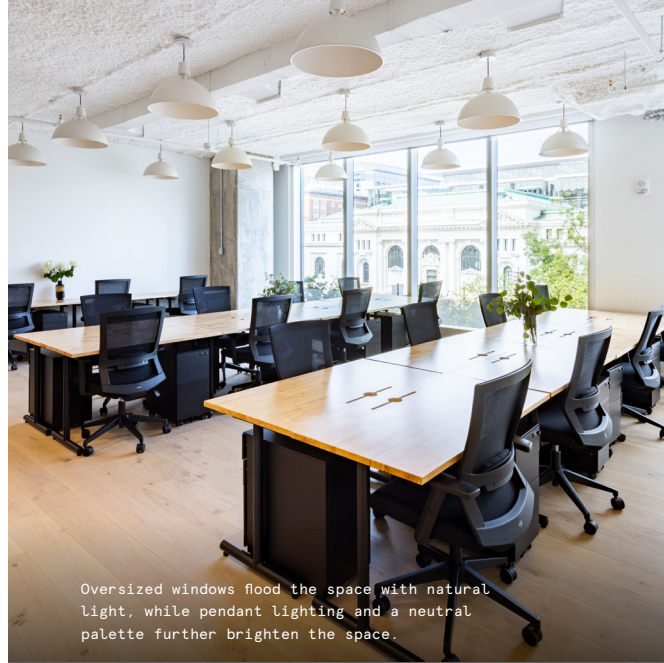



On-site amenities

- 24/7 security
- Electronic keycard access
- Web-based visitor access
- Business-class printers
- Stocked pantry
- US mail drop



- On-site staff
- Meeting rooms
- Mother's room
- Phone booths
- Wellness/meditation room
- Classroom space
- Gender-neutral restrooms
- Outdoor space
- Bicycle storage
- On-site parking
- Podcast booth
- Roof deck access

Building specifications



Hours of operation

Monday - Friday: 8am-5pm



Security

24/7 attended lobby



HVAC

Monday - Friday: 8am-8pm
Saturday: 9am-3pm



Building history

Built in 2019



Ceiling heights

10 feet slab-to-slab



Fire strategy

Fully-sprinklered floors



Building size

10 stories
442,676 SF



Elevators

6 passenger elevators
with a capacity of 3,000 lbs





Access to the heart of Downtown Washington

700 K Street is at the heart of downtown Washington. Just across the street from the Walter E. Washington Convention Center, this building is accessible by several metro lines and is within walking distance of some of DC's most renowned restaurants, landmarks, and attractions.

This neighborhood boasts dozens of hip restaurants and bars, perfect for business lunches, client dinners, or post-work happy hours. Local favorites like The Capital Burger and RPM Italian are sure to satisfy, while Pearl's bagels and Baker's Daughter are perfect for pre-work bites or lunchtime eats. There are also plenty of boutique fitness centers nearby, making it easier than ever to get in a workout on the way to or from the office. And those looking to check out one of the city's renowned cultural hotspots can take a short walk to the National Portrait Gallery.

Commuting is easy, with nearby buses and the Green, Yellow, and Red Metro Lines within walking distance.

Distance to WeWork

655 New York Avenue Parking Garage		Walk	2 min
Mount Vernon Square/7th Street-Convention Center Metro Station		Walk	5 min
Gallery Place/Chinatown Metro Station		Walk	7 min
Metro Center Metro Station		Walk	15 min

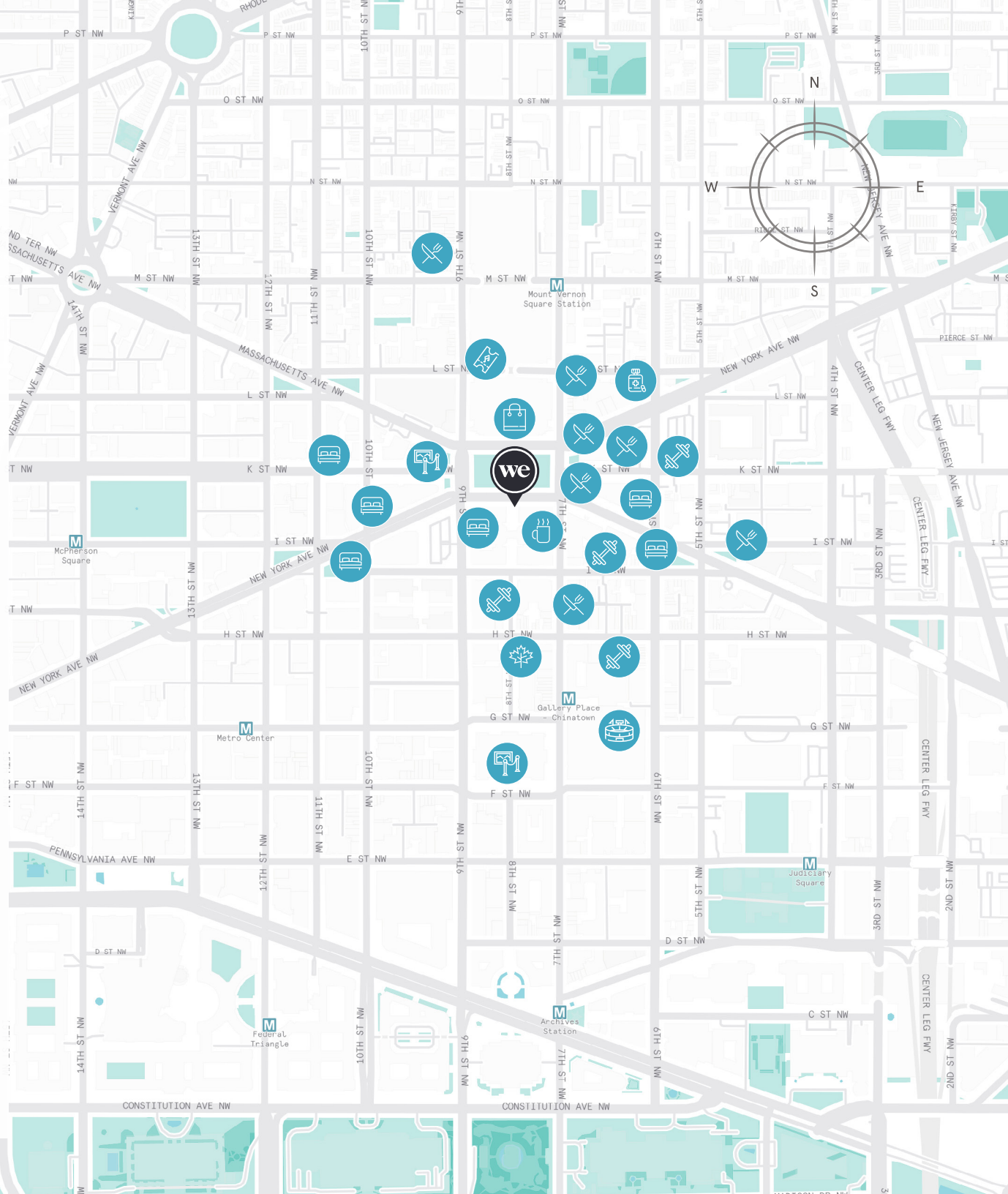

3rd Floor

Community Floor

1

MEETING ROOM(S)

1

SHARED WORKSPACE(S)

LEGEND

- MEETING ROOM
- SHARED WORKSPACE
- DEDICATED SPACE

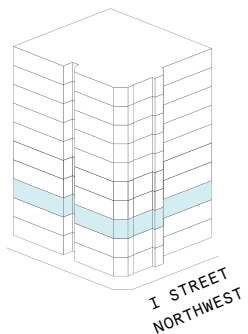

4th Floor

31,239 RSF

7

MEETING ROOM(S)

7

SHARED WORKSPACE(S)

LEGEND

- MEETING ROOM
- SHARED WORKSPACE
- DEDICATED SPACE

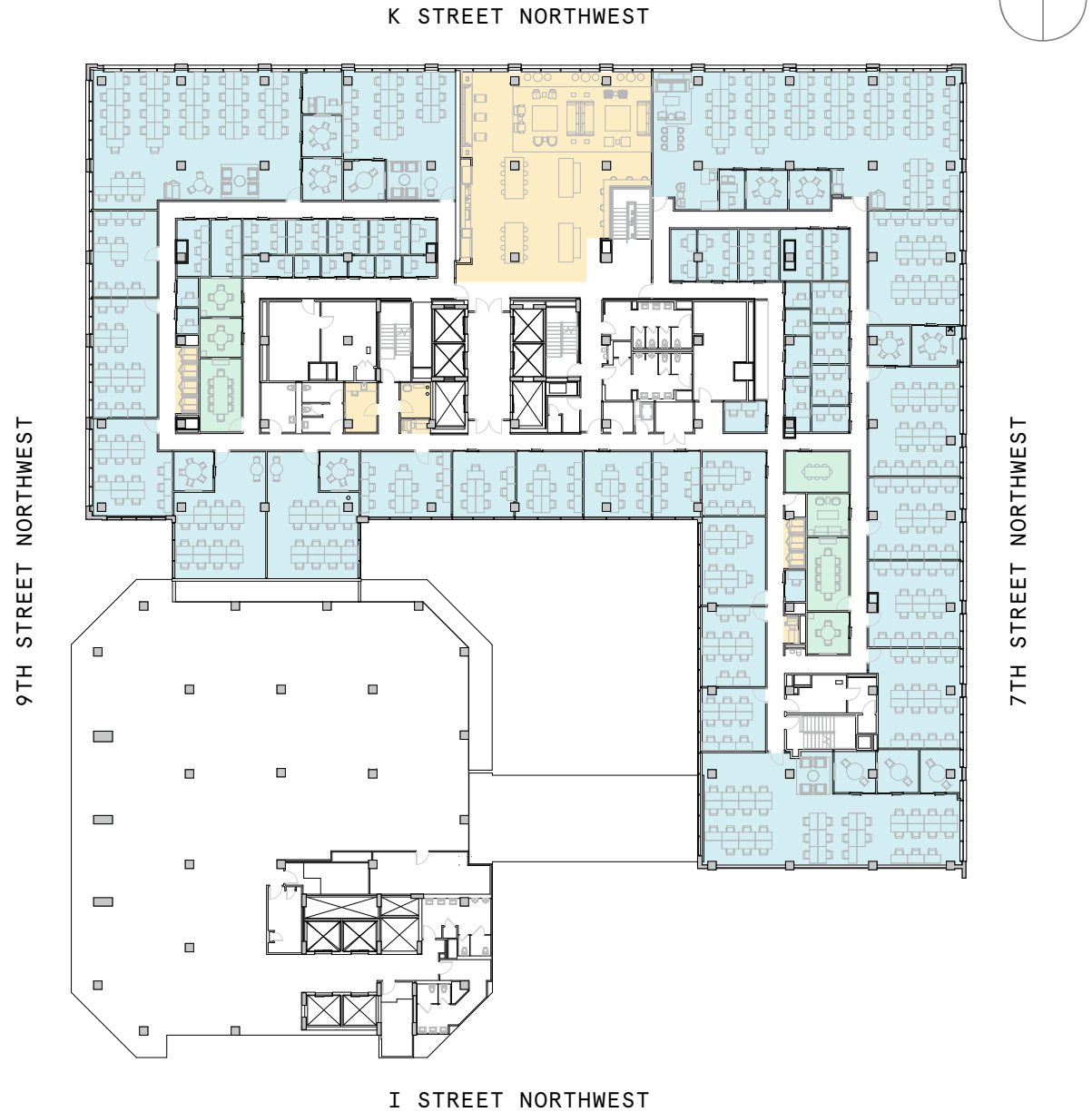
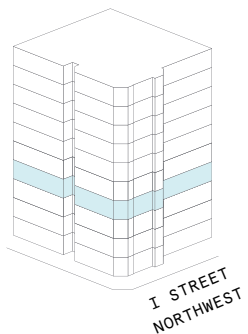

4th Floor

31,239 RSF

4,604 RSF Suite 04W101

2

MEETING ROOM(S)

1

PRIVATE OFFICE(S)

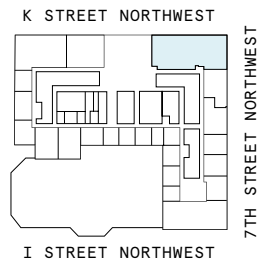

Suite 04W101

4th Floor

2

MEETING ROOM(S)

1

PRIVATE OFFICE(S)

4,604 RSF

RENTABLE AREA

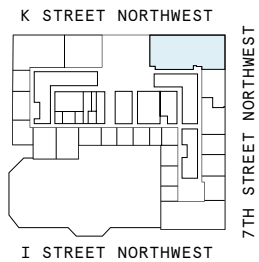
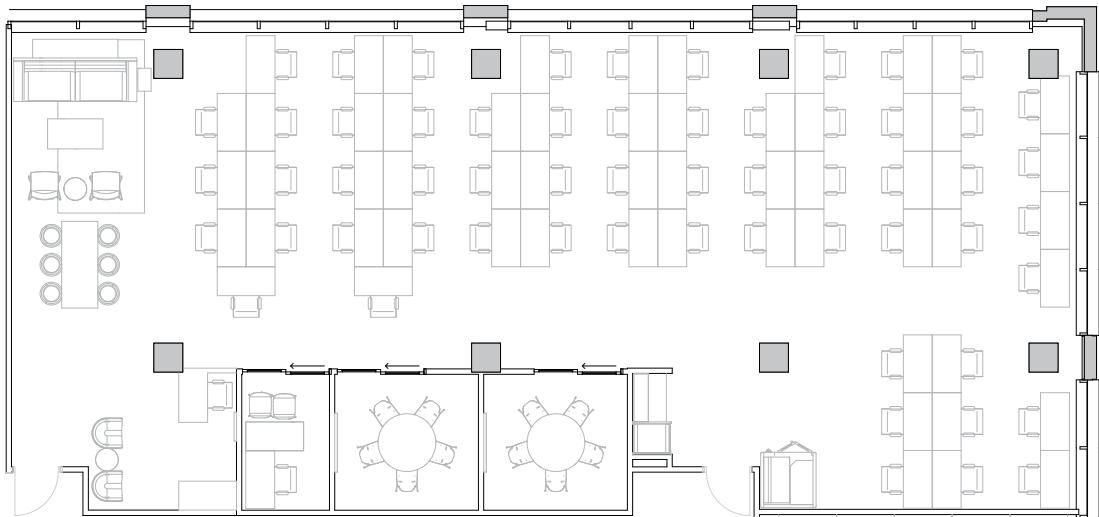

4th Floor

31,239 RSF

1,359 RSF Suite 04W108

1

MEETING ROOM(S)

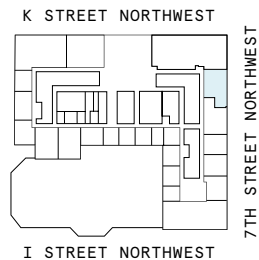

Suite 04W108

4th Floor

1

MEETING ROOM(S)

1,359 RSF
RENTABLE AREA

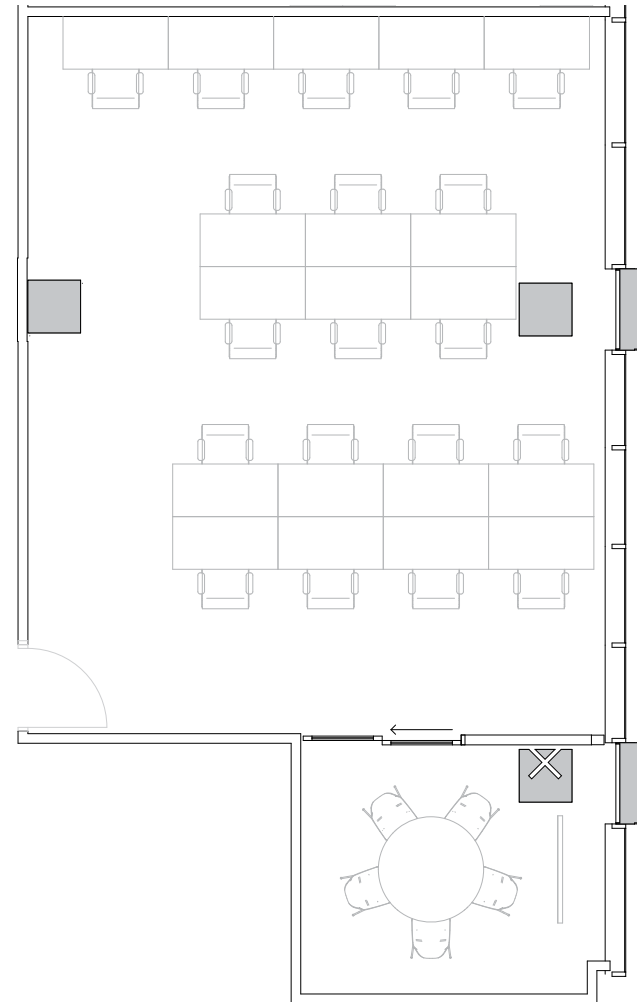
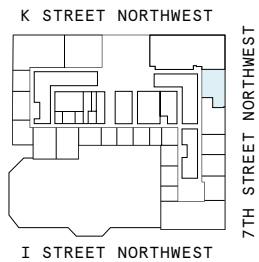

4th Floor

31,239 RSF

1,304 RSF Suite 04W110

1

MEETING ROOM(S)

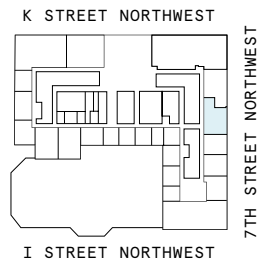

Suite 04W110

4th Floor

1

MEETING ROOM(S)

1,304 RSF

RENTABLE AREA

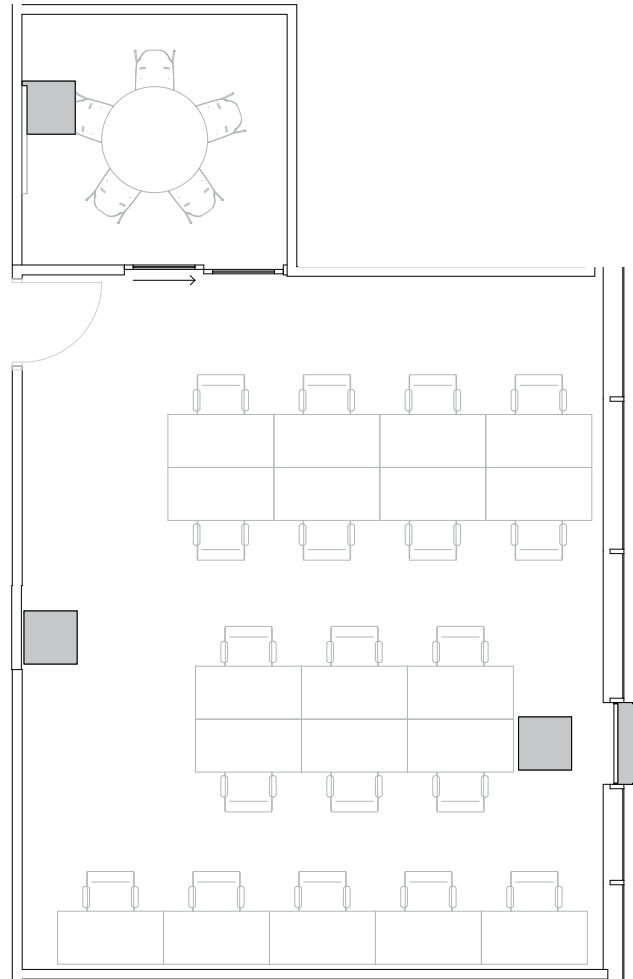
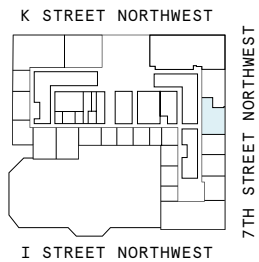

4th Floor

31,239 RSF

3,170 RSF Suite 04W116

3

MEETING ROOM(S)

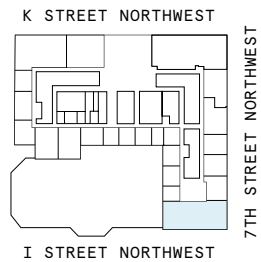

Suite 04W116

4th Floor

2

MEETING ROOM(S)

1

PRIVATE OFFICE(S)

3,170 RSF

RENTABLE AREA

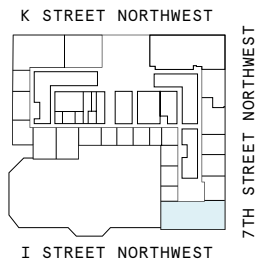
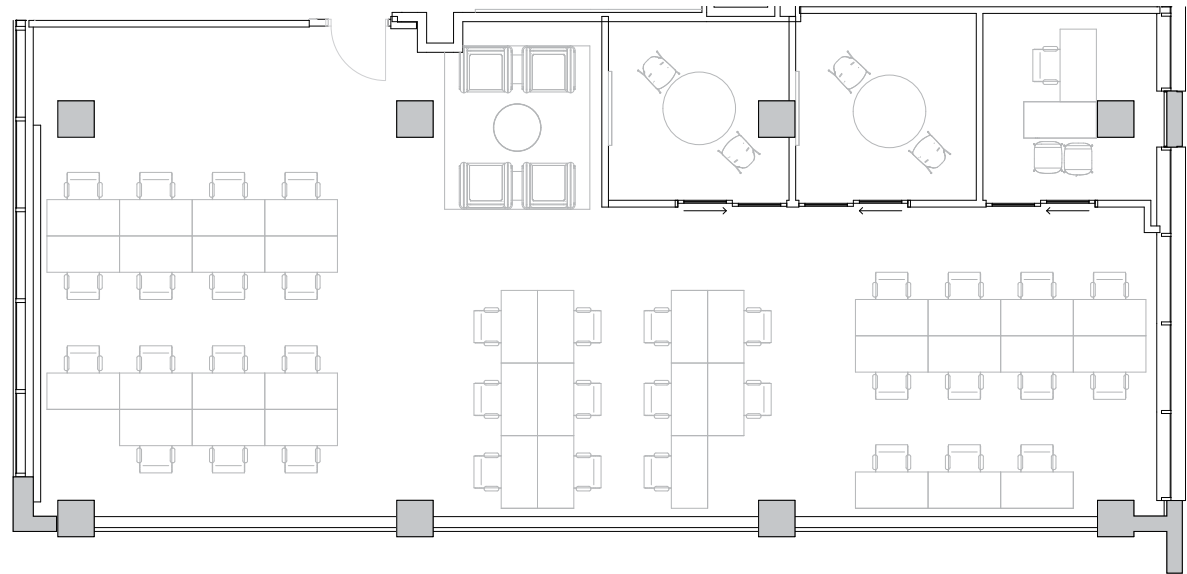

4th Floor

31,239 RSF

3,637 RSF Suite 04W142

2

MEETING ROOM(S)

1

PRIVATE OFFICE(S)

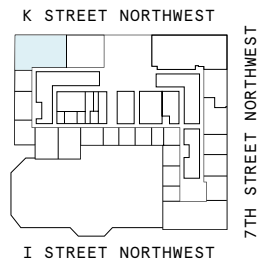

Suite 04W142

4th Floor

2

MEETING ROOM(S)

1

PRIVATE OFFICE(S)

3,637 RSF

RENTABLE AREA

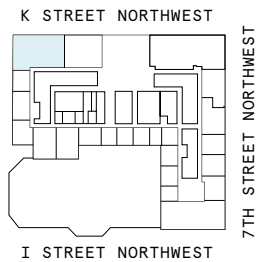
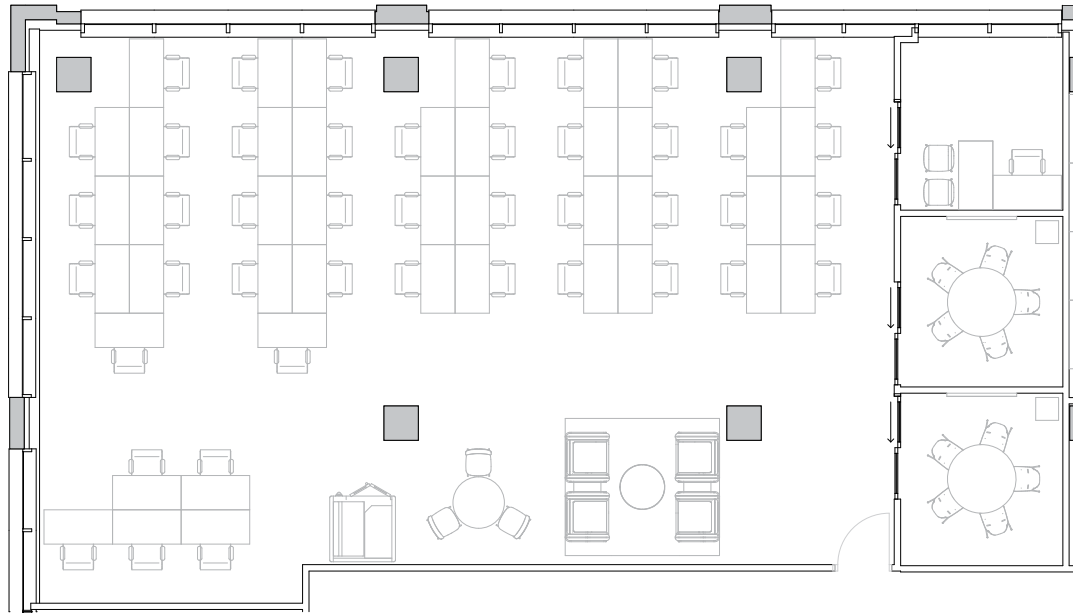

4th Floor

31,239 RSF

1,595 RSF Suite 04W147

1

MEETING ROOM(S)

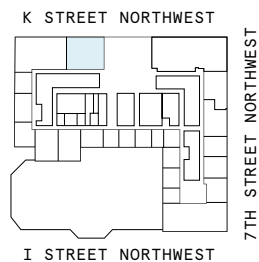

Suite 04W147

4th Floor

1

MEETING ROOM(S)

1,595 RSF

RENTABLE AREA

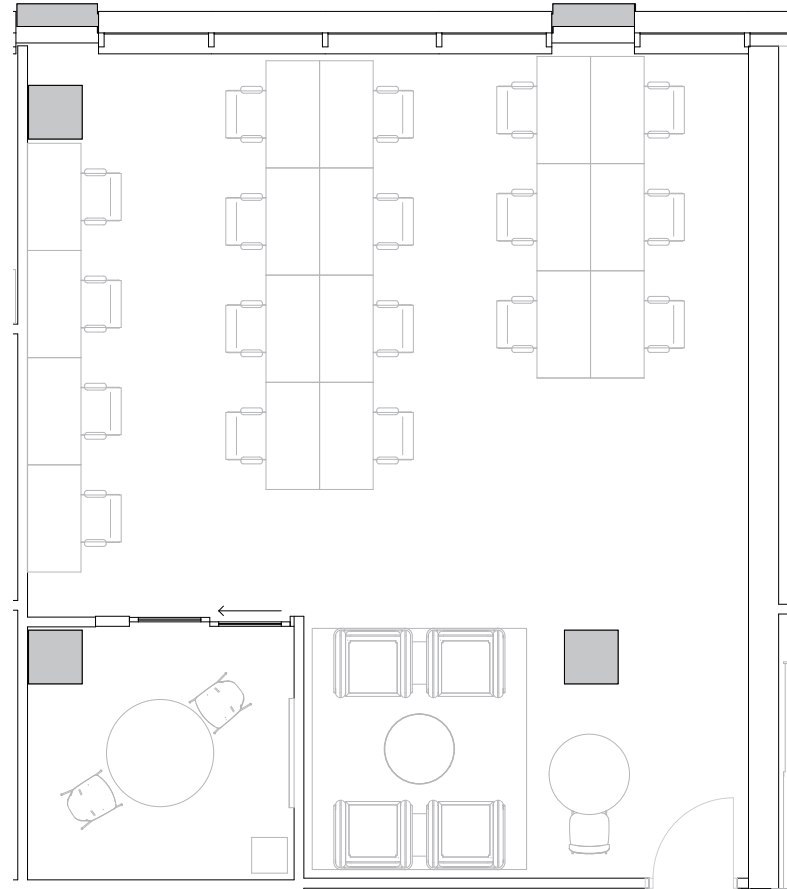
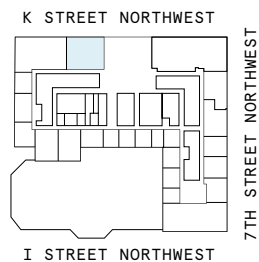

5th Floor

30,966 RSF

32
MEETING ROOM(S)

4
SHARED WORKSPACE(S)

LEGEND

- MEETING ROOM
- SHARED WORKSPACE
- DEDICATED SPACE

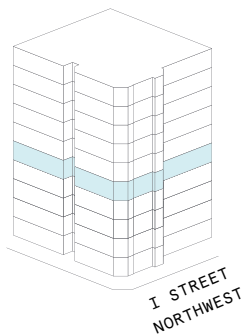

5th Floor

30,966 RSF

30,966 RSF Suite 05-100

32

MEETING ROOM(S)

LEGEND

 DEDICATED SPACE

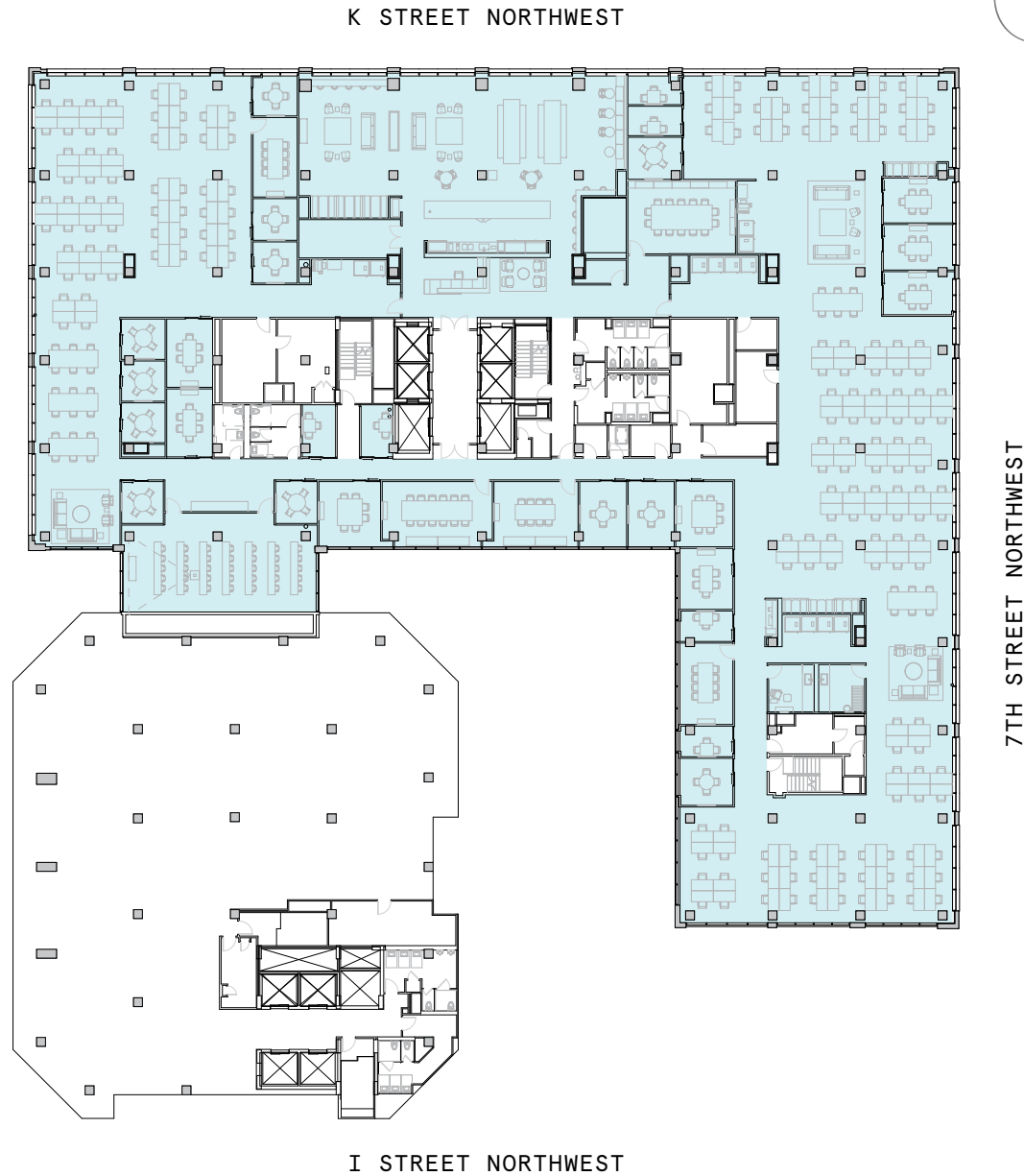
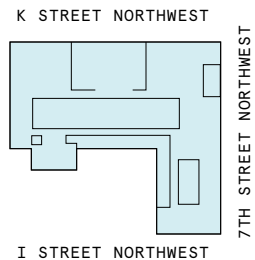

Contact

For leasing inquiries please
reach out to our team.



Dave Belford

LEASING DIRECTOR
DAVE.BELFORD@WEWORK.COM
240.601.2991

© 2022 WeWork. The WeWork trademark and related logos are the property of WeWork Companies LLC. Any reference to third-party names are for reference and informational purposes only and should not be considered an endorsement or association of WeWork or vice versa. Photographs contained herein may be representative examples of various WeWork locations and do not necessarily depict the WeWork location referenced. While reasonable efforts have been made to check the accuracy of the information contained here, WeWork, its officers, employees, directors, and representatives, make no warranty, express or implied, regarding the accuracy of the information and disclaim any liability arising from the use of the information contained herein. All dimensions are approximate and subject to variances. It is your obligation to independently verify the particulars of the property. WeWork reserves the right to make changes.