



# FOR LEASE

- ✓ Brand New Class A Flex Space
- ✓ 5,500 - 22,000 SF Available
- ✓ Direct I-15 / I-84 Visibility & Access
- ✓ Strategic Northern Utah Location
- ✓ Ample Parking & Truck Circulation
- ✓ Flexible Space Configurations
- ✓ 28'-30' High Ceilings w/ 23'-25' Clear
- ✓ 3-Phase Power Available
- ✓ Ready for Tenant Improvements



**\$1.15/SF/NNN**

**1242 North 2000 West  
Farr West, UT 84404**



# Floor Plan



Each Unit = 5,500 Sq Ft Total  
Building = 22,000 Sq Ft

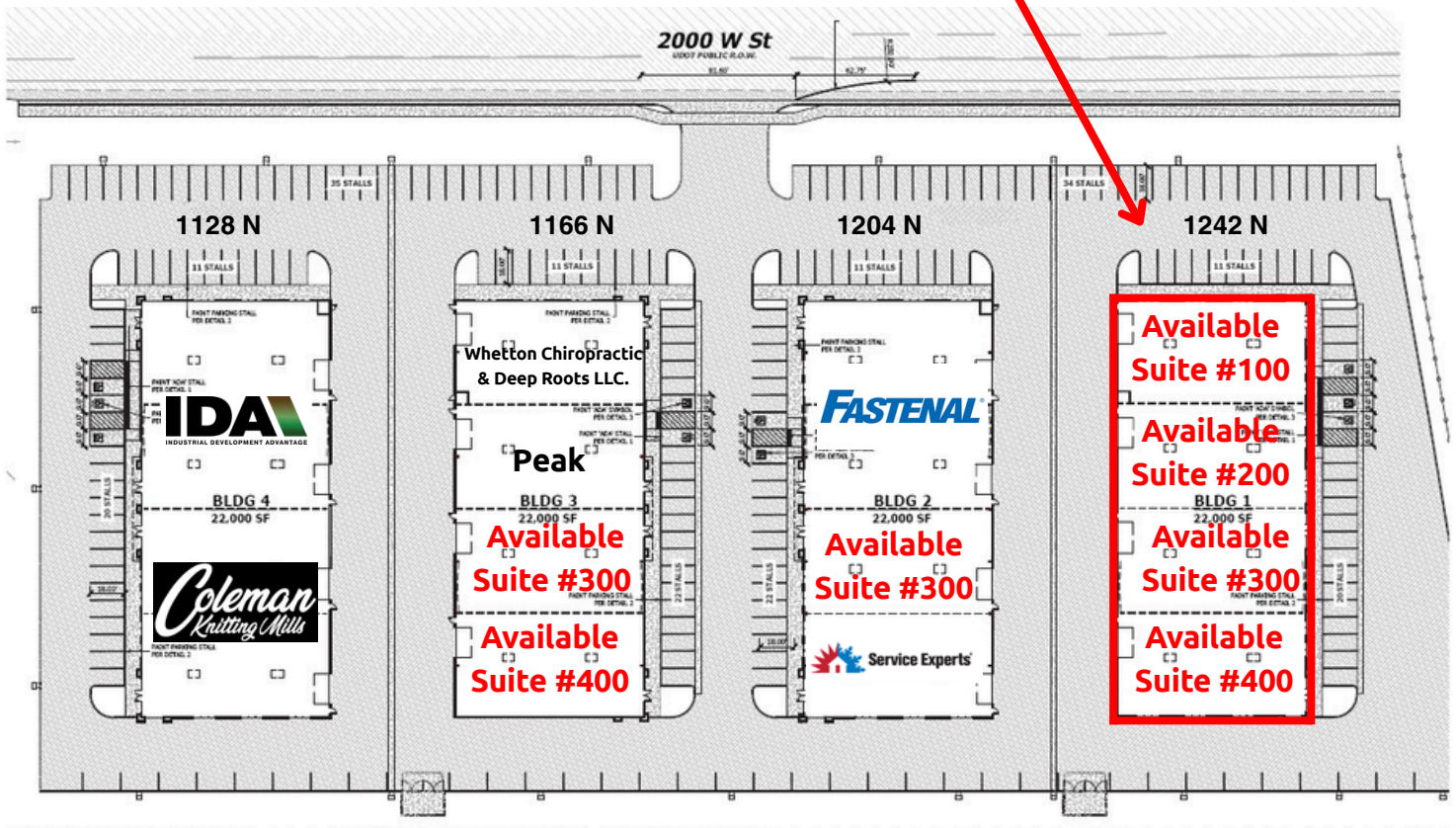
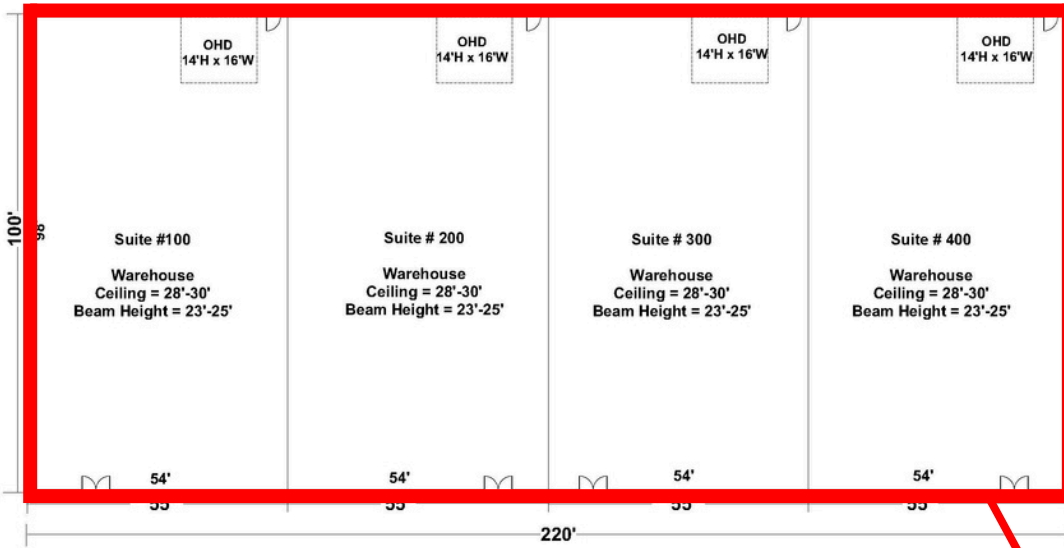

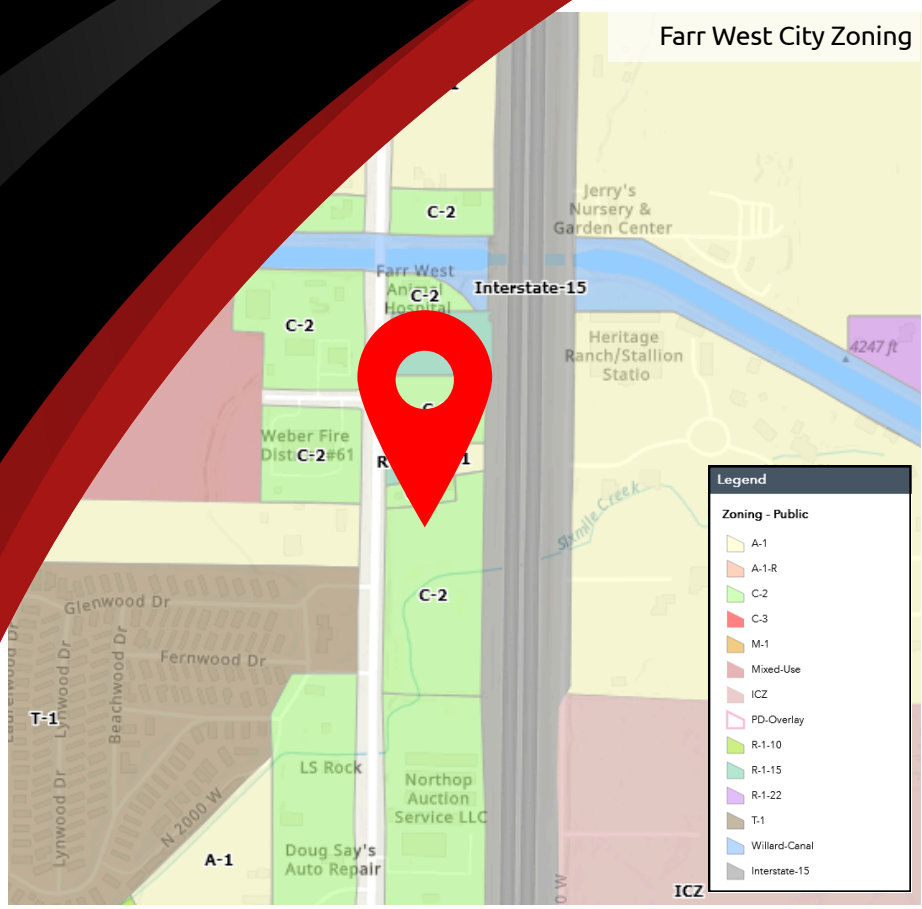

1242 N 2000 W  
FARR WEST, UT 84404



**Garrett Pierson**  
801-644-1361  
g@crestutah.com



**Aaron McCrady**  
801-953-7012  
aaroncrest@gmail.com





# Contact Us



**Garrett Pierson**

801-644-1361

g@crestutah.com



**Aaron McCrady**

801-953-7012

aaroncrest@gmail.com



www.crestutah.com  
968 Chambers St #2,  
South Ogden UT 84403  
801-476-9500

