



10890

NW S River Dr
Medley, FL 33178



MEDLEY INDUSTRIAL SERVICE FACILITY FOR LEASE

+/- 1 up to 4.34 AC with +/- 15,875 SF of Buildings

Fronting Okeechobee Rd - Great location and access (demisable)

Pat McBride, SIOR, Esq.
pmcbride@comreal.com
305-619-2937

Chris Spear, SIOR, CCIM
cspear@comreal.com
(305) 807-7662



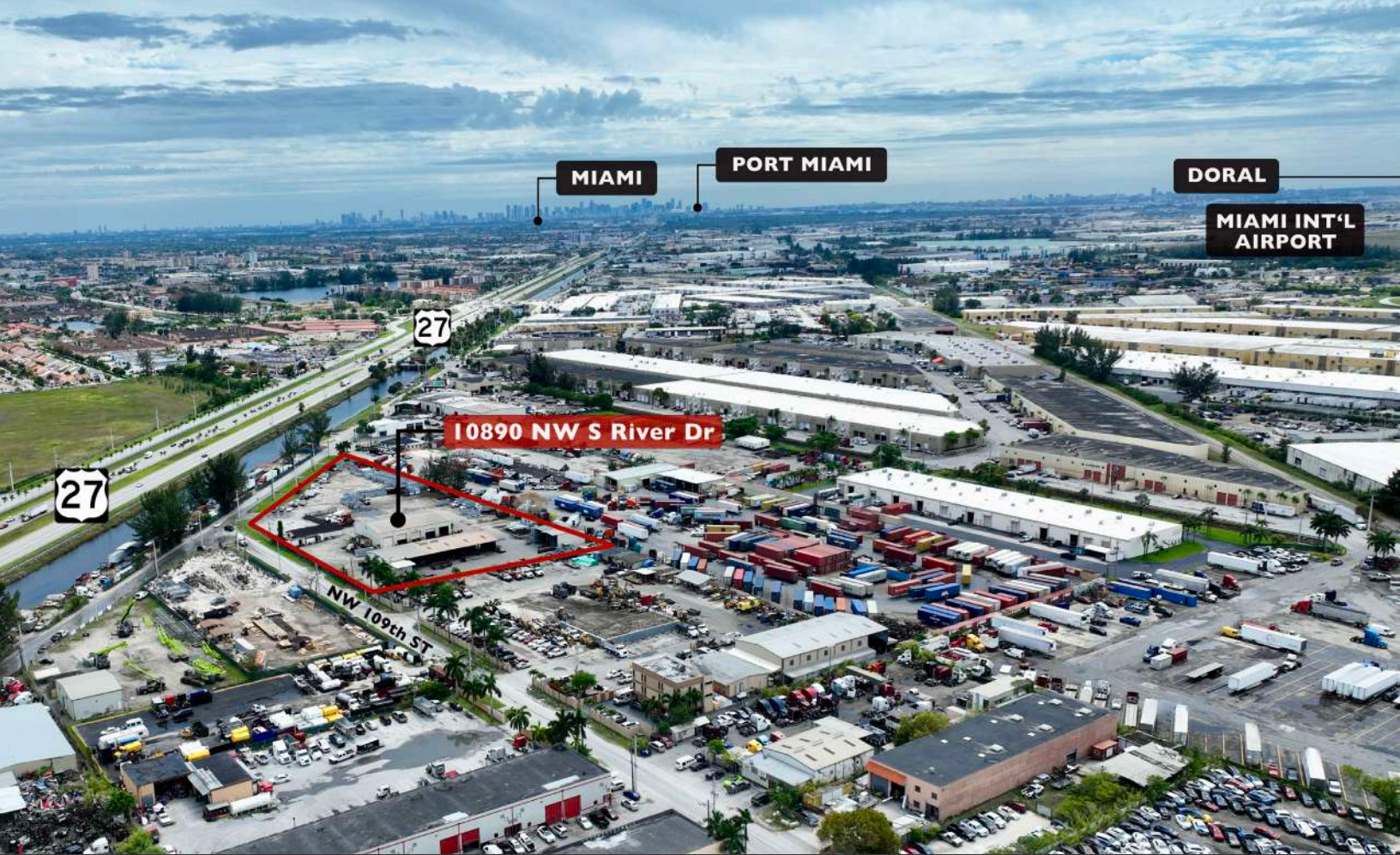

PROPERTY LOCATION

DISTANCE TO:

- **US 27:** 0.4 miles
- **FL Turnpike:** 2.3 miles
- **826 Expressway:** 2.0 miles
- **Miami Int'l Airport:** 7.9 miles
- **Port Miami:** 14.0 miles

PROPERTY OVERVIEW

- **Zoning:** M-1 Town of Medley
- **Ideal Uses:** Heavy Equipment, Truck, & Auto Storage, Parking, & Maintenance
- Fully permitted paint booth on site
- **Fenced, lit, and secure**
- Inquire for lease rate

PROPERTY PHOTOS



ENTIRE SITE

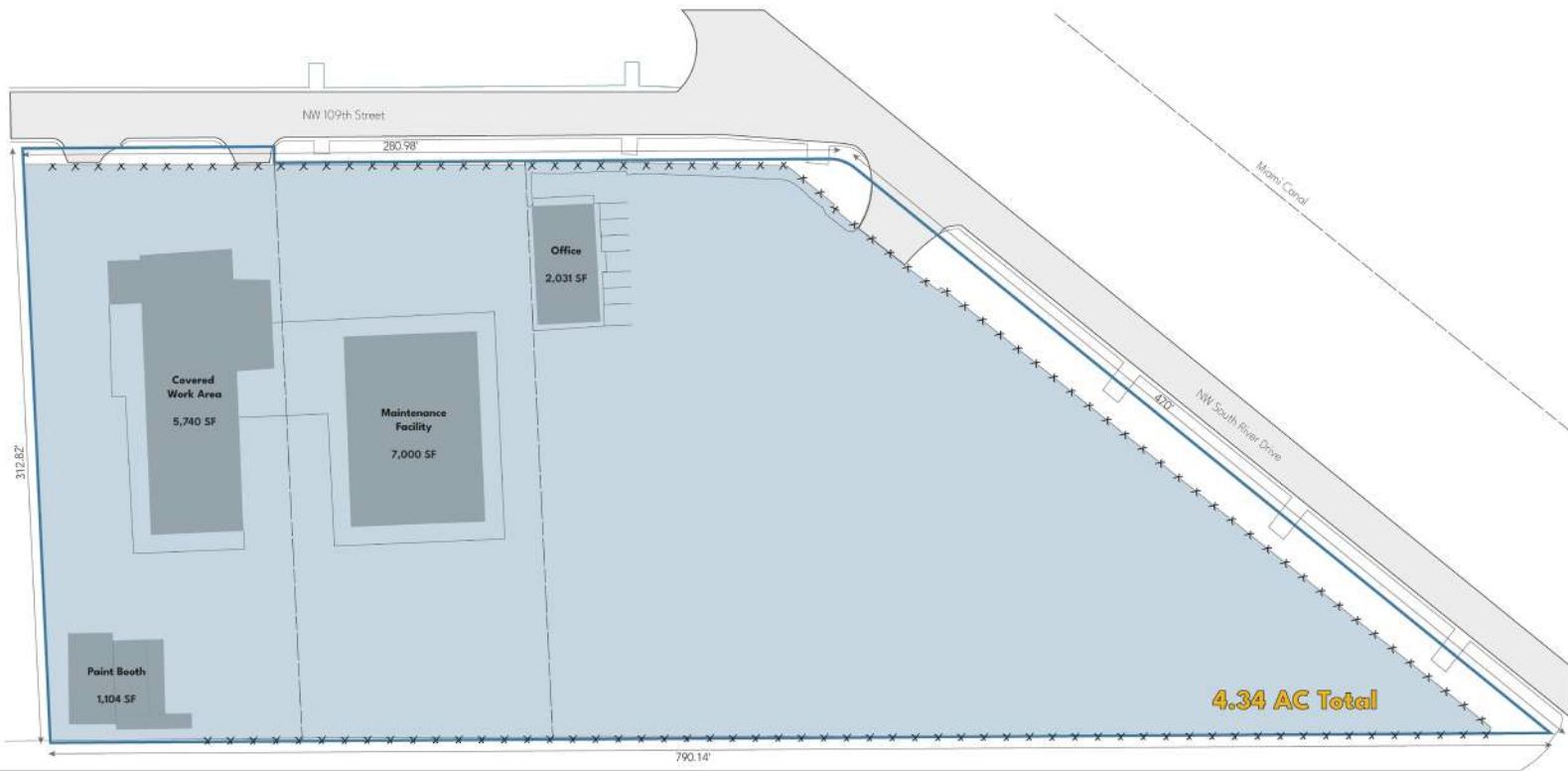

DEMISING OPTIONS

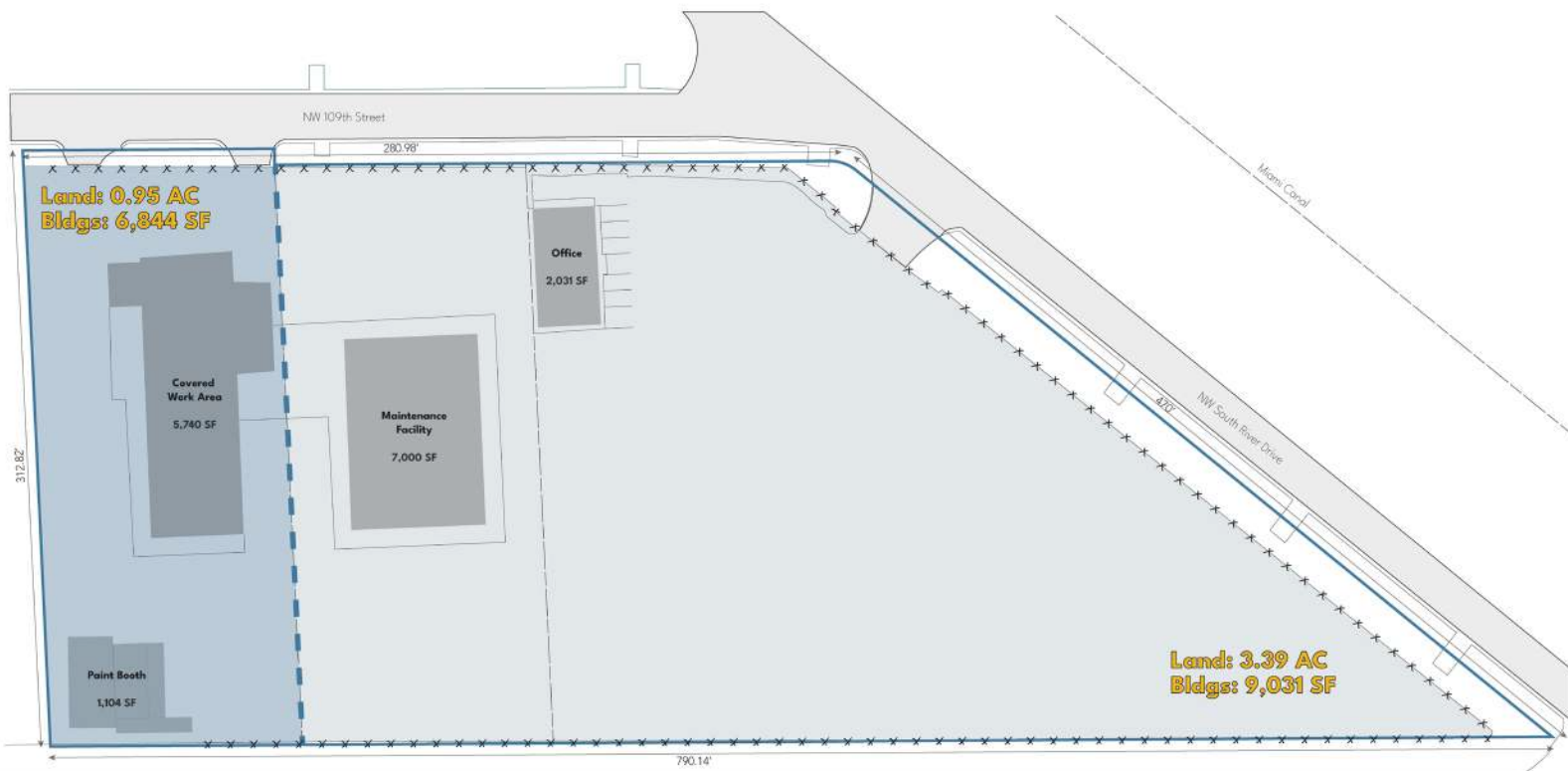
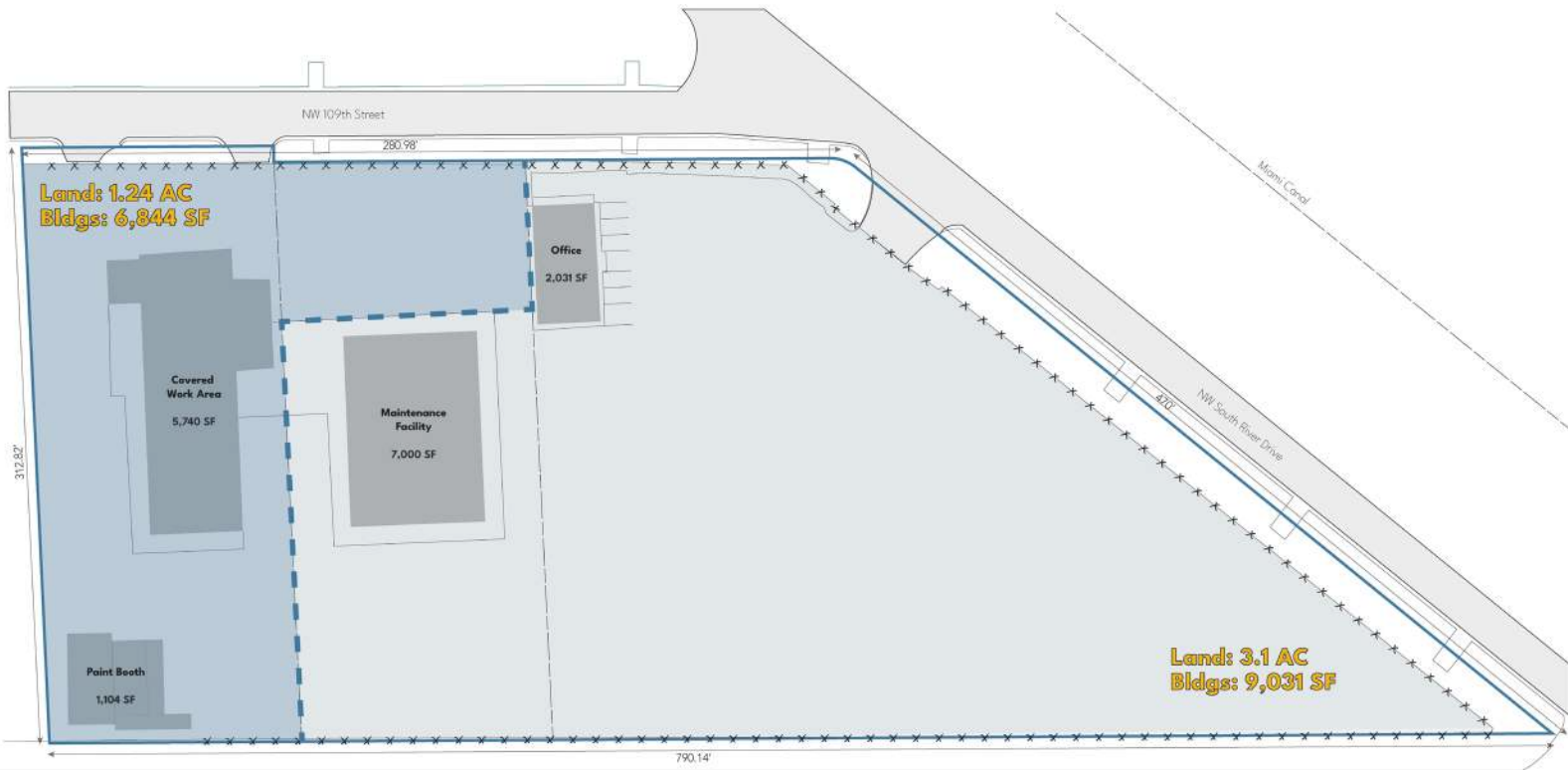

* Other demising options available

National Highway Freight Network

- PHFS (Primary Highway Freight System)
- Non-PHFS Interstates
- Connectors
- Connector Pending FHWA Approval
- Other Roads

BROWARD COUNTY

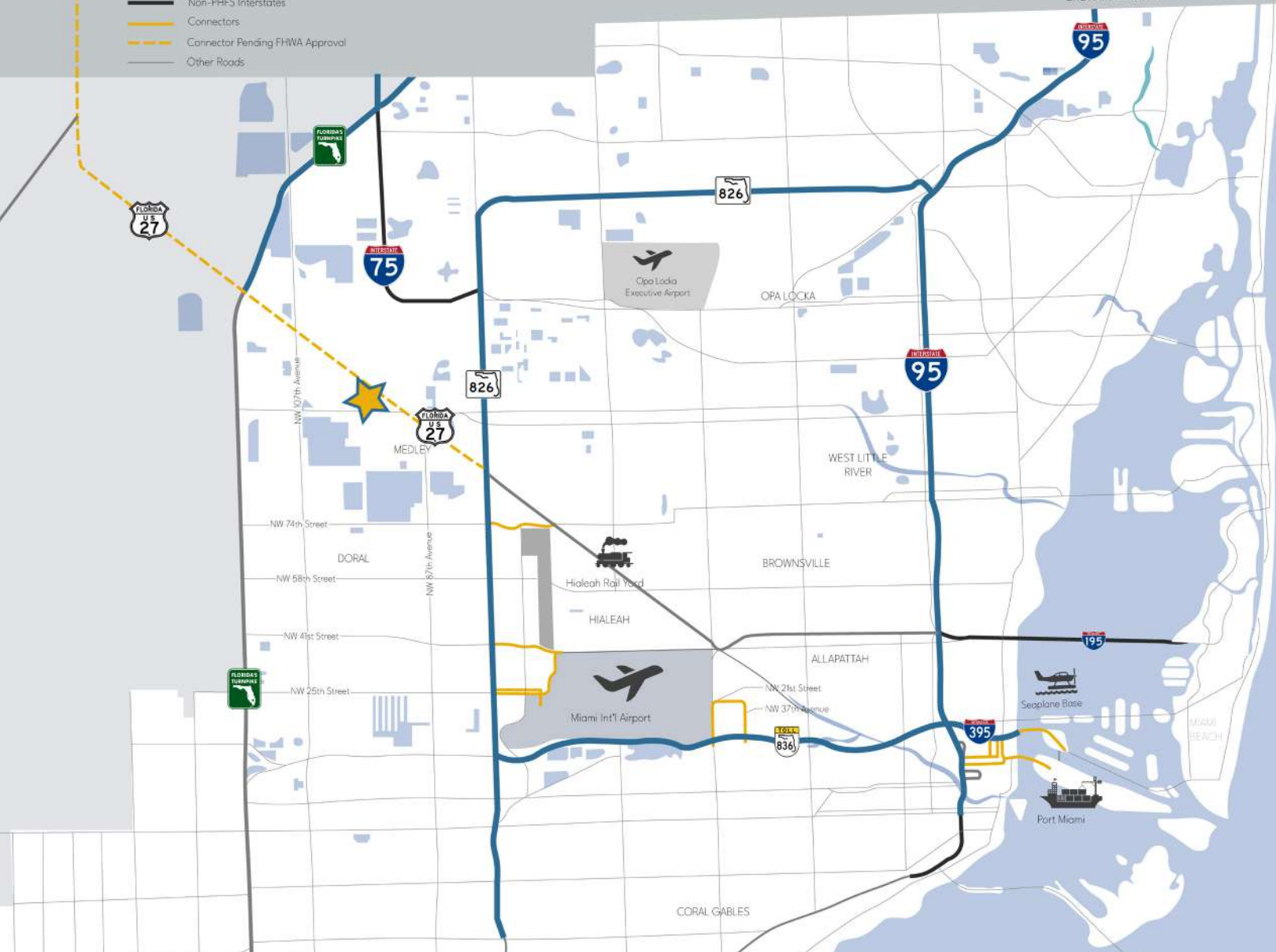

For Leasing Inquiries, Contact:

Pat McBride, SIOR, Esq.
pmcbride@comreal.com
(305) 619-2937

Chris Spear SIOR, CCIM
cspear@comreal.com
(305) 807-7662



Owned and Managed by:



ComReal Miami - Doral, LLC
3470 NW 82nd Ave, Suite 605
Doral, FL 33122

Disclosure: All information provided herein is obtained from sources that we believe to be reliable, but has not been verified for accuracy or completeness. Any reliance on this information is solely at your own risk. Terms and conditions or change in price are subject to change without notice.